



Chipsmall Limited consists of a professional team with an average of over 10 year of expertise in the distribution of electronic components. Based in Hongkong, we have already established firm and mutual-benefit business relationships with customers from,Europe,America and south Asia,supplying obsolete and hard-to-find components to meet their specific needs.

With the principle of “Quality Parts,Customers Priority,Honest Operation,and Considerate Service”,our business mainly focus on the distribution of electronic components. Line cards we deal with include Microchip,ALPS,ROHM,Xilinx,Pulse,ON,Everlight and Freescale. Main products comprise IC,Modules,Potentiometer,IC Socket,Relay,Connector.Our parts cover such applications as commercial,industrial, and automotives areas.

We are looking forward to setting up business relationship with you and hope to provide you with the best service and solution. Let us make a better world for our industry!



Contact us

Tel: +86-755-8981 8866 Fax: +86-755-8427 6832

Email & Skype: info@chipsmall.com Web: www.chipsmall.com

Address: A1208, Overseas Decoration Building, #122 Zhenhua RD., Futian, Shenzhen, China



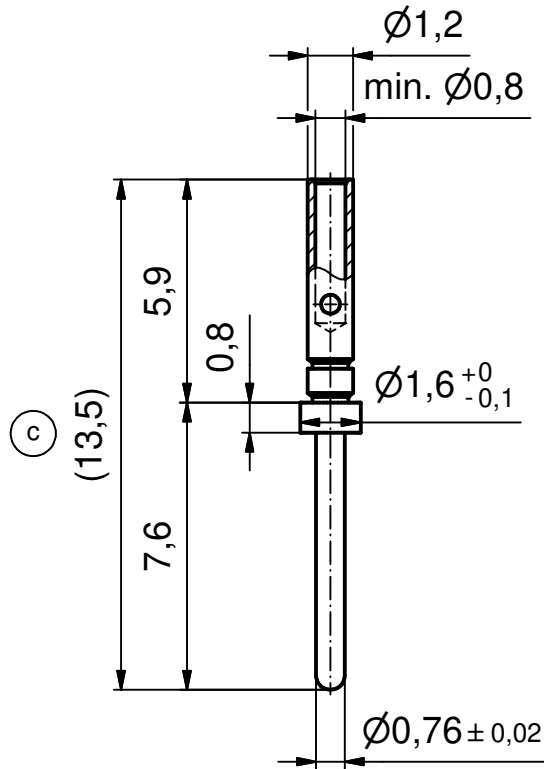
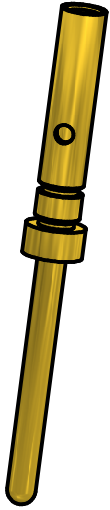

STRIPPING DIMENSION (b) (c)

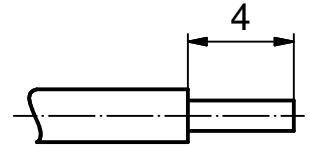

Part-no. as per finish		
GOLD FLASH over NICKEL (d) (e)	min. 20µin HARD GOLD over min. 50µin NICKEL	min. 30µin HARD GOLD over min. 50µin NICKEL
161A18009X	161B18009X	161C18009X

- (b) **NOTES:**
 (c) 1. Material: Copper alloy
 2. Finish: See table
 3. Temperature range: -55 °C to +125 °C
 4. Rated current: 3 A maximum
 5. Contact resistance: <= 10 mOhm
 6. Crimping: Use crimp tool 360X10329X
 With tool insert 360X10629X
 Selector settings: 4 for AWG 22
 3 for AWG 24
 2 for AWG 26
 1 for AWG 28

Directive 2002/95/EC RoHS compliant

THIS DRAWING MAY NOT BE COPIED OR REPRODUCED IN ANY WAY, AND MAY NOT BE PASSED ON TO A THIRD PARTY WITHOUT WRITTEN PERMISSION. OWNERSHIP AND COPYRIGHT OF CONEC GmbH

DO NOT ALTER CAD DRAWING BY HAND

				tolerance DIN ISO 2768-m		dim. in mm
				date	name	
				drawn 12.03.01	Parei	
1 x e	Ä4116	26.09.11	Lehm.	appd. 12.03.01	Mickenbecker	
1 x d	Ä3750	15.09.10	K.H.	norm		
4 x c	Ä 3698	25.08.10	Lehm.	d-old		
2 x b	Ä 2647	11.01.07	Lehm.			
a	Original					
rev.	description	date	name			

scale:	5:1	
material:	SEE NOTES	
title:	HD CRIMP PLUG CONTACT screw machined version accepts cable AWG 28-22	
dwg no:	Inventor 10	DIN-A4
	16K1A152A	sh: 1
part no:	SEE TABLE	