



Chipsmall Limited consists of a professional team with an average of over 10 year of expertise in the distribution of electronic components. Based in Hongkong, we have already established firm and mutual-benefit business relationships with customers from,Europe,America and south Asia,supplying obsolete and hard-to-find components to meet their specific needs.

With the principle of "Quality Parts,Customers Priority,Honest Operation,and Considerate Service",our business mainly focus on the distribution of electronic components. Line cards we deal with include Microchip,ALPS,ROHM,Xilinx,Pulse,ON,Everlight and Freescale. Main products comprise IC,Modules,Potentiometer,IC Socket,Relay,Connector.Our parts cover such applications as commercial,industrial, and automotives areas.

We are looking forward to setting up business relationship with you and hope to provide you with the best service and solution. Let us make a better world for our industry!



## Contact us

Tel: +86-755-8981 8866 Fax: +86-755-8427 6832

Email & Skype: info@chipsmall.com Web: www.chipsmall.com

Address: A1208, Overseas Decoration Building, #122 Zhenhua RD., Futian, Shenzhen, China



# Photovoltaic connector - PV-FT-CM-C-6-500-RD - 1623390

Please be informed that the data shown in this PDF Document is generated from our Online Catalog. Please find the complete data in the user's documentation. Our General Terms of Use for Downloads are valid (<http://phoenixcontact.com/download>)



## Key Commercial Data

|                        |   |
|------------------------|---|
| Packing unit           | 50 STK  |
| Minimum order quantity | 50 STK  |
| GTIN                   | <br>4 055626 139654 |
| GTIN                   | 4055626139654   |

## Technical data

### Dimensions

|                         |                 |
|-------------------------|-----------------|
| Fixed cable length      | 500 mm          |
| External cable diameter | 5.4 mm ±0.15 mm |

### Ambient conditions

|  |                          |
|--|--------------------------|
| Degree of protection (when plugged in) | IP66 / IP68 (2 m / 24 h) |
| Degree of protection (not plugged in)  | IP65                     |
| Ambient temperature (operation)        | -40 °C ... 85 °C         |
| Ambient temperature (assembly)         | -25 °C ... 50 °C         |

### General

|   |                   |
|---|-------------------|
| Design                                      | Pin               |
| Tightening torque nut                       | 1.8 Nm ±0.1 Nm    |
| Insertion force                             | 45 N ±10 N        |
| Disconnect force                            | 250 N ±50 N       |
| Pull-out force of cable >= disconnect force | > 80 N            |
| Rated voltage                               | 1500 V            |
| Rated current (6.0 mm <sup>2</sup> )        | 40 A              |
| Nominal cross section                       | 6 mm <sup>2</sup> |

# Photovoltaic connector - PV-FT-CM-C-6-500-RD - 1623390

## Technical data

### General

|                  |    |
|------------------|----|
| Protection class | II |
|------------------|----|

### Material

|  |       |
|--|-------|
| Color                                  | black |
| Insulating material                    | mPPE  |
| Contact material                       | Cu    |
| Contact surface material               | Ag    |
| Flammability rating according to UL 94 | V0    |

### Connection data

|   |                   |
|---|-------------------|
| Connection method                           | Crimp             |
| Connection capacity                         | 6 mm <sup>2</sup> |
| Contact resistance with connected conductor | 0.45 mΩ           |
| Cable type                                  | S03               |

### Standards and Regulations

|  |    |
|--|----|
| Flammability rating according to UL 94 | V0 |
|--|----|

### Environmental Product Compliance

|            |   |
|------------|---|
| China RoHS | Environmentally friendly use period: unlimited = EFUP-e |
|            | No hazardous substances above threshold values          |

## Drawings

Dimensional drawing

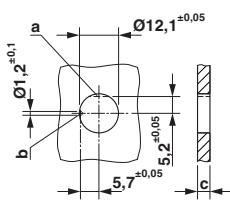

Dimensional drawing

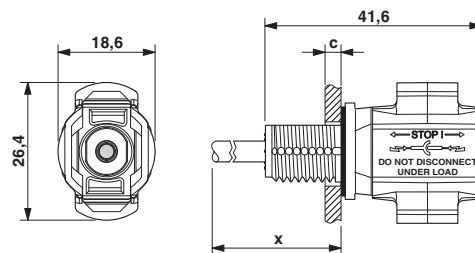

a: anti-rotation protection

b: coding

c: panel thickness - plastic: 2 - 6 mm; metal: 2 - 5 mm

Dimension x = cable length

c: panel thickness - plastic: 2 - 6 mm; metal: 2 - 5 mm

## Approvals

### Approvals

### Approvals

VDE approval of drawings / EAC / TÜV Rheinland

# Photovoltaic connector - PV-FT-CM-C-6-500-RD - 1623390

## Approvals

Ex Approvals

### Approval details

|                            |   |   |          |
|----------------------------|---|---|----------|
| VDE approval of drawings   |  | <a href="http://www2.vde.com/de/Institut/Online-Service/VDE-gepruefteProdukte/Seiten/Online-Suche.aspx">http://www2.vde.com/de/Institut/Online-Service/VDE-gepruefteProdukte/Seiten/Online-Suche.aspx</a> | 40031807 |
| Nominal voltage UN         |   | 1500 V  |          |
| Nominal current IN         |   | 40 A  |          |
| mm <sup>2</sup> /AWG/kcmil |   | 6.0   |          |

|     |   |         |
|-----|---|---------|
| EAC |  | B.00767 |
|-----|---|---------|

|                    |   |            |
|--------------------|---|------------|
| TÜV Rheinland      | <a href="http://www.certipedia.com">http://www.certipedia.com</a> | R 60126961 |
| Nominal voltage UN |   | 1500 V     |

Phoenix Contact 2018 © - all rights reserved  
<http://www.phoenixcontact.com>

PHOENIX CONTACT GmbH & Co. KG  
 Flachsmarktstr. 8  
 32825 Blomberg  
 Germany  
 Tel. +49 5235 300  
 Fax +49 5235 3 41200  
<http://www.phoenixcontact.com>