



Chipsmall Limited consists of a professional team with an average of over 10 year of expertise in the distribution of electronic components. Based in Hongkong, we have already established firm and mutual-benefit business relationships with customers from,Europe,America and south Asia,supplying obsolete and hard-to-find components to meet their specific needs.

With the principle of “Quality Parts,Customers Priority,Honest Operation,and Considerate Service”,our business mainly focus on the distribution of electronic components. Line cards we deal with include Microchip,ALPS,ROHM,Xilinx,Pulse,ON,Everlight and Freescale. Main products comprise IC,Modules,Potentiometer,IC Socket,Relay,Connector.Our parts cover such applications as commercial,industrial, and automotives areas.

We are looking forward to setting up business relationship with you and hope to provide you with the best service and solution. Let us make a better world for our industry!



Contact us

Tel: +86-755-8981 8866 Fax: +86-755-8427 6832

Email & Skype: info@chipsmall.com Web: www.chipsmall.com

Address: A1208, Overseas Decoration Building, #122 Zhenhua RD., Futian, Shenzhen, China



LOC		DIST		REVISIONS			
AD	00	P	LTB	DESCRIPTION	DATE	DWN	APVD
		A		DRAWN	11APR2011	RKC	JE

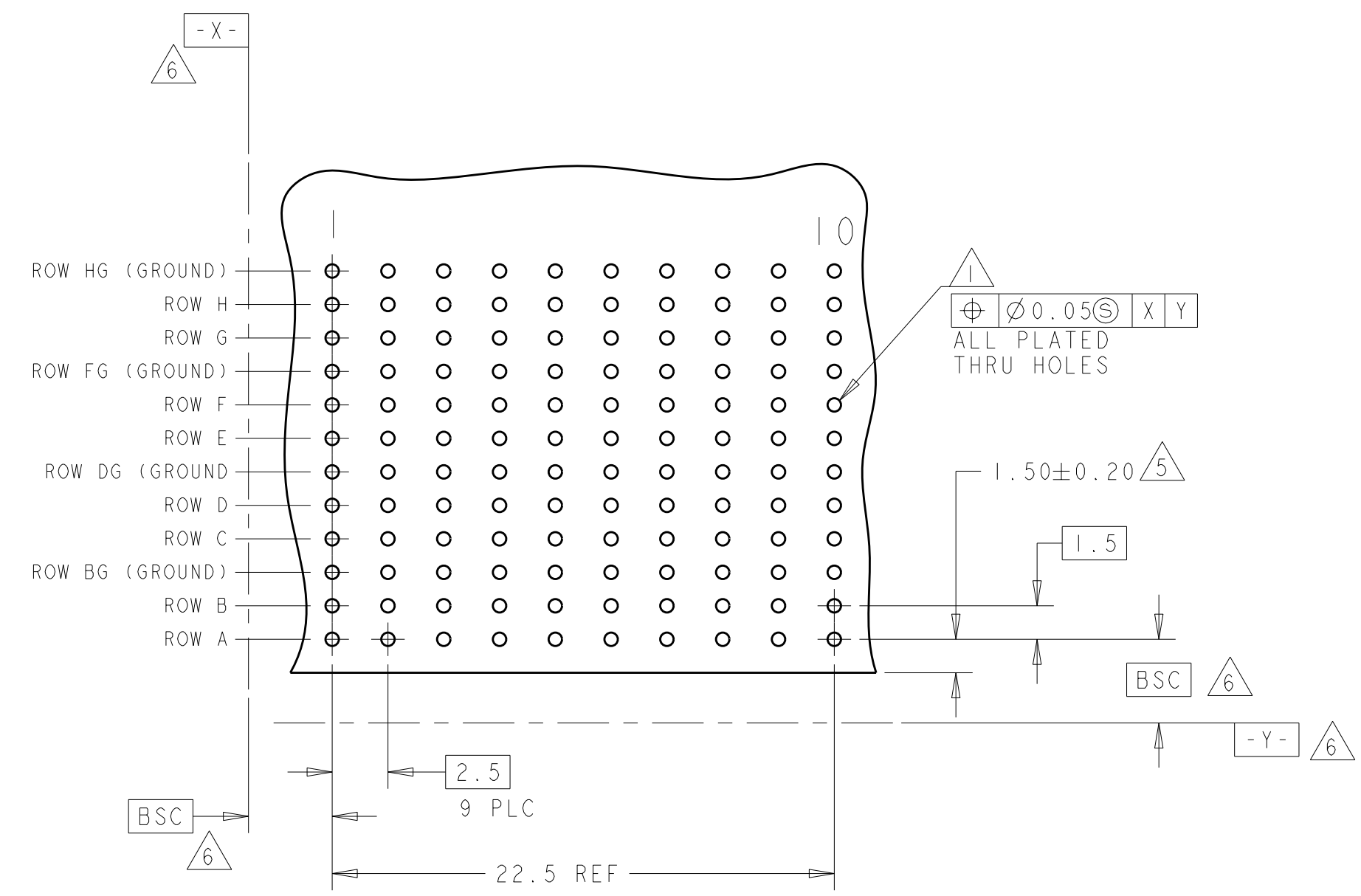
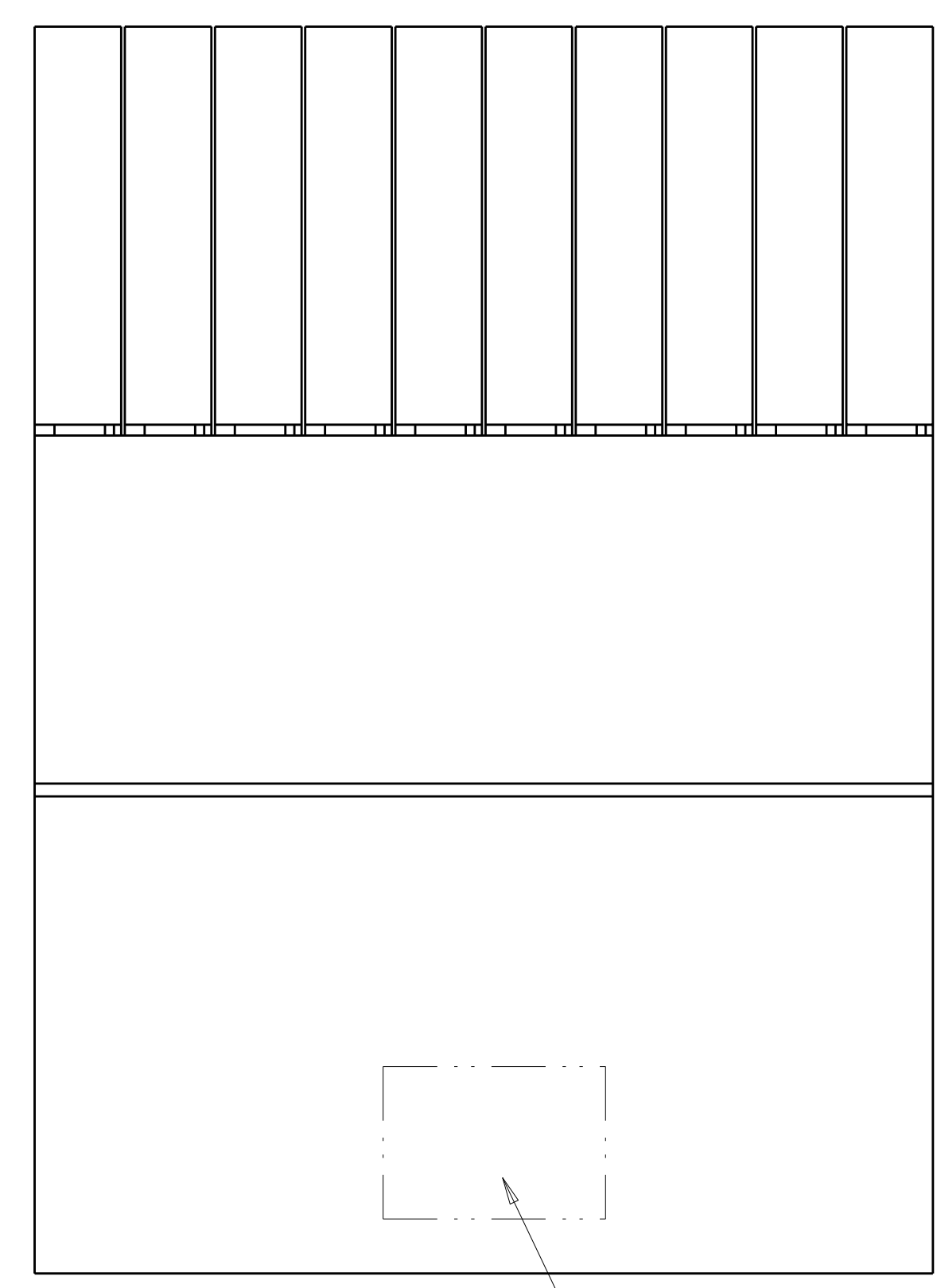

RECOMMENDED PC BOARD LAYOUT
 COMPONENT SIDE SHOWN
 SCALE 4:1

- 1. REFERENCE APPLICATION SPEC 114-13059 FOR RECOMMENDED PLATED THRU HOLE DIAMETER AND PLATING THICKNESSES.
- 2. MATERIAL:
 CONTACT & SHIELD - PHOSPHOR BRONZE
 HOUSING & CHICKLET - GLASS FILLED POLYESTER
- 3. FINISH:
 CONTACT & SHIELD - 0.76µm MIN GOLD OVER 1.27µm MIN NICKEL IN MATING AREA, 0.5µm MIN TIN OVER 1.27µm MIN NICKEL IN COMPLIANT PIN AREA.
- 4. CONNECTOR MARKED WITH PART NUMBER AND DATE CODE IN APPROXIMATE AREA SHOWN
- 5. DIMENSION APPLIES TO CENTERLINE OF THRU HOLE
- 6. DATUMS AND BASIC DIMENSIONS ESTABLISHED BY CUSTOMER
- 7. CONTACT AREA LUBRICATED WITH BELLCORE APPROVED LUBRICANT. TECHNICAL REFERENCE: GR-1217-CORE, ISSUE 1, NOVEMBER 1995

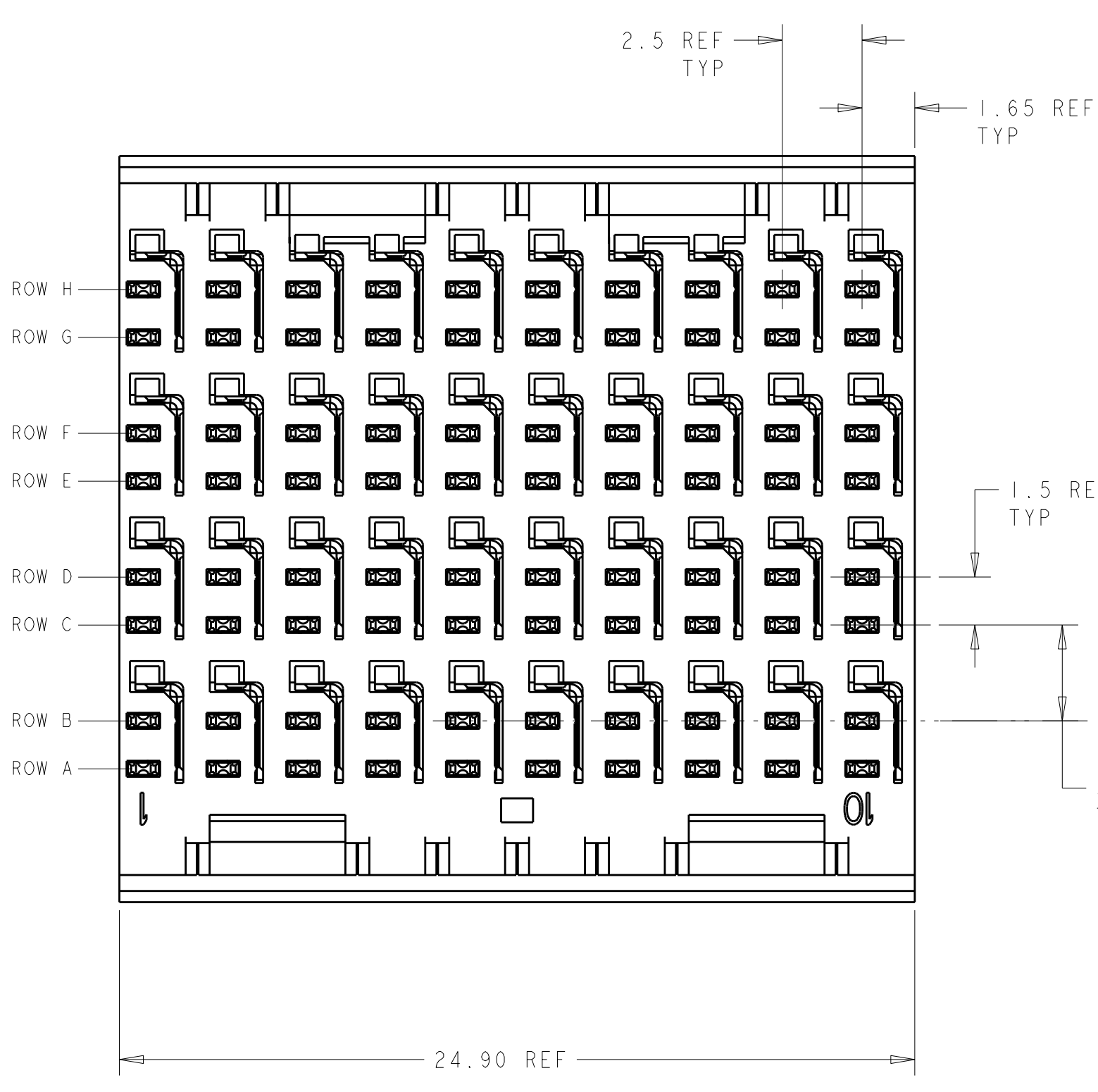

TOP SURFACE OF DAUGHTER CARD

CONTACT LAYOUT	
A	= 3.80mm (DIM N)
B	= 5.30mm (DIM N)
G	= GROUND
ROWS	COLUMNS
	I 2 3 4 5 6 7 8 9 10
	HF G G G G G G G G G G
	H B B B B B B B B B B
	G B B B B B B B B B B
	FG G G G G G G G G G G
	F B B B B B B B B B B
	E B B B B B B B B B B
	DG G G G G G G G G G G
	D B B B B B B B B B B
C A B B B B B B B B B	
BG G G G G G G G G G G	
B B B B B B B B B B B	
A B B B B B B B B B B	

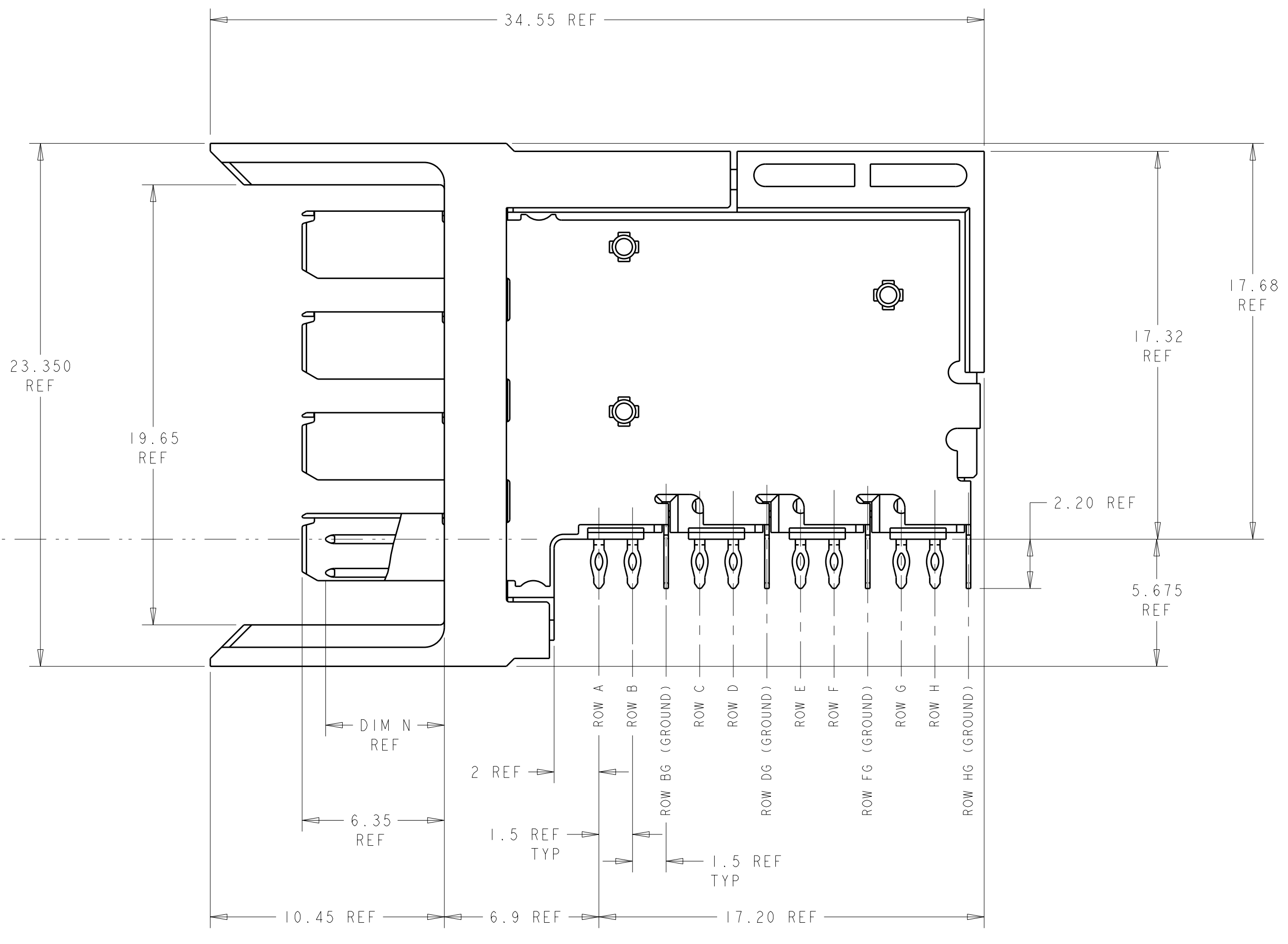

1645601-1
 PART NUMBER

DIMENSIONS: mm		TOLERANCES UNLESS OTHERWISE SPECIFIED: 9 PLC ± 1 PLC ± 5 PLC ± 4 PLC ± ANGLES ±		DWN R. K. COELLO 25JUN2004 CHK J. EARY 25JUN2004 APVD		Tyco Electronics Harrisburg, PA 17105-3608	
MATERIAL: 2		FINISH: 3		PRODUCT SPEC: - APPLICATION SPEC: - WEIGHT: - CUSTOMER DRAWING		NAME: HEATER ASSEMBLY, RIGHT ANGLE, 4 PAIR, HMZd SIZE: A1 CAGE CODE: 00779 DRAWING NO: 1645601 SHEET 1 OF 1 REV A	