



Chipsmall Limited consists of a professional team with an average of over 10 year of expertise in the distribution of electronic components. Based in Hongkong, we have already established firm and mutual-benefit business relationships with customers from,Europe,America and south Asia,supplying obsolete and hard-to-find components to meet their specific needs.

With the principle of “Quality Parts,Customers Priority,Honest Operation,and Considerate Service”,our business mainly focus on the distribution of electronic components. Line cards we deal with include Microchip,ALPS,ROHM,Xilinx,Pulse,ON,Everlight and Freescale. Main products comprise IC,Modules,Potentiometer,IC Socket,Relay,Connector.Our parts cover such applications as commercial,industrial, and automotives areas.

We are looking forward to setting up business relationship with you and hope to provide you with the best service and solution. Let us make a better world for our industry!



## Contact us

Tel: +86-755-8981 8866 Fax: +86-755-8427 6832

Email & Skype: [info@chipsmall.com](mailto:info@chipsmall.com) Web: [www.chipsmall.com](http://www.chipsmall.com)

Address: A1208, Overseas Decoration Building, #122 Zhenhua RD., Futian, Shenzhen, China



2		1				
LOC	DIST	REVISIONS				
H	-	P	LTR	DESCRIPTION	DATE	APVD
			C3	REVISED PER ECO-12-021315	10JAN2012	KH

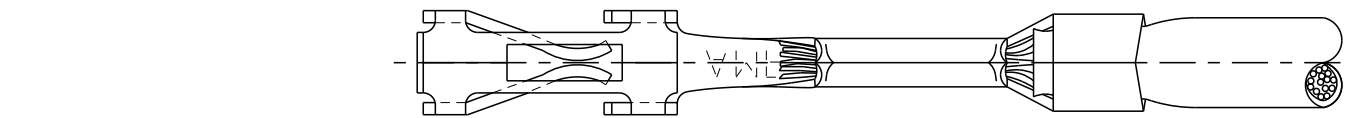

0,25 MAX.  
CUT-OFF

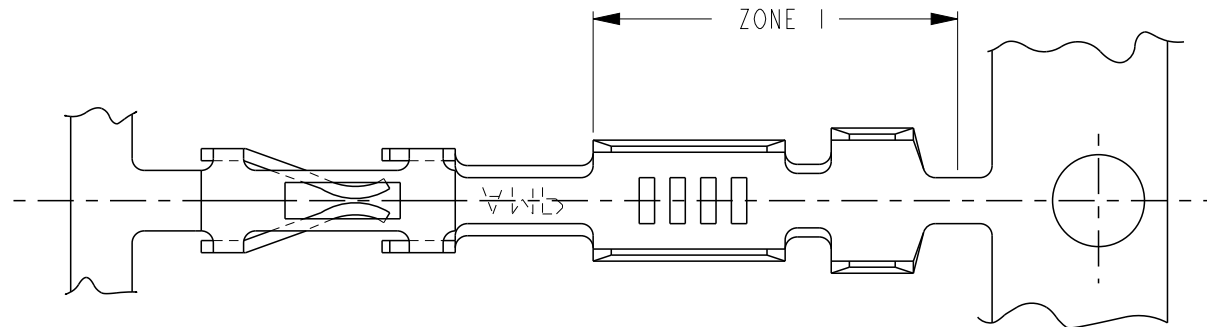
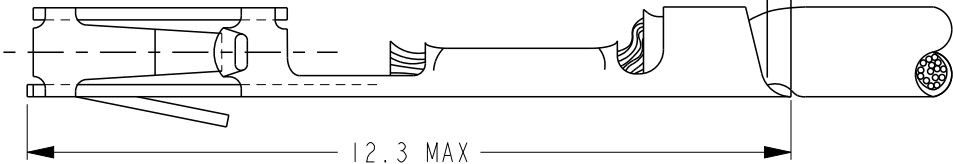

- 1
- FOR MINI-APPLICATOR-CRIMPING.
- 2
- UNDERCOATING:1,25μm Ni,SELECTIVE:0,8μm Au, NO GOLDFLASH.
- 3
- UNDERCOATING:1,25μm Ni,SELECTIVE:0,8μm Au, REMAINDER:GOLDFLASH.
- 4
- PRE-TINPLATED:2,0μm.
- 5
- ZONE 1:MATT TIN PLATED.
- 6
- MATERIAL:PHOSPHORBRONZE
- 7
- FOR REELFED-HANDTOOL-CRIMPING, 500 CONTACTS ON A SMALL REEL.
- 8
- 24-20 AWG (0,20-0,56 mm<sup>2</sup>) WITH .055 CRIMPER.  
26 AWG (0,12-0,14 mm<sup>2</sup>) WITH .042 CRIMPER.
- 9
- OBSOLETE PARTS: OBSOLETE CIS STREAMLINING PER D.RENAUD/D.SINISI

WIRE RANGE
8
INSUL. RANGE
1,4 MAX. DIA.

TIN	4	166310-3	5-166309-3	7
GOLD	3	166310-2	5-166309-2	7
GOLD	25	166310-1	5-166309-1	7
TIN	4	166310-3	166309-3	1
GOLD	3	166310-2	166309-2	1
GOLD	25	166310-1	166309-1	1
FINISH		LOOSE PIECE		PARTNUMBER

THIS DRAWING IS A CONTROLLED DOCUMENT.

DIMENSIONS:  
mm

MATERIAL

-

TOLERANCES UNLESS OTHERWISE SPECIFIED:

0 PLC ±  
1 PLC ±  
2 PLC ±  
3 PLC ±  
4 PLC ±  
ANGLES ±  
FINISH SEE TABLE

DWN  
Rv HEUVEN  
25JUNE07

CHK  
MvD  
25JUNE07

APVD  
MvD

PRODUCT SPEC  
-

APPLICATION SPEC  
-

WEIGHT  
-

CUSTOMER DRAWING

TE Connectivity

AMPMODU MOD. V  
RECEPTACLE,  
HIGH PRESSURE, STRIP.

SIZE  
A3

CAGE CODE  
00779

DRAWING NO  
C-166309

RESTRICTED TO  
-

SCALE  
NTS

SHEET  
1

OF  
1

REV  
C3