



Chipsmall Limited consists of a professional team with an average of over 10 year of expertise in the distribution of electronic components. Based in Hongkong, we have already established firm and mutual-benefit business relationships with customers from,Europe,America and south Asia,supplying obsolete and hard-to-find components to meet their specific needs.

With the principle of “Quality Parts,Customers Priority,Honest Operation,and Considerate Service”,our business mainly focus on the distribution of electronic components. Line cards we deal with include Microchip,ALPS,ROHM,Xilinx,Pulse,ON,Everlight and Freescale. Main products comprise IC,Modules,Potentiometer,IC Socket,Relay,Connector.Our parts cover such applications as commercial,industrial, and automotives areas.

We are looking forward to setting up business relationship with you and hope to provide you with the best service and solution. Let us make a better world for our industry!



Contact us

Tel: +86-755-8981 8866 Fax: +86-755-8427 6832

Email & Skype: info@chipsmall.com Web: www.chipsmall.com

Address: A1208, Overseas Decoration Building, #122 Zhenhua RD., Futian, Shenzhen, China



Series HA



Series HA

Series HA 3 - 48 pole Screw connection

- Screw clamp termination
- Pole numbers: 3, 4, 10, 16, 32, 48

Note:

The 3-pole connector is a 4-pole connector with 3 poles assembled;
32-pole connectors are composed of two 16-pole inserts numbered 1-16 and 17-36;
48-pole connectors are composed of three 16-pole inserts numbered 1-16, 17-32 and 33-48.

Series HA

Technical data

| Series HA | |
|--|--|
| Standards | DIN VDE 0627 DIN VDE 0110 |
| Approvals | |
| Inserts | |
| No. of poles | 3, 4, 10, 16, 32, 48 (+ PE) |
| Rated current | |
| - 3 + 4 pole | 10 A max. |
| - 10 - 48 pole | 16 A max. |
| Insulation group | C |
| Rated voltage (VDE 110/1.89) | |
| - 3 + 4 pole | 400 V |
| - 10 - 48 pole | 250 V |
| Rated impulse voltage HA10, HA16 | 4 kV |
| Pollution degree HA10,HA16 | 3 |
| Contact resistance HA3 | 10 ¹⁵ Ohmcm |
| Contact resistance HA4,HA10,HA16 | 10 ¹³ Ohmcm |
| Material | PC glass-fibre reinforced (UL listed) |
| Temperature range | -40° ... + 125° C |
| Flammability | |
| class acc. UL 94 | V-0 |
| Mechanical durability insertion frequency Ag | ≤ 100 |
| Rated voltage aa. UL / CSA | 600 V |
| Connection method: HA - inserts | Screw connection |

Contacts

| | |
|---------------------------------|-----------------|
| Material | Copper alloy |
| Plating | 3 mm Ag |
| Through resistance HA - inserts | ≤1.5 - 4.0 mOhm |
| Clamping range | |
| mm ² | 0.5 - 2.5 |
| AWG | 22 ... 14 |
| Torque | 0.5 Nm |
| Insulating stripping length | |
| 3 + 4-pole | 6.0 mm |
| 10 - 48-pole | 7.0 mm |

Hoods and Housing

| | |
|--|-------------------------------|
| Material | |
| Group size 1 | Die cast zinc / thermoplastic |
| Group size 2 -12 | Aluminium die cast AL-Si 12 |
| Flammability class acc. UL 94 (Group size 1 in thermoplastic) | V-0 |
| Surface | Powder coating, grey |
| Locking | |
| - Standard | Steel, zinc plated |
| Gasket | NBR |
| Temperature range | -40° ... + 125° C |
| Protection class i.a.w DIN when locked | |
| 3 + 4-pole | IP 54 |
| 10 - 48-pole | IP 65 |

Derating curves

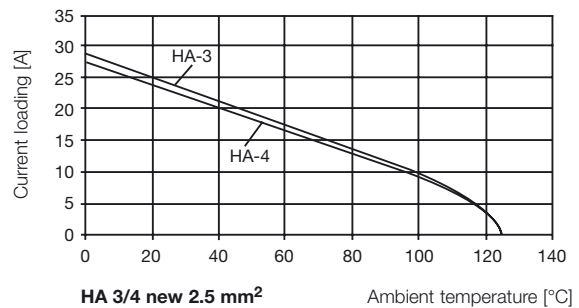
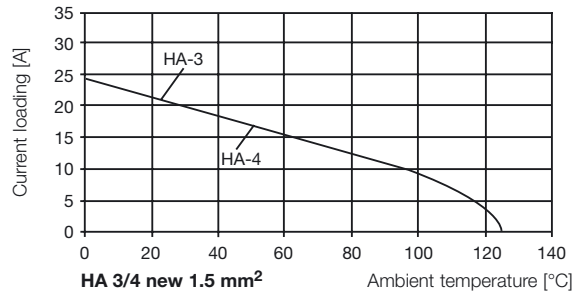
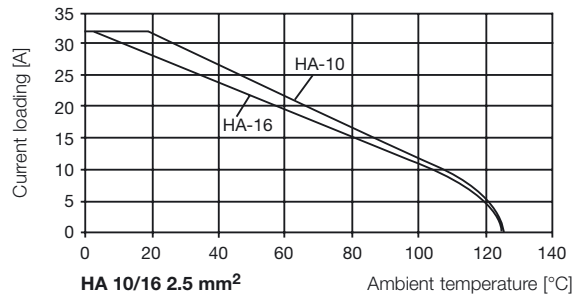
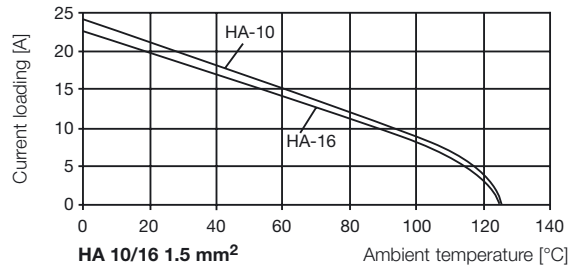

Inserts Group Size 1

New

New

Screw connection HA-3

3-pole + PE

400 V-/max. 10 A

Screw connection HA-4

4-pole + PE

400 V-/max. 10 A

Series HA

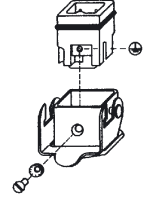
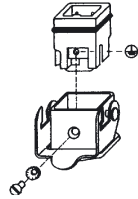
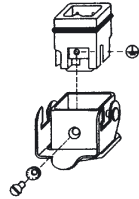
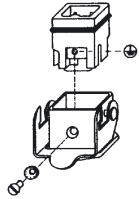

| Version | Type | Cat. No. | Qty. |
|---------|------------|------------|------|
| Male | HDC-HA-3SS | 1498100000 | 10 |
| Female | HDC-HA-3BS | 1498200000 | 10 |

| Version | Type | Cat. No. | Qty. |
|---------|------------|------------|------|
| Male | HDC-HA-4SS | 1498300000 | 10 |
| Female | HDC-HA-4BS | 1498400000 | 10 |

For accessories see section "Accessories"

For accessories see section "Accessories"

Mounting instructions HA-3 and HA-4 male / female inserts

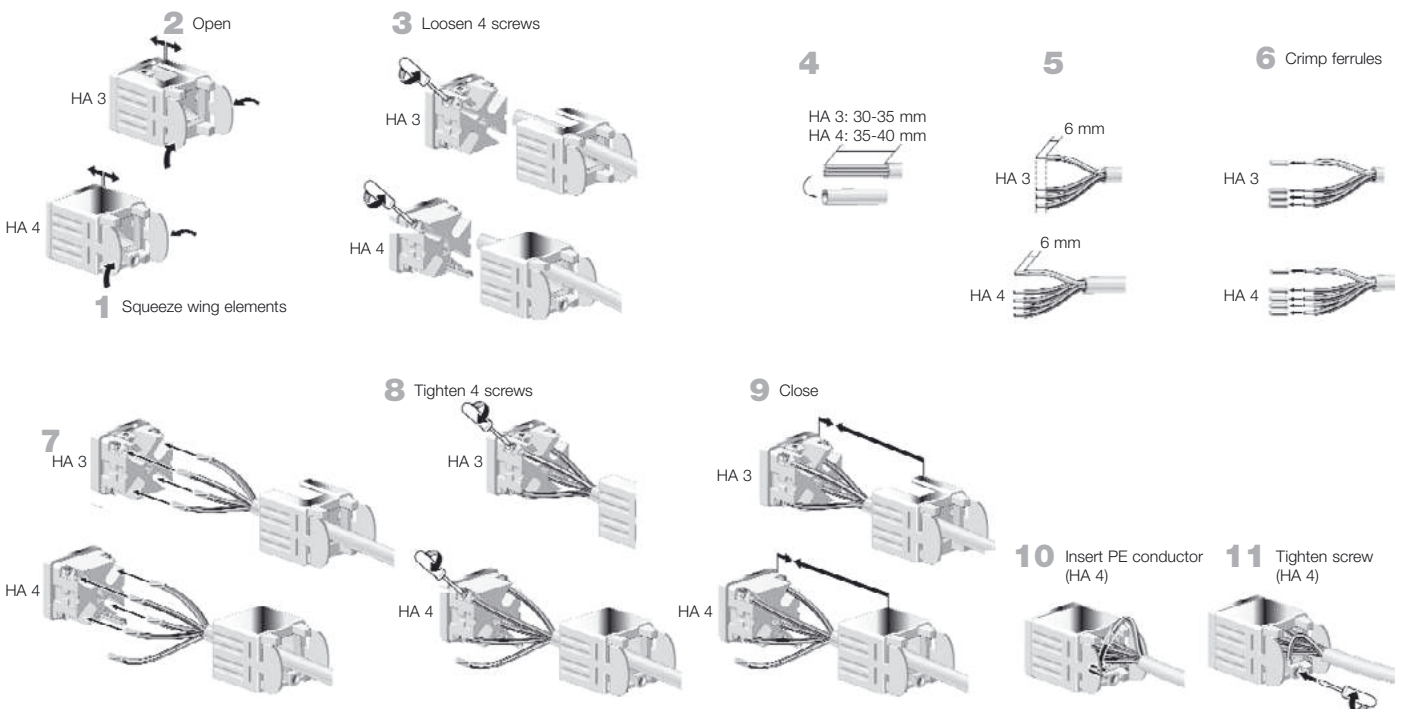

Housings Group Size 1

Plug hood HA-3/HAD-7

End locking / lower side



TOVL

Dimensions

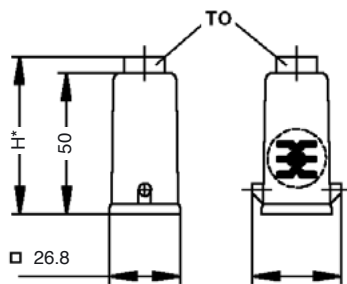

H* M = 50
PG, Metal = 57
PG, Plastic = 62

HAD=36
HA=33.5

| Version | Type | Cat. No. | Qty. |
|---------------------------------------|----------------------|------------|------|
| Plastic housing, metric thread | | | |
| 1 x M 20 thread | HDC HAD7 TOVL 1xM20G | 1788520000 | 10 |
| Plastic housing, PG thread | | | |
| 1 x Pg 11 complete | HDC-HAD-7-TOVL1/11P | 1652370000 | 10 |
| 1 x Pg 11 sleeve | HDC-HAD-7-TOVL1/11 | 1652380000 | 10 |
| Metal housing, metric thread | | | |
| 1 x M 20 thread | HDC HA3 TOVL 1xM20G | 1788820000 | 10 |
| Metal housing, PG thread | | | |
| 1 x Pg 11 complete | HDC-HA-3-TOVL1/11P | 1498500000 | 10 |
| 1 x Pg 11 sleeve | HDC-HA-3-TOVL1/11 | 1652470000 | 10 |

TOVL = Plug hood; Top cable entry, end locking
HAD-7 = Plastic housing
HA-3 = Metal housing

Plug hood HA-3/HAD-7

End locking / lower side



TWVL

Dimensions

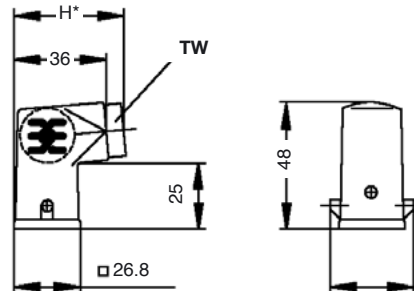

H* M = 36
PG, Metal = 43
PG, Plastic = 48

HAD=36
HA=33.5

| Version | Type | Cat. No. | Qty. |
|---------------------------------------|----------------------|------------|------|
| Plastic housing, metric thread | | | |
| 1 x M 20 thread | HDC HAD7 TWVL 1xM20G | 1788510000 | 10 |
| Plastic housing, PG thread | | | |
| 1 x Pg 11 complete | HDC-HAD-7-TWVL1/11P | 1652390000 | 10 |
| 1 x Pg 11 sleeve | HDC-HAD-7-TWVL1/11 | 1652400000 | 10 |
| Metal housing, metric thread | | | |
| 1 x M 20 thread | HDC HA3 TWVL 1xM20G | 1788810000 | 10 |
| Metal housing, PG thread | | | |
| 1 x Pg 11 complete | HDC-HA-3-TWVL1/11P | 1498600000 | 10 |
| 1 x Pg 11 sleeve | HDC-HA-3-TWVL1/11 | 1652480000 | 10 |

TWVL = Plug hood angled, end locking
HAD-7 = Plastic housing
HA-3 = Metal housing

Base housing HA-3/HAD-7

End locking



SVL

Dimensions

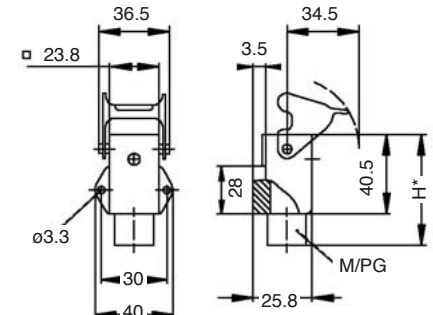

H* M = 40.5
PG, Metal = 57
PG, Plastic = 62

| Version | Type | Cat. No. | Qty. |
|---------------------------------------|---------------------|------------|------|
| Plastic housing, metric thread | | | |
| 1 x M 20 thread | HDC HAD7 SVL 1xM20G | 1788530000 | 10 |
| Plastic housing, PG thread | | | |
| 1 x Pg 11 complete | HDC-HAD-7-SVL1/11P | 1652430000 | 10 |
| 1 x Pg 11 sleeve | HDC-HAD-7-SVL1/11 | 1652440000 | 10 |
| Metal housing, metric thread | | | |
| 1 x M 20 sleeve | HDC HA3 SVL 1xM20 | 1788830000 | 10 |
| Metal housing, PG thread | | | |
| 1 x Pg 11 complete | HDC-HA-3-SVL1/11P | 1497800000 | 10 |
| 1 x Pg 11 sleeve | HDC-HA-3-SVL1/11 | 1652490000 | 10 |

SVL = Base housing, end locking
HAD-7 = Plastic housing
HA-3 = Metal housing

For accessories see section "Accessories"

Housings Group Size 1

Coupling hood HA-3/HAD-7

End locking



KVL

Dimensions

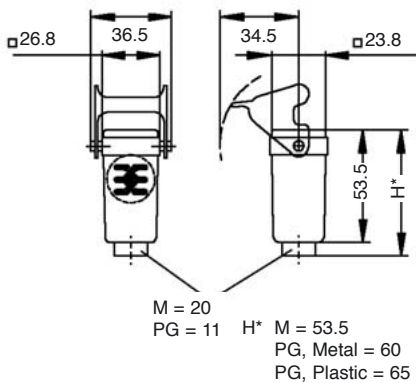

| Version | Type | Cat. No. | Qty. |
|---------------------------------------|---------------------|------------|------|
| Plastic housing, metric thread | | | |
| 1 x M 20 thread | HDC HAD7 KVL 1xM20G | 1788540000 | 10 |
| Plastic housing, PG thread | | | |
| 1 x Pg 11 complete | HDC-HAD-7-KVL1/11P | 1652450000 | 10 |
| 1 x Pg 11 sleeve | HDC-HAD-7-KVL1/11 | 1652460000 | 10 |
| Metal housing, metric thread | | | |
| 1 x M 20 thread | HDC HA3 KVL 1xM20G | 1788840000 | 10 |
| Metal housing, PG thread | | | |
| 1 x Pg 11 complete | HDC-HA-3-KVL1/11P | 1497900000 | 10 |
| 1 x Pg 11 sleeve | HDC-HA-3-KVL1/11 | 1652500000 | 10 |

KVL = Coupling hood, end locking
HAD-7 = Plastic housing
HA-3 = Metal housing

Bulkhead housing HA-3/HAD-7

End locking



AVL

Dimensions

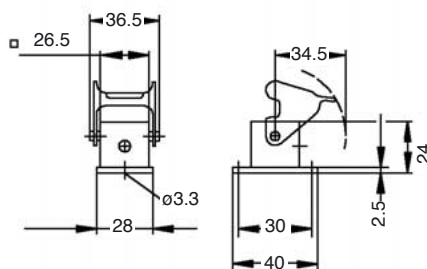

| Version | Type | Cat. No. | Qty. |
|------------------------|---------------|------------|------|
| Plastic housing | | | |
| | HDC-HAD-7-AVL | 1652410000 | 10 |
| Metal housing | | | |
| | HDC-HA-3-AVL | 1497600000 | 10 |

AVL = Bulkhead housing, end locking
HAD-7 = Plastic housing
HA-3 = Metal housing

Bulkhead housing angled HA-3/HAD-7

End locking



AWL

Dimensions

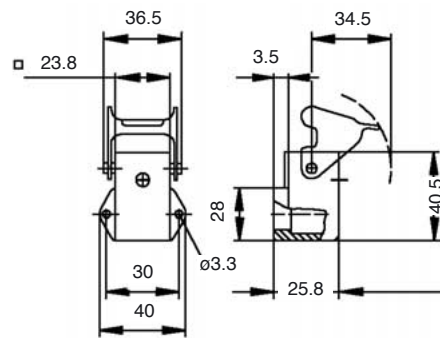

| Version | Type | Cat. No. | Qty. |
|------------------------|----------------|------------|------|
| Plastic housing | | | |
| | HDC-HAD-7-AWVL | 1652420000 | 10 |
| Metal housing | | | |
| | HDC-HA-3-AWVL | 1497700000 | 10 |

AWL = Bulkhead housing angled, end locking
HAD-7 = Plastic housing
HA-3 = Metal housing

Cover for housings with end locking

Plastic / Cover with cord

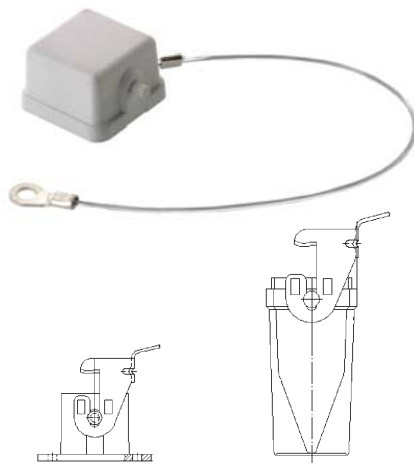

| Version / Type | Cat. No. | Qty. |
|----------------------|------------|------|
| Plastic cover | | |
| HDC-HA-3-KDBF-S | 1665760000 | 10 |
| HDC-HA-3-KDBF-B | 1665770000 | 10 |

S = Cover without sealing when using male inserts
 B = Cover without sealing when using female inserts

Metal / Cover with cord

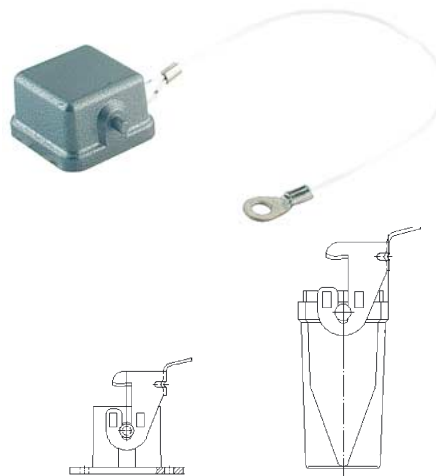

| Version / Type | Cat. No. | Qty. |
|--------------------|------------|------|
| Metal cover | | |
| HDC-HA-3-MDBF-S | 1665740000 | 10 |
| HDC-HA-3-MDBF-B | 1665750000 | 10 |

S = Cover without sealing when using male inserts
 B = Cover without sealing when using female inserts

For accessories see section "Accessories"

Inserts Group Size 2

Screw connection HA-10

10-pole

250 V-/max 16 A

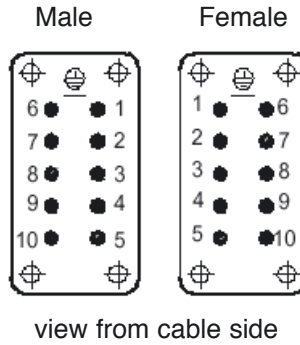
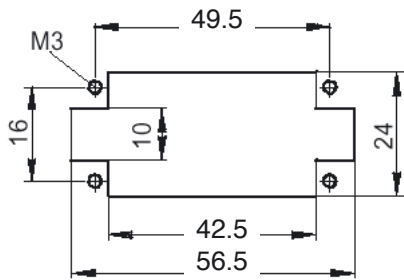
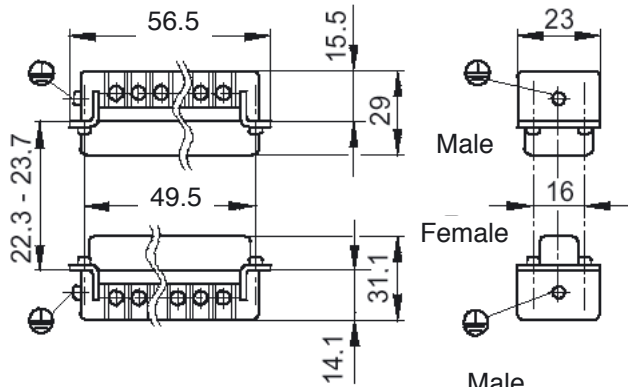

Housings Group Size 2

Plug hood HA-10

End locking / lower side



TOVL



TSVL

Dimensions

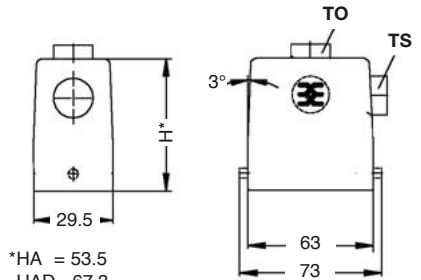

*HA = 53.5
HAD = 67.3

| Version | Type | Cat. No. | Qty. |
|---------|-------------|------------|------|
| Male | HDC-HA-10SS | 1650610000 | 5 |
| Female | HDC-HA-10BS | 1650620000 | 5 |

| Version | Type | Cat. No. | Qty. |
|---------|------|----------|------|
|---------|------|----------|------|

Standard housing, metric thread

| | | | |
|-----------------|-----------------------|------------|---|
| 1 x M 20 thread | HDC HA10 TOVL 1xM20G | 1788620000 | 5 |
| 1 x M 25 thread | HDC HA10 TOVL 1xM25G | 1788610000 | 5 |
| 1 x M 20 sleeve | HDC HA10 TSVL 1xM20 | 1788600000 | 5 |
| 1 x M 25 sleeve | HDC HA10 TSVL 1xM25 | 1788590000 | 5 |
| 1 x M 20 thread | HDC HAD15 TOVL 1xM20G | 1788880000 | 5 |
| 1 x M 25 thread | HDC HAD15 TOVL 1xM25G | 1788870000 | 5 |
| 1 x M 20 thread | HDC HAD15 TSVL 1xM20G | 1788860000 | 5 |
| 1 x M 25 thread | HDC HAD15 TSVL 1xM25G | 1788850000 | 5 |

Standard housing , PG thread

| | | | |
|-------------------|----------------------|------------|---|
| 1 x Pg16 complete | HDC-HA-10-TOVL1/16P | 1663920000 | 5 |
| 1 x Pg16 sleeve | HDC-HA-10-TOVL1/16 | 1663930000 | 5 |
| 1 x Pg16 complete | HDC-HA-10-TSVL1/16P | 1663800000 | 5 |
| 1 x Pg16 sleeve | HDC-HA-10-TSVL1/16 | 1663810000 | 5 |
| 1 x Pg16 complete | HDC-HAD-15-TOVL1/16P | 1663960000 | 5 |
| 1 x Pg21 complete | HDC-HAD-15-TOVL1/21P | 1663980000 | 5 |
| 1 x Pg21 sleeve | HDC-HAD-15-TOVL1/21 | 1663990000 | 5 |
| 1 x Pg16 complete | HDC-HAD-15-TSVL1/16P | 1663840000 | 5 |
| 1 x Pg16 sleeve | HDC-HAD-15-TSVL1/16 | 1663850000 | 5 |
| 1 x Pg21 complete | HDC-HAD-15-TSVL1/21P | 1663860000 | 5 |
| 1 x Pg21 sleeve | HDC-HAD-15-TSVL1/21 | 1663870000 | 5 |

TOVL = Plug hood; Top cable entry, end locking

TSVL = Plug hood; Side cable entry, end locking

For accessories see section "Accessories"

Housings Group Size 2

Base housing HA-10

End locking / with/without cover



SVL



SDVL

Dimensions

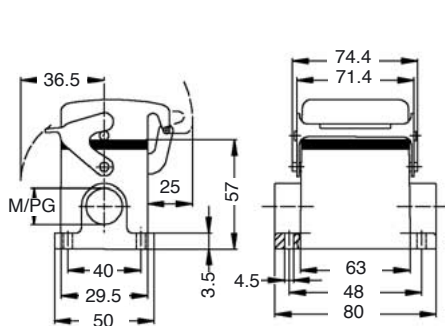

| Version | Type | Cat. No. | Qty. |
|---|----------------------|------------|------|
| Standard housing, metric thread | | | |
| 2 x M 20 thread | HDC HA10 SVL 2xM20G | 1788640000 | 5 |
| 2 x M 25 thread | HDC HA10 SVL 2xM25G | 1788630000 | 5 |
| Standard housing with cover, metric thread | | | |
| 2 x M 20 thread | HDC HA10 SDVL 2xM20G | 1788660000 | 5 |
| 2 x M 25 thread | HDC HA10 SDVL 2xM25G | 1788650000 | 5 |
| Standard housing, PG thread | | | |
| 1 x Pg16 complete | HDC-HA-10-SVL1/16P | 1664160000 | 5 |
| 1 x Pg16 sleeve | HDC-HA-10-SVL1/16 | 1664170000 | 5 |
| 1 x Pg21 complete | HDC-HA-10-SVL1/21P | 1664200000 | 5 |
| 1 x Pg21 sleeve | HDC-HA-10-SVL1/21 | 1664210000 | 5 |
| 2 x Pg16 complete | HDC-HA-10-SVL2/16P | 1664180000 | 5 |
| 2 x Pg16 sleeve | HDC-HA-10-SVL2/16 | 1664190000 | 5 |
| Standard housing with cover, PG thread | | | |
| 1 x Pg16 complete | HDC-HA-10-SDVL1/16P | 1664400000 | 5 |
| 1 x Pg16 sleeve | HDC-HA-10-SDVL1/16 | 1664410000 | 5 |
| 2 x Pg16 complete | HDC-HA-10-SDVL2/16P | 1664420000 | 5 |

SVL = Base housing, end locking
SDVL = Base housing with cover, end locking

Coupling hood HA-10 / HAD-15

End locking



KVL

Dimensions

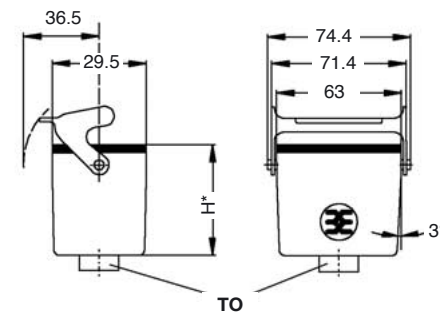

*HA = 48
HAD= 62

| Version | Type | Cat. No. | Qty. |
|--|----------------------|------------|------|
| Standard housing, metric thread | | | |
| 1 x M 25 thread | HDC HA10 KVL 1xM25G | 1788670000 | 5 |
| 1 x M 25 thread | HDC HAD15 KVL 1xM25G | 1788890000 | 2 |
| Standard housing, PG thread | | | |
| 1 x Pg16 complete | HDC-HA-10-KVL1/16P | 1664560000 | 5 |
| 1 x Pg21 complete | HDC-HAD-15-KVL1/21P | 1664620000 | 2 |
| 1 x Pg21 sleeve | HDC-HAD-15-KVL1/21 | 1664630000 | 2 |

KVL = Coupling hood, end locking

Cover for plug hood

Cover with cord

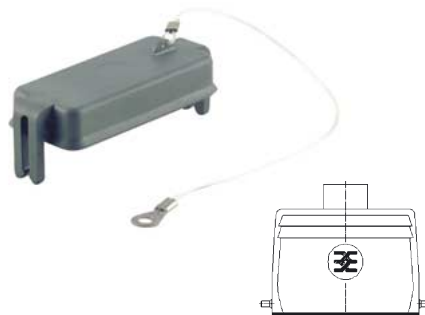

| Version / Type | Cat. No. | Qty. |
|----------------------|------------|------|
| Plastic cover | | |
| HDC-HA-10-KDF | 1665890000 | 5 |

Bulkhead housing HA-10

End locking / with/without cover



AVL



ADVL

Dimensions

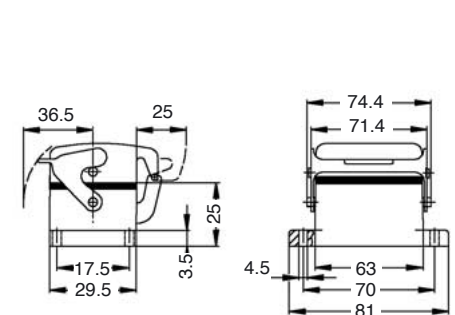

| Version | Type | Cat. No. | Qty. |
|------------------------------------|----------------|------------|------|
| Standard housing | | | |
| | HDC-HA-10-AVL | 1664040000 | 5 |
| Standard housing with cover | | | |
| | HDC-HA-10-ADVL | 1664060000 | 5 |

ADVL = Bulkhead housing with cover, end locking
AVL = Bulkhead housing, end locking

Cover for housings with end locking

Cover with cord

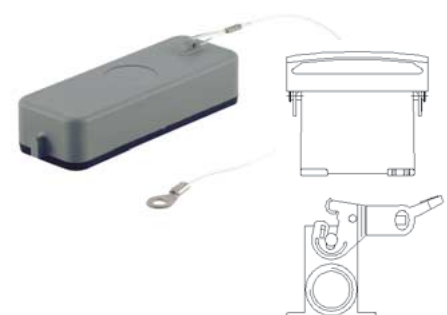

| Version / Type | Cat. No. | Qty. |
|----------------------|------------|------|
| Plastic cover | | |
| HDC-HA-10-KDBF | 1665880000 | 5 |

For accessories see section "Accessories"

Inserts Group Size 5

Housings Group Size 5

Screw connection HA-16

Plug hood HA-16 / HAD-25

16-pole

250 V-/max 16 A

End locking / lower side



TOVL

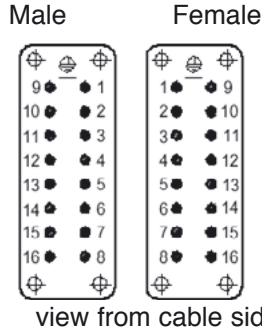
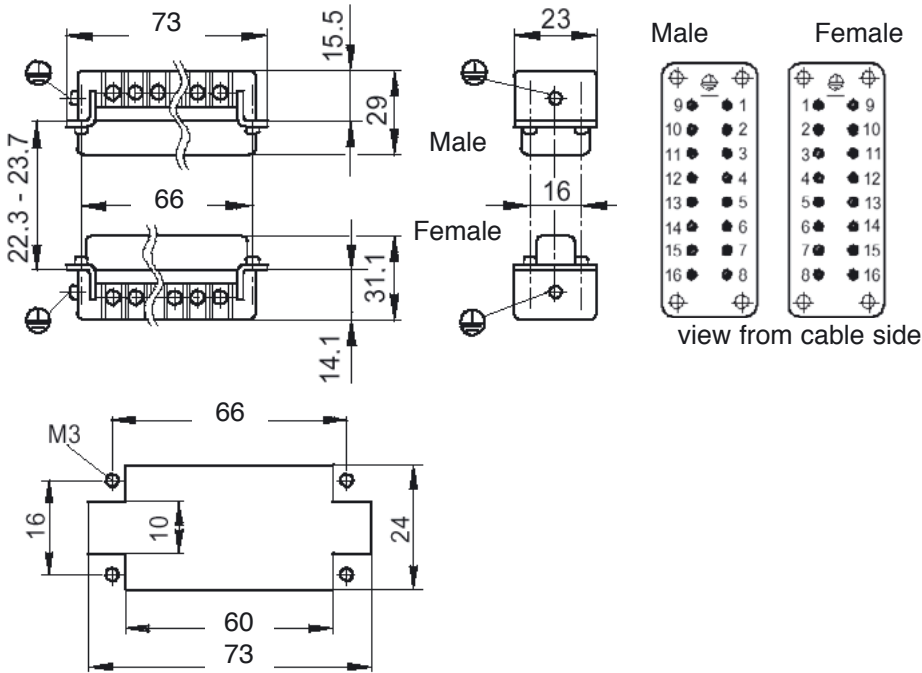

TSVL

Dimensions

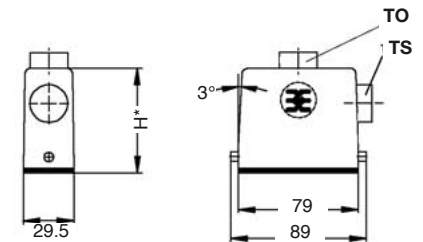

*HA = 58.3
HAD= 72.3

| Version | Type | Cat. No. | Qty. |
|---------|-------------|------------|------|
| Male | HDC-HA-16SS | 1650770000 | 5 |
| Female | HDC-HA-16BS | 1650780000 | 5 |

| Version | Type | Cat. No. | Qty. |
|---------|------|----------|------|
|---------|------|----------|------|

Standard housing, metric thread

| | | | |
|-----------------|-----------------------|------------|---|
| 1 x M 20 thread | HDC HA16 TOVL 1xM20G | 1804680000 | 5 |
| 1 x M 25 thread | HDC HA16 TOVL 1xM25G | 1788750000 | 5 |
| 1 x M 20 sleeve | HDC HA16 TSVL 1xM20 | 1804620000 | 5 |
| 1 x M 25 sleeve | HDC HA16 TSVL 1xM25 | 1788740000 | 5 |
| 1 x M 20 thread | HDC HAD25 TOVL 1xM20G | 1788710000 | 5 |
| 1 x M 25 thread | HDC HAD25 TOVL 1xM25G | 1788700000 | 5 |
| 1 x M 25 thread | HDC HAD25 TSVL 1xM25G | 1788690000 | 5 |
| 1 x M 32 thread | HDC HAD25 TSVL 1xM32G | 1788680000 | 5 |

Standard housing, PG thread

| | | | |
|-------------------|----------------------|------------|---|
| 1 x Pg16 complete | HDC-HA-16-TOVL1/16P | 1664800000 | 5 |
| 1 x Pg16 sleeve | HDC-HA-16-TOVL1/16 | 1664810000 | 5 |
| 1 x Pg16 complete | HDC-HA-16-TSVL1/16P | 1664680000 | 5 |
| 1 x Pg16 sleeve | HDC-HA-16-TSVL1/16 | 1664690000 | 5 |
| 1 x Pg16 complete | HDC-HAD-25-TOVL1/16P | 1664840000 | 5 |
| 1 x Pg16 sleeve | HDC-HAD-25-TOVL1/16 | 1664850000 | 5 |
| 1 x Pg21 complete | HDC-HAD-25-TOVL1/21P | 1664860000 | 5 |
| 1 x Pg21 sleeve | HDC-HAD-25-TOVL1/21 | 1664870000 | 5 |
| 1 x Pg16 complete | HDC-HAD-25-TSVL1/16P | 1664720000 | 5 |
| 1 x Pg16 sleeve | HDC-HAD-25-TSVL1/16 | 1664730000 | 5 |
| 1 x Pg21 complete | HDC-HAD-25-TSVL1/21P | 1664740000 | 5 |
| 1 x Pg21 sleeve | HDC-HAD-25-TSVL1/21 | 1664750000 | 5 |

TOVL = Plug hood; Top cable entry, end locking

TSVL = Plug hood; Side cable entry, end locking

For accessories see section "Accessories"

Housings Group Size 5

Base housing HA-16

End locking, with/without Cover



SVL



SDVL

Dimensions

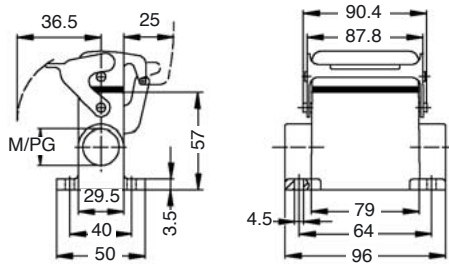

| Version | Type | Cat. No. | Qty. |
|---|----------------------|------------|------|
| Standard housing, metric thread | | | |
| 2 x M 20 thread | HDC HA16 SVL 2xM20G | 1788770000 | 2 |
| 2 x M 25 thread | HDC HA16 SVL 2xM25G | 1788760000 | 2 |
| Standard housing with cover, metric thread | | | |
| 2 x M 20 thread | HDC HA16 SDVL 2xM20G | 1788790000 | 2 |
| 2 x M 25 thread | HDC HA16 SDVL 2xM25G | 1788780000 | 2 |
| Standard housing, PG thread | | | |
| 1 x Pg16 complete | HDC-HA-16-SVL1/16P | 1665040000 | 2 |
| 1 x Pg16 sleeve | HDC-HA-16-SVL1/16 | 1665050000 | 2 |
| 1 x Pg21 complete | HDC-HA-16-SVL1/21P | 1665080000 | 2 |
| 1 x Pg21 sleeve | HDC-HA-16-SVL1/21 | 1665090000 | 2 |
| 2 x Pg16 complete | HDC-HA-16-SVL2/16P | 1665060000 | 2 |
| 2 x Pg16 sleeve | HDC-HA-16-SVL2/16 | 1665070000 | 2 |
| 2 x Pg21 complete | HDC-HA-16-SVL2/21P | 1665100000 | 2 |
| Standard housing with cover, PG thread | | | |
| 1 x Pg16 complete | HDC-HA-16-SDVL1/16P | 1665280000 | 2 |
| 2 x Pg16 complete | HDC-HA-16-SDVL2/16P | 1665300000 | 2 |

SVL = Base housing, end locking
SDVL = Base housing with cover, end locking

Coupling hood HA-16 / HAD-25

End locking



KVL

Dimensions

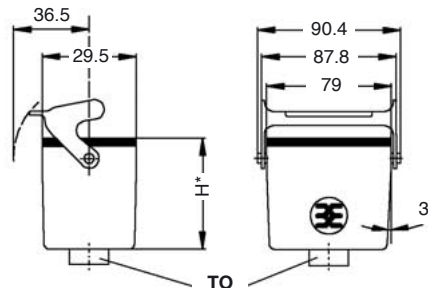

*HA = 53
HAD= 67

| Version | Type | Cat. No. | Qty. |
|--|----------------------|------------|------|
| Standard housing, metric thread | | | |
| 1 x M 25 thread | HDC HA16 KVL 1xM25G | 1788800000 | 5 |
| 1 x M 20 thread | HDC HAD25 KVL 1xM20G | 1788730000 | 2 |
| 1 x M 25 thread | HDC HAD25 KVL 1xM25G | 1788720000 | 2 |
| Standard housing, PG thread | | | |
| 1 x Pg16 complete | HDC-HA-16-KVL1/16P | 1665440000 | 5 |
| 1 x Pg16 sleeve | HDC-HA-16-KVL1/16 | 1665450000 | 5 |
| 1 x Pg16 complete | HDC-HAD-25-KVL1/16P | 1665480000 | 2 |
| 1 x Pg21 complete | HDC-HAD-25-KVL1/21P | 1665500000 | 2 |

KVL = Coupling hood, end locking

Cover for plug hood

Cover with cord

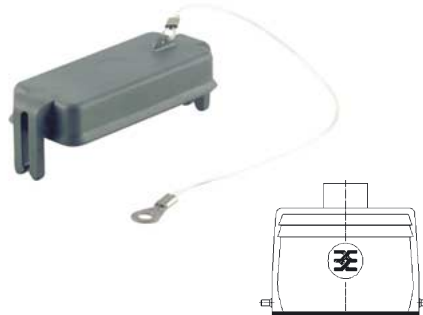

| Type | Cat. No. | Qty. |
|----------------------|------------|------|
| Plastic cover | | |
| HDC-HA-16-KDBF | 1665910000 | 5 |

Bulkhead housing HA-16

End locking / with/without Cover



AVL



ADVL

Dimensions

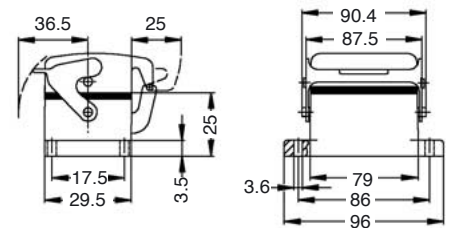

| Version | Type | Cat. No. | Qty. |
|------------------------------------|----------------|------------|------|
| Standard housing | | | |
| | HDC-HA-16-AVL | 1664920000 | 5 |
| Standard housing with cover | | | |
| | HDC-HA-16-ADVL | 1664940000 | 5 |

AVL = Bulkhead housing, end locking

ADVL = Bulkhead housing with cover, end locking

Cover for housings with end locking

Cover with cord



| Type | Cat. No. | Qty. |
|----------------------|------------|------|
| Plastic cover | | |
| HDC-HA-16-KDBF | 1665900000 | 5 |

For accessories see section "Accessories"

Inserts Group Size 7

Housings Group Size 7

Screw connection HA-32

Plug hood HA-32

32-pole

250 V-/300 V-/max 16 A

Side locking / lower side

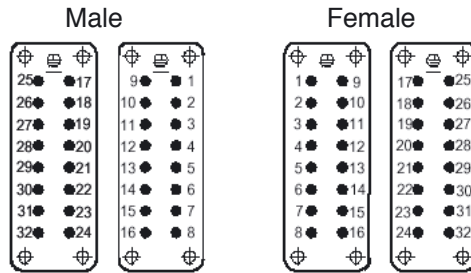
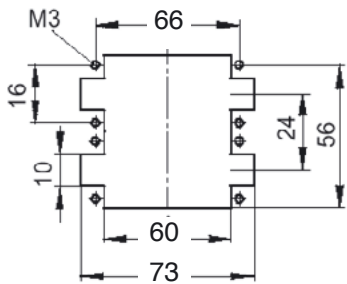
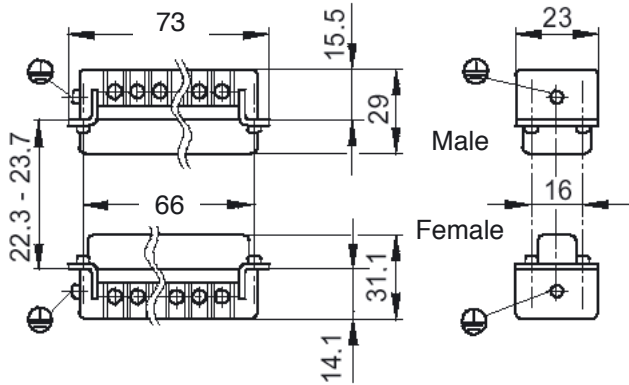

view from cable side

| Version | Type | Cat. No. | Qty. |
|---------|-------------------|------------|------|
| Male | HDC-HA-16SS | 1650770000 | 5 |
| Male | HDC-HA-16SS 17-32 | 1650880000 | 5 |
| Female | HDC-HA-16BS | 1650780000 | 5 |
| Female | HDC-HA-16BS 17-32 | 1650900000 | 5 |

Please order two inserts per housing

| Version | Type | Cat. No. | Qty. |
|--|----------------------|------------|------|
| Standard housing, metric thread | | | |
| 1 x M 25 thread | HDC HA32 TOVU 1xM25G | 1788000000 | 2 |
| 1 x M 32 thread | HDC HA32 TOVU 1xM32G | 1787990000 | 2 |
| 1 x M 25 thread | HDC HA32 TSVU 1xM25G | 1787960000 | 2 |
| 1 x M 32 thread | HDC HA32 TSVU 1xM32G | 1787950000 | 2 |
| Standard housing, PG thread | | | |
| 1 x Pg21 complete | HDC-HA-32-TOVU1/21P | 1665780000 | 2 |
| 1 x Pg21 sleeve | HDC-HA-32-TOVU1/21 | 1665790000 | 2 |
| 1 x Pg29 complete | HDC-HA-32-TOVU1/29P | 1665800000 | 2 |
| 1 x Pg29 sleeve | HDC-HA-32-TOVU1/29 | 1665810000 | 2 |
| 1 x Pg21 complete | HDC-HA-32-TSVU1/21P | 1665660000 | 2 |
| 1 x Pg21 sleeve | HDC-HA-32-TSVU1/21 | 1665670000 | 2 |
| 1 x Pg29 complete | HDC-HA-32-TSVU1/29P | 1665680000 | 2 |
| 1 x Pg29 sleeve | HDC-HA-32-TSVU1/29 | 1665690000 | 2 |



TOVU



TSVU

Dimensions

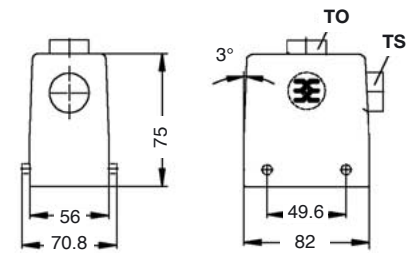

| Version | Type | Cat. No. | Qty. |
|---------|------|----------|------|
|---------|------|----------|------|

Standard housing, metric thread

| | | | |
|-----------------|----------------------|------------|---|
| 1 x M 25 thread | HDC HA32 TOVU 1xM25G | 1788000000 | 2 |
| 1 x M 32 thread | HDC HA32 TOVU 1xM32G | 1787990000 | 2 |
| 1 x M 25 thread | HDC HA32 TSVU 1xM25G | 1787960000 | 2 |
| 1 x M 32 thread | HDC HA32 TSVU 1xM32G | 1787950000 | 2 |

Standard housing, PG thread

| | | | |
|-------------------|---------------------|------------|---|
| 1 x Pg21 complete | HDC-HA-32-TOVU1/21P | 1665780000 | 2 |
| 1 x Pg21 sleeve | HDC-HA-32-TOVU1/21 | 1665790000 | 2 |
| 1 x Pg29 complete | HDC-HA-32-TOVU1/29P | 1665800000 | 2 |
| 1 x Pg29 sleeve | HDC-HA-32-TOVU1/29 | 1665810000 | 2 |
| 1 x Pg21 complete | HDC-HA-32-TSVU1/21P | 1665660000 | 2 |
| 1 x Pg21 sleeve | HDC-HA-32-TSVU1/21 | 1665670000 | 2 |
| 1 x Pg29 complete | HDC-HA-32-TSVU1/29P | 1665680000 | 2 |
| 1 x Pg29 sleeve | HDC-HA-32-TSVU1/29 | 1665690000 | 2 |

TOVU = Plug hood; Top cable entry,
Side locking / lower side

TSVU = Plug hood; Side cable entry,
side locking / lower side

For accessories see section "Accessories"

Housings Group Size 7

Base housing HA-32

Side locking



SVU

Coupling hood HA-32

Side locking



KVV

Bulkhead housing HA-32

Side locking



AVU

Dimensions

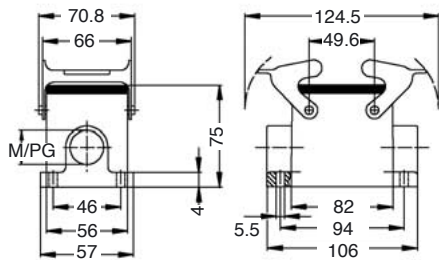

Dimensions

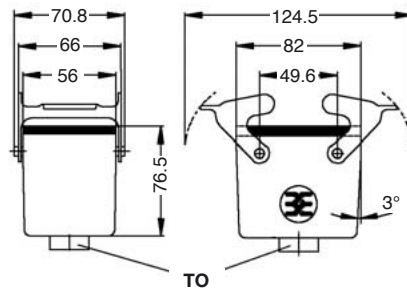

Dimensions

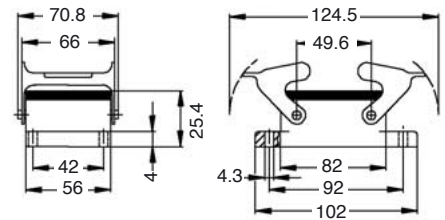

| Version | Type | Cat. No. | Qty. |
|--|---------------------|------------|------|
| Standard housing, metric thread | | | |
| 2 x M 25 thread | HDC HA32 SVU 2xM25G | 1788040000 | 2 |
| 2 x M 32 thread | HDC HA32 SVU 2xM32G | 1788030000 | 2 |
| Standard housing, PG thread | | | |
| 1 x Pg21 complete | HDC-HA-32-SVU1/21P | 1665960000 | 2 |
| 1 x Pg29 complete | HDC-HA-32-SVU1/29P | 1666000000 | 2 |
| 1 x Pg29 sleeve | HDC-HA-32-SVU1/29 | 1666010000 | 2 |
| 2 x Pg21 complete | HDC-HA-32-SVU2/21P | 1665980000 | 2 |
| 2 x Pg29 complete | HDC-HA-32-SVU2/29P | 1666020000 | 2 |

| Version | Type | Cat. No. | Qty. |
|--|---------------------|------------|------|
| Standard housing, metric thread | | | |
| 1 x M 25 thread | HDC HA32 KVV 1xM25G | 1788080000 | 2 |
| 1 x M 32 thread | HDC HA32 KVV 1xM32G | 1788070000 | 2 |
| Standard housing, PG thread | | | |
| 1 x Pg21 complete | HDC-HA-32-KVV1/21P | 1666120000 | 2 |
| 1 x Pg29 complete | HDC-HA-32-KVV1/29P | 1666140000 | 2 |

KVV = Coupling hood, side locking

| Version | Type | Cat. No. | Qty. |
|-------------------------|---------------|------------|------|
| Standard housing | | | |
| | HDC-HA-32-AVU | 1665860000 | 2 |

AVU = Bulkhead housing, side locking / lower side

Cover for plug hood

Cover with cord



| Type | Cat. No. | Qty. |
|----------------------|------------|------|
| Plastic cover | | |
| HDC-HA-32-KDF | 1665930000 | 2 |

Cover for housings with side locking

Cover with cord

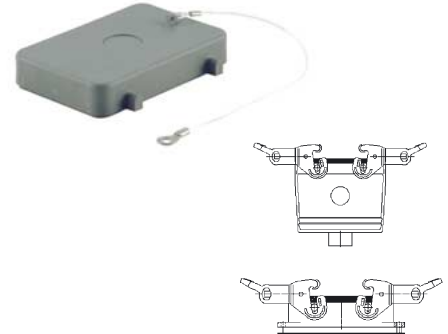

| Type | Cat. No. | Qty. |
|----------------------|------------|------|
| Plastic cover | | |
| HDC-HA-32-KDBF | 1665920000 | 2 |

SVU = Base housing, side locking / lower side

For accessories see section "Accessories"

Housings Group Size 7

Plug hood HA-32

Side locking / upper side



TOVO



TSVO

Dimensions

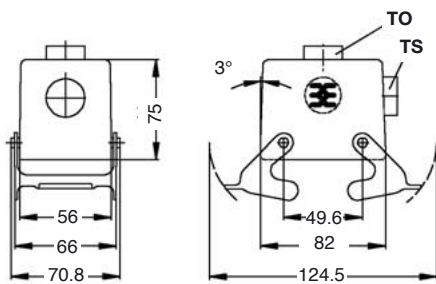

Base housing HA-32

Side locking / upper side



SDVO

Dimensions

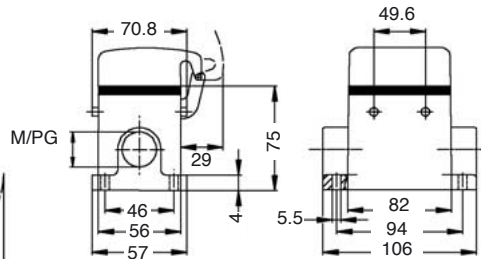

| Version | Type | Cat. No. | Qty. |
|--|----------------------|------------|------|
| Standard housing, metric thread | | | |
| 1 x M 25 thread | HDC HA32 TOVO 1xM25G | 1788020000 | 2 |
| 1 x M 32 thread | HDC HA32 TOVO 1xM32G | 1788010000 | 2 |
| 1 x M 25 thread | HDC HA32 TSVO 1xM25G | 1787980000 | 2 |
| 1 x M 32 thread | HDC HA32 TSVO 1xM32G | 1787970000 | 2 |
| Standard housing, PG thread | | | |
| 1 x Pg21 complete | HDC-HA-32-TOVO1/21P | 1666360000 | 2 |
| 1 x Pg29 complete | HDC-HA-32-TOVO1/29P | 1666380000 | 2 |
| 1 x Pg21 complete | HDC-HA-32-TSVO1/21P | 1666240000 | 2 |
| 1 x Pg29 complete | HDC-HA-32-TSVO1/29P | 1666260000 | 2 |
| 1 x Pg29 sleeve | HDC-HA-32-TSVO1/29 | 1666270000 | 2 |

| Version | Type | Cat. No. | Qty. |
|---|----------------------|------------|------|
| Standard housing with cover, metric thread | | | |
| 2 x M 25 thread | HDC HA32 SDVO 2xM25G | 1788060000 | 2 |
| 2 x M 32 thread | HDC HA32 SDVO 2xM32G | 1788050000 | 2 |
| Standard housing with cover, PG thread | | | |
| 1 x Pg21 complete | HDC-HA-32-SDVO1/21P | 1666540000 | 2 |
| 1 x Pg21 sleeve | HDC-HA-32-SDVO1/21 | 1666550000 | 2 |
| 1 x Pg29 sleeve | HDC-HA-32-SDVO1/29 | 1666590000 | 2 |

TOVO = Plug hood; Top cable entry, side locking
 TSVO = Plug hood; Side cable entry, side locking

SDVO = Base housing with cover, side locking / upper side

For accessories see section "Accessories"

Inserts Group Size 9

Screw connection HA-48

48-pole

250 V-/300 V-/max 16 A

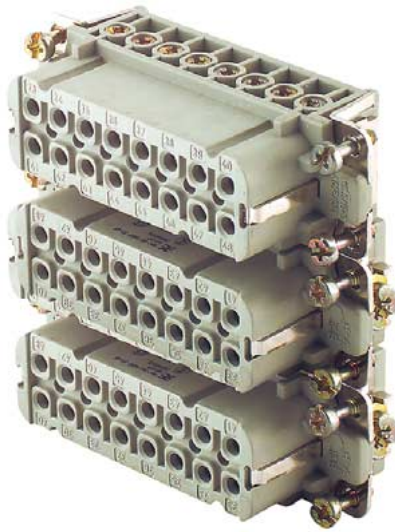
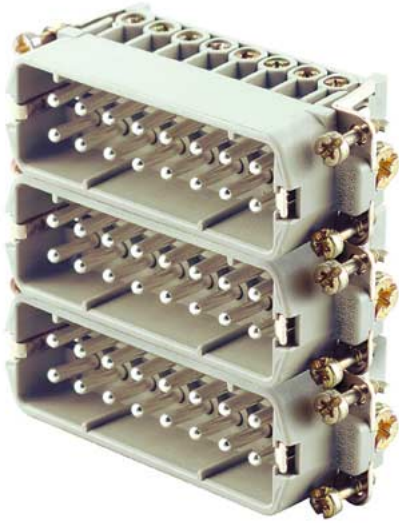

| Version | Type | Cat. No. | Qty. |
|---------|-------------------|------------|------|
| Male | HDC-HA-16SS | 1650770000 | 5 |
| Male | HDC-HA-16SS 17-32 | 1650880000 | 5 |
| Male | HDC-HA-16SS 33-48 | 1650990000 | 5 |
| Female | HDC-HA-16BS | 1650780000 | 5 |
| Female | HDC-HA-16BS 17-32 | 1650900000 | 5 |
| Female | HDC-HA-16BS 33-48 | 1651020000 | 5 |

Please order two inserts per housing

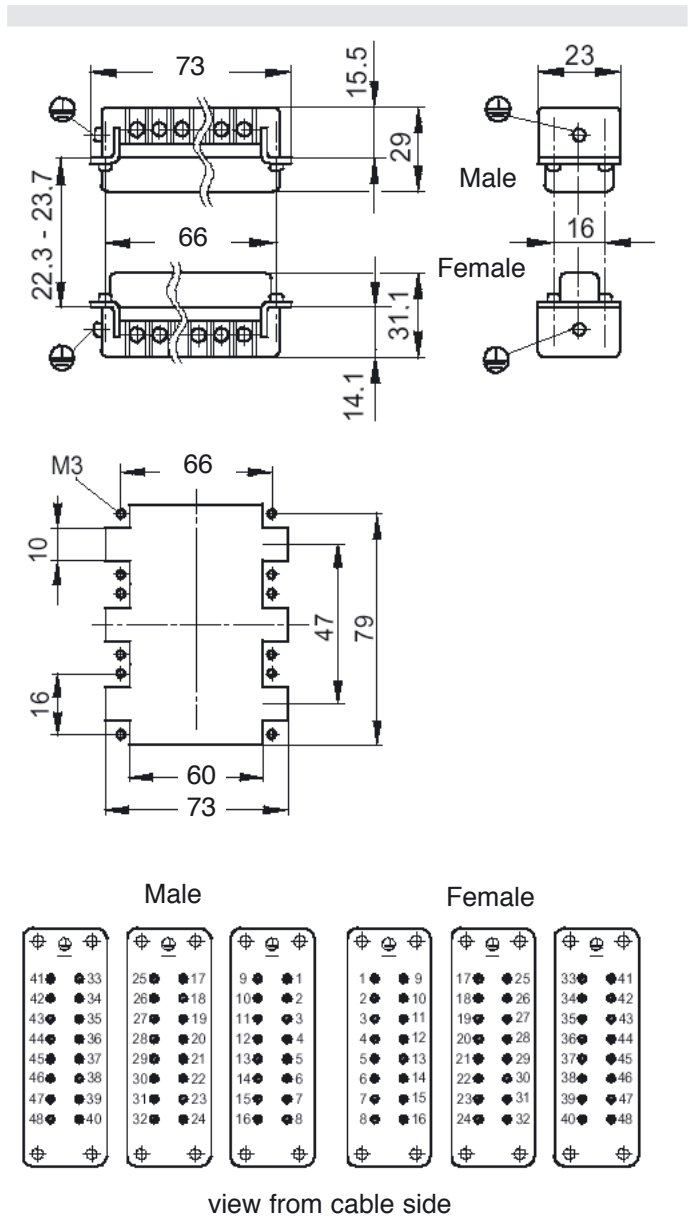

For accessories see section "Accessories"

Housings Group Size 9

Plug hood HA-48

End locking / lower side



TOVL



TSVL

Dimensions

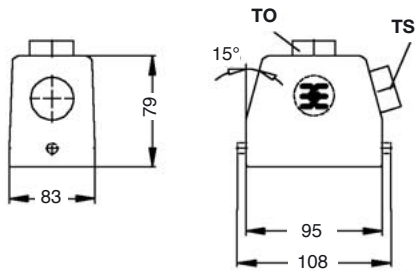

| Version | Type | Cat. No. | Qty. |
|--|----------------------|-------------------|------|
| Standard housing, metric thread | | | |
| 1 x M 32 thread | HDC HA48 TOVL 1xM32G | 1788560000 | 1 |
| 1 x M 32 thread | HDC HA48 TSVL 1xM32G | 1788550000 | 1 |
| Standard housing, PG thread | | | |
| 1 x Pg29 complete | HDC-HA-48-TOVL1/29P | 1666720000 | 1 |
| 1 x Pg29 sleeve | HDC-HA-48-TOVL1/29 | 1666730000 | 1 |
| 1 x Pg29 complete | HDC-HA-48-TSVL1/29P | 1666700000 | 1 |
| 1 x Pg29 sleeve | HDC-HA-48-TSVL1/29 | 1666710000 | 1 |

TOVL = Plug hood; Top cable entry, end locking / lower side
TSVL = Plug hood; Side cable entry, end locking / lower side

Base housing HA-48

End locking / with cover



SVL



SDVL

Dimensions

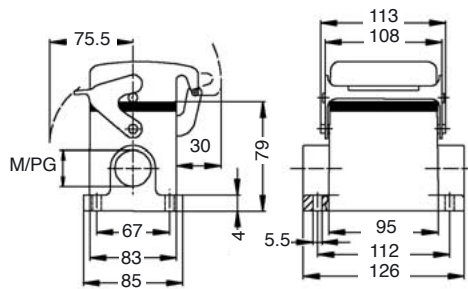

| Version | Type | Cat. No. | Qty. |
|---|----------------------|-------------------|------|
| Standard housing, metric thread | | | |
| 2 x M 32 thread | HDC HA48 SVL 2xM32G | 1788570000 | 1 |
| Standard housing with cover, metric thread | | | |
| 2 x M 32 thread | HDC HA48 SDVL 2xM32G | 1788580000 | 1 |
| Standard housing, PG thread | | | |
| 1 x Pg29 complete | HDC-HA-48-SVL1/29P | 1666760000 | 1 |
| 1 x Pg29 sleeve | HDC-HA-48-SVL1/29 | 1666770000 | 1 |
| 2 x Pg29 complete | HDC-HA-48-SVL2/29P | 1666780000 | 1 |
| Standard housing with cover, PG thread | | | |
| 1 x Pg29 complete | HDC-HA-48-SDVL1/29P | 1666800000 | 1 |
| 1 x Pg29 sleeve | HDC-HA-48-SDVL1/29 | 1666810000 | 1 |
| 2 x Pg29 complete | HDC-HA-48-SDVL2/29P | 1666820000 | 1 |
| 2 x Pg29 sleeve | HDC-HA-48-SDVL2/29 | 1666830000 | 1 |

SVL = Base housing, end locking
SDVL = Base housing with cover, end locking

Bulkhead housing HA-48

End locking / with cover



AVL



ADVL

Dimensions

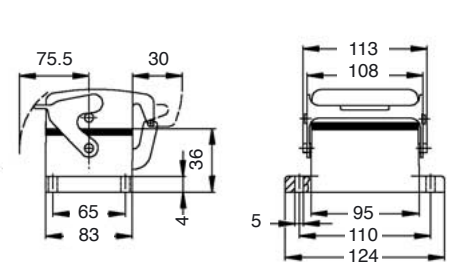

| Version | Type | Cat. No. | Qty. |
|------------------------------------|----------------|-------------------|------|
| Standard housing | | | |
| sleeve | HDC-HA-48-AVL | 1666740000 | 1 |
| Standard housing with cover | | | |
| sleeve | HDC-HA-48-ADVL | 1666750000 | 1 |

AVL = Bulkhead housing, end locking
ADVL = Bulkhead housing with cover, end locking

For accessories see section "Accessories"

