



Chipsmall Limited consists of a professional team with an average of over 10 year of expertise in the distribution of electronic components. Based in Hongkong, we have already established firm and mutual-benefit business relationships with customers from,Europe,America and south Asia,supplying obsolete and hard-to-find components to meet their specific needs.

With the principle of “Quality Parts,Customers Priority,Honest Operation,and Considerate Service”,our business mainly focus on the distribution of electronic components. Line cards we deal with include Microchip,ALPS,ROHM,Xilinx,Pulse,ON,Everlight and Freescale. Main products comprise IC,Modules,Potentiometer,IC Socket,Relay,Connector.Our parts cover such applications as commercial,industrial, and automotives areas.

We are looking forward to setting up business relationship with you and hope to provide you with the best service and solution. Let us make a better world for our industry!



## Contact us

Tel: +86-755-8981 8866 Fax: +86-755-8427 6832

Email & Skype: info@chipsmall.com Web: www.chipsmall.com

Address: A1208, Overseas Decoration Building, #122 Zhenhua RD., Futian, Shenzhen, China



NOTES:

- 1 FOR MINI-APPLICATOR-CRIMPING.
- 2 UNDERCOATING:1,25µm Ni,SELECTIVE:0,8µm Au, ZONE 1: 0,5µm MIN. GOLDFLASH.
- 3 UNDERCOATING:1,25µm Ni,SELECTIVE:0,8µm Au, REMAINDER:GOLDFLASH.
- 4 UNDERCOATING:1,25µm Ni,SELECTIVE:0,4µm Au, NO GOLDFLASH.
- 5 UNDERCOATING:1,25µm Ni,SELECTIVE:2,0µm Au, REMAINDER:GOLDFLASH.
- 6 PRE-TINPLATED:2,0µm.
- 7 ZONE 1:BRIGHT TIN/LEAD PLATED.
- 8 MATERIAL:PHOSPHORBRONZE
- 9 FOR STANDARD-APPLICATOR-CRIMPING.
- 10 FOR REELFED-HANDTOOL-CRIMPING, 500 CONTACTS ON A SMALL REEL.
- 11 24-20 AWG (0,20-0,56 mm<sup>2</sup>) WITH .055 CRIMPER.  
26 AWG (0,12-0,14 mm<sup>2</sup>) WITH .042 CRIMPER.
- 12 OBSOLETE PARTS: OBSOLETE CIS STREAMLINING PER D.RENAUD/D.SINISI

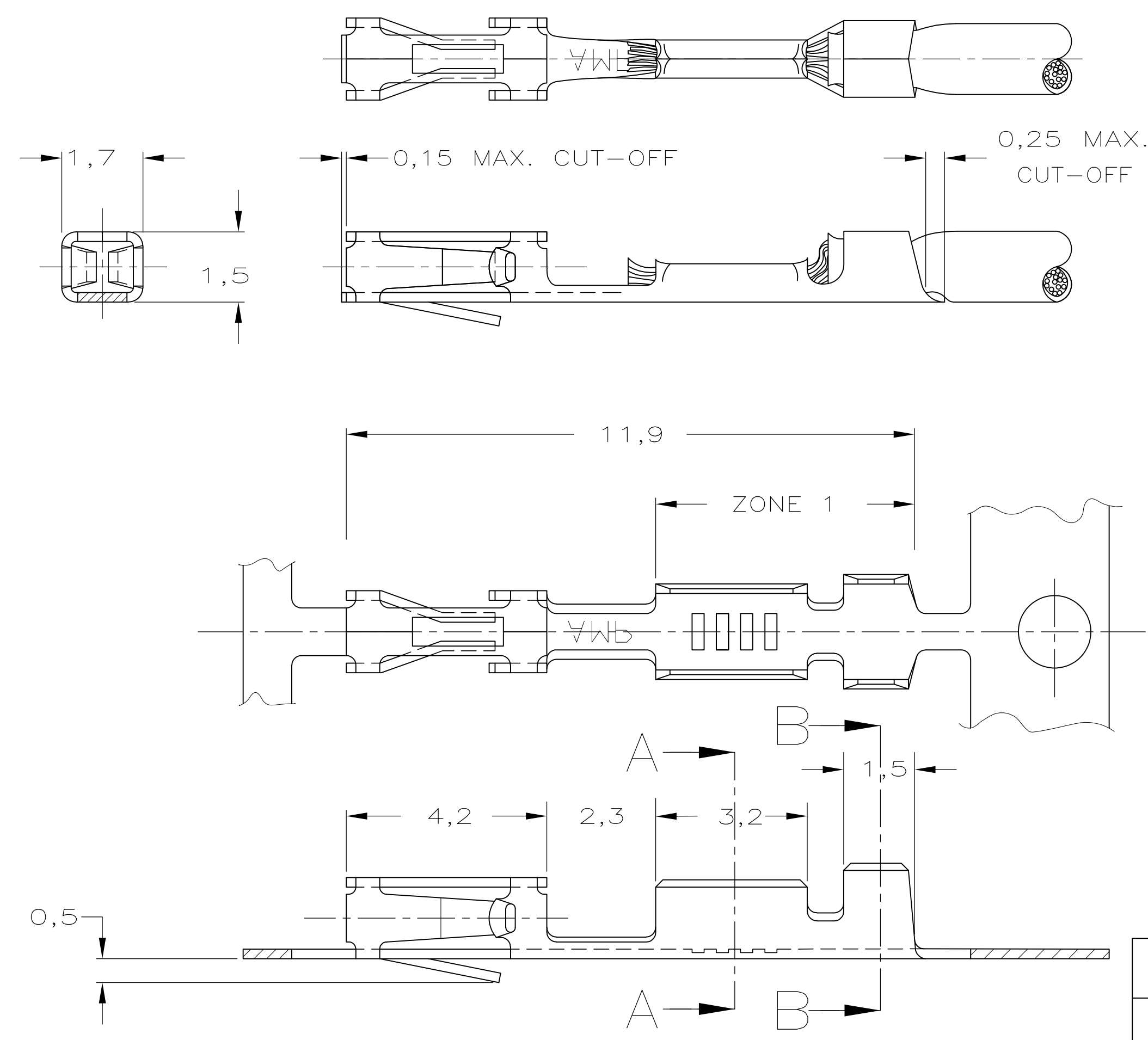

WIRE RANGE	1
INSUL. RANGE	1,4 MAX. DIA.

GOLD	2	1-141708-2	5-167301-4	12	10
TIN	6	1-141708-1	5-167301-2	12	10
GOLD	5	≠	2-167301-6	12	1
			2-167301-5		9
GOLD	2	1-141708-2	2-167301-4		1
			2-167301-3	12	9
TIN	6	1-141708-1	2-167301-2		1
			2-167301-1		9
GOLD	4	7	≠		1
			1-167301-6		9
			1-167301-5		9
GOLD	3	141708-1	167301-4		1
			167301-3		9

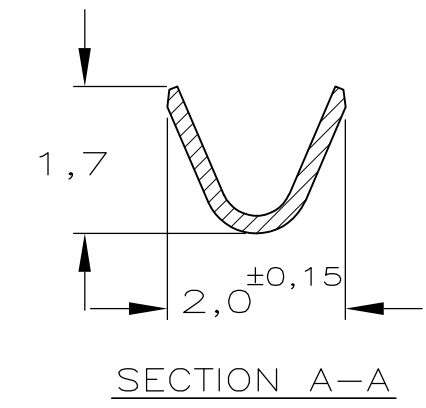
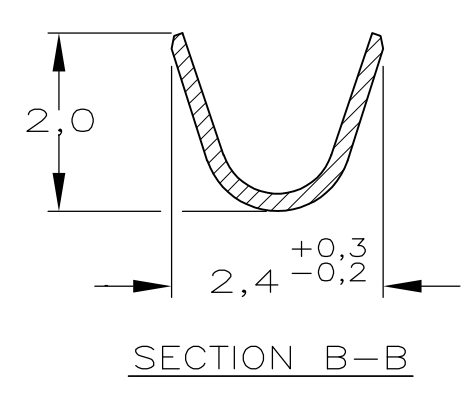

FINISH		LOOSE PIECE		PARTNUMBER	
CUSTOMER DRAWING FOR REFERENCE ONLY WILL NOT BE UPDATED					
© COPYRIGHT - BY					
ALL INTERNATIONAL RIGHTS RESERVED.					
THIS DRAWING IS UNPUBLISHED RELEASED FOR PUBLICATION _____,19____					
				<b>STE</b> TE Connectivity	
NAME				AMP MODU MOD.4 RECEPTACLE,S.C.P. STRIP	
J2	REVISED PER ECO-11-005294	RK	HMR	13APR11	
LTR.	REVISION RECORD	DR.	CHK.	DATE	
DR.:	R.VISSER	CHK.:	J.v.LIEMPT	APP.:	L.v.SOEST
DATE:	11-11-87	DATE:	-	DATE:	-
DWG.No. C-167301		REV.LTR. J2		SHEET 1 OF 1	