



Chipsmall Limited consists of a professional team with an average of over 10 year of expertise in the distribution of electronic components. Based in Hongkong, we have already established firm and mutual-benefit business relationships with customers from,Europe,America and south Asia,supplying obsolete and hard-to-find components to meet their specific needs.

With the principle of “Quality Parts,Customers Priority,Honest Operation,and Considerate Service”,our business mainly focus on the distribution of electronic components. Line cards we deal with include Microchip,ALPS,ROHM,Xilinx,Pulse,ON,Everlight and Freescale. Main products comprise IC,Modules,Potentiometer,IC Socket,Relay,Connector.Our parts cover such applications as commercial,industrial, and automotives areas.

We are looking forward to setting up business relationship with you and hope to provide you with the best service and solution. Let us make a better world for our industry!



## Contact us

Tel: +86-755-8981 8866 Fax: +86-755-8427 6832

Email & Skype: info@chipsmall.com Web: www.chipsmall.com

Address: A1208, Overseas Decoration Building, #122 Zhenhua RD., Futian, Shenzhen, China



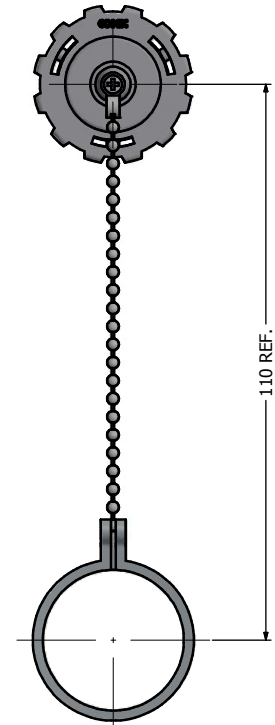
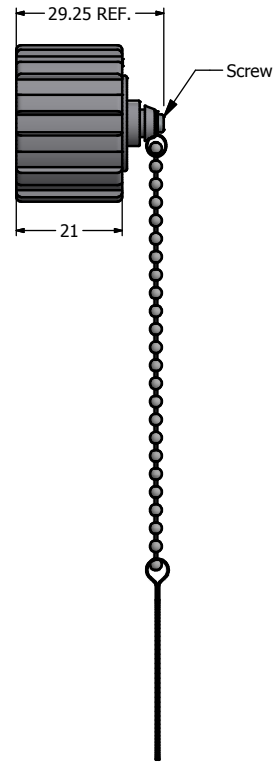
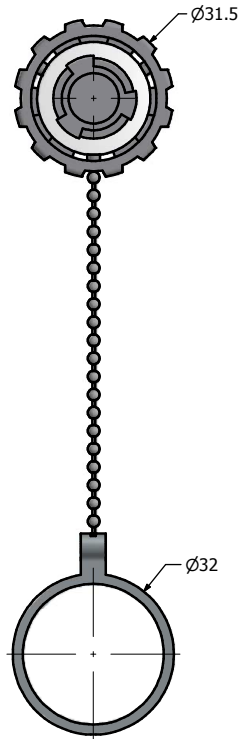
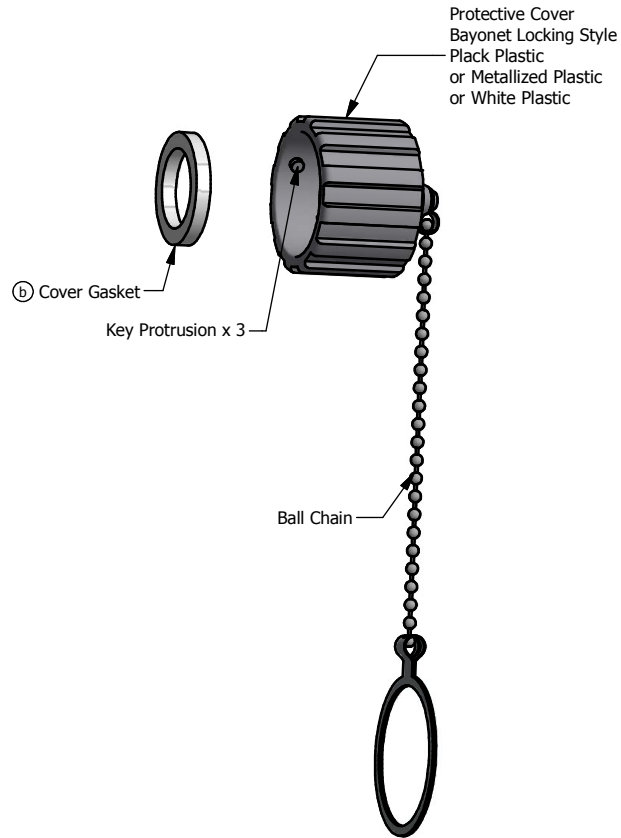

Version	Part Number
Black Plastic Version with metal ball chain	17-101710
Metallized Plastic Version with metal ball chain	17-101720
White plastic version (Color #: RAL9016) with metal ball chain	17-103850

**Notes:**

- Ⓒ 1. Material and Finish:
- Cover Coupling Ring: Polyester (Black) or metallized ABS, (Nickel Plated), or PBT (White, RAL9016), UL94 V-0
  - Ball Chain: Copper Alloy, Nickel Plated
  - Screw: Stainless steel, Nickel Plated
  - Cover Gasket: Silicon, Color: Transparent
2. Operating Temperature: -40°C to +85°C

Directive 2002/95/EC RoHS Compliant

THIS DRAWING MAY NOT BE COPIED OR REPRODUCED IN ANY WAY AND MAY NOT BE PASSED ON TO A THIRD PARTY WITHOUT WRITTEN PERMISSION. OWNERSHIP AND COPYRIGHT OF CONEC CORPORATION <b>DO NOT ALTER CAD DRAWING BY HAND</b>	Customer:			Tolerance Unless otherwise specified			Scale:	Dim. in mm
	Name	Title	Approval Date	0 PLC ±0.50	1 PLC ±0.38		Autodesk Inventor Material: See Notes Title: Protective Cover Assembly Kit Plastic or Metallized Plastic Version with metal ball chain	Drawing No.: 17K1A136 Part No.: SEE PART NUMBER TABLE
				2 PLC ±0.25	3 PLC ±0.10			
				ANGLES ±3°		2009 Date Name Draw. Sept. 14 Vincent Ke Appd. Sept. 14 J. Chaudry		
	d	1 x d	Aug/08/2013	Vincent Ke	Norm			
c	2 x c	Jul/09/2013	Vincent Ke	D-old				
b	1 x b	Mar/30/2010	Vincent ke					
a	original							
Rev.	Changes	Date	Name					