



Chipsmall Limited consists of a professional team with an average of over 10 year of expertise in the distribution of electronic components. Based in Hongkong, we have already established firm and mutual-benefit business relationships with customers from,Europe,America and south Asia,supplying obsolete and hard-to-find components to meet their specific needs.

With the principle of “Quality Parts,Customers Priority,Honest Operation,and Considerate Service”,our business mainly focus on the distribution of electronic components. Line cards we deal with include Microchip,ALPS,ROHM,Xilinx,Pulse,ON,Everlight and Freescale. Main products comprise IC,Modules,Potentiometer,IC Socket,Relay,Connector.Our parts cover such applications as commercial,industrial, and automotives areas.

We are looking forward to setting up business relationship with you and hope to provide you with the best service and solution. Let us make a better world for our industry!



## Contact us

Tel: +86-755-8981 8866 Fax: +86-755-8427 6832

Email & Skype: info@chipsmall.com Web: www.chipsmall.com

Address: A1208, Overseas Decoration Building, #122 Zhenhua RD., Futian, Shenzhen, China



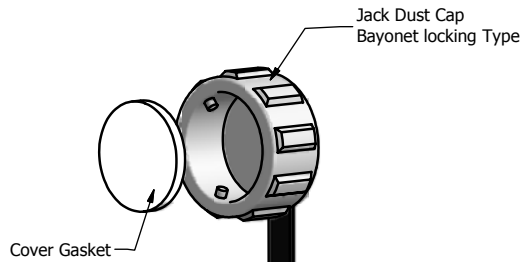

ISO View

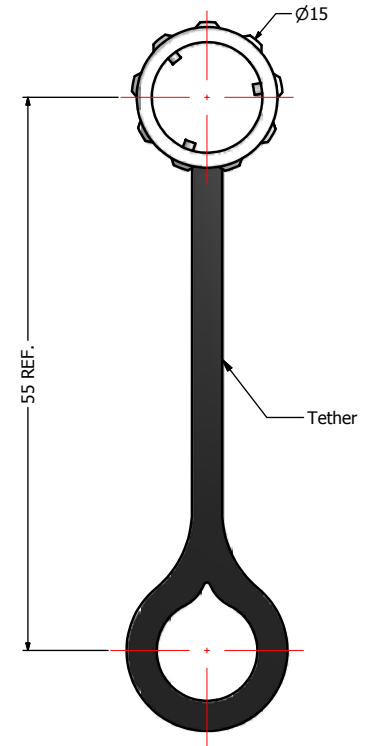
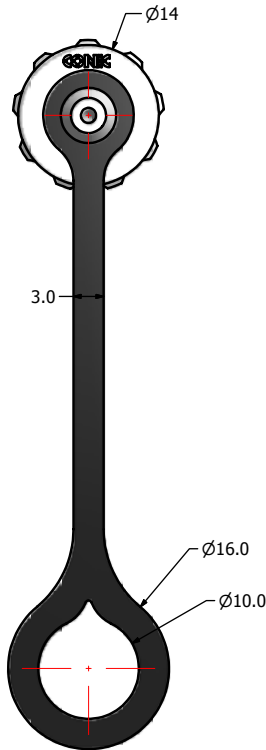

**Notes:**

1. Material:
  - Protective Cover: Polyester (Black), UL94 V-0
  - Cover Gasket: Silicone, White
  - Tether: Polycarbonate, Black
2. Operating Temperature: -40°C to +85°C
3. RoHS compliant
4. IP67 rated when fully mated with appropriate mating connector

Directive 2002/95/EC RoHS Compliant

THIS DRAWING MAY NOT BE COPIED, OR REPRODUCED IN ANY WAY AND MAY NOT BE PASSED ON TO A THIRD PARTY WITHOUT WRITTEN PERMISSION. OWNERSHIP AND COPYRIGHT OF CONEC CORPORATION <b>DOT NOT ALTER CAD DRAWING BY HAND</b>	Customer:			Tolerance Unless otherwise specified			Scale: 2:1	Dim. in mm
	Name		Title	Approval Date	0 PLC ±0.50		1 PLC ±0.38	Material: See Notes
					2 PLC ±0.25	3 PLC ±0.10	Title: IP67 mini USB Jack Dust Cap Assembly	
					ANGLES ±3°		Drawing No.: 17K1A138	
					2011	Date	Name	DIN A3
					Draw.	May 05	Vincent Ke	Sheet 1/1
					Appd.	May 05	J. Chaudry	
					Norm			Drawing No.: 17K1A138
					D-old			Part No.: 17-250010
	a		original					
Rev.	Changes	Date	Name					