



Chipsmall Limited consists of a professional team with an average of over 10 year of expertise in the distribution of electronic components. Based in Hongkong, we have already established firm and mutual-benefit business relationships with customers from,Europe,America and south Asia,supplying obsolete and hard-to-find components to meet their specific needs.

With the principle of “Quality Parts,Customers Priority,Honest Operation,and Considerate Service”,our business mainly focus on the distribution of electronic components. Line cards we deal with include Microchip,ALPS,ROHM,Xilinx,Pulse,ON,Everlight and Freescale. Main products comprise IC,Modules,Potentiometer,IC Socket,Relay,Connector.Our parts cover such applications as commercial,industrial, and automotives areas.

We are looking forward to setting up business relationship with you and hope to provide you with the best service and solution. Let us make a better world for our industry!



Contact us

Tel: +86-755-8981 8866 Fax: +86-755-8427 6832

Email & Skype: info@chipsmall.com Web: www.chipsmall.com

Address: A1208, Overseas Decoration Building, #122 Zhenhua RD., Futian, Shenzhen, China



LOC		DIST		REVISIONS					
P	LTR	DESCRIPTION		ECN	DATE	DWN	APVD		
	F	REDRAWN W/CHANGE		FJ00-0148-98	28 JAN 98	TS	MB		

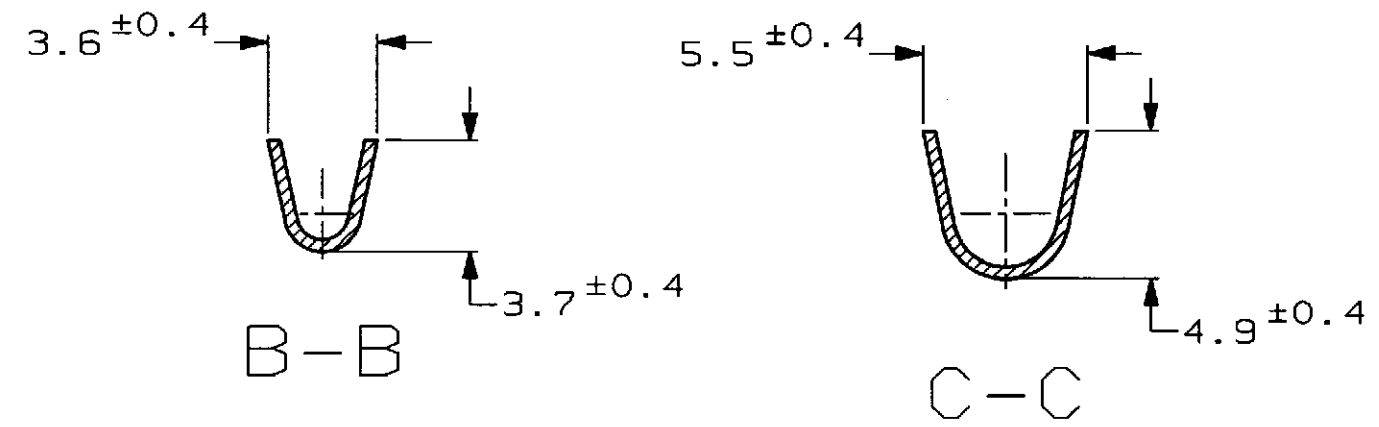
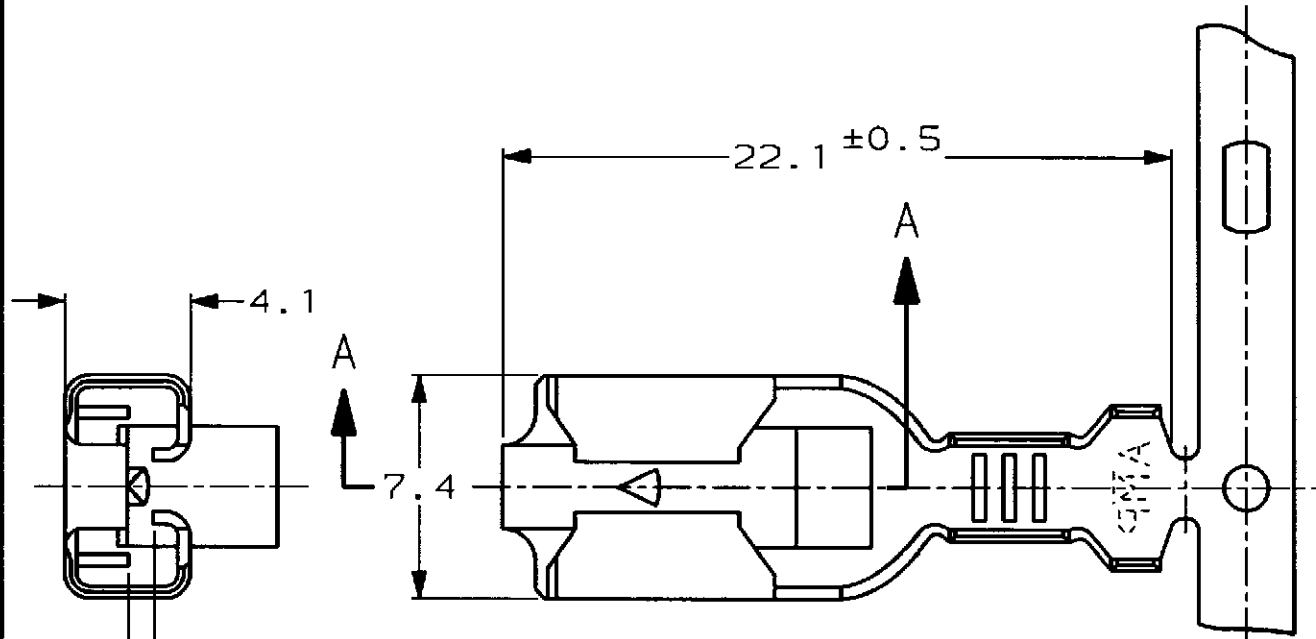

MATING TAB CONTACT 0.8 THICKNESS
0.8厚タブと嵌合

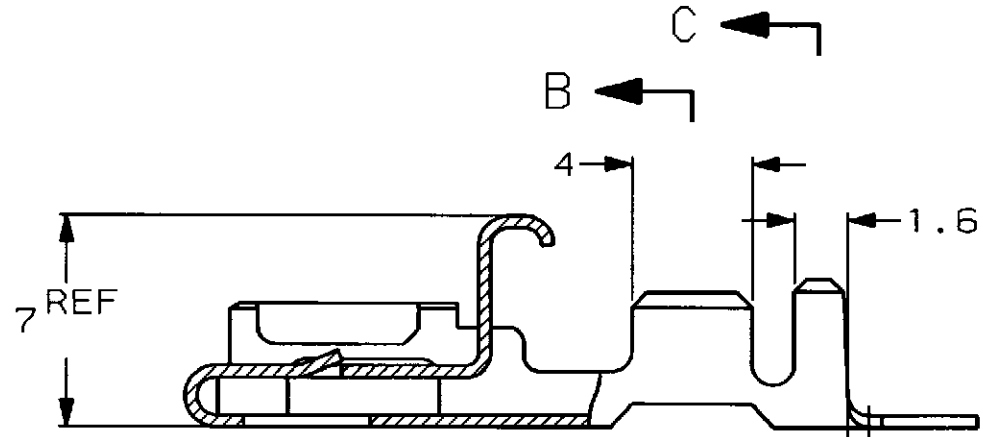

- 1. 適用ハウジングは、型番171809,171810,171848及び154719
- ② 適用製品規格：108-5114,108-5117
- ③ 適用圧着規格：114-5032
- ④ 材料の板厚0.4, ASTM B36に準拠する

- 1. THE MATING HOUSING : 171809,171810,171848 AND 154719
- ② PRODUCT SPEC : 108-5114,108-5117
- ③ APPLICATION SPEC : 114-5032
- ④ MATERIAL THICKNESS 0.4, BASED ON ASTM B36

0.5~2.27	2.1~3.4mm	TIN 錫めっき	PHOSPHOR BRONZE りん青銅	170265-4	170233-4
0.5~2.27	2.1~3.4mm	TIN 錫めっき	BRASS 黄銅	170265-2	170233-2
0.5~2.27	2.1~3.4mm	-	BRASS 黄銅	170265-1	170233-1
WIRE RANGE 適用電線範囲	INSULATION DIA 被覆外径	FINISH 仕上げ	MATERIAL 材料	LOOSE PIECE ばら状端子型番	STRIP FORM 連鎖状端子型番
				PART NUMBER 型番	

A-A
B
C
0.5MAX
最大

THIS DRAWING IS A CONTROLLED DOCUMENT FOR AMP INCORPORATED. IT IS SUBJECT TO CHANGE AND THE CONTROLLING ENGINEERING ORGANIZATION SHOULD BE CONTACTED FOR THE LATEST REVISION.		DWN CHK APVD PRODUCT SPEC APPLICATION SPEC WEIGHT CUSTOMER DRAWING		WIRE RANGE INSULATION DIA SEE TABLE 表参照		INSULATION DIA 被覆外径 SEE TABLE 表参照	
DIMENSIONS 単位: 概 mm		TOLERANCES UNLESS OTHERWISE SPECIFIED 一般公差 10% ±0.2 30% >0, ±0.25 100% >30, ±0.3 ANGLE: ±0.3°		AMP 株式会社 Kawasaki, Japan		NAME 名称 250 シリーズ ポジティブロック リセプタクル 250 SERIES POSITIVE LOCK RECEPTACLE	
MATERIAL 材料 SEE TABLE 表参照		FINISH 仕上 SEE TABLE 表参照		SIZE A3		CAGE CODE 00779	
				DRAWING NO 番号 C=170233		RESTRICTED TO 番号 -	
				SCALE 尺度 4:1		SHEET 1 OF 1	