



Chipsmall Limited consists of a professional team with an average of over 10 year of expertise in the distribution of electronic components. Based in Hongkong, we have already established firm and mutual-benefit business relationships with customers from,Europe,America and south Asia,supplying obsolete and hard-to-find components to meet their specific needs.

With the principle of “Quality Parts,Customers Priority,Honest Operation,and Considerate Service”,our business mainly focus on the distribution of electronic components. Line cards we deal with include Microchip,ALPS,ROHM,Xilinx,Pulse,ON,Everlight and Freescale. Main products comprise IC,Modules,Potentiometer,IC Socket,Relay,Connector.Our parts cover such applications as commercial,industrial, and automotives areas.

We are looking forward to setting up business relationship with you and hope to provide you with the best service and solution. Let us make a better world for our industry!



Contact us

Tel: +86-755-8981 8866 Fax: +86-755-8427 6832

Email & Skype: info@chipsmall.com Web: www.chipsmall.com

Address: A1208, Overseas Decoration Building, #122 Zhenhua RD., Futian, Shenzhen, China



LOC		DIST		REVISIONS			
P	LTR	DESCRIPTION	DATE	DWN	APVD		
		B1	REVISED PER ECO-11-005294	11APR11	RK	HMR	

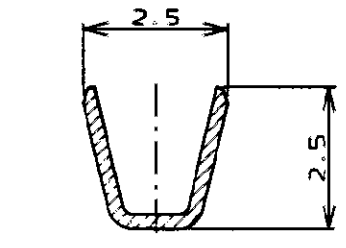
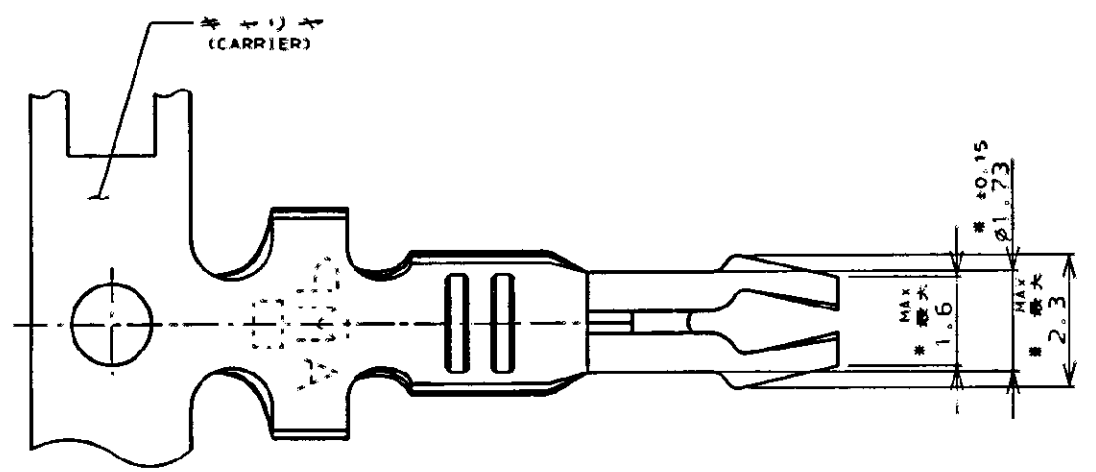

断面 "A"- "A"
SECT.

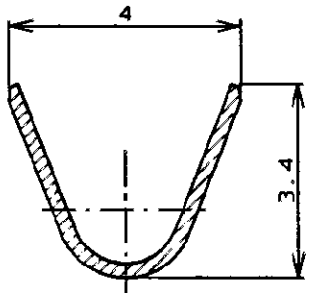

断面 "B"- "B"
SECT.

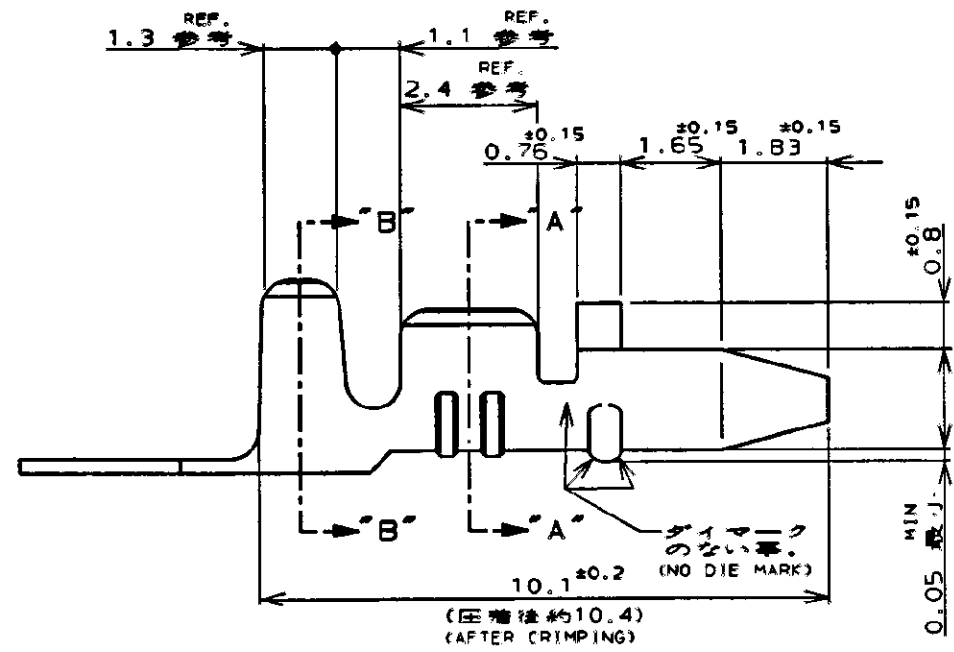

本図 : -1
(AS SHOWN : -1)

- 注記;
1. PC板 (1.6t 下太1.8φ-1.9φ)にて
初回挿入力 2Kg以下
初回引抜き力 0.5Kg以上であること。
 2. 取付用PC板 下太は1.8φ-1.9φとする。
 3. PC板取付後、半田の上り位置は先端より約8.5までとする。
 4. *印のついた寸法は注記1(挿入力、引抜き力)に追随するものである。
 5. 圧着後の折れ強度
ロード圧着した端子を基板に固定し、各方向の折れ強度を測定したとき3Kgで切断されないこと。

- NOTES;
1. WHEN MEASURED BY USING PCB HAVING THICKNESS OF 1.6mm AND HOLE DIAMETER RANGING 1.8-1.9mm, INSERTING FORCE (INITIAL); 2Kg MAX. EXTRACTION FORCE (INITIAL); 0.5Kg MIN.
 2. MOUNTING PCB HOLE DIAMETER TO BE WITHIN 1.8-1.9mm
 3. AFTER MOUNTING ON PCB, THE SOLDER FLOW-UP FROM THE TIP END OF CONTACT TO BE WITHIN 8.5mm APPROX.
 4. THE ASTERISK * MARKED DIMENSIONS HAVE MUCH TO DO WITH EXTRACTION/EXTRACTION INSERTION/EXTRACTION FORCE.
 5. CONTACT BEND-BREAK STRENGTH AFTER CRIMPING TO BE SUCH THAT THE CONTACT SHALL WITHSTAND THE BEND-BREAK LOAD OF 3Kg APPLIED IN EACH DIRECTION OF THE CRIMPED AND MOUNTED TERMINAL ON PCB.

DIMENSIONS 単位 mm		TOLERANCES UNLESS OTHERWISE SPECIFIED 一般公差 ±0.3 ±3°		DWN (24th To) N. Nagaiwa		WIRE RANGE 絶縁電線断面積 0.3-0.89mm ² (AWG #22-18)		INSULATION DIA 絶縁外径 1.52-2.79mm (.060-.110IN)	
MATERIAL 材料 銅下地鍍めつき黄銅		FINISH 仕上 ---		APVD (24th To) H. H. H.		NAME 名称 アンプインターミナル AMP-IN TERMINAL		SIZE A3	
				PRODUCT SPEC 製品規格 ---		CAGE CODE 00779		DRAWING NO 番号 C=170338	
				APPLICATION SPEC 取付運用規格 ---		WEIGHT ---		SCALE 尺貫 8:1	
				CUSTOMER DRAWING		SHEET 1 OF 1		REV B1	