



Chipsmall Limited consists of a professional team with an average of over 10 year of expertise in the distribution of electronic components. Based in Hongkong, we have already established firm and mutual-benefit business relationships with customers from,Europe,America and south Asia,supplying obsolete and hard-to-find components to meet their specific needs.

With the principle of “Quality Parts,Customers Priority,Honest Operation,and Considerate Service”,our business mainly focus on the distribution of electronic components. Line cards we deal with include Microchip,ALPS,ROHM,Xilinx,Pulse,ON,Everlight and Freescale. Main products comprise IC,Modules,Potentiometer,IC Socket,Relay,Connector.Our parts cover such applications as commercial,industrial, and automotives areas.

We are looking forward to setting up business relationship with you and hope to provide you with the best service and solution. Let us make a better world for our industry!



## Contact us

Tel: +86-755-8981 8866 Fax: +86-755-8427 6832

Email & Skype: info@chipsmall.com Web: www.chipsmall.com

Address: A1208, Overseas Decoration Building, #122 Zhenhua RD., Futian, Shenzhen, China



# Printed-circuit board connector - DFK-PC 16/ 2-STF-SH-10,16 - 1703616

Please be informed that the data shown in this PDF Document is generated from our Online Catalog. Please find the complete data in the user's documentation. Our General Terms of Use for Downloads are valid (<http://phoenixcontact.com/download>)

Feed-through connector, nominal current: 76 A, rated voltage (III/2): 1000 V, number of positions: 2, pitch: 10.16 mm, connection method: Screw connection with tension sleeve, color: green, contact surface: Silver



The figure shows a 5-pos. version of the product

## Why buy this product

- Well-known connection principle allows worldwide use
- Low temperature rise, thanks to maximum contact force
- Allows connection of two conductors
- Flange system enables secure fixing to the housing panel by means of tool-free snap-in locking or screws
- Shroud for professional EMC shield feed-through on the inside of the device
- Screwable flange for superior mechanical stability

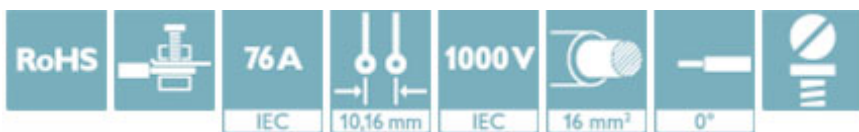

## Key Commercial Data

|              |   |
|--------------|---|
| Packing unit | 10 STK  |
| GTIN         | <br>4 017918 994457 |
| GTIN         | 4017918994457   |

## Technical data

### Item properties

|                           |                                      |
|---------------------------|--------------------------------------|
| Brief article description | Printed-circuit board connector      |
| Range of articles         | DFK-PC 16/..-STF-SH                  |
| Pitch                     | 10.16 mm                             |
| Type of contact           | Male connector                       |
| Plug-in system            | POWER COMBICON 16                    |
| Number of positions       | 2                                    |
| Connection method         | Screw connection with tension sleeve |
| Drive form screw head     | Slotted                              |
| Screw thread              | M4                                   |

# Printed-circuit board connector - DFK-PC 16/ 2-STF-SH-10,16 - 1703616

## Technical data

### Item properties

|                  |              |
|------------------|--------------|
| Locking          | Screw flange |
| Number of levels | 1            |

### Electrical parameters

|                                  |        |
|----------------------------------|--------|
| Rated current                    | 76 A   |
| Rated insulation voltage (III/2) | 1000 V |
| Rated surge voltage (III/2)      | 8 kV   |

### Connection capacity

|  |   |
|--|---|
| Conductor cross section solid  | 0.75 mm <sup>2</sup> ... 16 mm <sup>2</sup> |
| Conductor cross section flexible   | 0.75 mm <sup>2</sup> ... 16 mm <sup>2</sup> |
| Conductor cross section AWG / kcmil  | 18 ... 6                                    |
| Conductor cross section flexible, with ferrule without plastic sleeve                  | 0.5 mm <sup>2</sup> ... 16 mm <sup>2</sup>  |
| Conductor cross section, flexible, with ferrule, with plastic sleeve                   | 0.5 mm <sup>2</sup> ... 16 mm <sup>2</sup>  |
| 2 conductors with same cross section, solid  | 0.75 mm <sup>2</sup> ... 6 mm <sup>2</sup>  |
| 2 conductors with same cross section, flexible   | 0.75 mm <sup>2</sup> ... 6 mm <sup>2</sup>  |
| 2 conductors with same cross section, stranded, ferrules without plastic sleeve        | 0.5 mm <sup>2</sup> ... 4 mm <sup>2</sup>   |
| 2 conductors with same cross section, stranded, with TWIN ferrules with plastic sleeve | 0.5 mm <sup>2</sup> ... 6 mm <sup>2</sup>   |

### Material data - contact

|  |   |
|--|---|
| Note                                     | WEEE/RoHS-compliant, free of whiskers according to IEC 60068-2-82/ JEDEC JESD 201 |
| Contact material                         | Cu alloy  |
| Surface characteristics                  | Electroplated silver  |
| Metal surface terminal point (top layer) | Silver (4 - 8 µm Ag)  |
| Metal surface contact area (top layer)   | Silver (4 - 8 µm Ag)  |

### Material data - housing

|  |     |
|--|-----|
| Insulating material                    | PA  |
| Insulating material group              | I   |
| CTI according to IEC 60112             | 600 |
| Flammability rating according to UL 94 | V0  |

### Dimensions for the product

|                             |          |
|-----------------------------|----------|
| Length [ l ]                | 44.1 mm  |
| Width [ w ]                 | 55.68 mm |
| Height [ h ]                | 30.55 mm |
| Pitch                       | 10.16 mm |
| Height (without solder pin) | 27.8 mm  |
| Solder pin [P]              | 4.1 mm   |
| Dimension a                 | 10.16 mm |

### Packaging information

# Printed-circuit board connector - DFK-PC 16/ 2-STF-SH-10,16 - 1703616

## Technical data

### Packaging information

|                            |                     |
|----------------------------|---------------------|
| Type of packaging          | packed in cardboard |
| Pieces per package         | 10                  |
| Denomination packing units | Pcs.                |

### Air clearances and creepage distances

|                                  |                     |
|----------------------------------|---------------------|
| Specification                    | IEC 60664-1:2007-04 |
| Insulating material group        | I                   |
| Voltage                          | 1000 V              |
| Rated insulation voltage (III/3) | 1000 V              |
| Rated insulation voltage (III/2) | 1000 V              |
| Rated insulation voltage (II/2)  | 1000 V              |
| Rated surge voltage (III/3)      | 8 kV                |
| Rated surge voltage (III/2)      | 8 kV                |
| Rated surge voltage (II/2)       | 6 kV                |

### Current carrying capacity / derating curves

#### Environmental Product Compliance

|            |   |
|------------|---|
| REACH SVHC | Lead 7439-92-1  |
| China RoHS | Environmentally Friendly Use Period = 50  |
|            | For details about hazardous substances go to tab "Downloads", Category "Manufacturer's declaration" |

## Drawings

Drilling diagram

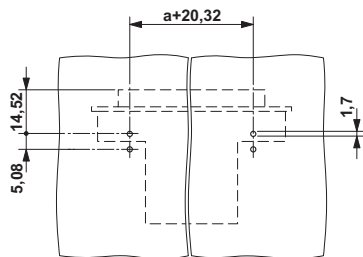

Diagram

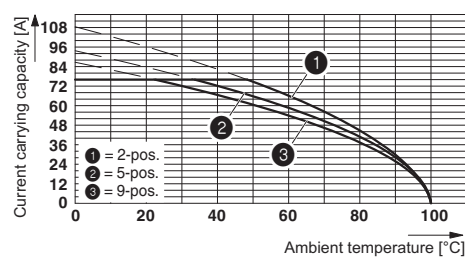

Derating curve for: PC 16/...-ST-10.16 with DFK-PC 16/...-ST-10.16



# Printed-circuit board connector - DFK-PC 16/ 2-STF-SH-10,16 - 1703616

Dimensional drawing

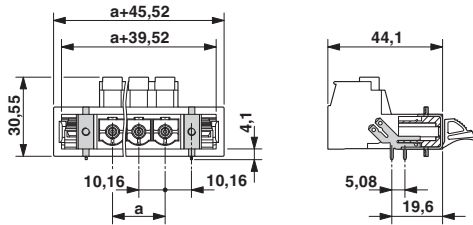

Dimensional drawing

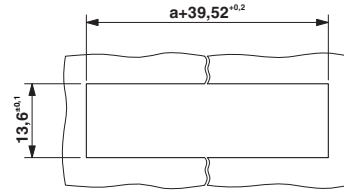

Sheet metal cutout for snap-on.

Dimensional drawing

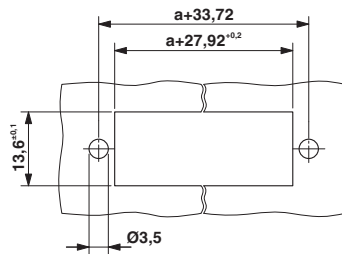

Sheet metal cutout for screw connection.

## Approvals

Approvals

Approvals

SEV / IECCE CB Scheme / EAC / cULus Recognized

Ex Approvals

## Approval details

|                            |        |   |         |
|----------------------------|--------|---|---------|
| SEV                        |        | <a href="https://www.electrosuisse.ch/en/meta/shop/product-certificates.html">https://www.electrosuisse.ch/en/meta/shop/product-certificates.html</a> | IK-3431 |
| Nominal voltage UN         | 1000 V |   |         |
| Nominal current IN         | 76 A   |   |         |
| mm <sup>2</sup> /AWG/kcmil | 16     |   |         |

# Printed-circuit board connector - DFK-PC 16/ 2-STF-SH-10,16 - 1703616

## Approvals

|                    |   |   |         |
|--------------------|---|---|---------|
| IECEE CB Scheme    |  | <a href="http://www.iecee.org/">http://www.iecee.org/</a> | CH-8077 |
| Nominal voltage UN | 1000 V  |   |         |
| Nominal current IN | 76 A  |   |         |

|     |   |         |
|-----|---|---------|
| EAC |  | B.01742 |
|-----|---|---------|

|                            |   |   |                 |
|----------------------------|---|---|-----------------|
| cULus Recognized           |  | <a href="http://database.ul.com/cgi-bin/XYV/template/LISEXT/1FRAME/index.htm">http://database.ul.com/cgi-bin/XYV/template/LISEXT/1FRAME/index.htm</a> | E60425-20040202 |
|                            | B   | C   |                 |
| Nominal voltage UN         | 600 V   | 600 V   |                 |
| Nominal current IN         | 55 A  | 55 A  |                 |
| mm <sup>2</sup> /AWG/kcmil | 20-6  | 20-6  |                 |

Phoenix Contact 2018 © - all rights reserved  
<http://www.phoenixcontact.com>

PHOENIX CONTACT GmbH & Co. KG  
 Flachsmarktstr. 8  
 32825 Blomberg  
 Germany  
 Tel. +49 5235 300  
 Fax +49 5235 3 41200  
<http://www.phoenixcontact.com>