



Chipsmall Limited consists of a professional team with an average of over 10 year of expertise in the distribution of electronic components. Based in Hongkong, we have already established firm and mutual-benefit business relationships with customers from,Europe,America and south Asia,supplying obsolete and hard-to-find components to meet their specific needs.

With the principle of "Quality Parts,Customers Priority,Honest Operation,and Considerate Service",our business mainly focus on the distribution of electronic components. Line cards we deal with include Microchip,ALPS,ROHM,Xilinx,Pulse,ON,Everlight and Freescale. Main products comprise IC,Modules,Potentiometer,IC Socket,Relay,Connector.Our parts cover such applications as commercial,industrial, and automotives areas.

We are looking forward to setting up business relationship with you and hope to provide you with the best service and solution. Let us make a better world for our industry!



Contact us

Tel: +86-755-8981 8866 Fax: +86-755-8427 6832

Email & Skype: info@chipsmall.com Web: www.chipsmall.com

Address: A1208, Overseas Decoration Building, #122 Zhenhua RD., Futian, Shenzhen, China



NUMBER C-172129

三角錐(30°角 PROJECTION)

METRIC

ALL DIMENSIONS IN MM. DO NOT SCALE PRINT

PRINT DIST

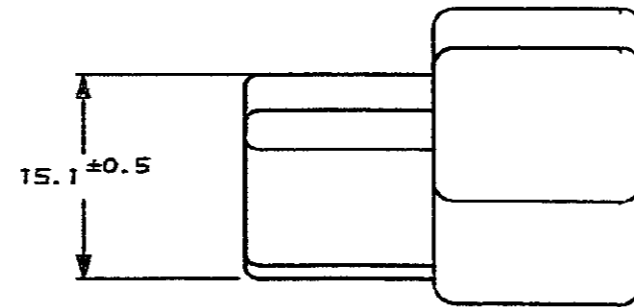
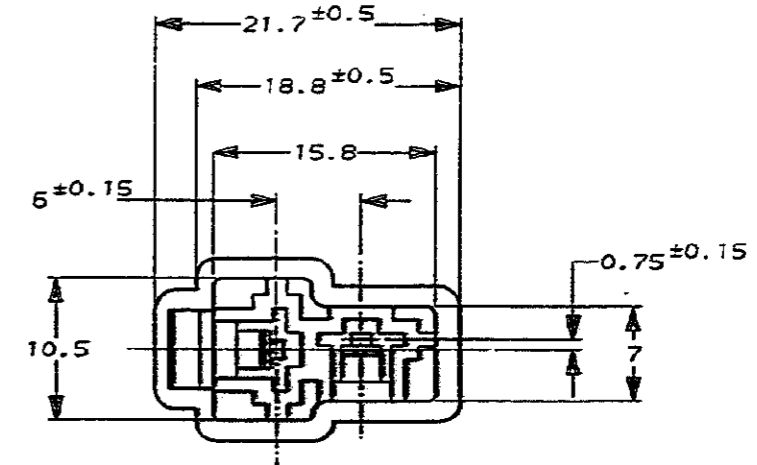
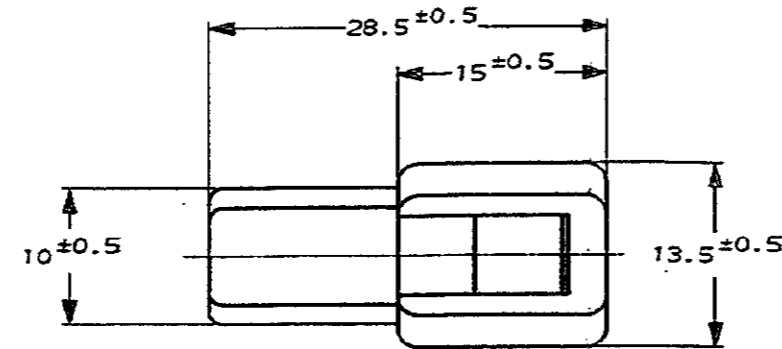
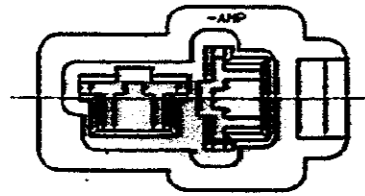

注.

- 1. 嵌合する相手ハウジングは型番172130
- 2. 使用端子は型番170340, 170341, 170349

NOTE.

- 1. THE MATING PLUG HOUSING, P/N 172130
- 2. APPLIED CONTACT, P/N 170340, 170341, 170349

△ OBSOLETE PARTS: OBSOLETE CIS STREAMLINING PER D.RENAUD/D.SINISI

△ OBSOLETE

△ OBSOLETE

淡灰 (LIGHT GRAY)	6-172129-5
自然色 (NATURAL) 94V-0	1-▲ -1
赤 (RED)	-9
橙 (ORANGE)	-8
青 (BLUE)	-5
緑 (GREEN)	-4
茶 (BROWN)	-3
黒 (BLACK)	▼ -2
自然色 (NATURAL)	172129-1
色 (COLOR)	番号 (NUMBER)

TE TE Connectivity

材料 (MATERIAL) 6/6 ナイロン (6/6 NYLON)	仕上 (FINISH) 色: 表参照 (COLOR: SEE TABLE)	名称 (NAME) "250"シリーズ ハウジング ランス コネクタ 2極 キャップ ハウジング "250" SERIES HOUSING LANCE CONNECTOR 2P CAP HOUSING
DR. <i>K. Yamada</i> 9/10/93	DE. <i>K. Yamada</i> 9/10/93	一般公差 (GENERAL TOLERANCE) ISHLT: ±0.2 ISHLT: ±0.25 ISHLT: ±0.3 R: ±3°
C2 REVISED PER ECO-11-005030	RK HMR 22MAR11	LOC 番号 (NO.) B J C-172129
LTR 変更 (REVISION RECORD)	DR CHK DATE	尺数 (SCALED) 2-1 REV. C2 SHEET 1 OF 1