



Chipsmall Limited consists of a professional team with an average of over 10 year of expertise in the distribution of electronic components. Based in Hongkong, we have already established firm and mutual-benefit business relationships with customers from,Europe,America and south Asia,supplying obsolete and hard-to-find components to meet their specific needs.

With the principle of "Quality Parts,Customers Priority,Honest Operation,and Considerate Service",our business mainly focus on the distribution of electronic components. Line cards we deal with include Microchip,ALPS,ROHM,Xilinx,Pulse,ON,Everlight and Freescale. Main products comprise IC,Modules,Potentiometer,IC Socket,Relay,Connector.Our parts cover such applications as commercial,industrial, and automotives areas.

We are looking forward to setting up business relationship with you and hope to provide you with the best service and solution. Let us make a better world for our industry!



Contact us

Tel: +86-755-8981 8866 Fax: +86-755-8427 6832

Email & Skype: info@chipsmall.com Web: www.chipsmall.com

Address: A1208, Overseas Decoration Building, #122 Zhenhua RD., Futian, Shenzhen, China



CKT SIZE	① MAIN HOUSING	② TPA	③ SIGNAL HOUSING	④ POWER TERMINAL	⑤ SIGNAL TERMINAL	DIMENSION 'A'	DIMENSION 'B'	DIMENSION 'C'	DIMENSION 'D'
	MATERIAL: UNFILLED PBT	MATERIAL: FILLED PBT	MATERIAL: UNFILLED NYLON	MATERIAL: COPPER ALLOY FINISH: TIN OVER NICKEL W/ SELECT GOLD	MATERIAL: PHOS BRONZE FINISH: TIN OVER NICKEL W/ SELECT GOLD				
2P-12S	172510-3212	46708-3212	46709-0004	173693-****	70058-****	45.76	28.4	26.48	10.67
2P-18S	172510-3218	46708-3218	46709-0006	173693-****	70058-****	50.84	33.5	31.80	15.75
2P-24S	172510-3224	46708-3224	46709-0008	173693-****	70058-****	55.92	38.6	36.85	20.83
4P-12S	172510-3412	46708-3412	46709-0004	173693-****	70058-****	60.76	43.4	41.48	10.67
4P-18S	172510-3418	46708-3418	46709-0006	173693-****	70058-****	65.84	48.5	46.80	15.75
4P-24S	172510-3424	46708-3424	46709-0008	173693-****	70058-****	70.92	53.6	51.85	20.83
6P-12S	172510-3612	46708-3612	46709-0004	173693-****	70058-****	75.76	58.4	56.48	10.67
6P-18S	172510-3618	46708-3618	46709-0006	173693-****	70058-****	80.84	63.5	61.85	15.75
6P-24S	172510-3624	46708-3624	46709-0008	173693-****	70058-****	85.92	68.6	66.93	20.83

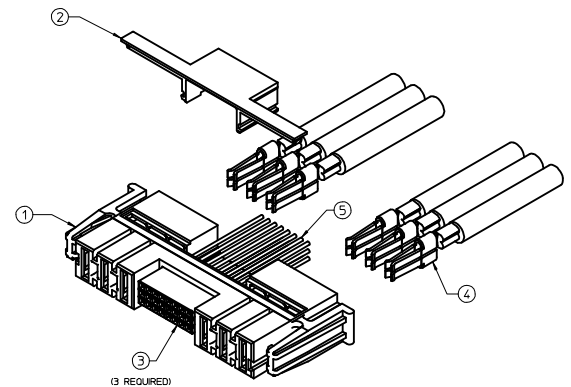

EXPLODED VIEW

MAIN HOUSING

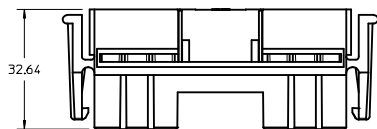

TPA

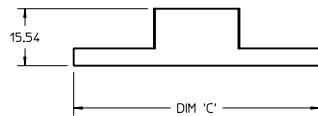

SIGNAL HOUSING

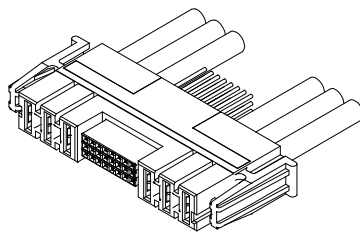
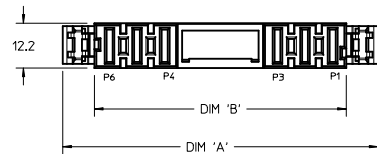
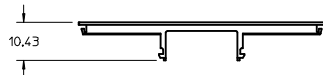
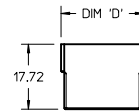

NOTES:

1. SEE CHART FOR MATERIAL DETAILS
2. PART MATES TO MOLEX PLUG SERIES 172453
3. ASSEMBLY SHOWN FOR REFERENCE ONLY. EACH ITEM HAS TO BE ORDERED SEPARATELY.
4. SEE SD-173693-001 FOR POWER TERMINAL DETAILS
5. SEE SD-70058-*** FOR SIGNAL TERMINAL DETAILS

CHG TRML P/N EEC NO: UCP2016-4071 DRAWN: JSCHAFFER 2016/04/18 CHKD: APPR: BPISZCZOR 2016/10/03	QUALITY SYMBOLS ▽=0 ▽=0 ▽=0	GENERAL TOLERANCES (UNLESS SPECIFIED)		DIMENSION STYLE MM ONLY		SCALE 1.5:1	DESIGN UNITS METRIC	THIRD ANGLE PROJECTION
		4 PLACES ±--- ±--- 3 PLACES ±--- ±--- 2 PLACES ±0.13 ±--- 1 PLACE ±0.25 ±--- 0 PLACE ±--- ±---	mm INCH	DRAWN BY JSCHAFFER	DATE 2014/02/17	CHECKED BY	DATE	TITLE TEN60 WIRE TO BOARD POWER / SIGNAL MIX
DRAFT WHERE APPLICABLE MUST REMAIN WITHIN DIMENSIONS		ANGULAR ±1/2°		SEE CHART		MATERIAL NO.	DOCUMENT NO. SD-172510-001	SHEET NO. 1 OF 1
THIS DRAWING CONTAINS INFORMATION THAT IS PROPRIETARY TO MOLEX INCORPORATED AND SHOULD NOT BE USED WITHOUT WRITTEN PERMISSION								