



Chipsmall Limited consists of a professional team with an average of over 10 year of expertise in the distribution of electronic components. Based in Hongkong, we have already established firm and mutual-benefit business relationships with customers from,Europe,America and south Asia,supplying obsolete and hard-to-find components to meet their specific needs.

With the principle of “Quality Parts,Customers Priority,Honest Operation,and Considerate Service”,our business mainly focus on the distribution of electronic components. Line cards we deal with include Microchip,ALPS,ROHM,Xilinx,Pulse,ON,Everlight and Freescale. Main products comprise IC,Modules,Potentiometer,IC Socket,Relay,Connector.Our parts cover such applications as commercial,industrial, and automotives areas.

We are looking forward to setting up business relationship with you and hope to provide you with the best service and solution. Let us make a better world for our industry!



## Contact us

Tel: +86-755-8981 8866 Fax: +86-755-8427 6832

Email & Skype: [info@chipsmall.com](mailto:info@chipsmall.com) Web: [www.chipsmall.com](http://www.chipsmall.com)

Address: A1208, Overseas Decoration Building, #122 Zhenhua RD., Futian, Shenzhen, China



## ENGINEERED FASTENING SOLUTIONS



**HellermannTyton**

BUNDLE SEPARATORS | MOUNTS | CLAMPS | FASTENERS | CABLE TIE TOOLS | IDENTIFICATION | CABLE MANAGEMENT

HellermannTyton is a leader in designing and manufacturing innovative fastening solutions for the automotive, truck, bus, aerospace, OEM, appliance, marine and heavy equipment industries.

With over 34 locations world wide, HellermannTyton is able to design, produce, and deliver solutions to meet customer's production requirements.

ARGENTINA | AUSTRALIA | AUSTRIA | BELGIUM | BRAZIL | CANADA | CHINA  
CZECH REPUBLIC | DENMARK | FINLAND | FRANCE | GERMANY | HONG KONG  
HUNGARY | IRELAND | ITALY | JAPAN | KOREA | MEXICO | NETHERLANDS | NORWAY | PHILIPPINES  
POLAND | PORTUGAL | ROMANIA | RUSSIAN FEDERATION | SINGAPORE | SLOVENIA | SOUTH AFRICA  
SPAIN | SWEDEN | THAILAND | UNITED KINGDOM | UNITED STATES

## MATERIAL INFORMATION AND SPECIFICATIONS

7-8



### BUNDLE SEPARATION PRODUCTS

9-20

Dual Swivel Saddle Spacers	9-10
Dual Clamp Ties	11
Standoff Mounting Dual Clamp Tie	12
Double Head Ties	13
Pipe and Hose Clips, PC-Series	14
Automatic Harness Clips	15-16
Isolator	17
Omega Clips	18
Wire Clamping Cable Ties	19
Wire and Hose Swivel Clip Tie	20



### MOUNTS

21-38

H Mounts	21
Heavy Duty Mounts	22-23
Weld Stud Mount	24
Saddle Mount for Button Head Ties	25
Two way Saddle Mounts	26
Axial Oval Mounts	27
Fir Tree Saddle Mounts	25
Bundling Clips	29-30
Connector Clips	31-32
Mounting Cradle	33
Lashing Tie Mounts	33
Fir Tree Mount Tube Clip	34
Fir Tree Clip	34
Cable Guide Standoff	35
Cable Tie Mounts	36
Cable Tie Mounting Bases	37-38

## TABLE OF CONTENTS



### FASTENERS

**39-78**

Wide Strap Cable Ties	39
Heavy Duty Cable Ties	39-40
Button Head Cable Ties	41
Edge Clips	42-45
Fir Tree Mount Cable Ties	46-51
Push Mount Cable Ties	52-54
Arrowhead Mount Cable Ties	55
Stud Mount Cable Ties	56-59
Screw Mount Cable Ties	60
Clamp Cable Ties	61
Branch Cable Tie	62
Kabelwrap Bundling System	62
Standard Cable Ties	63-65
Specialty Materials Cable Ties	66-71
Outside Serrated Cable Ties	71
Releasable Cable Ties	72-76
Stainless Steel Cable Ties	77-78



### CLAMPS

**79-88**

Snapper Hose Clamps	79-84
Non-Adhesive Clamps and Clips	85
Adhesive Cable Clamps and Clips	86
Flat Ribbon Cable Clips	87-88



### CABLE TIE TOOLS

**89-103**

Mechanical Cable Tie Tools	89-91
Power Assisted Cable Tie Tools	92-94
Automatic Cable Tie Tools	95-103



### IDENTIFICATION SYSTEMS

**104-122**

SwiftMark Label Printer/Applicator	104
TagPrint Pro™ Software	105
Spirit Printer and Labels	106-108
Thermal Transfer Printers and Labels	109-110
Labels	111-122



### CABLE MANAGEMENT

**122-150**

Spiralwrap	123-125
Convuluted Tubing	126-128
Grommet	129-130
Braided Sleeving and Accessories	131-150

### INDEX

**141-148**

# Engineered Fastening Solutions

HellermannTyton is a world leader in providing fastening solutions to the global marketplace. But that doesn't mean we rest on our past successes —our product development teams continue to push the possibilities, shaping the future of fastening solutions through innovative designs and an unprecedented commitment to the success of our customers.

## The Engineered Process

**Innovative Design Technologies –**  
Utilizing the latest customer compatible design software.

**Short Concept to Production Cycle –**  
We are an agile company and can act quickly to changing needs.

**A Valued Partnership –**  
Our development team works with your engineers to develop solutions specific to your application needs.

## Solutions

**Customer  
driven  
solutions**



# The Fastening Products

**Reduced costs,  
assembly time  
and warranty  
issues**

**Wide variety of customized  
solutions for the automotive,  
transportation and OEM markets.**

**Superior Materials Knowledge –**  
Offering advanced materials  
that address unique application  
and environmental needs.

**Quality Certified –**  
TS16949, ISO 9001, and  
ISO 14001 certified

**Improved quality  
and durability**

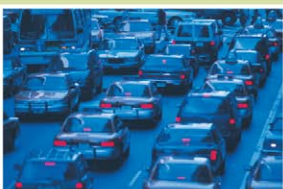

## Optimum storage conditions for cable ties made of polyamide (PA)

**HellermannTyton** cable ties and mounts are manufactured from high-quality polyamide (PA). This material is mainly processed using injection molding, but can also be extruded.

Polyamide is a hygroscopic material. This means that the material absorbs and loses moisture. For optimum handling of cable ties, it is important that the material is in a condition of equilibrium with a water content of approximately 2.5%.

The packaging used by HellermannTyton ensures that the water content in the material remains constant. Therefore, it is important to store the products in their original packaging to preserve the quality of the ties and mounts.



Once opened you should use the ties as quickly as possible.



Do not expose the product to direct sunlight

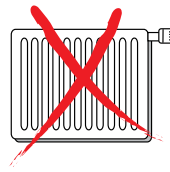

Store the product away from direct sources of heat

### Ideal storage conditions:

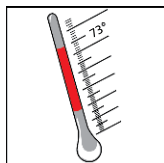

73 °F

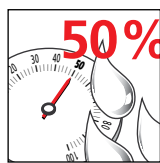

50%  
relative  
humidity

### QUALITY CERTIFICATIONS

HellermannTyton is certified to TS 16949, ISO 9001:2000 and ISO 14001

### RoHS/WEEE



The scope of the European Union's Restriction of Hazardous Substances (RoHS) and the Waste Electrical and Electronic Equipment (WEEE) directives covers all electrical and electronic equipment (and their components) sold into the European Union. Throughout this catalog, you will see designations where materials are RoHS compliant. If you have specific questions or need compliance information related to the RoHS or WEEE directives, please go to our website link: [www.hellermann.tyton.com/rohs.asp](http://www.hellermann.tyton.com/rohs.asp) or email us at: [rohs@htamericas.com](mailto:rohs@htamericas.com). A HellermannTyton representative will promptly respond to your request.

### WARRANTY POLICY

HellermannTyton products are warranted to be free from defects in material and workmanship at the time sold by us; but our obligation under this warranty and that of the seller is limited to the replacement of the product, and neither we nor the seller are bound by any other warranty, expressed, implied or statutory. Under no circumstances are we or the seller liable for any loss, damage, expenses or consequential damages of any kind arising out of the use or inability to use these products. All are sold with the understanding that the user will test them in actual use and determine their adaptability for the intended uses.

*The above warranties and remedies are exclusive and in lieu of all other warranties and remedies whatsoever, express or implied, including, but not limited to, any implied warranties of merchantability or fitness for a particular purpose which HellermannTyton expressly disclaims.*

## Cable Ties and Tool Systems

**HellermannTyton's** cable tie and tool systems are designed to work together to provide optimal consistency, quality, safety, and overall performance. Wrapping and hand tensioning a high quality cable tie is just the first step in assuring a high quality application. It is necessary to use one of HellermannTyton's cable tie tools to ensure that the cable tie is applied with just the right amount of tension and with a flush cut that won't leave a sharp edge. HellermannTyton leads the world in the development and manufacture of ergonomically designed, high performing cable tie tools in mechanical, power assisted, and automatic versions. With HellermannTyton's automatic cable tie systems, cable ties are applied, tensioned and cut-off to the correct tension in approximately one second. HellermannTyton's mechanical and power assisted tools expertly tension and cut-off hand applied cable ties.

## Consistency and Quality

By utilizing HellermannTyton's cable ties and tools together, a consistent tension and cut-off is achieved. When using non-approved methods of cutting off a cable tie, wire and cable can be crushed, the strap of the cable tie may be cut-off too deeply causing the tie to disengage, or the cable tie can be applied too loosely which can affect the bundling and securing properties of the application.

## Safety

A flush cut is another benefit of using HellermannTyton's cable tie tools and ties as a system. Worker safety, and resulting reduction of workers' compensation claims, is an increasing priority of most companies. HellermannTyton's cable tie tools are ergonomically designed to reduce worker effort and causes of repetitive motion injuries. When using HellermannTyton's tools and cable ties, a flush cut is achieved, creating a smooth edge. When non-approved methods of applying a cable tie are used, a sharp edge is almost always left at the end of the tie - causing injury to workers and end-customers. All of HellermannTyton's cable tie tool systems offer adjustable tension and cut-off levels to assure optimal tensions and flush cut-offs.

## Overall Performance

Used together, HellermannTyton's cable ties and ergonomically designed tool systems assure a high quality installation which prevents damage to wire and cable and potential rework due to inappropriately applied cable ties - all lowering installed costs while improving performance.

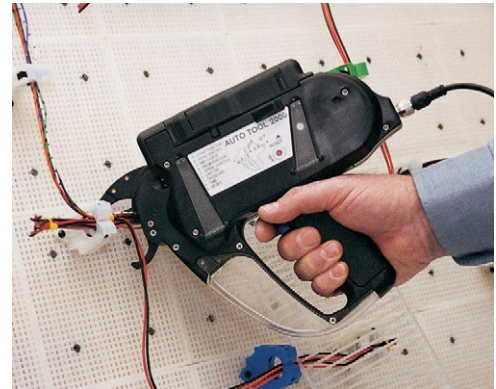

*AT2000 Automatic Cable Tie Tool — For automatic cable tie tool systems, see page 88.*



*MK7P - Power Assisted Cable Tie Tool — For power assisted cable tie tools, see page 85.*



*MK7 and MK9 Mechanical Cable Tie Tools — For mechanical cable tie tools, see page 82.*

## Materials

**HellermannTyton** has worked very closely with its material suppliers to develop resins that are specifically formulated for fastener and cable tie production. HellermannTyton has spearheaded material advancements in component manufacturing to assure customers the finest quality of products. Environmental factors can have an adverse effect on fasteners. It is very important to use the most suitable material for each application. HellermannTyton fasteners are available in a variety of materials ranging from polyamides (nylon) to fluoropolymers.

### Polyamide 6.6 – General Purpose

General purpose polyamide 6.6 features light weight, high strength and a wide temperature range. Polyamide 6.6 is hygroscopic, and therefore, absorbs or releases moisture depending on its environment. Thus, the moisture level of the material will affect tensile strength, stiffness and elongation of the product.



### Polyamide 6.6 – Heat Stabilized

With similar properties and benefits as polyamide 6.6, products manufactured with heat stabilized polyamide 6.6 material have a chemical stabilizer added for higher continuous temperature applications.



### \*Polyamide 6.6 – UV Resistant

Chemical inhibitors are used to give polyamide 6.6 material added properties to fight against premature aging of products due to the effects of ultraviolet rays.



### Polyamide 6.6 – UV Stabilized (2% Carbon for Military Specification)

The physical properties of this material include carbon, which acts as a UV stabilizer, prolonging the life of the product under ultraviolet conditions. It also allows HellermannTyton's black cable ties to meet the particular military specification for cable ties.



### Polyamide 6.6 – V0 Flame Retardant

This material meets UL 94V-0 flammability requirements. Flame retardant additives generally reduce tensile strength when compared to general purpose polyamide 6.6, but this resin has been formulated to minimize such effects.



### \*Polyamide 6.6 – Impact Modified, Heat Stabilized and UV Resistant

Impact modified polyamide 6.6 offers the increased flexibility, heat resistance and UV resistance of the high impact material with the added feature of greater resistance to vibration, heat and sunlight for mobile applications.



### Polyamide 6.6 – Impact Modified

Impact modifiers are added to increase flexibility. High impact polyamide 6.6 has stable tensile strength due to its reduced influence from moisture. It is excellent for high vibration applications, as within the aircraft and automobile industries and performs better than polyamide 6.6 against ultraviolet rays. Good for outdoor use.



### Polyamide 4.6

Polyamide 4.6, like polyamide 6.6, offers light weight and high strength benefits, but offers an even wider temperature range. This material can be used at a higher continuous operating temperature than polyamide 6.6 - heat stabilized. In addition to having excellent heat resistance, polyamide 4.6 has low creep effects and retention of stiffness at elevated temperatures.



### Polypropylene

Polypropylene is used in environments where chemical effects on polyamide are a concern. It is not affected by inorganic acids (hydrochloric), polyhydric alcohols (ethyleneglycol), neutral salts (sodium chloride) and basic salts (sodium bicarbonate). Polypropylene also resists a number of other chemicals with good results, although it has lower tensile strength than polyamide 6.6 (about half). Polypropylene has good UV resistance.



### Polyamide 12 - UV Resistant

Although not as strong as polyamide 6.6 (about half), polyamide 12 is extremely flexible, absorbs little moisture, ages better and has better chemical and UV resistance than general purpose polyamide 6.6. Polyamide 12 is good for applications where products are exposed to metal oxides.



### Ethylentetrafluorethylene - Tefzel

Although about two-thirds the strength of polyamide 6.6, Tefzel is resistant to a wide range of chemicals, such as concentrated hydrofluoric and sulfuric acids. It is also a low water absorbing material, therefore, is not adversely affected by water. Tefzel is radiation resistant up to 200 megarads and meets the fire and smoke requirements of IEEE 383. Tefzel also withstands high temperatures and ultraviolet light exposure. Products made from Tefzel material also have non-outgassing properties for zero gravity applications.



### Polyacetal

Polyacetal has excellent dielectric properties, UV and chemical resistance, and a UL94-HB flame rating. It has been tested for excellent weatherability against moisture, sunlight, and other environmental conditions.



### Polyetheretherketone – PEEK

This material is an excellent choice for high temperature environments. It also has excellent chemical resistance and is resistant to abrasion. PEEK material has a relatively high tensile strength and it has the ability to retain its tensile strength when continuously conditioned in water at elevated temperatures and pressures.



### Thermoplastic Vulcanizate (TPV)

TPV is a durable rubber material that is chemical and abrasion resistant and remains flexible at low temperatures.



**For more information on RoHS/WEEE Compliance, go online to: <http://www.hellermann.tyton.com/rohs.asp>**

\* UV Resistant = Material contains less than 2% carbon or a UV additive to improve UV resistance.

## Material Specifications

MATERIAL	CONTINUOUS OPERATING TEMPERATURE		TENSILE STRENGTH AT 73°F DRY AS MOLDED ASTM D-638 (PSI)	UL FLAME RATING	OXYGEN INDEX %	GAMMA RADIATION RESISTANCE	UV RESISTANCE	MILITARY, FEDERAL, ASTM AND FDA SPECIFICATIONS
	MAX.	MIN.						
<b>Polyamide 6.6 - General Purpose (PA66)</b>	185°F 85°C	-40°F -40°C	12,000	94V-2	28	1 x 10 <sup>5</sup> Rads	Poor	ASTM D-4066PA0111 FDA CFR177.1500
<b>Polyamide 6.6 - Heat Stabilized (PA66HS)</b>	221°F 105°C	-40°F -40°C	12,000	94V-2	26	1 x 10 <sup>5</sup> Rads	Poor	ASTM D-4066PA0121
<b>*Polyamide 6.6 - UV resistant (PA66UV)</b>	185°F 85°C	-40°F -40°C	12,000	94V-2	26	1 x 10 <sup>5</sup> Rads	Good	-
<b>Polyamide 6.6 - 2% Carbon UV stabilized (OUV)</b>	185°F 85°C	-40°F -40°C	12,000	94V-2	26	1 x 10 <sup>5</sup> Rads	Excellent	ASTM D-4066PA0181 MS3367/8
<b>Polyamide 6.6 - Flame Retardant (PA66VO)</b>	185°F 85°C	-40°F -40°C	10,800	94V-0	34	1 x 10 <sup>5</sup> Rads	Poor	ASTM D-4066PA0110
<b>*Polyamide 6.6 - Impact Mod. Heat Stabilized, UV Resistant (PA66HIRHS)</b>	230°F 110°C	-40°F -40°C	9,500	94-HB	N/A	N/A	Very Good	ASTM D-4066PA0161
<b>Polyamide 6.6 - Impact Modified (PA66HIR)</b>	230°F 110°C	-40°F -40°C	8,800	94-HB	19	1 x 10 <sup>5</sup> Rads	Good	ASTM D-4066PA0151
<b>Polyamide 4.6 - Heat Stabilized (PA46)</b>	275°F 135°C	-40°F -40°C	14,400	94V-2	27	9 x 10 <sup>6</sup> Rads	Poor	ASTM D-4066PA0922
<b>Polypropylene - Chemical Resistant (PP)</b>	239°F 115°C	-40°F -40°C	3,400	94-HB	N/A	1 x 10 <sup>5</sup> Rads	Good	ASTM D-4101PP0327
<b>*Polyamide 12 - UV resistant (UV)</b>	176°F 80°C	-40°F -40°C	5,800	94-HB	N/A	1 x 10 <sup>5</sup> Rads	Good	ASTM D-4066PA411
<b>Ethlenterafluorineethylene Tefzel® (E/TFE)</b>	302°F 150°C	-112°F -80°C	5,800	94V-0	30	2 x 10 <sup>8</sup> Rads	Excellent	UL2043 ASTM D-3159 Type 1 Grade 1
<b>Polyacetal (POM)</b>	185°F 85°C	-40°F -40°C	6,500	94-HB	N/A	N/A	Excellent	-
<b>Polyetheretherketone (PEEK)</b>	500°F 260°C	-67°F -55°C	14,600	94V-0	24	1 x 10 <sup>9</sup> Rads	Poor	21CFR 177.2415 EEC 93/9/EEC 151G
<b>Thermoplastic Vulcanizate (TPV)</b>	392°F 200°C	-50°F -45°C	n/a	94V-0	N/A	N/A	Excellent	-

\* UV Resistant = Material contains less than 2% carbon or a UV additive to improve UV resistance.

## Material Performance Guide

ATTRIBUTE	POLYAMIDE 6.6 GENERAL PURPOSE	POLYAMIDE 6.6 HEAT STABILIZED	POLYAMIDE 6.6 UV RESISTANT	POLYAMIDE 6.6 - 2% CARBON UV RESISTANT	POLYAMIDE 6.6 FLAME RETARDANT VO	POLYAMIDE 6.6 IMPACT MODIFIED, HEAT STABILIZED UV RESISTANT	POLYAMIDE 6.6 HIGH IMPACT	POLYAMIDE 4.6 HEAT STABILIZED	POLYPROPYLENE	POLYAMIDE 12 UV RESISTANT	ETHYLENTERAFLUORINE-ETHYLENE — E/TFE	POLYACETAL	PEEK	TPV
<b>Tensile Strength</b>	8	8	8	9	7	8	7	10	2	4	5	5	10	-
<b>High Temperature</b>	2	3	2	2	2	3	2	9	2	1	10	3	10	10
<b>Flammability</b>	5	5	5	5	10	2	2	5	2	2	10	2	10	2
<b>UV Resistance</b>	1	1	5	8	1	8	2	1	5	3	10	10	1	1
<b>Radiation</b>	3	3	3	3	3	3	3	6	3	3	8	3	10	-
<b>Chemical Resistance</b>	6	6	6	6	6	6	6	6	8	8	10	-	10	-
<b>-Hydrocarbons</b>	8	8	8	8	8	8	8	8	6	8	10	8	10	4
<b>-Chlorinated Hydrocarbons</b>	6	6	6	6	6	6	6	6	3	8	10	5	10	4
<b>-Acids</b>	2	2	2	2	2	2	2	2	8	5	10	8	5	8
<b>-Bases</b>	8	6	6	6	6	6	6	6	8	6	10	8	10	8
<b>-Salts</b>	3	3	3	3	3	3	3	3	10	8	10	8	10	8
<b>Relative Cost</b>	Low	Low	Med.	Med.	Med.	Med.	Med.	Med.	Med.	Med.	High	Med.	High	Med.

10 = Most Recommended 1 = Least Recommended

## Dual Swivel Saddle Spacer

### DSWS4

These saddle spacers are installed between two bundles (such as wires, cables, hoses, tubing, conduit, etc.) to separate them and prevent chafing and wear. The mounts can be easily rotated by hand, allowing the bundles to be crossed and rotated at any angle. Cable ties, which secure the bundles, are used with the mounts. The dual swivel saddle spacers accommodate cable ties up to 1/2" wide.

The "H" profile of the saddles allows for broad surface contact with the bundle, minimizing pinching and crushing of the bundle, and it accepts a wide range of bundle diameters from .25 inches to 3 inches.

The DSWS4 Dual Swivel Saddle Spacer provides a .7 inch (17.8 millimeter) separation between bundles. Friction tabs in the tie slots help hold the cable ties in place during assembly.

The DSWS4 is two-shot molded with polyacetal and polyamide 6.6 heat stabilized materials.



Material Data	
Material	<b>Polyacetal (POM)</b>
Operating Temperature	<b>-40 °F to +185 °F (-40 °C to +85 °C) continuous</b>
Flammability	<b>UL94 HB</b>

RoHS

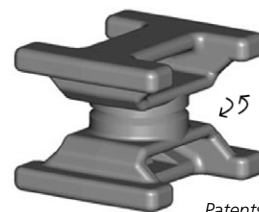

25 swivels

Patents Pending

Material Data	
Material	<b>Polyamide 6.6 heat stabilized (PA66HS)</b>
Operating Temperature	<b>-40 °F to +221 °F (-40 °C to +105 °C) continuous</b>
Flammability	<b>UL94 V2</b>

RoHS

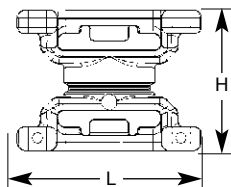

Product Selection										
Article No.	Part No.	Type	Cable Tie Series	Bundle Ø	Minimum Extraction Strength	Length (L)	Width (W)	Height (H)	Color	Pkg. Qty.
				in. (mm)	lb. (N)	in. (mm)	in. (mm)	in. (mm)		
151-06500	<b>151-06500</b>	DSWS4	T50 - T250	.25" - 3" (6.35 - 76.2)	100 lb. (445)	.93" (23.6)	.8" (20.3)	.71" (18)	Black	2200
151-00644	<b>151-00644</b>	DSWS4	T50 - T250	.25" - 3" (6.35 - 76.2)	100 lb. (445)	.93" (23.6)	.8" (20.3)	.71" (18)	Black	50

Dimensions are approximate and subject to technical changes. Use **Part No.** for ordering and **Type** for specification purposes.

## Dual Swivel Saddle Spacer

### DSWS5

These saddle spacers are installed between two bundles (such as wires, cables, hoses, tubing, conduit, etc.) to separate them and prevent chafing and wear. The spacers can be easily rotated by hand, allowing the bundles to be crossed and rotated at any angle. Cable ties, which secure the bundles, are used with the spacers.

The DSWS5 accepts bundle diameters ranging from .625 inches to 6 inches. The DSWS5 provides a .93 inch (23.6 millimeter) separation between bundles. The dual swivel saddle spacers accommodate cable ties up to 1/2" wide.



Material Data	
Material	Polyamide 6.6 heat stabilized (PA66HS)
Operating Temperature	-40 °F to +221 °F (-40 °C to +105 °C) continuous
Flammability	UL94 V2

RoHS

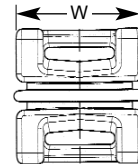
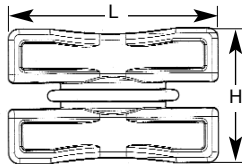
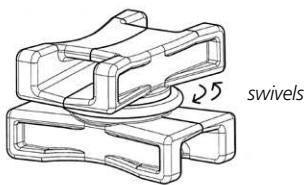

Product Selection									
Article No.	Part No.	Type	Cable Tie Series	Bundle Ø	Length (L)	Width (W)	Height (H)	Color	Pkg. Qty.
				in. (mm)	in. (mm)	in. (mm)	in. (mm)		
151-06502	<b>DSWS50HSK2</b>	DSWS5	T50 - T250	.625" - 6" (15.8 - 152.4)	1.6" (40.6)	1" (25.4)	.93" (23.6)	Black	50
151-06501	<b>DSWS50HSH1</b>	DSWS5	T50 - T250	.625" - 6" (15.8 - 152.4)	1.6" (40.6)	1" (25.4)	.93" (23.6)	Black	500

Dimensions are approximate and subject to technical changes. Use **Part No.** for ordering and **Type** for specification purposes.

## Dual Clamp Ties

HellermannTyton's dual clamp ties are designed to provide parallel separation between hoses, wires, cables and tubing, protecting them from abrasion. These ties have an optional mounting hole for securing bundles along the chassis of trucks, trailers, and heavy duty equipment. The unique, one-piece design features the dual head centered on the strap.

Available in two lengths, the dual clamp ties accommodate bundles ranging from .25 inches to 2.3 inches. The flexible wide straps minimize pinching of hoses and convoluted tubing. The straps are also releasable.



U.S. Patent Number 5,966,781

Material Data		RoHS
Material	<b>Polyamide 6.6 impact modified, Heat Stabilized, UV Resistant (PA66HIRHS)</b>	
Operating Temperature	<b>-40 °F to +230 °F (-40 °C to +110 °C) continuous</b>	
Flammability	<b>UL94 HB</b>	

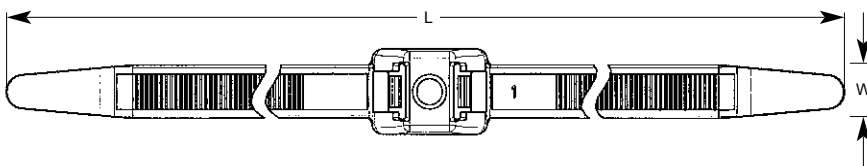

Product Selection			Stud Ø	Min. Tensile Strength	Length (L)	Max. Ø Bundle (each side)	Width (W)	Color	Pkg. Qty.
Article No.	Part No.	Type							
115-30900	<b>DCT90HIRK2</b>	DCT9	.25 " (6.35)	150 lbs (670)	13.0" (331)	1.3" (33.02)	.50" (12.7)	Black	50
115-00034	<b>DCT90HIRC2</b>	DCT9	.25 " (6.35)	150 lbs (670)	13.0" (331)	1.3" (33.02)	.50" (12.7)	Black	100
115-31100	<b>DCT110HIRK2</b>	DCT11	.25 " (6.35)	150 lbs (670)	19.2" (489)	2.3" (58.42)	.50" (12.7)	Black	50
115-00033	<b>DCT110HIRC2</b>	DCT11	.25 " (6.35)	150 lbs (670)	19.2" (489)	2.3" (58.42)	.50" (12.7)	Black	100

Installation tools - MK9, MK9HT, MK9P. Dimensions are approximate and subject to technical changes. Use **Part No.** for ordering and **Type** for specification purposes.

## Standoff Mounting Dual Clamp Ties

HellermannTyton's standoff dual clamp tie offers the same features as the standard dual clamp tie with a standoff mount that secures the bundle away from the side of the frame rail, protecting the bundles from bolts and other protrusions.

### Features

- Wide strap minimizes pinching of soft hoses & convoluted tubing
- Clamping rails increase circumferential grip on varying bundle diameters
- Locking stud mount pawls allow for easy hand insertion
- Nut or weld nesting counterbore provides flush mounting at the base
- Socket counterbore for fastening a nut provides added retention



Material Data		RoHS
Material	<b>Polyamide 6.6 impact modified, Heat Stabilized, UV Resistant (PA66HIRHS)</b>	
Operating Temperature	<b>-40 °F to +230 °F (-40 °C to +110 °C) continuous</b>	
Flammability	<b>UL94 HB</b>	

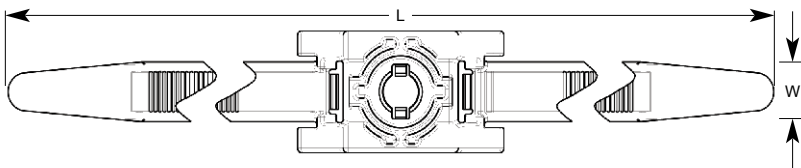

Product Selection			Stud Ø	Min. Tensile Strength	Length (L)	Max. Ø Bundle (each side)	Width (W)	Color	Pkg. Qty.
Article No.	Part No.	Type	in. (mm)	lbs. (N)	in. (mm)	in. (mm)	in. (mm)		
117-00012	<b>117-00012</b>	SDCTR312	.31" (7.94)	100 lbs (445)	20.1" (511)	2.3" (58.42)	.50" (12.7)	Black	250
157-00060	<b>157-00060</b>	SDCTL312	.31" (7.94)	100 lbs (445)	26.1" (663)	3.4" (86.36)	.50" (12.7)	Black	250

Installation tools - MK9, MK9HT, MK9P. Dimensions are approximate and subject to technical changes. Use **Part No.** for ordering and **Type** for specification purposes.

## Double Head Ties

Double head ties create two loops that separate two bundles. They can also be used to secure a bundle to an existing fixing point.

Material Data	
Material	<b>Polyamide 6.6 (PA66)</b>
Operating Temperature	<b>-40 °F to +185 °F (-40 °C to +85 °C)</b> <b>continuous</b>
Flammability	<b>UL94 V2</b>

RoHS

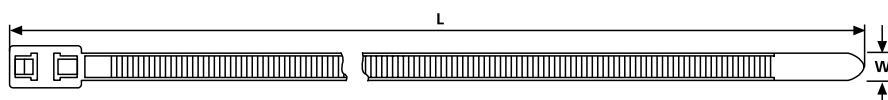

**UL**  
File# E64139

File# E64139

Product Selection			Min. Tensile Strength		Length (L)		Width (W)		Color	Pkg. Qty.
Article No.	Part No.	Type	lbs.	(N)	in.	(mm)	in.	(mm)		
T50SDH										
117-00016	117-00016	T50SDH	50 lbs	(225)	6.26"	(159)	.19"	(4.7)	Natural	100
117-00017	117-00017	T50SDH	50 lbs	(225)	6.26"	(159)	.19"	(4.7)		1000
117-00018	117-00018	T50SDH	50 lbs	(225)	6.26"	(159)	.19"	(4.7)	Black	100
117-00019	117-00019	T50SDH	50 lbs	(225)	6.26"	(159)	.19"	(4.7)		1000
T50RDH										
117-05006	T50RDH9C2	T50RDH	50 lbs	(225)	8.25"	(210)	.19"	(4.7)	Natural	100
117-05008	T50RDH9M4	T50RDH	50 lbs	(225)	8.25"	(210)	.19"	(4.7)		1000
117-05004	T50RDH0C2	T50RDH	50 lbs	(225)	8.25"	(210)	.19"	(4.7)	Black	100
117-05005	T50RDH0M4	T50RDH	50 lbs	(225)	8.25"	(210)	.19"	(4.7)		1000
T50IDH										
117-05302	T50IDH9C2	T50IDH	50 lbs	(225)	12"	(305)	.19"	(4.7)	Natural	100
117-05303	T50IDH9M4	T50IDH	50 lbs	(225)	12"	(305)	.19"	(4.7)		1000
117-05362	T50IDH0C2	T50IDH	50 lbs	(225)	12"	(305)	.19"	(4.7)	Black	100
117-05300	T50IDH0M4	T50IDH	50 lbs	(225)	12"	(305)	.19"	(4.7)		1000
T50LDH										
117-05402	T50LDH9C2	T50LDH	50 lbs	(225)	15.5"	(395)	.19"	(4.7)	Natural	100
117-05461	T50LDH9M4	T50LDH	50 lbs	(225)	15.5"	(395)	.19"	(4.7)		1000
117-05400	T50LDH0C2	T50LDH	50 lbs	(225)	15.5"	(395)	.19"	(4.7)	Black	100
117-05401	T50LDH0M4	T50LDH	50 lbs	(225)	15.5"	(395)	.19"	(4.7)		1000
T120RDH										
117-05501	T120RDH0K2	T120RDH	120 lbs	(535)	15.7"	(398)	.29"	(7.6)	Black	50
117-05500	T120RDH0H4	T120RDH	120 lbs	(535)	15.7"	(398)	.29"	(7.6)		500

Maximum bundle diameter is variable due to double loops. Installation tools - MK7, MK7HT, MK7P, MK9, MK9HT, MK9P. Dimensions are approximate and subject to technical changes. Use **Part No.** for ordering and **Type** for specification purposes.

## Pipe and Hose Clips, PC-Series

Pipe and hose clips offer simple and secure installation of pipes or hoses to panels. These clips can be attached to the panel prior to installing the pipe or hose. Simply push the pipe into the clip for a firm and secure fixing. These parts can be connected together offering a greater choice of installation options.



Material Data		RoHS
Material	<b>Polyamide 6.6 (PA66)</b>	
Operating Temperature	<b>-40 °F to +185 °F (-40 °C to +85 °C) continuous</b>	
Flammability	<b>UL94 V2</b>	

Material Data		RoHS
Material	<b>Polyamide 6.6 impact modified (PA66HIR)</b>	
Operating Temperature	<b>-40 °F to +176 °F (-40 °C to +80 °C) continuous</b>	
Flammability	<b>UL94 HB</b>	

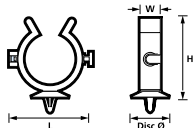

Product Selection											
Article No.	Part No.	Type	Height (H)	Width (W)	Disc Ø	Max. Ø Bundle	Mounting Hole Ø	Max. Panel Thickness	Material	Color	Pkg. Qty.
			in. (mm)	in. (mm)	in. (mm)	in. (mm)	in. (mm)	in. (mm)			
151-00096	<b>151-00096</b>	IPC10AH	.72" (18.4)	.39" (10)	.87" (22)	.49" (12.5)	.25" (6.3)	.06" (1.6)	PA66HIR	Black	100
151-14130	<b>151-14130</b>	IPC13AH	.83" (21)	.39" (10)	.87" (22)	.53" (13.5)	.25" (6.3)	.06" (1.6)	PA66	Black	100
151-14500	<b>151-14500</b>	IPC15AH	.91" (23)	.39" (10)	.87" (22)	.58" (14.7)	.25" (6.3)	.06" (1.6)	PA66HIR	Black	100
151-14601	<b>151-14601</b>	IPC23AH	1.3" (34)	.39" (10)	.87" (22)	.98" (25)	.25" (6.3)	.06" (1.6)	PA66	Black	100

Use **Part No.** for ordering and **Type** for specification purposes.

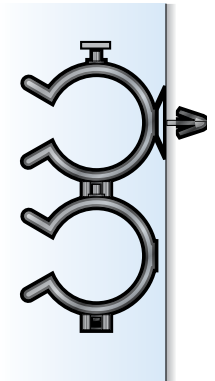
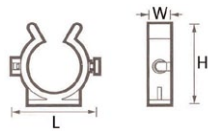

IPC AH Clip connected

Product Selection								
Article No.	Part No.	Type	Height (H)	Width (W)	Max. Ø Bundle	Material	Color	Pkg. Qty.
			in. (mm)	in. (mm)	in. (mm)			
151-14400	<b>151-14400</b>	IPC10P	.59" (15)	.39" (10)	.49" (12.5)	PA66HIR	Black	100
151-14132	<b>151-14132</b>	IPC13P	.69" (17.4)	.39" (10)	.53" (13.5)	PA66	Black	100
151-14502	<b>151-14502</b>	IPC15P	.77" (19.5)	.39" (10)	.58" (14.7)	PA66HIR	Black	100
151-14603	<b>151-14603</b>	IPC23P	1.2" (30.5)	.39" (10)	.98" (25)	PA66	Black	100

Use **Part No.** for ordering and **Type** for specification purposes.

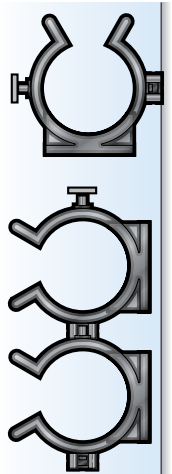

IPC P Clip connected

## Automatic Harness Clips — Connectable

In addition to offering the same simple and secure method of attaching cables to panels as the non-connectable automatic harness clips, these products can be connected for additional installation flexibility.

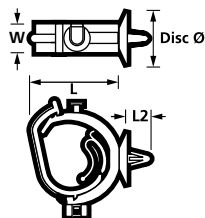

Material Data		RoHS
Material	Polyamide 6.6 impact modified, Heat Stabilized, UV Resistant (PA66HIRHS)	
Operating Temperature	-40 °F to +230 °F (-40 °C to +110 °C) continuous	
Flammability	UL94 HB	

### Product Selection

Article No.	Part No.	Type	Length (L)	Length (L2)	Width (W)	Disc Ø	Max. Ø Bundle	Mounting Hole Ø	Panel Thickness in. (mm)		Color	Pkg. Qty.
			in. (mm)	in. (mm)	in. (mm)				Min.	Max.		
151-00378	151-00378	IAHC3AH	1.5" (39)	.28" (7)	.39" (10)	.94" (24)	1.1" (28)	.24 - .26" (6.2 - 6.7)	.02" (.5)	.1" (2.7)	Black	500
151-00211	151-00211	IAHC4AH	1.8" (46)	.28" (7)	.51" (13)	.94" (24)	1.4" (36)	.24 - .26" (6.2 - 6.7)	.02" (.5)	.1" (2.5)	Black	450

Use **Part No.** for ordering and **Type** for specification purposes.

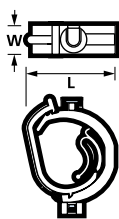

### Product Selection

Article No.	Part No.	Type	Length (L)	Width (W)	Max. Ø Bundle	Color	Pkg. Qty.
			in. (mm)	in. (mm)	in. (mm)		
151-00223	151-00223	IAHC1T	.91" (23)	.39" (10)	.51" (13)	Black	1300
151-00199	151-00199	IAHC2T	1.18" (30)	.39" (10)	.79" (20)	Black	700
151-00213	151-00213	IAHC3T	1.6" (40)	.39" (10)	1.1" (28)	Black	400
151-00207	151-00207	IAHC4T	1.9" (47)	.53" (13.5)	1.4" (36)	Black	1000
151-00195	151-00195	IAHC5T	2.24" (57)	.53" (13.5)	1.8" (45)	Black	700

Use **Part No.** for ordering and **Type** for specification purposes.

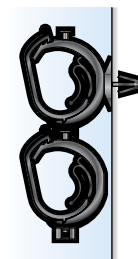

Elements AH and T connected.

## Automatic Harness Clips — Non-connectable

These clips offer a simple and secure method of attaching cables to panels. They can be attached to the panel prior to installing the cables. Simply pushing the cable into place closes the clip and activates the automatic locking feature.

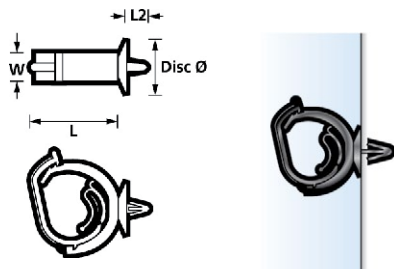

### Material Data

Material	<b>Polyamide 6.6 impact modified, Heat Stabilized, UV Resistant (PA66HIRHS)</b>
Operating Temperature	<b>-40 °F to +230 °F (-40 °C to +110 °C)</b>
Flammability	<b>UL94 HB</b>



### Product Selection

Article No.	Part No.	Type	Length (L)	Length (L2)	Width (W)	Disc Ø	Max. Ø Bundle	Mounting Hole Ø	Min. Panel Thickness	Max. Panel Thickness	Color	Pkg. Qty.
			in. (mm)	in. (mm)	in. (mm)	in. (mm)	in. (mm)	in. (mm)	in. (mm)	in. (mm)		
151-00366	<b>151-00366</b>	AHC1AH	.98" (25)	.28" (7)	.39" (10)	.79" (20)	.51" (13)	.24 - .26" (6.2 - 6.7)	.02" (.5)	.08" (2)	Black	1500
151-00367	<b>151-00367</b>	AHC2AH	1.16" (29.5)	.28" (7)	.39" (10)	.79" (20)	.79" (20)	.24 - .26" (6.2 - 6.7)	.02" (.5)	.08" (2)	Black	900

Use **Part No.** for ordering and **Type** for specification purposes.

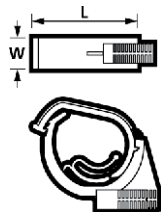

### Product Selection

Article No.	Part No.	Type	Stud Ø	Length (L)	Width (W)	Max. Ø Bundle	Color	Pkg. Qty.
			in. (mm)	in. (mm)	in. (mm)	in. (mm)		
151-00206	<b>151-00206</b>	AHC2SS	.20" (5)	1.24" (31.5)	.39" (10)	.79" (20)	Black	1000

Use **Part No.** for ordering and **Type** for specification purposes.

## Isolator

HellermannTyton's isolator mount is used to align and separate 1/4" tubing or brake lines. Easy to assemble, the isolator dampens vibrations and can be used with up to four brake lines. Mounting the isolator can be accomplished with HellermannTyton's standard cable ties, button head ties and any of HellermannTyton's heavy equipment mounts. Mounting is optional, but recommended for long runs. The isolator is durable, chemical and abrasion resistant, and remains flexible in low temperatures.



Material Data		RoHS
Material	<b>Thermoplastic Vulcanizate (TPV)</b>	
Operating Temperature	<b>-50 °F to +329 °F (-45 °C to +200 °C) continuous</b>	
Flammability	<b>UL94 HB</b>	

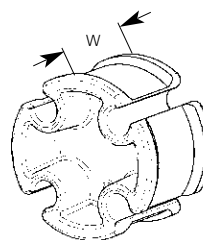

Product Selection				Max Bundle Ø	Mounting Ø	Overall Ø	Spacing Between Clips	Width (W)	Color	Pkg. Qty.
Article No.	Part No.	Type	Cable Tie Series	in. (mm)	in. (mm)	in. (mm)	in. (mm)	in. (mm)		
151-00455	<b>ISO4X250H1</b>	ISO4X250	T50 - T250	.25" (6.4)	1.34" (34)	1.44" (36.6)	.51" (13)	.92" (23.4)	Black	500

Dimensions are approximate and subject to technical changes. Use **Part No.** for ordering and **Type** for specification purposes.

## Omega Clip Cable Ties

Omega Clip Cable Ties provide the opportunity to attach a wire or hose to an existing bundle. Offering a full range of orientations, the wire/hose can be oriented in any direction in relation to the main harness. The Omega Clip design is ideally suited for easing the application process on the production floor by allowing for an easy one-step snap fit of the harness assembly to the wire or hose.



*Omega Clips secure cables to harnesses, hoses, or tubular frame rails.*

### Material Data - Cable Ties

Material	<b>Polyamide 6.6 heat stabilized (PA66HS)</b>
Operating Temperature	<b>-40 °F to +221 °F (-40 °C to +105 °C) continuous</b>
Flammability	<b>UL94 V2</b>



### Material Data - Omega Clips

Material	<b>Polyamide 6.6 impact modified, heat stabilized, UV resistant (PA66HIRHS)</b>
Operating Temperature	<b>-40 °F to +230 °F (-40 °C to +110 °C) continuous</b>
Flammability	<b>UL94 HB</b>



### Product Selection

Article No.	Part No.	Type	Tensile Strength	Length (L)	Maximum Bundle Ø	Attaches to Diameter	Color	Pkg. Qty.	Drawing
			lbs (N)	in. (mm)	in. (mm)	in. (mm)			
156-00036	<b>156-00036</b>	T50ROC1A	50 (225)	7.9 (200)	1.8 (45)	0.16 - 0.40 (4.0 - 10.0)	Black	500	
156-00306	<b>156-00306</b>	T50ROC1B	50 (225)	7.9 (200)	1.8 (45)	0.16 - 0.40 (4.0 - 10.0)	Black	500	
156-00134	<b>156-00134</b>	T50SVC OC10-14	50 (225)	6.0 (155)	1.4 (35)	.40 - .55 (10.0 - 14.0)	Black	500	
156-00135	<b>156-00135</b>	T50SVC OC15-18	50 (225)	6.0 (155)	1.4 (35)	.60 - .71 (15.0 - 18.0)	Black	500	
156-00136	<b>156-00136</b>	T50SVC OC19-24.5	50 (225)	6.0 (155)	1.4 (35)	.75-.96 (19.0 - 24.5)	Black	500	
156-00272	<b>156-00272</b>	T50SVC OC25-31	50 (225)	6.0 (155)	1.4 (35)	.98-1.22 (25.0 - 31.0)	Black	250	
156-00273	<b>156-00273</b>	T50SVC OC31-39	50 (225)	6.0 (155)	1.4 (35)	1.22 -1.54 (31.0 - 39.0)	Black	250	
156-00137	<b>156-00137</b>	T50SVC OC39-45	50 (225)	6.0 (155)	1.4 (35)	1.54 -1.77 (39.0 - 45.0)	Black	250	

Installation tools - MK7, MK7HT, MK7P, MK9, MK9HT, MK9P. Dimensions are approximate and subject to technical changes. Use **Part No.** for ordering and **Type** for specification purposes.

## Wire Clamping Cable Ties

Wire Clamping Ties were designed as an innovative solution to mounting wire or cable harness assemblies to wire suspension frames found in seating applications. The clamp easily secures to the wire frame for a tight fit and is available in four different wire frame sizes and two separate orientations to provide both perpendicular and parallel routing. The wire clamp design is ideally suited for easing the application process on the production floor by allowing for an easy snap fit of the harness assembly to the wire frame.

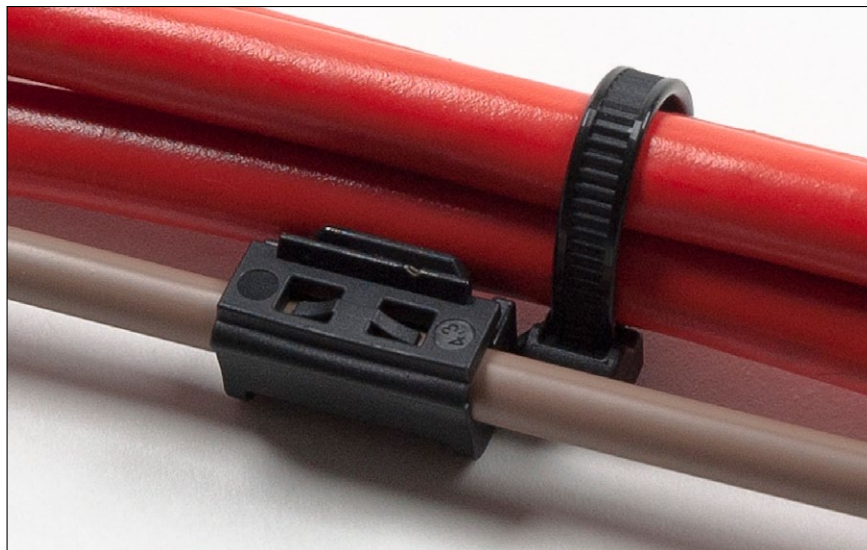

Material Data	
Material	Polyamide 6.6 heat stabilized (PA66HS)
Operating Temperature	-40 °F to +221 °F (-40 °C to +105 °C) continuous
Flammability	UL94 V2



### Product Selection

Product Selection											
Article No.	Part No.	Type	Tensile Strength	Length (L)	Maximum Bundle Ø	Attaches to Diameter	Color	Pkg. Qty.	Drawing		
			lbs (N)	in. (mm)	in. (mm)	in. (mm)					
148-00089	148-00089	T50SOSWA1.8E	50 (225)	6 (150)	1.4 (35)	.07 (1.8)	Black	500			
148-00088	148-00088	T50SOSWA2.0E	50 (225)	6 (150)	1.4 (35)	.09 (2.18)	Black	500			
148-00095	148-00095	T50SOSWA3.4E	50 (225)	6 (150)	1.4 (35)	.13 (3.4)	Black	500			
148-00092	148-00092	T50SOSWA4.3E	50 (225)	6 (150)	1.4 (35)	.17 (4.3)	Black	500			
148-00090	148-00090	T50SOSWB1.8E	50 (225)	6 (150)	1.4 (35)	.07 (1.8)	Black	500			
148-00093	148-00093	T50SOSWB2.0E	50 (225)	6 (150)	1.4 (35)	.09 (2.18)	Black	500			
148-00096	148-00096	T50SOSWB3.4E	50 (225)	6 (150)	1.4 (35)	.13 (3.4)	Black	500			
148-00091	148-00091	T50SOSWB4.3E	50 (225)	6 (150)	1.4 (35)	.17 (4.3)	Black	500			

Installation tools - MK7, MK7HT, MK7P, MK9, MK9HT, MK9P. Dimensions are approximate and subject to technical changes. Use **Part No.** for ordering and **Type** for specification purposes.

## Wire and Hose Swivel Clip Ties

These simple to use inside serrated ties provide the opportunity to attach an additional wire or hose to an existing harness. Offering a full 360 degrees of rotation, the wire/hose can be oriented in any direction in relation to the main harness. It is ideally suited for any application in which the wire or hose can move in relation to the mounting point.

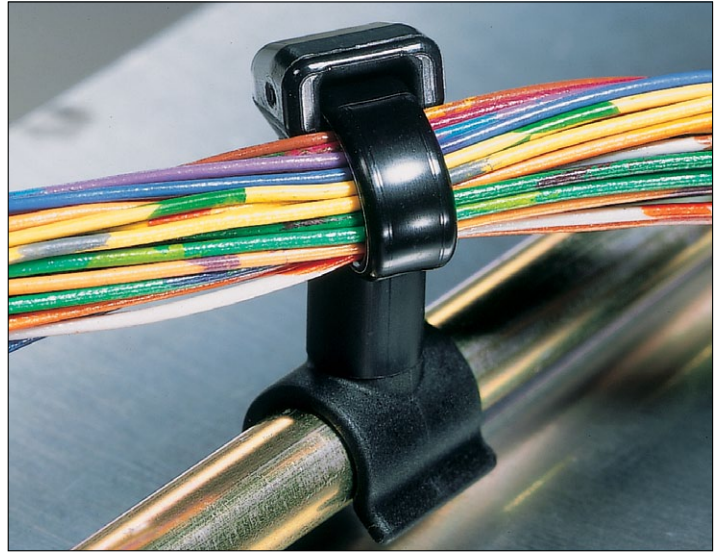

*T50SVC rotates in any direction.*

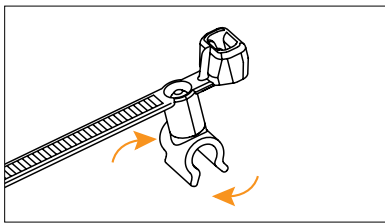

*T50SVC4/T50SVC5*

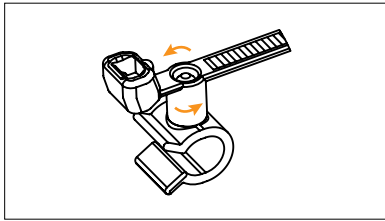

*T50SVC6.5*

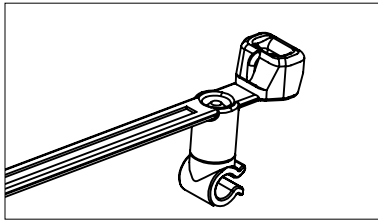

*T50SVC3.5*

Material Data	
Material	Polyamide 6.6 heat stabilized (PA66HS)
Operating Temperature	-40 °F to +221 °F (-40 °C to +105 °C) continuous
Flammability	UL94 V2



### Product Selection

Article No.	Part No.	Type	Tensile Strength		Hose Clip Ø in. (mm)	Maximum Bundle Ø in. (mm)	Length (L) in. (mm)	Width (W) in. (mm)	Color	Pkg. Qty.
			lbs	(N)						
156-00791	<b>156-00791</b>	T50SVC3.5	50 lbs	(222)	.13 - .17 (3.4 - 3.6)	1.4 (35)	6.35 (163)	.18 (4.6)	Black	1000
156-00318	<b>156-00318</b>	T50SVC4	50 lbs	(225)	.15 - .17 (3.8 - 4.2)	1.38 (35)	6.1 (155)	.19 (4.7)	Black Natural	500
155-31202	<b>155-31202</b>	T50SVCS	50 lbs	(222)	.17 - .20 (4.5 - 5.2)	1.4 (35)	6.35 (163)	.18 (4.6)	Black	500
156-00155	<b>156-31202</b>	T50SVC6.5	50 lbs	(222)	.26 - .32 (6.5 - 8.0)	1.38 (35)	6.1 (155)	.19 (4.7)	Black	500

Installation tools - MK7, MK7HT, MK7P, MK9, MK9HT, MK9P. Dimensions are approximate and subject to technical changes. Use **Part No.** for ordering and **Type** for specification purposes.

## H-Mount Series

HellermannTyton's new H-mount product line offers a secure bundle mounting solution that utilizes existing frame bolts. H-mounts fasten to three bolt sizes:  $\frac{1}{2}$ ",  $\frac{5}{8}$ " and  $\frac{3}{4}$ ". The H-mounts have three bundle mounting locations, each accommodating ties up to  $\frac{1}{2}$ " wide.

5

### Application

The preferred mount method is to use the specially designed drill bit to spin the H-mount onto the bolt. The bit fits all  $\frac{1}{4}$ " drills and has tapered sides to secure the H-mount during installation.

### Benefits

- The H-mounts utilize existing frame bolts which reduces component costs and improves installation time.
- The H-mounts have a top tie slot which allows the bundle to be positioned directly over the bolt, and two curved tie slots on the sides that minimize bundle abrasion and positions the bundles adjacent to the bolt yet away from the frame.



Material Data	
Material	Polyamide 6.6 high impact modified, heat and UV stabilized (PA66HIRHSUV)
Operating Temperature	-40 °F to +230 °F (-40 °C to +110 °C) continuous
Flammability	UL94 HB

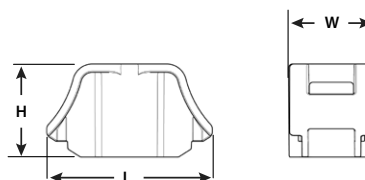

Product Selection								
Article No.	Part No.	Type	Stud Bolt Size	Length (L)	Width (W)	Height (H)	Color	Pkg. Qty.
			in. (mm)	in. (mm)	in. (mm)	in. (mm)		
151-00812	<b>151-00812</b>	HM5	.5" (12.7)	1.97" (50.0)	1.02" (25.98)	1.1" (28.0)	Black	900
151-00813	<b>151-00813</b>	HM6	.625" (15.9)	1.97" (50.0)	1.02" (25.98)	1.1" (28.0)	Black	900
151-00814	<b>151-00814</b>	HM7	.75" (19.0)	1.97" (50.0)	1.02" (25.98)	1.1" (28.0)	Black	900

Dimensions are approximate and subject to technical changes. Use **Part No.** for ordering and **Type** for specification purposes.

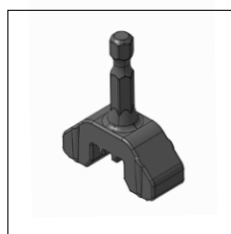

904-00284

Accessory				
Article No.	Part No.	Type	Color	Pkg. Qty.
904-00284	<b>904-00284</b>	HBIT	Black	1



H Bit in the H Mount

## Heavy Duty Mounts

The heavy duty mount, when used with a cable tie, eliminates the need to carry multiple sizes of fixed bundle diameter clamps, which reduces inventory and purchasing costs while simplifying the assembly process.

The heavy duty mount and cable tie combination makes it easy to service bundles in the field. Simply remove the cable tie, leave the mount in place, and replace the cable tie.

The heavy duty mounts are designed for use with HellermannTyton's heavy duty T250, T255, and wide strap cable ties to harness wires and hoses; however, they accept all standard cable ties up to .5" wide.



U.S. Patent Number 5,820,083

Material Data		RoHS
Material	<b>Polyamide 6.6 impact modified, Heat Stabilized, UV Resistant (PA66HIRHS)</b>	
Operating Temperature	<b>-40 °F to +230 °F (-40 °C to +110 °C) continuous</b>	
Flammability	<b>UL94 HB</b>	

## Standard Torque Mounts

These mounts contain a small tab inside the mounting hole to temporarily engage the threads, which allows assemblers to pre-install the mount on a stud before securing with a washer and a nut.

Product Selection		Type	Mounting	Max Torque	Max Ø for Washer/Socket	Length (L)	Width (W)	Color	Pkg. Qty.
Article No.	Part No.		in. (mm)	lb. - in	in. (mm)	in. (mm)	in. (mm)		
151-00134	<b>HDM190HIRC2</b>	HDM19	.1875 (4.8)	115 lb. - in.	.73" (18.5)	1.43" (36.32)	.76" (19.3)	Black	100
151-00436	<b>HDM190HIRH4</b>	HDM19	.1875 (4.8)	115 lb. - in.	.73" (18.5)	1.43" (36.32)	.76" (19.3)	Black	500
151-00437	<b>HDM250HIRC2</b>	HDM25	.25" (6.4)	115 lb. - in.	.73" (18.5)	1.43" (36.32)	.76" (19.3)	Black	100
151-00438	<b>HDM250HIRH4</b>	HDM25	.25" (6.4)	115 lb. - in.	.73" (18.5)	1.43" (36.32)	.76" (19.3)	Black	500
151-00439	<b>HDM3120HIRC2</b>	HDM312	.3125" (8)	115 lb. - in.	.73" (18.5)	1.43" (36.32)	.76" (19.3)	Black	100
151-00440	<b>HDM3120HIRH4</b>	HDM312	.3125" (8)	115 lb. - in.	.73" (18.5)	1.43" (36.32)	.76" (19.3)	Black	500

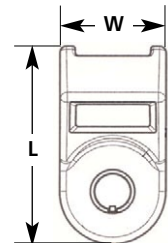

Dimensions are approximate and subject to technical changes. Use **Part No.** for ordering and **Type** for specification purposes.

## Medium Torque Mounts

The arched "H" profile of the saddle surface allows for a broad surface contact with the bundle, minimizing pinching and crushing of the bundles, and adjusts to a wide variety of bundle diameters.

Product Selection		Type	Mounting	Max Torque	Max Ø for Washer/Socket	Length (L)	Width (W)	Color	Pkg. Qty.
Article No.	Part No.		in. (mm)	lb. - ft.	in. (mm)	in. (mm)	in. (mm)		
151-00441	<b>HDM321HIHSUVC2</b>	HDM321	.3125" (8)	40 lb. - ft.	.90" (23)	1.8" (46)	.96" (24)	Black	100
151-07100	<b>HDM321HIHSUVH4</b>	HDM321	.3125" (8)	40 lb. - ft.	.90" (23)	1.8" (46)	.96" (24)	Black	500
151-00442	<b>HDM401HIHSUVC2</b>	HDM401	.375" (9.5)	40 lb. - ft.	.90" (23)	1.8" (46)	.96" (24)	Black	100
151-07300	<b>HDM401HIHSUVH4</b>	HDM401	.375" (9.5)	40 lb. - ft.	.90" (23)	1.8" (46)	.96" (24)	Black	500
151-00443	<b>HDM501HIHSUVC2</b>	HDM501	.5" (12.7)	40 lb. - ft.	.90" (23)	1.8" (46)	.96" (24)	Black	100
151-07500	<b>HDM501HIHSUVH4</b>	HDM501	.5" (12.7)	40 lb. - ft.	.90" (23)	1.8" (46)	.96" (24)	Black	500

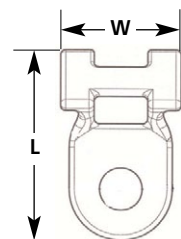

Dimensions are approximate and subject to technical changes. Use **Part No.** for ordering and **Type** for specification purposes.

## High Torque Mounts

The high torque mount is designed for use with power-assisted impact wrenches and is molded with a metal bushing to withstand the forces required to tighten grade 8 bolts. The arched "H" profile of the saddle surface allows for a broad surface contact with the bundle, minimizing pinching and crushing of bundles, and it adjusts to a wide variety of bundle diameters.

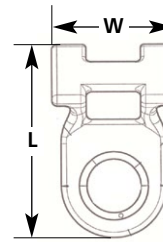

Product Selection									
Article No.	Part No.	Type	Mounting	Max Torque	Max Ø for Washer/Socket	Length (L)	Width (W)	Color	Pkg. Qty.
			in. (mm)	lb. - ft.	in. (mm)	in. (mm)	in. (mm)		
151-00444	<b>HDM320BHIHSUVC2</b>	HDM320	.3125" (8)	114 lb. - ft.	.9" (23)	1.85" (47)	.99" (25)	Black	100
151-07000	<b>HDM320BHIHSUVH4</b>	HDM320	.3125" (8)	114 lb. - ft.	.9" (23)	1.85" (47)	.99" (25)	Black	500
151-00445	<b>HDM400BHISHUVC2</b>	HDM400	.375" (9.5)	114 lb. - ft.	1.26" (32)	1.85" (47)	.99" (25)	Black	100
151-07200	<b>HDM400BHIHSUVH4</b>	HDM400	.375" (9.5)	114 lb. - ft.	1.26" (32)	1.85" (47)	.99" (25)	Black	500
151-00446	<b>HDM500BHIHSUVC2</b>	HDM500	.5" (12.7)	114 lb. - ft.	1.26" (32)	1.85" (47)	.99" (25)	Black	100
151-07400	<b>HDM500BHIHSUVH4</b>	HDM500	.5" (12.7)	114 lb. - ft.	1.26" (32)	1.85" (47)	.99" (25)	Black	500

Dimensions are approximate and subject to technical changes. Use **Part No.** for ordering and **Type** for specification purposes.

## High Torque Double Mount

This mount is designed for use with power-assisted impact wrenches and is molded with a metal bushing to withstand the forces required to tighten grade 8 bolts. The high torque double mount secures the bundle directly over the mounting fastener. The arched saddle surface allows for a broad surface contact with the bundle, minimizing pinching and crushing of the bundles, and accommodates a wide variety of bundle diameters.

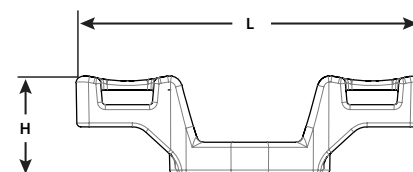
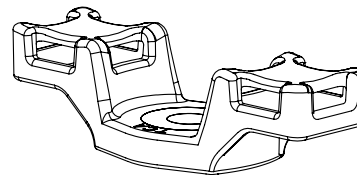

Product Selection									
Article No.	Part No.	Type	Mounting	Max Torque	Max Ø for Washer/Socket	Length (L)	Height (H)	Color	Pkg. Qty.
			in. (mm)	lb. - ft.	in. (mm)	in. (mm)	in. (mm)		
151-00756	<b>151-00756</b>	HDM375	.375" (9.5)	114 lb. - ft.	1.27" (32.5)	3.43" (87)	.99" (25.2)	Black	100

Dimensions are approximate and subject to technical changes. Use **Part No.** for ordering and **Type** for specification purposes.

## Weld Stud Mount

Used in conjunction with a cable tie, the weld stud mount eliminates all sizes of p-clamps, nuts, and bolts. Designed to significantly save time and labor, the weld stud mount can be welded onto a painted frame rail without having to grind the surface in preparation. Contact HellermannTyton for information on suitable welding equipment for this product.

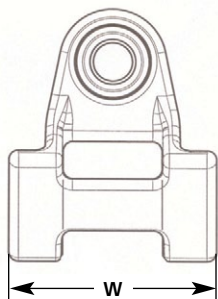
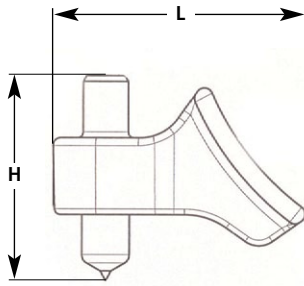

### Material Data

Material	<b>Polyamide 6.6 impact modified, Heat Stabilized, UV Resistant (PA66HIRHS)</b>
Operating Temperature	<b>-40 °F to +230 °F (-40 °C to +110 °C) continuous</b>
Flammability	<b>UL94 HB</b>



### Product Selection

Article No.	Part No.	Type	Cable Tie Series	Max Bundle Ø	Stud Ø	Length (L)	Width (W)	Height (H)	Color	Pkg. Qty.
				in. (mm)	in. (mm)	in. (mm)	in. (mm)	in. (mm)		
<b>151-00146</b>	WSM60IMHSUVH1	WSM60	T50 - T250	6" (152.4)	.24" (6)	1.32" (33.5)	1.07" (27.2)	1.06" (27)	Black	500

Dimensions are approximate and subject to technical changes. Use **Part No.** for ordering and **Type** for specification purposes.