



Chipsmall Limited consists of a professional team with an average of over 10 year of expertise in the distribution of electronic components. Based in Hongkong, we have already established firm and mutual-benefit business relationships with customers from,Europe,America and south Asia,supplying obsolete and hard-to-find components to meet their specific needs.

With the principle of “Quality Parts,Customers Priority,Honest Operation,and Considerate Service”,our business mainly focus on the distribution of electronic components. Line cards we deal with include Microchip,ALPS,ROHM,Xilinx,Pulse,ON,Everlight and Freescale. Main products comprise IC,Modules,Potentiometer,IC Socket,Relay,Connector.Our parts cover such applications as commercial,industrial, and automotives areas.

We are looking forward to setting up business relationship with you and hope to provide you with the best service and solution. Let us make a better world for our industry!



Contact us

Tel: +86-755-8981 8866 Fax: +86-755-8427 6832

Email & Skype: info@chipsmall.com Web: www.chipsmall.com

Address: A1208, Overseas Decoration Building, #122 Zhenhua RD., Futian, Shenzhen, China



THIS DRAWING IS UNPUBLISHED. RELEASED FOR PUBLICATION
 © COPYRIGHT BY TYCO ELECTRONICS CORPORATION. ALL RIGHTS RESERVED.

LOC		DIST		REVISIONS				
P	LTR	DESCRIPTION			DATE	DWN	APVD	
C2		REVISED (ECR-12-013098)			20JUL12	JL	WK	

NOTE:

- MATERIAL:
 HOUSING: LCP WITH 30% GF, UL 94V-0, WHITE COLOR.
 EJECTOR: LCP WITH 30% GF, UL 94V-0, BLACK COLOR.
 PICKPAD: LCP WITH 30% GF, UL 94V-0, BLACK COLOR.
 CONTACTS: BRASS.
 BOARDLOCKS: BRASS.
 PIVOT SHELL: STEEL.
- FINISH:
 CONTACTS: 0.381µm [15µ"] GOLD PLATED ON CONTACT AREA,
 2.54µm [100µ"] MIN. MATTE-TIN ON SOLDER TAIL, WITH
 ENTIRE CONTACT UNDERPLATED 1.27µm [50µ"] MIN. NICKEL.
 MOUNT EAR: 2.54µm [100µ"] MIN. TIN PLATED ON SOLDER AREA
 1.27µm [50µ"] MIN. UNDERPLATED ALL OVER.
- REFLOW SOLDER CAPABLE TO 260°C PER TE TEST SPEC.
 109-201, CONDITION B.
- MEET COMPACT FLASH INDUSTRY STANDARD.
- "Δ" CTQ DIMENSION FOR SPECIAL CONTROL

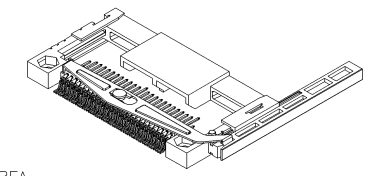

POWER	5.00mm
GENERAL	4.25mm
DETECT	3.50mm
PIN TYPE	INTERFACE DIM. L

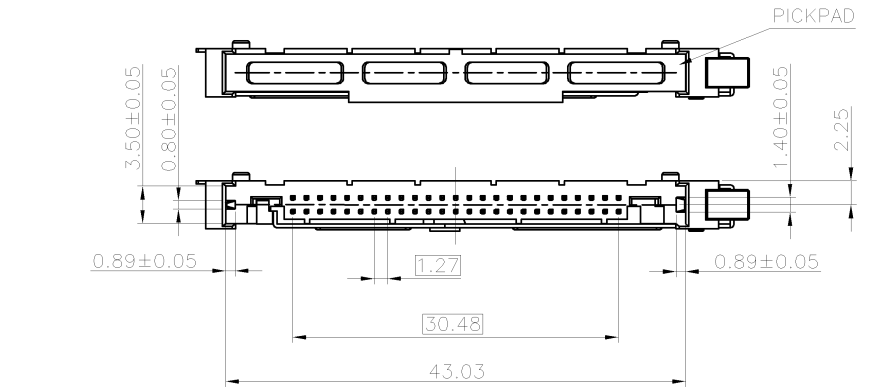

0.85 2.80

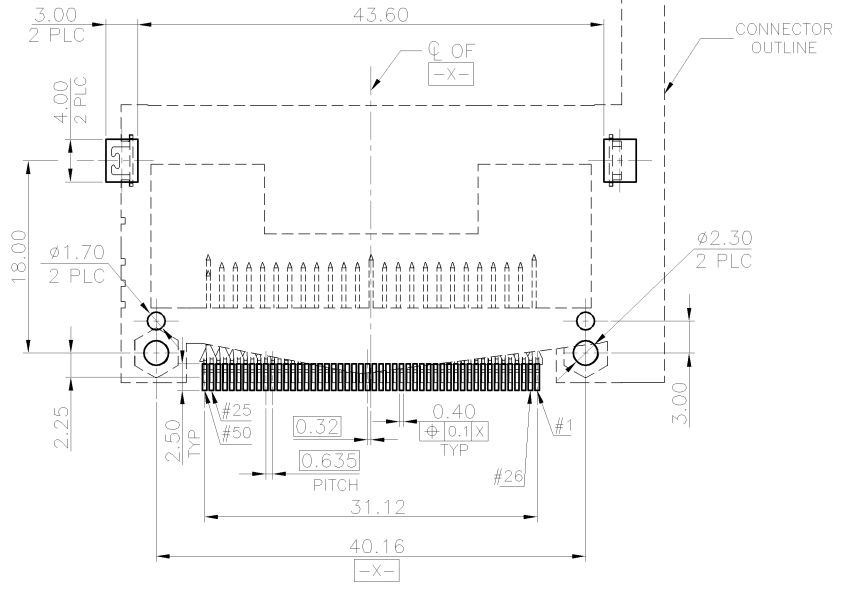
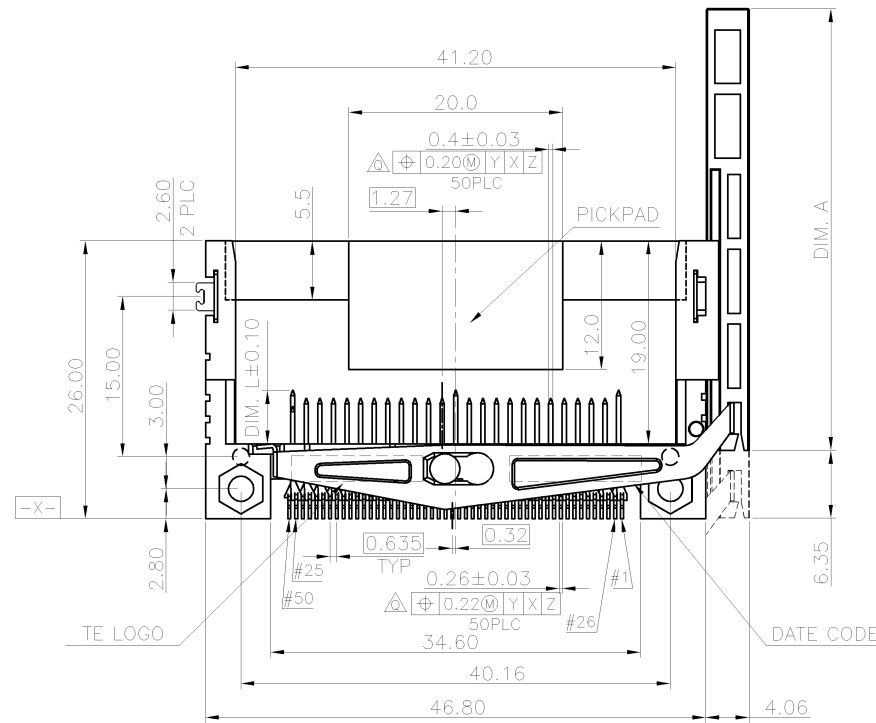
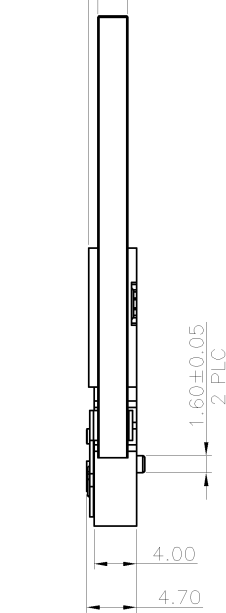

RECOMMENDED PCB LAYOUT
 (TOLERANCE: ±0.05)

OBSOLETE	34.70	≠1734909=2=
	41.30	1734909-1
	DIM. A	PART NUMBER

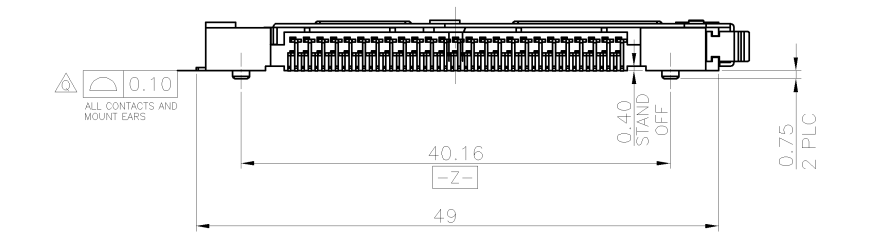

THIS DRAWING IS A CONTROLLED DOCUMENT.		DWN	S. CHIEN	16JUL2008	TE Connectivity		
DIMENSIONS: MM		CHK	S. CHIEN	16JUL2008			
TOLERANCES UNLESS OTHERWISE SPECIFIED:		APVD	W. KODAMA	16JUL2008	NAME		
0 PLC ± 0.5		PRODUCT SPEC		PIN HEADER, 50 POS, SMT, WITH EJECTOR, COMPACT FLASH CARD			
1 PLC ± 0.3		QUALIFICATION TEST REPORT		108-57134		SIZE	A3
2 PLC ± 0.2		WEIGHT		501-57118		CAGE CODE	00779
3 PLC ± 0.1		CUSTOMER DRAWING		C=1734909		DRAWING NO	C=1734909
4 PLC ± 0.1		MATERIAL		4.54 GRAMS		RESTRICTED TO	
4 ANGLES ± 0.1		FINISH		SEE NOTE		SCALE	
SEE NOTE		SEE NOTE		CUSTOMER DRAWING		SHEET	1 of 2
						REV	C2

THIS DRAWING IS UNPUBLISHED. RELEASED FOR PUBLICATION

© COPYRIGHT BY TYCO ELECTRONICS CORPORATION. ALL RIGHTS RESERVED.

LOC DIST DW

REVISIONS

P	LTR	DESCRIPTION	DATE	DWN	APVD
		SEE SHEET 1.			

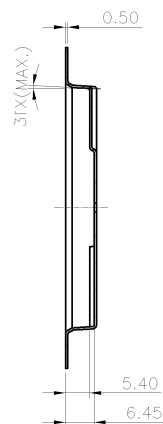
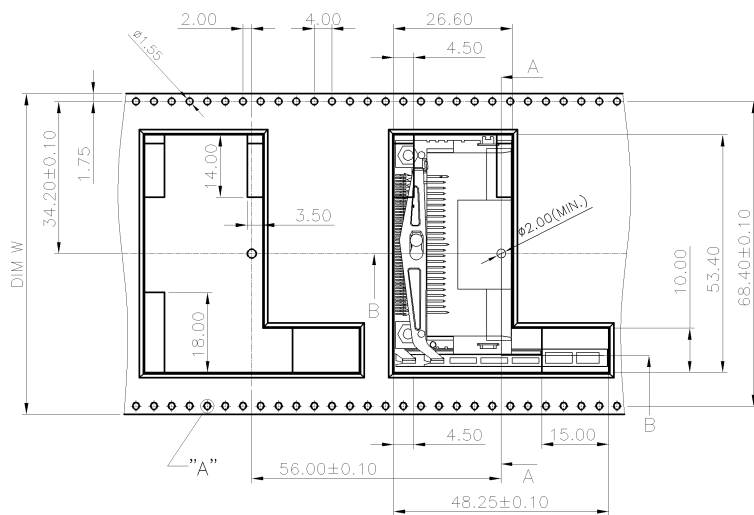
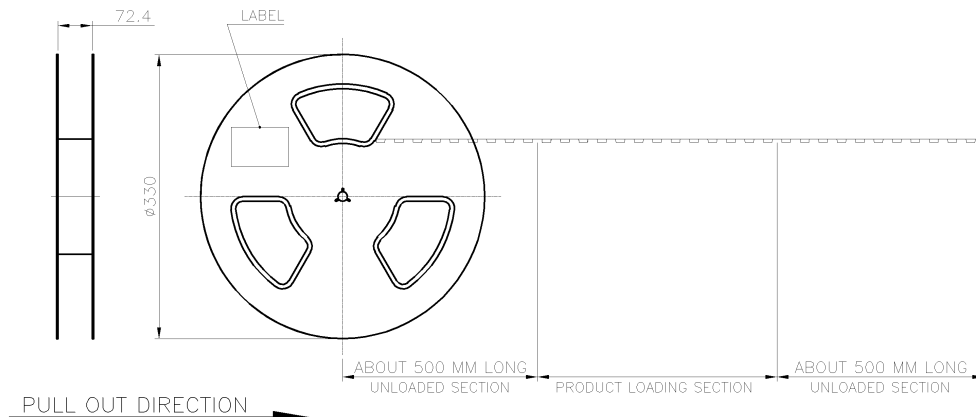

SECTION A-A

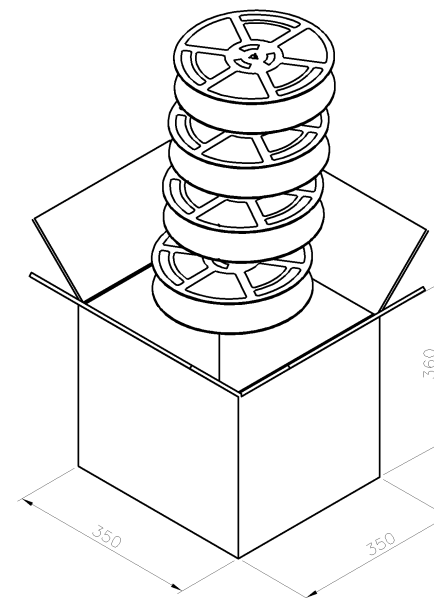

DIM W	PCS/TAPE	REELS/CARTON	QUANTITY (PCS)	G/W (Kg)	N/W (Kg)
72	110	4	440	6	5.5

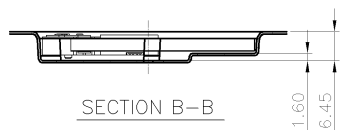
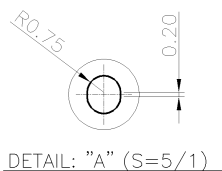

SECTION B-B

THIS DRAWING IS A CONTROLLED DOCUMENT.		DWN	-		
DIMENSIONS: MM		CHK	-		
TOLERANCES UNLESS OTHERWISE SPECIFIED:		APVD	-		
0 PLC ±		PRODUCT SPEC	-		
1 PLC ±		APPLICATION SPEC	-		
2 PLC ±		WEIGHT	-		
3 PLC ±		CUSTOMER DRAWING	-		
4 PLC ±		SIZE	A3	CAGE CODE	00779
ANGLES ±		DRAWING NO	C=1734909		RESTRICTED TO
FINISH ±		SCALE	-		SHEET
		2 of 2		REV	C2

STE TE Connectivity

PIN HEADER, 50 POS, SMT, WITH EJECTOR, COMPACT FLASH CARD