



Chipsmall Limited consists of a professional team with an average of over 10 year of expertise in the distribution of electronic components. Based in Hongkong, we have already established firm and mutual-benefit business relationships with customers from,Europe,America and south Asia,supplying obsolete and hard-to-find components to meet their specific needs.

With the principle of “Quality Parts,Customers Priority,Honest Operation,and Considerate Service”,our business mainly focus on the distribution of electronic components. Line cards we deal with include Microchip,ALPS,ROHM,Xilinx,Pulse,ON,Everlight and Freescale. Main products comprise IC,Modules,Potentiometer,IC Socket,Relay,Connector.Our parts cover such applications as commercial,industrial, and automotives areas.

We are looking forward to setting up business relationship with you and hope to provide you with the best service and solution. Let us make a better world for our industry!



Contact us

Tel: +86-755-8981 8866 Fax: +86-755-8427 6832

Email & Skype: info@chipsmall.com Web: www.chipsmall.com

Address: A1208, Overseas Decoration Building, #122 Zhenhua RD., Futian, Shenzhen, China



THIS DRAWING IS UNPUBLISHED. RELEASED FOR PUBLICATION
 © COPYRIGHT - By - ALL RIGHTS RESERVED.

LOC		DIST		REVISIONS			
P	LTR	DESCRIPTION	DATE	DWN	APVD		
AF	50	A3	ECR-13-016672	25OCT13	PKS	RRP	

IDENTIFICATION NUMBER 7 FOR MAGNET WIRE RANGE

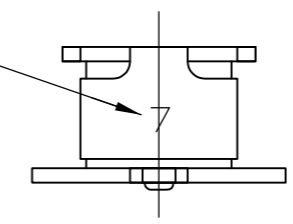

- 1 CONTINUOUS STRIP ON REELS WITH TERMINALS LOCATED ON 5.59±0.08 [.220±.003] CENTERS.
- 2 SLOT TERMINATES EITHER A SINGLE OR DOUBLE MAGNET WIRES OF THE SAME TYPE AND SIZE, COPPER RANGE: 0.29-0.40mm [#29-#26] AWG. ALUMINUM RANGE: 0.36-0.51mm [#27-#24] AWG (THE ALUMINUM RANGE ARE TENTATIVE VALUES AND TO BE VERIFIED BY TE. PLEASE VERIFY AND CONFIRM THE IDC CROSS SECTIONS BEFORE USING.)
- 3 TIN OVER NICKEL UNDERPLATE.

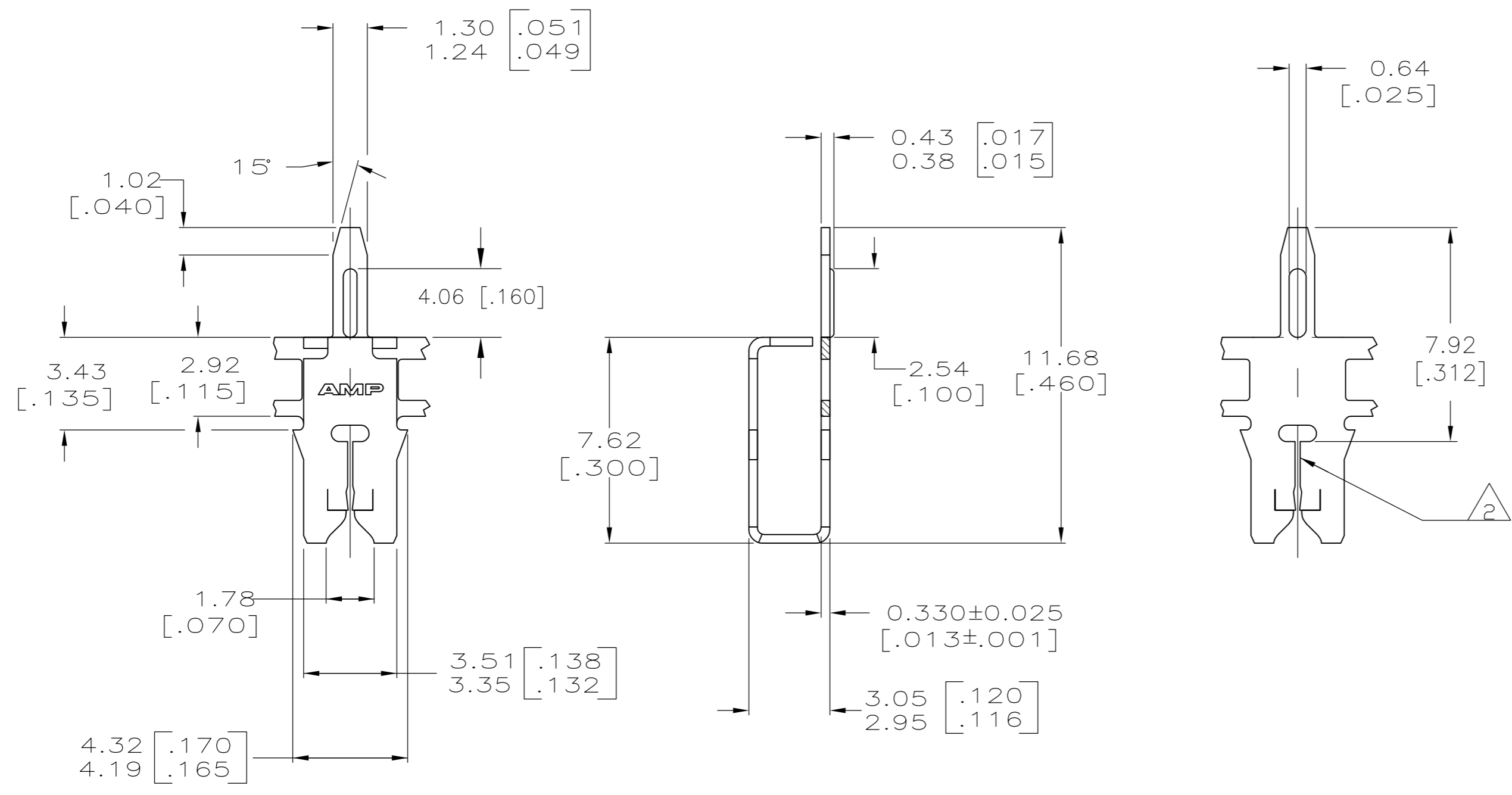

1742940-1
PART NUMBER

THIS DRAWING IS A CONTROLLED DOCUMENT.		DWN jr ruth 15NOV11		
DIMENSIONS: INCHES		CHK KURT RANDOLPH 15NOV11		
TOLERANCES UNLESS OTHERWISE SPECIFIED:		APVD KURT RANDOLPH 15NOV11	NAME POST, TERMINAL, MAG-MATE	
0 PLC ± -		PRODUCT SPEC 108-2012	SIZE A2	
1 PLC ± -		APPLICATION SPEC 114-2046	CAGE CODE 00779	DRAWING NO 1742940
2 PLC ± 0.25 [.010]		MATERIAL BRASS	RESTRICTED TO	
3 PLC ± -		FINISH - 3	SCALE 6:1	SHEET 1 of 1
4 PLC ± -			REV A3	
ANGLES ± 1°				