



Chipsmall Limited consists of a professional team with an average of over 10 year of expertise in the distribution of electronic components. Based in Hongkong, we have already established firm and mutual-benefit business relationships with customers from,Europe,America and south Asia,supplying obsolete and hard-to-find components to meet their specific needs.

With the principle of “Quality Parts,Customers Priority,Honest Operation,and Considerate Service”,our business mainly focus on the distribution of electronic components. Line cards we deal with include Microchip,ALPS,ROHM,Xilinx,Pulse,ON,Everlight and Freescale. Main products comprise IC,Modules,Potentiometer,IC Socket,Relay,Connector.Our parts cover such applications as commercial,industrial, and automotives areas.

We are looking forward to setting up business relationship with you and hope to provide you with the best service and solution. Let us make a better world for our industry!



## Contact us

Tel: +86-755-8981 8866 Fax: +86-755-8427 6832

Email & Skype: [info@chipsmall.com](mailto:info@chipsmall.com) Web: [www.chipsmall.com](http://www.chipsmall.com)

Address: A1208, Overseas Decoration Building, #122 Zhenhua RD., Futian, Shenzhen, China



THIS DRAWING IS UNPUBLISHED.

RELEASED FOR PUBLICATION

© COPYRIGHT — By — ALL RIGHTS RESERVED.

LOC  
JDIST  
—

REVISIONS

変更

DESCRIPTION

DATE

DWN

APVD

P

LTR

E5

REVISED

ECR-15-005620

13APR15

KF

RK

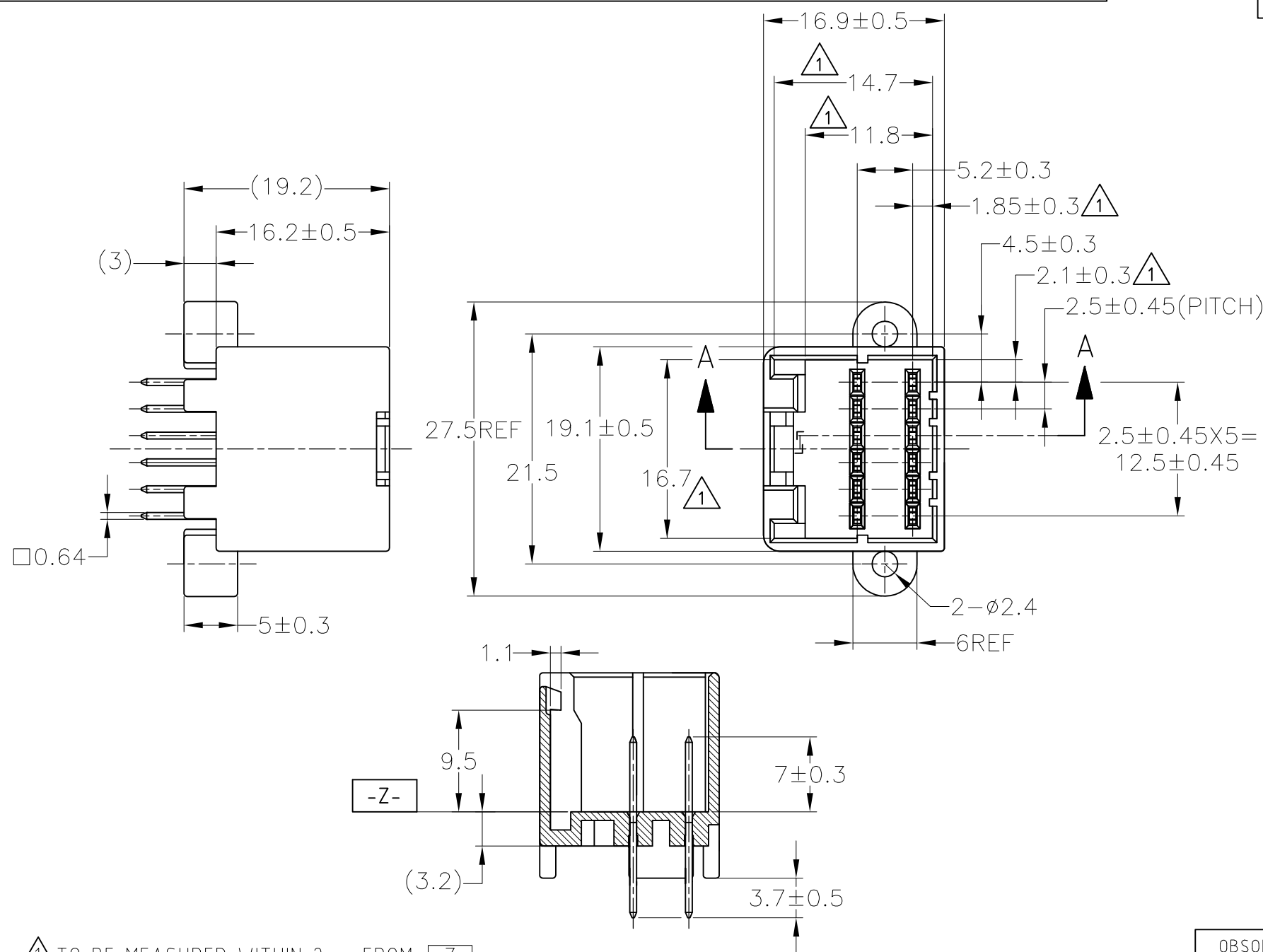

A-A

1. TO BE MEASURED WITHIN 2mm FROM  $\square$ -Z-
2. APPLICABLE P.C.BOARD THICKNESS: 1.6mm
3. THE MATING COUNTERPART PART NUMBER: 174045
4. RECOMMENDED MOUNTING SCREW: 3mm DIA, 6mm LENGTH TAPPING SCREW SPECIFIED IN JIS B1115, B1122 (TIGHTENING TORQUE: 0.8N-M MAX.)
5. CIRCUIT NUMBER

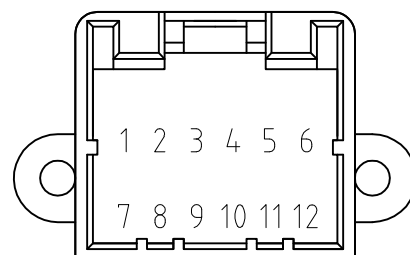

1.  $\square$ -Z-面より2mmの範囲で測定
2. 適用プリント基板厚: 1.6mm
3. 嵌合相手ハウジング型番: 174045
4. 推奨取付ネジ: JIS B1115, B1122 タッピンネジ, ナベ2種  
呼び径3, 長さ6mm (締付けトルク0.8N-M以下)
5. 回路番号: 上図参照のこと

TOLERANCE UNLESS OTHERWISE SPECIFIED: 一般公差		
0 < x ≤ 10	:	±0.2
10 < x ≤ 30	:	±0.25
30 < x ≤ 100	:	±0.3
ANGLE ; 角度	:	±3°

THIS DRAWING IS A CONTROLLED DOCUMENT.

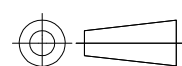
DIMENSIONS:  
単位: 耗  
mmMATERIAL  
材料  
HOUSING: PBT  
CONTACT: BRASSTOLERANCES UNLESS OTHERWISE SPECIFIED:  
一般公差

0 PLC	±
1 PLC	±
2 PLC	±
3 PLC	±
4 PLC	±

ANGLES

仕上

SEE TABLE

SELECTIVE TIN (MATTE)	SELECTIVE GOLD x 12	1~12	BLACK 黒色	5174973-1
TIN-LEAD	SELECTIVE GOLD x 2	5,6	BLACK 黒色	4-174973-2
PRE-TIN x 10		—//—	GREEN 緑色	2-174973-4
SELECTIVE-TIN (MATTE)	PRE-TIN x 12	—//—	GREEN 緑色	2-174973-4
SEE CUSTOMER DRAWING 2-174973-1				
PRE-TIN x 12		—//—	GREEN 緑色	174973-4
SELECTIVE-TIN (MATTE)	SELECTIVE-TIN x 12 (BRIGHT)	—//—	BLACK 黒色	174973-3
PRE-TIN x 12		—//—	BLACK 黒色	174973-2
TIN-LEAD	SELECTIVE GOLD x 12	1~12	BLACK 黒色	174973-1
SOLDERING SIDE 半田付け部	CONTACT SIDE 接触部側	GOLD PLATED CIRCUIT NO. 金めっき回路番号		PART NUMBER 製品型番
CONTACT FINISH コンタクト仕上				

DWN  
T.SHINOHARA 16APR02

CHK  
A.YAMAGUCHI 16APR02

APVD  
K.BETSUI 16APR02

PRODUCT SPEC  
製品規格  
108-5244

APPLICATION SPEC  
取付適用規格

WEIGHT  
4.2 g

CUSTOMER DRAWING

**STE**

TE Connectivity

040 SERIES MULTI-LOCK I/O CONN.  
12Pos CAP HOUSING ASSY (VERTICAL TYPE)

SIZE

CAGE CODE

DRAWING NO  
番号

RESTRICTED TO

A300779

C-174973

SCALE  
尺度 2:1SHEET  
1 OF 1REV  
E5