



Chipsmall Limited consists of a professional team with an average of over 10 year of expertise in the distribution of electronic components. Based in Hongkong, we have already established firm and mutual-benefit business relationships with customers from,Europe,America and south Asia,supplying obsolete and hard-to-find components to meet their specific needs.

With the principle of “Quality Parts,Customers Priority,Honest Operation,and Considerate Service”,our business mainly focus on the distribution of electronic components. Line cards we deal with include Microchip,ALPS,ROHM,Xilinx,Pulse,ON,Everlight and Freescale. Main products comprise IC,Modules,Potentiometer,IC Socket,Relay,Connector.Our parts cover such applications as commercial,industrial, and automotives areas.

We are looking forward to setting up business relationship with you and hope to provide you with the best service and solution. Let us make a better world for our industry!



Contact us

Tel: +86-755-8981 8866 Fax: +86-755-8427 6832

Email & Skype: info@chipsmall.com Web: www.chipsmall.com

Address: A1208, Overseas Decoration Building, #122 Zhenhua RD., Futian, Shenzhen, China



NUMBER C-175274
 METRIC
 三角法 (3rd ANGLE PROJECTION)

PRINT DIST
 単位: 概 DIMENSIONS IN MM. DO NOT SCALE PRINT

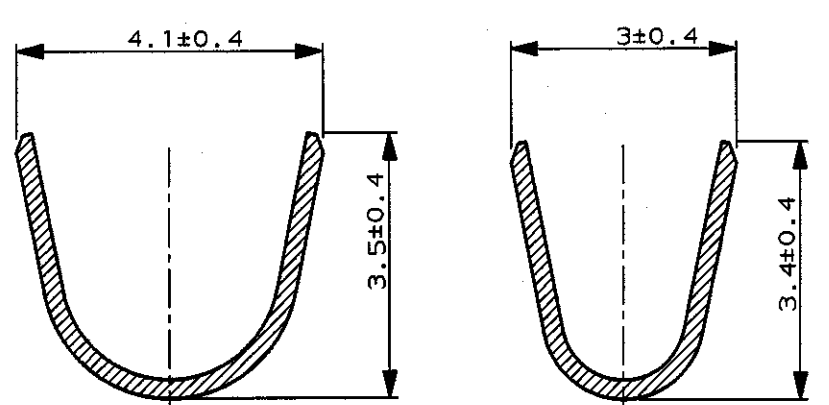
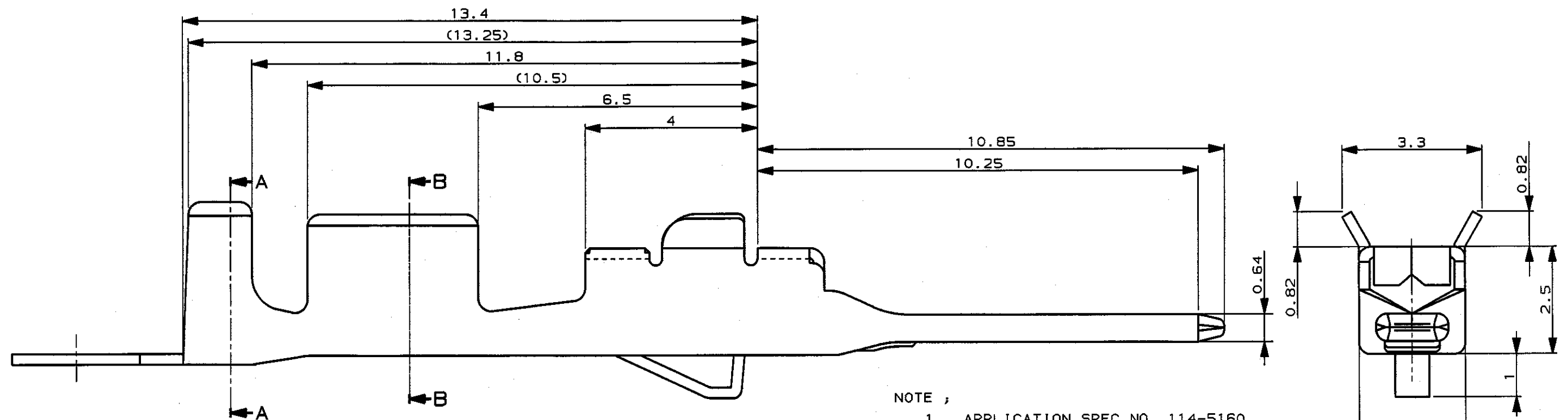
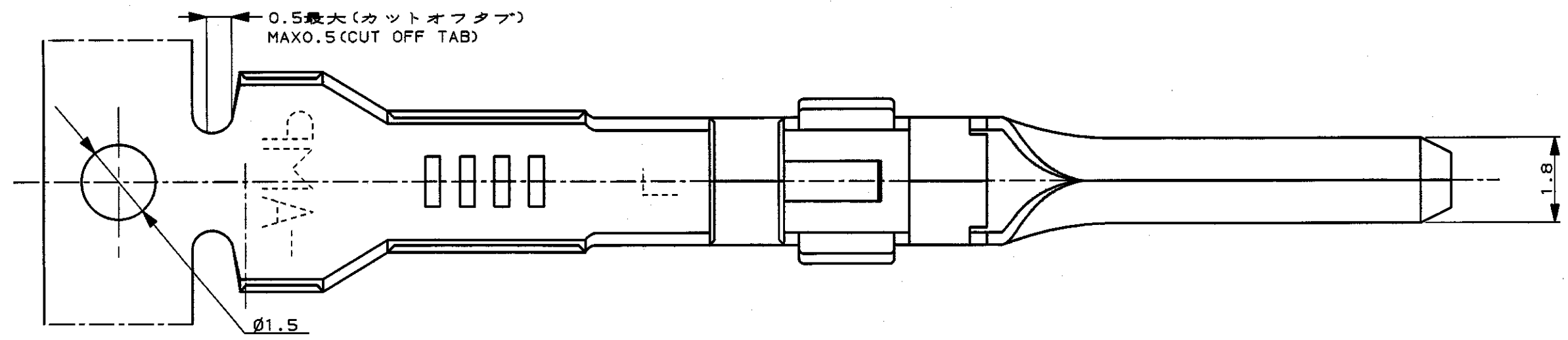

断面 A-A
 SECT. A-A

断面 B-B
 SECT. B-B

- NOTE ;
1. APPLICATION SPEC NO. 114-5160
 2. APPLICABLE PRODUCT SPEC NO.108-5374
- 注 ;
1. 取付適用規格番号 114-5160
 2. 通用製品規格番号 108-5374

179430-1		錫めっき済 (PRE-TINNIED)	175274-1
バラ端子型番 (LOOSE PIECE CONTACT P/N)		仕上げ (FINISH)	AMP型番 (PART NUMBER)
Copyright ©1990年 AMP (Japan) LTD. ALL RIGHTS RESERVED.		AMP 日本エー・エム・ピー株式会社 Tokyo, Japan	
E1 ADD NOTE 2 FJ00-0937-99 TS KB 28MAY 99		名称 (NAME) .070 II SERIES L TAB CONTACT .070 II シリーズ L タブ コンタクト	
E 改訂 (FJ00-0577-98) TK NS 25MAR 98		一般公差 (GENERAL TOLERANCE) 10以下: ±0.2 10を超え 30以下: ±0.25 30を超え 100以下: ±0.3 角度: ±3°	
D 改訂 (FJ00-0153-94) TK MT 4/3 94		SIZE LOC 番号 (No.) A3 J C-175274	
C 改訂 J-1339 YK KO 1/11 93		尺度 (SCALE) 10-1	
B 改訂 J-0212 KO SI 7/8 91		REV. E1	
A 再作成 KO SI 4/25 91		SHEET 1 OF 1	
LTR 変更 (REVISION RECORD) DR CHK DATE		APP. 4/25 91	