



Chipsmall Limited consists of a professional team with an average of over 10 year of expertise in the distribution of electronic components. Based in Hongkong, we have already established firm and mutual-benefit business relationships with customers from,Europe,America and south Asia,supplying obsolete and hard-to-find components to meet their specific needs.

With the principle of “Quality Parts,Customers Priority,Honest Operation,and Considerate Service”,our business mainly focus on the distribution of electronic components. Line cards we deal with include Microchip,ALPS,ROHM,Xilinx,Pulse,ON,Everlight and Freescale. Main products comprise IC,Modules,Potentiometer,IC Socket,Relay,Connector.Our parts cover such applications as commercial,industrial, and automotives areas.

We are looking forward to setting up business relationship with you and hope to provide you with the best service and solution. Let us make a better world for our industry!



## Contact us

Tel: +86-755-8981 8866 Fax: +86-755-8427 6832

Email & Skype: info@chipsmall.com Web: www.chipsmall.com

Address: A1208, Overseas Decoration Building, #122 Zhenhua RD., Futian, Shenzhen, China



**BLIDC 3.5F**

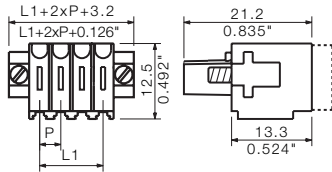

**Accessories**

**Possible colors**

Additional colours on request



**Coding**

See chapter accessories



**Mounting block**

See chapter accessories



**Marking strips**

See chapter accessories

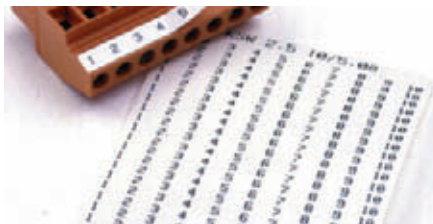

**Screwdriver**

See chapter accessories  
Order No. 9008370000



**Ordering data**

**Solder pin length**

Colour  orange  black

**Pitch 3.50 mm**

Poles	L1 mm	(inch)	Qty.	Order No.	Order No.
2	3.50	(0.138)	100	1751090000	1771090000
3	7.00	(0.276)	100	1751100000	1771100000
4	10.50	(0.413)	100	1751110000	1771110000
5	14.00	(0.551)	50	1751120000	1771120000
6	17.50	(0.689)	50	1751130000	1771130000
7	21.00	(0.827)	50	1751140000	1771140000
8	24.50	(0.965)	50	1751150000	1771150000
9	28.00	(1.102)	50	1751160000	1771160000
10	31.50	(1.240)	50	1751170000	1771170000
11	35.00	(1.378)	50	1751180000	1771180000
12	38.50	(1.516)	50	1751190000	1771190000
13	42.00	(1.654)	50	1751200000	1771200000
14	45.50	(1.791)	50	1751210000	1771210000
15	49.00	(1.929)	50	1751220000	1771220000
16	52.50	(2.067)	50	1751230000	1771230000