



Chipsmall Limited consists of a professional team with an average of over 10 year of expertise in the distribution of electronic components. Based in Hongkong, we have already established firm and mutual-benefit business relationships with customers from,Europe,America and south Asia,supplying obsolete and hard-to-find components to meet their specific needs.

With the principle of “Quality Parts,Customers Priority,Honest Operation,and Considerate Service”,our business mainly focus on the distribution of electronic components. Line cards we deal with include Microchip,ALPS,ROHM,Xilinx,Pulse,ON,Everlight and Freescale. Main products comprise IC,Modules,Potentiometer,IC Socket,Relay,Connector.Our parts cover such applications as commercial,industrial, and automotives areas.

We are looking forward to setting up business relationship with you and hope to provide you with the best service and solution. Let us make a better world for our industry!



Contact us

Tel: +86-755-8981 8866 Fax: +86-755-8427 6832

Email & Skype: info@chipsmall.com Web: www.chipsmall.com

Address: A1208, Overseas Decoration Building, #122 Zhenhua RD., Futian, Shenzhen, China



THIS DRAWING IS UNPUBLISHED. RELEASED FOR PUBLICATION 20
 © COPYRIGHT 20 BY TYCO ELECTRONICS CORPORATION. ALL RIGHTS RESERVED.

LOC FT DIST 0

REVISIONS					
P	LTR	DESCRIPTION	DATE	DWN	APVD
0		PRELIMINARY EC 0G3B-0947-04	09NOV2004	SW	SY
A		REVISED EC 0G3B-1174-04	14DEC2004	SW	SY
AI		REVISED ECR 05-000925	28MAR2005	SW	SY
B		RELEASED ECO-05-008873	09SEP2005	SW	SY

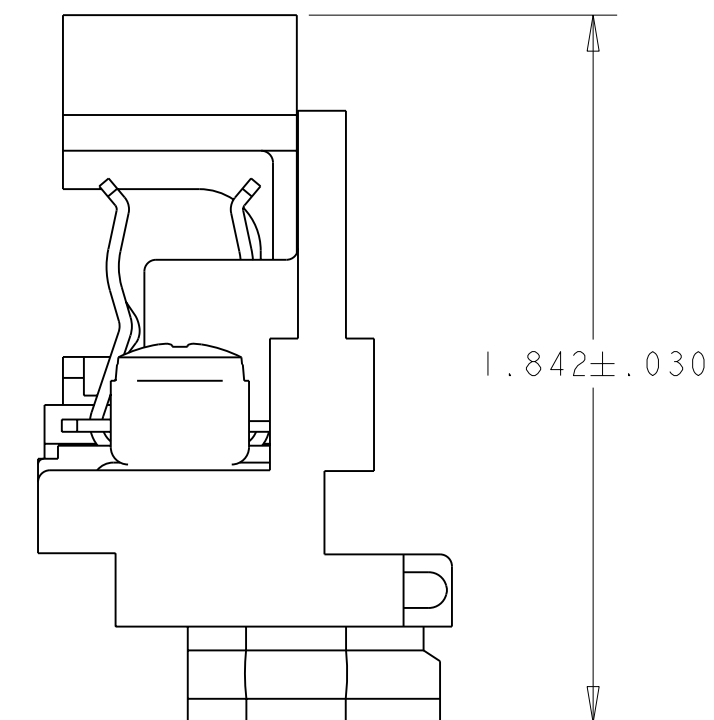
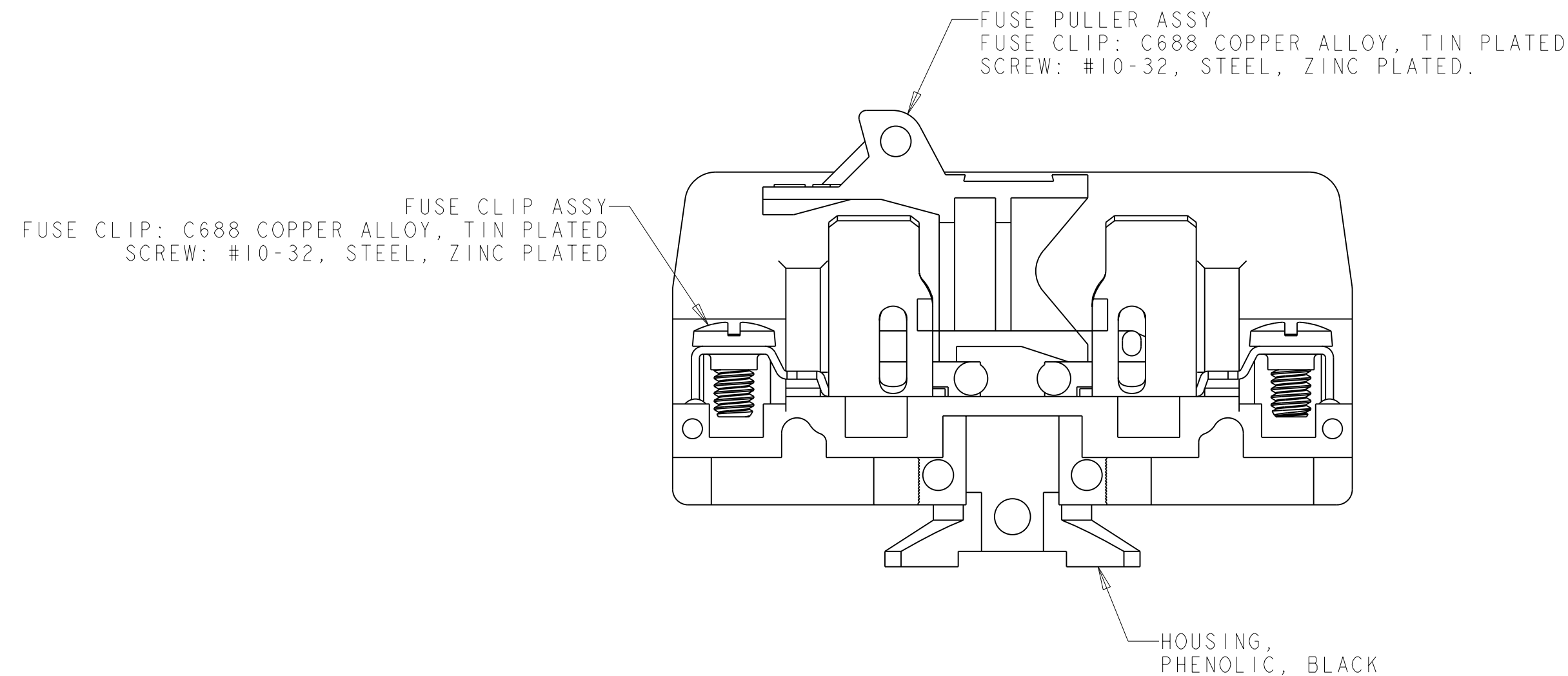
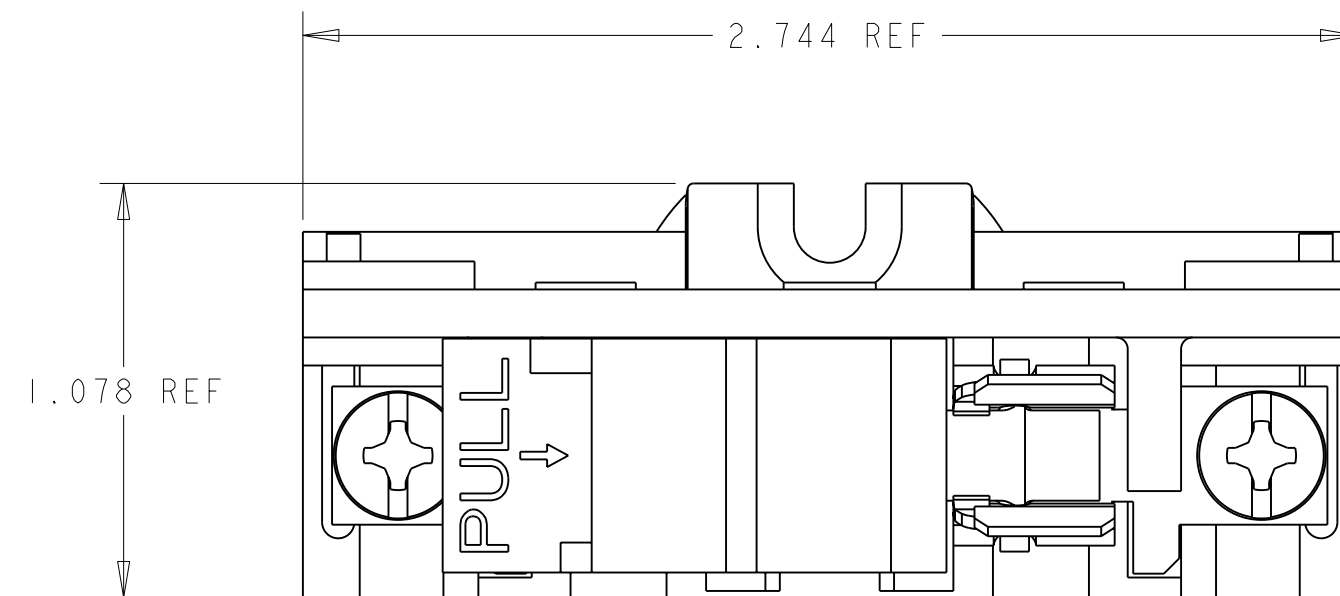

1. ELECTRICAL RATING (UL/CSA)
 RATED CURRENT: 30A
 OPERATING VOLTAGE: 600V
 WIRE RANGE: 22-8 AWG

0351SP	1776277-1
CATALOG PART NUMBER	PART NUMBER

THIS DRAWING IS A CONTROLLED DOCUMENT FOR TYCO ELECTRONICS CORPORATION. IT IS SUBJECT TO CHANGE AND THE CONTROLLING ENGINEERING ORGANIZATION SHOULD BE CONTACTED FOR THE LATEST REVISION.		DWN S. WELDON 09JAN2004	BUCHANAN Tyco Electronics Harrisburg, PA 17105-3608			
DIMENSIONS: INCHES		CHK S. YODER 09JAN2004	NAME FUSE BLOCK ASSEMBLY, STRAP SCREW, DOVETAIL, ONE PIECE FUSE CLIP			
TOLERANCES UNLESS OTHERWISE SPECIFIED: 0 PLC ±0 1 PLC ±.01 2 PLC ±.005 3 PLC ±.005 4 PLC ±.0005 ANGLES ±1°		APVD S. YODER 09JAN2004				
MATERIAL FINISH		PRODUCT SPEC -	SIZE A2	CAGE CODE 00779	DRAWING NO C=1776277	RESTRICTED TO -
-		APPLICATION SPEC -	SCALE 2:1		SHEET 1 OF 1	REV B
-		WEIGHT -	CUSTOMER DRAWING			