



Chipsmall Limited consists of a professional team with an average of over 10 year of expertise in the distribution of electronic components. Based in Hongkong, we have already established firm and mutual-benefit business relationships with customers from,Europe,America and south Asia,supplying obsolete and hard-to-find components to meet their specific needs.

With the principle of “Quality Parts,Customers Priority,Honest Operation,and Considerate Service”,our business mainly focus on the distribution of electronic components. Line cards we deal with include Microchip,ALPS,ROHM,Xilinx,Pulse,ON,Everlight and Freescale. Main products comprise IC,Modules,Potentiometer,IC Socket,Relay,Connector.Our parts cover such applications as commercial,industrial, and automotives areas.

We are looking forward to setting up business relationship with you and hope to provide you with the best service and solution. Let us make a better world for our industry!



Contact us

Tel: +86-755-8981 8866 Fax: +86-755-8427 6832

Email & Skype: info@chipsmall.com Web: www.chipsmall.com

Address: A1208, Overseas Decoration Building, #122 Zhenhua RD., Futian, Shenzhen, China



Printed-circuit board connector - DFK-IPC 35 HC/ 4-GF-15,00 - 1784981

Please be informed that the data shown in this PDF Document is generated from our Online Catalog. Please find the complete data in the user's documentation. Our General Terms of Use for Downloads are valid (<http://download.phoenixcontact.com>)

Header, Nominal current: 125 A, Rated voltage (III/2): 1000 V, Number of positions: 4, Pitch: 15 mm, Color: green, Contact surface: Silver, Assembly: Soldering



Why buy this product

- Inverted IPC 35 HC headers for implementing a touch-proof PCB output (in combination with IPC 35 HC plugs) or a PCB/PCB connection (in combination with PC 35 headers)
- DFK versions for fixing in the housing panel
- Integrated threaded flange for screw connection with the PCB



Key commercial data

Packing unit	0
Minimum order quantity	1
Catalog page	Page 499 (CC-2011)
GTIN	 4 046356 561297
Custom tariff number	85366990
Country of origin	GERMANY

Technical data

Dimensions / positions

Length	44.9 mm
Height	34.7 mm
Pitch	15 mm
Dimension a	45 mm
Number of positions	4
Pin dimensions	2,4 x 2,5 mm
Hole diameter	3.6 mm

Technical data

Range of articles	DFK-IPC 35 HC/..-GF
Insulating material group	IIIa

Printed-circuit board connector - DFK-IPC 35 HC/ 4-GF-15,00 - 1784981

Technical data

Technical data

Rated surge voltage (III/3)	8 kV
Rated surge voltage (III/2)	8 kV
Rated surge voltage (II/2)	8 kV
Rated voltage (III/2)	1000 V
Rated voltage (II/2)	1000 V
Connection in acc. with standard	EN-VDE
Nominal current I _N	125 A
Nominal voltage U _N	1000 V
Maximum load current	125 A
Insulating material	PBT
Inflammability class according to UL 94	V0
Color	green
Nominal voltage, UL/CUL Use Group B	600 V
Nominal current, UL/CUL Use Group B	115 A
Nominal voltage, UL/CUL Use Group C	600 V
Nominal current, UL/CUL Use Group C	115 A

Classifications

eclass

eCl@ss 4.0	272607xx
eCl@ss 4.1	27260701
eCl@ss 5.0	27260701
eCl@ss 5.1	27260701
eCl@ss 6.0	27260704
eCl@ss 7.0	27440402

etim

ETIM 4.0	EC002637
----------	----------

unspsc

UNSPSC 6.01	30211810
UNSPSC 7.0901	39121409
UNSPSC 11	39121409
UNSPSC 12.01	39121409
UNSPSC 13.2	39121409

Approvals

Approvals

Printed-circuit board connector - DFK-IPC 35 HC/ 4-GF-15,00 - 1784981

Approvals

Approvals

UL Recognized / GOST

Ex Approvals

Approvals submitted

Approval details

UL Recognized 		
	B	C
Nominal current I _N	115 A	115 A
Nominal voltage U _N	600 V	600 V

GOST 		
------------------------------------------------------------------------------------------	--	--

Accessories

Accessories

Plug/Adapter

Coding profile - CP-HC - 1686478



Encoding profile, 4 encoding profiles per strip, 40 strips per unit pack, for insertion in encoding grooves

Screw set - DFK-IPC 35-SS - 1703166

Drawings

Printed-circuit board connector - DFK-IPC 35 HC/ 4-GF-15,00 - 1784981

Drilling diagram

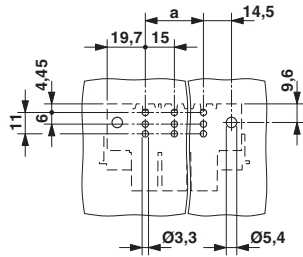

Dimensioned drawing

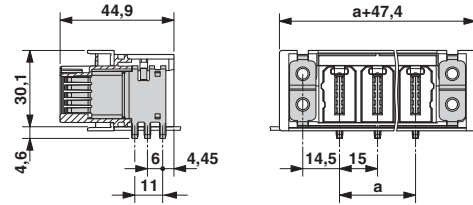

Dimensioned drawing

