



Chipsmall Limited consists of a professional team with an average of over 10 year of expertise in the distribution of electronic components. Based in Hongkong, we have already established firm and mutual-benefit business relationships with customers from,Europe,America and south Asia,supplying obsolete and hard-to-find components to meet their specific needs.

With the principle of “Quality Parts,Customers Priority,Honest Operation,and Considerate Service”,our business mainly focus on the distribution of electronic components. Line cards we deal with include Microchip,ALPS,ROHM,Xilinx,Pulse,ON,Everlight and Freescale. Main products comprise IC,Modules,Potentiometer,IC Socket,Relay,Connector.Our parts cover such applications as commercial,industrial, and automotives areas.

We are looking forward to setting up business relationship with you and hope to provide you with the best service and solution. Let us make a better world for our industry!



## Contact us

Tel: +86-755-8981 8866 Fax: +86-755-8427 6832

Email & Skype: info@chipsmall.com Web: www.chipsmall.com

Address: A1208, Overseas Decoration Building, #122 Zhenhua RD., Futian, Shenzhen, China



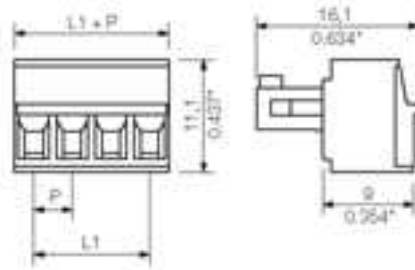

#### General ordering data

Order No.	1792880000
Part designation	BCZ 3.81/4/180 SN GN
Version	PCB plug-in connector, Female connectors, Clamping yoke connection, Clamping range, max.: 1.5 mm <sup>2</sup> , Pitch: 3.81 mm, No. of poles: 4, 180°, Box
EAN	4032248226962
Qty.	50 pc(s).

#### System parameters

Conductor connection system	Clamping yoke connection
Outgoing direction of conductor	180°
Pitch	3.81 mm
Pitch in inch	0.15 inch
No. of poles	4
No. of rows	1
Screwdriver blade	0.4 x 2.5
Screwdriver blade standard	DIN 5264
Tightening torque, min.	0.2
Tightening torque, max.	0.25 Nm
Clamping screw	M 2
Stripping length	7 mm
L1 in mm	11.43 mm
L1 in inch	0.45 inch
Electric shock protection to DIN VDE 0470	IP 20
Electric shock protection to DIN VDE 0470	Safe from finger touch

#### Material data

Insulating material	PA GF
Colour	Pale green
colour chart	Similar to RAL 6021
Insulating material group	II
Flammability class UL 94	V-0
CTI	>= 475

#### Material data

Contact base material	Copper alloy
Contact surface	tinned

#### Connectable conductors

Clamping range, min.	0.08 mm <sup>2</sup>
Clamping range, max.	1.5 mm <sup>2</sup>
AWG, min.	28
AWG, max.	16
Solid, min. H05(07) V-U	0.2 mm <sup>2</sup>
Solid, max. H05(07) V-U	1.5 mm <sup>2</sup>
Flexible, min. H05(07) V-K	0.2 mm <sup>2</sup>
Flexible, max. H05(07) V-K	1.5 mm <sup>2</sup>
With wire end ferrule, acc. to DIN 46 228/1, min.	0.2 mm <sup>2</sup>
With wire end ferrule, acc. to DIN 46 228/1, max.	1.5 mm <sup>2</sup>
w. plastic collar ferrule, DIN 46228 pt 4, min.	0.2 mm <sup>2</sup>
w. plastic collar ferrule, DIN 46228 pt 4, max.	1.5 mm <sup>2</sup>
Gauge to EN 60999 a x b; ø	2.4 mm x 1.5 mm ; 2.4 mm

#### DIN IEC rating data

Rated current, min. No. pins (Tu=20°C)	17.5 A
Rated current, max. No. pins (Tu=20°C)	17.5 A
Rated current, min. No. pins (Tu=40°C)	17.5 A
Rated current, max. No. pins (Tu=40°C)	15.2 A
Rated voltage for overvoltage class/pollution severity II/2	320 V
Rated voltage for overvoltage class/pollution severity III/2	160 V
Rated voltage for overvoltage class/pollution severity III/3	160 V
Rated impulse withstand voltage for overvoltage class/pollution severity II/2	2.5 kV
Rated impulse withstand voltage for overvoltage class/pollution severity III/2	2.5 kV
Rated impulse withstand voltage for overvoltage class/pollution severity III/3	2.5 kV
Short-time withstand current resistance	3 x 1s with 76 A

#### CSA rating data

Rated voltage (Use group D)	300 V
Rated current (Use group D)	10 A
AWG conductor (field wiring), min.	28
AWG conductor (field wiring), max.	16

#### UL 1059 rating data

Rated voltage (Use group D)	300 V
Rated current (Use group D)	10 A
AWG conductor, min.	28
AWG conductor, max.	16



## Approvals

Approvals institutes



## Classifications

ETIM 2.0	NK
ETIM 3.0	EC001284
eClass 4.1	27-26-07-01
eClass 5.0	27-26-07-01
eClass 5.1	27-26-07-04

## Similar products

Order No.	Part designation	Version
1940730000	BCZ 3.81/02/180 SN OR	PCB plug-in connector, Female connectors, Clamping yoke connection, Clamping range, max.: 1.5 mm <sup>2</sup> , Pitch: 3.81 mm, No. of poles: 2, 180°, Box
1792770000	BCZ 3.81/2/180 SN SW	PCB plug-in connector, Female connectors, Clamping yoke connection, Clamping range, max.: 1.5 mm <sup>2</sup> , Pitch: 3.81 mm, No. of poles: 2, 180°, Box
1792860000	BCZ 3.81/2/180 SN GN	PCB plug-in connector, Female connectors, Clamping yoke connection, Clamping range, max.: 1.5 mm <sup>2</sup> , Pitch: 3.81 mm, No. of poles: 2, 180°, Box
1940740000	BCZ 3.81/3/180 SN OR	PCB plug-in connector, Female connectors, Clamping yoke connection, Clamping range, max.: 1.5 mm <sup>2</sup> , Pitch: 3.81 mm, No. of poles: 3, 180°, Box
1792780000	BCZ 3.81/3/180 SN SW	PCB plug-in connector, Female connectors, Clamping yoke connection, Clamping range, max.: 1.5 mm <sup>2</sup> , Pitch: 3.81 mm, No. of poles: 3, 180°, Box
1792870000	BCZ 3.81/3/180 SN GN	PCB plug-in connector, Female connectors, Clamping yoke connection, Clamping range, max.: 1.5 mm <sup>2</sup> , Pitch: 3.81 mm, No. of poles: 3, 180°, Box
1940750000	BCZ 3.81/4/180 SN OR	PCB plug-in connector, Female connectors, Clamping yoke connection, Clamping range, max.: 1.5 mm <sup>2</sup> , Pitch: 3.81 mm, No. of poles: 4, 180°, Box
1792790000	BCZ 3.81/4/180 SN SW	PCB plug-in connector, Female connectors, Clamping yoke connection, Clamping range, max.: 1.5 mm <sup>2</sup> , Pitch: 3.81 mm, No. of poles: 4, 180°, Box
1940760000	BCZ 3.81/5/180 SN OR	PCB plug-in connector, Female connectors, Clamping yoke connection, Clamping range, max.: 1.5 mm <sup>2</sup> , Pitch: 3.81 mm, No. of poles: 5, 180°, Box
1792800000	BCZ 3.81/5/180 SN SW	PCB plug-in connector, Female connectors, Clamping yoke connection, Clamping range, max.: 1.5 mm <sup>2</sup> , Pitch: 3.81 mm, No. of poles: 5, 180°, Box
1792890000	BCZ 3.81/5/180 SN GN	PCB plug-in connector, Female connectors, Clamping yoke connection, Clamping range, max.: 1.5 mm <sup>2</sup> , Pitch: 3.81 mm, No. of poles: 5, 180°, Box

1940770000	BCZ 3.81/6/180 SN OR	PCB plug-in connector, Female connectors, Clamping yoke connection, Clamping range, max.: 1.5 mm <sup>2</sup> , Pitch: 3.81 mm, No. of poles: 6, 180°, Box
1792810000	BCZ 3.81/6/180 SN SW	PCB plug-in connector, Female connectors, Clamping yoke connection, Clamping range, max.: 1.5 mm <sup>2</sup> , Pitch: 3.81 mm, No. of poles: 6, 180°, Box
1792900000	BCZ 3.81/6/180 SN GN	PCB plug-in connector, Female connectors, Clamping yoke connection, Clamping range, max.: 1.5 mm <sup>2</sup> , Pitch: 3.81 mm, No. of poles: 6, 180°, Box
1940780000	BCZ 3.81/7/180 SN OR	PCB plug-in connector, Female connectors, Clamping yoke connection, Clamping range, max.: 1.5 mm <sup>2</sup> , Pitch: 3.81 mm, No. of poles: 7, 180°, Box
1871410000	BCZ 3.81/7/180 SN SW	PCB plug-in connector, Female connectors, Clamping yoke connection, Clamping range, max.: 1.5 mm <sup>2</sup> , Pitch: 3.81 mm, No. of poles: 7, 180°, Box
1871400000	BCZ 3.81/7/180 SN GN	PCB plug-in connector, Female connectors, Clamping yoke connection, Clamping range, max.: 1.5 mm <sup>2</sup> , Pitch: 3.81 mm, No. of poles: 7, 180°, Box
1940790000	BCZ 3.81/8/180 SN OR	PCB plug-in connector, Female connectors, Clamping yoke connection, Clamping range, max.: 1.5 mm <sup>2</sup> , Pitch: 3.81 mm, No. of poles: 8, 180°, Box
1792820000	BCZ 3.81/8/180 SN SW	PCB plug-in connector, Female connectors, Clamping yoke connection, Clamping range, max.: 1.5 mm <sup>2</sup> , Pitch: 3.81 mm, No. of poles: 8, 180°, Box
1792910000	BCZ 3.81/8/180 SN GN	PCB plug-in connector, Female connectors, Clamping yoke connection, Clamping range, max.: 1.5 mm <sup>2</sup> , Pitch: 3.81 mm, No. of poles: 8, 180°, Box
1940800000	BCZ 3.81/9/180 SN OR	PCB plug-in connector, Female connectors, Clamping yoke connection, Clamping range, max.: 1.5 mm <sup>2</sup> , Pitch: 3.81 mm, No. of poles: 9, 180°, Box
1871390000	BCZ 3.81/9/180 SN SW	PCB plug-in connector, Female connectors, Clamping yoke connection, Clamping range, max.: 1.5 mm <sup>2</sup> , Pitch: 3.81 mm, No. of poles: 9, 180°, Box
1871380000	BCZ 3.81/9/180 SN GN	PCB plug-in connector, Female connectors, Clamping yoke connection, Clamping range, max.: 1.5 mm <sup>2</sup> , Pitch: 3.81 mm, No. of poles: 9, 180°, Box
1940810000	BCZ 3.81/10/180 SN OR	PCB plug-in connector, Female connectors, Clamping yoke connection, Clamping range, max.: 1.5 mm <sup>2</sup> , Pitch: 3.81 mm, No. of poles: 10, 180°, Box
1792830000	BCZ 3.81/10/180 SN SW	PCB plug-in connector, Female connectors, Clamping yoke connection, Clamping range, max.: 1.5 mm <sup>2</sup> , Pitch: 3.81 mm, No. of poles: 10, 180°, Box
1792920000	BCZ 3.81/10/180 SN GN	PCB plug-in connector, Female connectors, Clamping yoke connection, Clamping range, max.: 1.5 mm <sup>2</sup> , Pitch: 3.81 mm, No. of poles: 10, 180°, Box
1940820000	BCZ 3.81/11/180 SN OR	PCB plug-in connector, Female connectors, Clamping yoke connection, Clamping range, max.: 1.5 mm <sup>2</sup> , Pitch: 3.81 mm, No. of poles: 11, 180°, Box
1899400000	BCZ 3.81/11/180 SN SW	PCB plug-in connector, Female connectors, Clamping yoke connection, Clamping range, max.: 1.5 mm <sup>2</sup> , Pitch: 3.81 mm, No. of poles: 11, 180°, Box

1899390000	BCZ 3.81/11/180 SN GN	PCB plug-in connector, Female connectors, Clamping yoke connection, Clamping range, max.: 1.5 mm <sup>2</sup> , Pitch: 3.81 mm, No. of poles: 11, 180°, Box
1940830000	BCZ 3.81/12/180 SN OR	PCB plug-in connector, Female connectors, Clamping yoke connection, Clamping range, max.: 1.5 mm <sup>2</sup> , Pitch: 3.81 mm, No. of poles: 12, 180°, Box
1792840000	BCZ 3.81/12/180 SN SW	PCB plug-in connector, Female connectors, Clamping yoke connection, Clamping range, max.: 1.5 mm <sup>2</sup> , Pitch: 3.81 mm, No. of poles: 12, 180°, Box
1792930000	BCZ 3.81/12/180 SN GN	PCB plug-in connector, Female connectors, Clamping yoke connection, Clamping range, max.: 1.5 mm <sup>2</sup> , Pitch: 3.81 mm, No. of poles: 12, 180°, Box
1940840000	BCZ 3.81/13/180 SN OR	PCB plug-in connector, Female connectors, Clamping yoke connection, Clamping range, max.: 1.5 mm <sup>2</sup> , Pitch: 3.81 mm, No. of poles: 13, 180°, Box
1899440000	BCZ 3.81/13/180 SN SW	PCB plug-in connector, Female connectors, Clamping yoke connection, Clamping range, max.: 1.5 mm <sup>2</sup> , Pitch: 3.81 mm, No. of poles: 13, 180°, Box
1899430000	BCZ 3.81/13/180 SN GN	PCB plug-in connector, Female connectors, Clamping yoke connection, Clamping range, max.: 1.5 mm <sup>2</sup> , Pitch: 3.81 mm, No. of poles: 13, 180°, Box
1940850000	BCZ 3.81/14/180 SN OR	PCB plug-in connector, Female connectors, Clamping yoke connection, Clamping range, max.: 1.5 mm <sup>2</sup> , Pitch: 3.81 mm, No. of poles: 14, 180°, Box
1899480000	BCZ 3.81/14/180 SN SW	PCB plug-in connector, Female connectors, Clamping yoke connection, Clamping range, max.: 1.5 mm <sup>2</sup> , Pitch: 3.81 mm, No. of poles: 14, 180°, Box
1899470000	BCZ 3.81/14/180 SN GN	PCB plug-in connector, Female connectors, Clamping yoke connection, Clamping range, max.: 1.5 mm <sup>2</sup> , Pitch: 3.81 mm, No. of poles: 14, 180°, Box
1940860000	BCZ 3.81/15/180 SN OR	PCB plug-in connector, Female connectors, Clamping yoke connection, Clamping range, max.: 1.5 mm <sup>2</sup> , Pitch: 3.81 mm, No. of poles: 15, 180°, Box
1899520000	BCZ 3.81/15/180 SN SW	PCB plug-in connector, Female connectors, Clamping yoke connection, Clamping range, max.: 1.5 mm <sup>2</sup> , Pitch: 3.81 mm, No. of poles: 15, 180°, Box
1899510000	BCZ 3.81/15/180 SN GN	PCB plug-in connector, Female connectors, Clamping yoke connection, Clamping range, max.: 1.5 mm <sup>2</sup> , Pitch: 3.81 mm, No. of poles: 15, 180°, Box
1940870000	BCZ 3.81/16/180 SN OR	PCB plug-in connector, Female connectors, Clamping yoke connection, Clamping range, max.: 1.5 mm <sup>2</sup> , Pitch: 3.81 mm, No. of poles: 16, 180°, Box
1792850000	BCZ 3.81/16/180 SN SW	PCB plug-in connector, Female connectors, Clamping yoke connection, Clamping range, max.: 1.5 mm <sup>2</sup> , Pitch: 3.81 mm, No. of poles: 16, 180°, Box
1792940000	BCZ 3.81/16/180 SN GN	PCB plug-in connector, Female connectors, Clamping yoke connection, Clamping range, max.: 1.5 mm <sup>2</sup> , Pitch: 3.81 mm, No. of poles: 16, 180°, Box
1940890000	BCZ 3.81/17/180 SN OR	PCB plug-in connector, Female connectors, Clamping yoke connection, Clamping range, max.: 1.5 mm <sup>2</sup> , Pitch: 3.81 mm, No. of poles: 17, 180°, Box

1940970000	BCZ 3.81/17/180 SN SW	PCB plug-in connector, Female connectors, Clamping yoke connection, Clamping range, max.: 1.5 mm <sup>2</sup> , Pitch: 3.81 mm, No. of poles: 17, 180°, Box
1940930000	BCZ 3.81/17/180 SN GN	PCB plug-in connector, Female connectors, Clamping yoke connection, Clamping range, max.: 1.5 mm <sup>2</sup> , Pitch: 3.81 mm, No. of poles: 17, 180°, Box
1940980000	BCZ 3.81/18/180 SN SW	PCB plug-in connector, Female connectors, Clamping yoke connection, Clamping range, max.: 1.5 mm <sup>2</sup> , Pitch: 3.81 mm, No. of poles: 18, 180°, Box
1940900000	BCZ 3.81/18/180 SN OR	PCB plug-in connector, Female connectors, Clamping yoke connection, Clamping range, max.: 1.5 mm <sup>2</sup> , Pitch: 3.81 mm, No. of poles: 18, 180°, Box
1940940000	BCZ 3.81/18/180 SN GN	PCB plug-in connector, Female connectors, Clamping yoke connection, Clamping range, max.: 1.5 mm <sup>2</sup> , Pitch: 3.81 mm, No. of poles: 18, 180°, Box
1940910000	BCZ 3.81/19/180 SN OR	PCB plug-in connector, Female connectors, Clamping yoke connection, Clamping range, max.: 1.5 mm <sup>2</sup> , Pitch: 3.81 mm, No. of poles: 19, 180°, Box
1940990000	BCZ 3.81/19/180 SN SW	PCB plug-in connector, Female connectors, Clamping yoke connection, Clamping range, max.: 1.5 mm <sup>2</sup> , Pitch: 3.81 mm, No. of poles: 19, 180°, Box
1940950000	BCZ 3.81/19/180 SN GN	PCB plug-in connector, Female connectors, Clamping yoke connection, Clamping range, max.: 1.5 mm <sup>2</sup> , Pitch: 3.81 mm, No. of poles: 19, 180°, Box
1940920000	BCZ 3.81/20/180 SN OR	PCB plug-in connector, Female connectors, Clamping yoke connection, Clamping range, max.: 1.5 mm <sup>2</sup> , Pitch: 3.81 mm, No. of poles: 20, 180°, Box
1941000000	BCZ 3.81/20/180 SN SW	PCB plug-in connector, Female connectors, Clamping yoke connection, Clamping range, max.: 1.5 mm <sup>2</sup> , Pitch: 3.81 mm, No. of poles: 20, 180°, Box
1940960000	BCZ 3.81/20/180 SN GN	PCB plug-in connector, Female connectors, Clamping yoke connection, Clamping range, max.: 1.5 mm <sup>2</sup> , Pitch: 3.81 mm, No. of poles: 20, 180°, Box