



Chipsmall Limited consists of a professional team with an average of over 10 year of expertise in the distribution of electronic components. Based in Hongkong, we have already established firm and mutual-benefit business relationships with customers from,Europe,America and south Asia,supplying obsolete and hard-to-find components to meet their specific needs.

With the principle of “Quality Parts,Customers Priority,Honest Operation,and Considerate Service”,our business mainly focus on the distribution of electronic components. Line cards we deal with include Microchip,ALPS,ROHM,Xilinx,Pulse,ON,Everlight and Freescale. Main products comprise IC,Modules,Potentiometer,IC Socket,Relay,Connector.Our parts cover such applications as commercial,industrial, and automotives areas.

We are looking forward to setting up business relationship with you and hope to provide you with the best service and solution. Let us make a better world for our industry!



Contact us

Tel: +86-755-8981 8866 Fax: +86-755-8427 6832

Email & Skype: info@chipsmall.com Web: www.chipsmall.com

Address: A1208, Overseas Decoration Building, #122 Zhenhua RD., Futian, Shenzhen, China



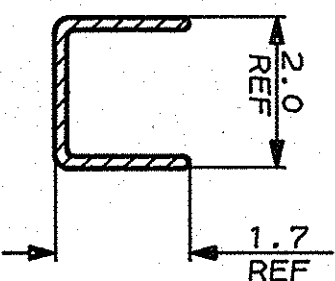
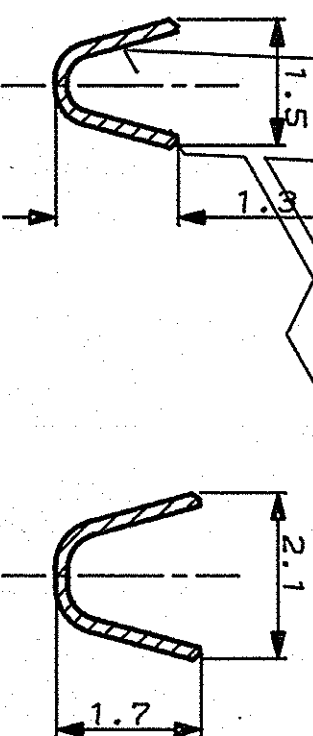
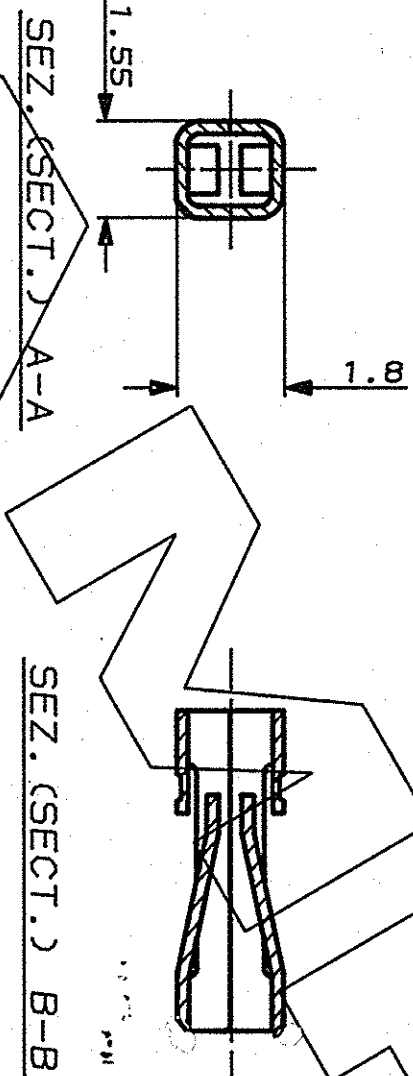
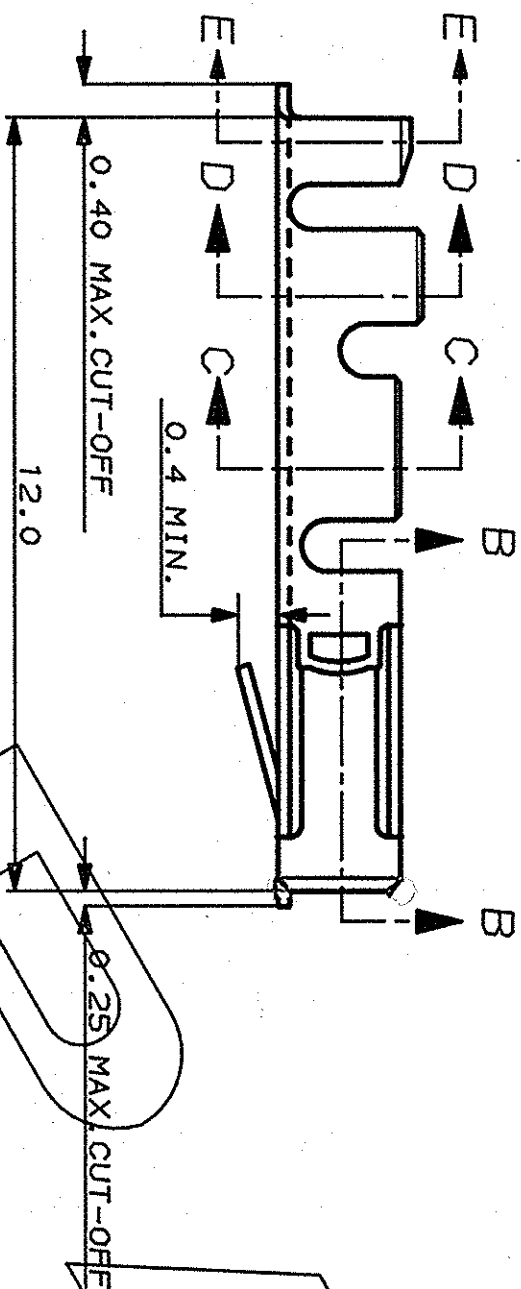
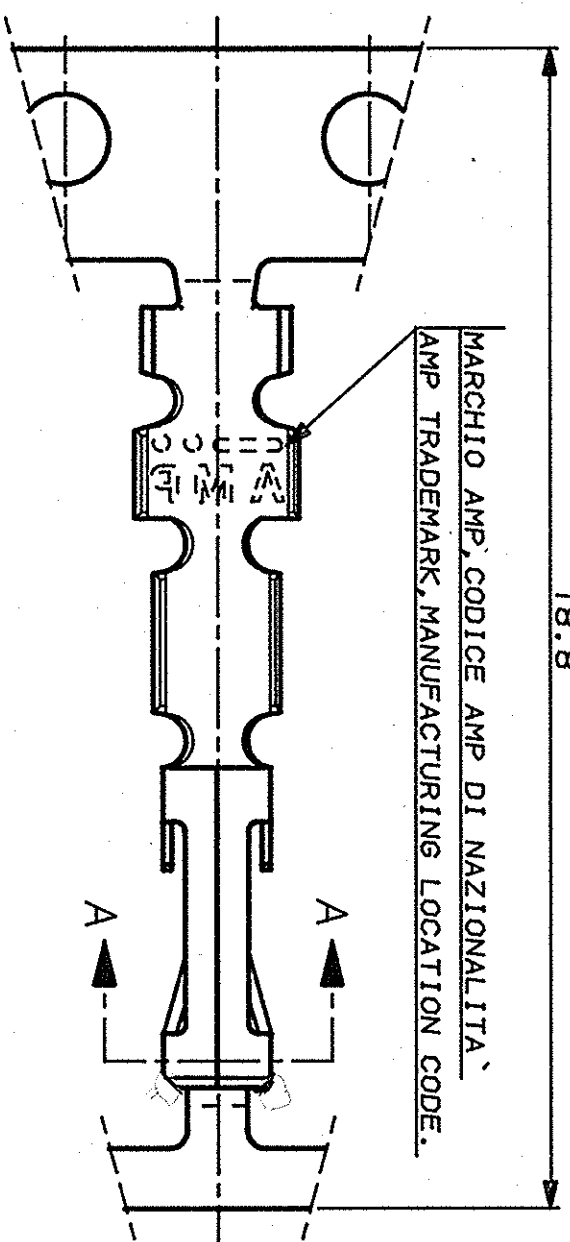

NOTE (NOTES)

1. MATERIALE (MATL.): BRONZO FOSFOROSO (PHOSPHOR BRONZE).
2. FINITURA (FINISH): STAGNATO 0.8µm ECCEPTE LE ZONE TRANCIAE. CTIN PLATED 0.8µm ALL OVER EXCEPT FOR CUTTING EDGES).
3. PER MINI-APPLICATORE (FOR MINI-APPLICATOR) P/N 781119-2.
4. PER APPLICATORE STD. (FOR STD. APPLICATOR).
5. PER UTENSILE A MANO (FOR HANDTOOL) P/N 782116.

NOTE (NOTES)

182207-2

280709-1

280709-2

| MATERIALE E FINITURA. (MATL. & FINISH) | LOOSE-PIECE PART NUMBER: (MATL. & FINISH) | STRIP PART NUMBER: (MATL. & FINISH) | STRIP PART NUMBER: (MATL. & FINISH) |
|---|--|--|--|
| 1 & 2 | 182207-2 | 280709-1 | 280709-2 |

CUSTOMER DWG.
FOR REFERENCE ONLY
DISEGNO PER CLIENTE
SOLO PER RIFERIMENTO

± 0.3

AMP

AMP ITALIA S.p.A.
Corso F.lli Cervi, 15
COLLENO (TORINO)

| REV. | REVISIONI (REVISIONS) | DIS. DATA (DATE) | APP. 2 | LOC. SIZE (CODE NO) | REV. | FOR 10 (COVER) DI 1 |
|------|---|-----------------------------|--------|------------------------|--------|---------------------------|
| P | PRIMO SMOSSO E C. 01/10/88 AGGIUNTI MARCHI C. 01/10/88 TRADEMARK ADDED | DIS. G. CAMPA 29 JUNE 89 | APP. 2 | I A3C | 280709 | 1 |
| E | AGGIORNATO (REVISED) | | | | | |
| D | AGGIORNATO (REVISED) | | | | | |
| C | AGGIORNATO (REVISED) | | | | | |
| B | AGGIORNATO (REVISED) | | | | | |