



Chipsmall Limited consists of a professional team with an average of over 10 year of expertise in the distribution of electronic components. Based in Hongkong, we have already established firm and mutual-benefit business relationships with customers from,Europe,America and south Asia,supplying obsolete and hard-to-find components to meet their specific needs.

With the principle of “Quality Parts,Customers Priority,Honest Operation,and Considerate Service”,our business mainly focus on the distribution of electronic components. Line cards we deal with include Microchip,ALPS,ROHM,Xilinx,Pulse,ON,Everlight and Freescale. Main products comprise IC,Modules,Potentiometer,IC Socket,Relay,Connector.Our parts cover such applications as commercial,industrial, and automotives areas.

We are looking forward to setting up business relationship with you and hope to provide you with the best service and solution. Let us make a better world for our industry!



## Contact us

Tel: +86-755-8981 8866 Fax: +86-755-8427 6832

Email & Skype: info@chipsmall.com Web: www.chipsmall.com

Address: A1208, Overseas Decoration Building, #122 Zhenhua RD., Futian, Shenzhen, China



## Base strip - MCVU 1,5/10-GFD-3,81 - 1833108

Please be informed that the data shown in this PDF Document is generated from our Online Catalog. Please find the complete data in the user's documentation. Our General Terms of Use for Downloads are valid (<http://download.phoenixcontact.com>)



Plug component, Nominal current: 8 A, Rated voltage (III/2): 160 V, Number of positions: 10, Pitch: 3.81 mm, Connection method: Screw connection, Color: green, Contact surface: Tin, Assembly: Direct mounting

The figure shows a 10-position version of the product

### Why buy this product

- Shock-proof connection block in combination with MC plug-in system
- Version with threaded flange
- Direct plug-in block with mounting flanges for screw connection on mounting plates or unit housing



### Key commercial data

|                        |   |
|------------------------|---|
| Packing unit           | 1   |
| Minimum order quantity | 50  |
| Catalog page           | Page 227 (CC-2011)  |
| GTIN                   | <br>4 017918 051792 |
| Custom tariff number   | 85369010  |
| Country of origin      | POLAND  |

### Technical data

#### Dimensions / positions

|                        |          |
|------------------------|----------|
| Pitch                  | 3.81 mm  |
| Dimension a            | 34.29 mm |
| Number of positions    | 10       |
| Screw thread           | M2       |
| Tightening torque, min | 0.22 Nm  |
| Tightening torque max  | 0.25 Nm  |

#### Technical data

|                             |                  |
|-----------------------------|------------------|
| Range of articles           | MCVU 1,5/...-GFD |
| Insulating material group   | I                |
| Rated surge voltage (III/3) | 2.5 kV           |
| Rated surge voltage (III/2) | 2.5 kV           |

## Base strip - MCVU 1,5/10-GFD-3,81 - 1833108

### Technical data

#### Technical data

|   |                     |
|---|---------------------|
| Rated surge voltage (II/2)              | 2.5 kV              |
| Rated voltage (III/2)                   | 160 V               |
| Rated voltage (II/2)                    | 320 V               |
| Connection in acc. with standard        | EN-VDE              |
| Nominal current $I_N$                   | 8 A                 |
| Nominal voltage $U_N$                   | 160 V               |
| Nominal cross section                   | 1.5 mm <sup>2</sup> |
| Maximum load current                    | 8 A                 |
| Insulating material                     | PA                  |
| Inflammability class according to UL 94 | V0                  |
| Internal cylindrical gage               | A1                  |
| Stripping length                        | 7 mm                |
| Nominal voltage, UL/CUL Use Group B     | 300 V               |
| Nominal current, UL/CUL Use Group B     | 8 A                 |
| Nominal voltage, UL/CUL Use Group D     | 300 V               |
| Nominal current, UL/CUL Use Group D     | 8 A                 |

#### Connection data

|   |                      |
|---|----------------------|
| Conductor cross section solid min.  | 0.14 mm <sup>2</sup> |
| Conductor cross section solid max.  | 1.5 mm <sup>2</sup>  |
| Conductor cross section stranded min.   | 0.14 mm <sup>2</sup> |
| Conductor cross section stranded max.   | 1.5 mm <sup>2</sup>  |
| Conductor cross section stranded, with ferrule without plastic sleeve min.              | 0.25 mm <sup>2</sup> |
| Conductor cross section stranded, with ferrule without plastic sleeve max.              | 1.5 mm <sup>2</sup>  |
| Conductor cross section stranded, with ferrule with plastic sleeve min.                 | 0.25 mm <sup>2</sup> |
| Conductor cross section stranded, with ferrule with plastic sleeve max.                 | 0.5 mm <sup>2</sup>  |
| Conductor cross section AWG/kcmil min.  | 28                   |
| Conductor cross section AWG/kcmil max   | 16                   |
| 2 conductors with same cross section, solid min.  | 0.14 mm <sup>2</sup> |
| 2 conductors with same cross section, solid max.  | 0.5 mm <sup>2</sup>  |
| 2 conductors with same cross section, stranded min.                                     | 0.14 mm <sup>2</sup> |
| 2 conductors with same cross section, stranded max.                                     | 0.75 mm <sup>2</sup> |
| 2 conductors with same cross section, stranded, ferrules without plastic sleeve, min.   | 0.25 mm <sup>2</sup> |
| 2 conductors with same cross section, stranded, ferrules without plastic sleeve, max.   | 0.34 mm <sup>2</sup> |
| 2 conductors with same cross section, stranded, TWIN ferrules with plastic sleeve, min. | 0.5 mm <sup>2</sup>  |
| 2 conductors with same cross section, stranded, TWIN ferrules with plastic sleeve, max. | 0.5 mm <sup>2</sup>  |
| Minimum AWG according to UL/CUL   | 30                   |

# Base strip - MCVU 1,5/10-GFD-3,81 - 1833108

## Technical data

### Connection data

|                                 |    |
|---------------------------------|----|
| Maximum AWG according to UL/CUL | 14 |
|---------------------------------|----|

## Classifications

### ETIM

|          |          |
|----------|----------|
| ETIM 3.0 | EC001121 |
| ETIM 4.0 | EC002638 |
| ETIM 5.0 | EC002638 |

### UNSPSC

|               |          |
|---------------|----------|
| UNSPSC 11     | 39121409 |
| UNSPSC 12.01  | 39121409 |
| UNSPSC 13.2   | 39121409 |
| UNSPSC 6.01   | 30211810 |
| UNSPSC 7.0901 | 39121409 |

### eCl@ss

|            |          |
|------------|----------|
| eCl@ss 4.0 | 272607xx |
| eCl@ss 4.1 | 27260701 |
| eCl@ss 5.0 | 27260701 |
| eCl@ss 5.1 | 27260701 |
| eCl@ss 6.0 | 27260704 |
| eCl@ss 7.0 | 27440402 |

## Approvals

### Approvals

---

#### Approvals

CSA / UL Recognized / VDE Gutachten mit Fertigungsüberwachung / cUL Recognized / GOST / IEC CB Scheme / GOST / cULus Recognized

---

#### Ex Approvals

---

#### Approvals submitted

---

#### Approval details

# Base strip - MCVU 1,5/10-GFD-3,81 - 1833108

## Approvals

CSA

|                            | B     | D     |
|----------------------------|-------|-------|
| mm <sup>2</sup> /AWG/kcmil | 28-16 | 28-16 |
| Nominal current IN         | 8 A   | 8 A   |
| Nominal voltage UN         | 300 V | 300 V |

UL Recognized

|                            | B     | D     |
|----------------------------|-------|-------|
| mm <sup>2</sup> /AWG/kcmil | 30-14 | 30-14 |
| Nominal current IN         | 8 A   | 8 A   |
| Nominal voltage UN         | 300 V | 300 V |

VDE Gutachten mit Fertigungsüberwachung

| mm <sup>2</sup> /AWG/kcmil | 0.2-1.5 |
|----------------------------|---------|
| Nominal current IN         | 8 A     |
| Nominal voltage UN         | 160 V   |

cUL Recognized

|                            | B     | D     |
|----------------------------|-------|-------|
| mm <sup>2</sup> /AWG/kcmil | 30-14 | 30-14 |
| Nominal current IN         | 8 A   | 8 A   |
| Nominal voltage UN         | 300 V | 300 V |

GOST

IECEE CB Scheme

| mm <sup>2</sup> /AWG/kcmil | 0.2-1.5 |
|----------------------------|---------|
| Nominal current IN         | 8 A     |
| Nominal voltage UN         | 160 V   |

## Base strip - MCVU 1,5/10-GFD-3,81 - 1833108

### Approvals

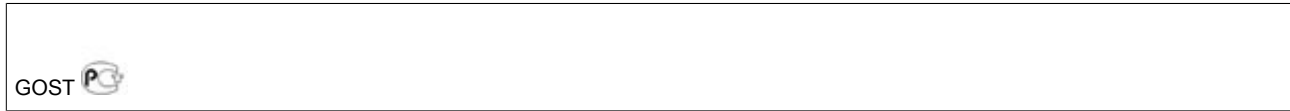

### Accessories

#### Accessories

#### Marking

Marker cards - SK 3,81/2,8:FORTL.ZAHLEN - 0804109



Marker cards, Card, white, labeled, Horizontal: Consecutive numbers 1 - 10, 11 - 20, etc. up to 91 - (99)100, Mounting type: Adhesive, For terminal block width: 3.81 mm

#### Plug/Adapter

Coding profile - CP-MSTB - 1734634



Keying profile, is inserted into the slot on the plug or inverted header, red insulating material

#### Tools

Screwdriver - SZS 0,4X2,5 VDE - 1205037



Screwdriver, bladed, VDE insulated, size: 0.4 x 2.5 x 80 mm, 2-component grip, with non-slip grip

#### Additional products

## Base strip - MCVU 1,5/10-GFD-3,81 - 1833108

### Accessories

#### Printed-circuit board connector - MCVR 1,5/10-STF-3,81 - 1828427



Plug component, Nominal current: 8 A, Rated voltage (III/2): 160 V, Number of positions: 10, Pitch: 3.81 mm, Connection method: Screw connection, Color: green, Contact surface: Tin

#### Printed-circuit board connector - QC 0,5/10-STF-3,81 - 1897623

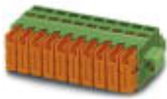

Plug component, Nominal current: 6 A, Rated voltage (III/2): 200 V, Number of positions: 10, Pitch: 3.81 mm, Connection method: Insulation displacement connection QUICKON, Color: green, Contact surface: Tin

#### Printed-circuit board connector - MCC 1/10-STZF-3,81 - 1852448



Plug component, Nominal current: 8 A, Rated voltage (III/2): 160 V, Number of positions: 10, Pitch: 3.81 mm, Connection method: Crimp connection, Color: green, Corresponding female crimp contacts with current [A] and conductor cross section range [mm<sup>2</sup>] data: 5A/MCC-MT 0,2-0,35 (1859988); 8A/MCC-MT 0,5-1,0 (1859991)

#### Printed-circuit board connector - MCVW 1,5/10-STF-3,81 - 1828579



Plug component, Nominal current: 8 A, Rated voltage (III/2): 160 V, Number of positions: 10, Pitch: 3.81 mm, Connection method: Screw connection, Color: green, Contact surface: Tin

#### Printed-circuit board connector - MC 1,5/10-STF-3,81 - 1827787



Plug component, Nominal current: 8 A, Rated voltage (III/2): 160 V, Number of positions: 10, Pitch: 3.81 mm, Connection method: Screw connection, Color: green, Contact surface: Tin

#### Printed-circuit board connector - FK-MCP 1,5/10-STF-3,81 - 1851313



Plug component, Nominal current: 8 A, Rated voltage (III/2): 160 V, Number of positions: 10, Pitch: 3.81 mm, Connection method: Spring-cage conn., Color: green, Contact surface: Tin

# Base strip - MCVU 1,5/10-GFD-3,81 - 1833108

## Accessories

Printed-circuit board connector - FRONT-MC 1,5/10-STF-3,81 - 1850932

Plug component, Nominal current: 8 A, Rated voltage (III/2): 160 V, Number of positions: 10, Pitch: 3.81 mm, Connection method: Screw connection, Color: green, Contact surface: Tin



## Drawings

Drilling diagram

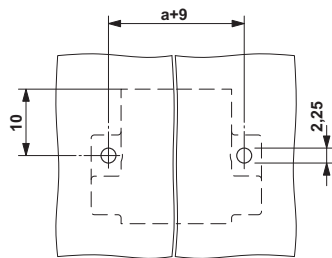

Dimensioned drawing

