



Chipsmall Limited consists of a professional team with an average of over 10 year of expertise in the distribution of electronic components. Based in Hongkong, we have already established firm and mutual-benefit business relationships with customers from,Europe,America and south Asia,supplying obsolete and hard-to-find components to meet their specific needs.

With the principle of "Quality Parts,Customers Priority,Honest Operation,and Considerate Service",our business mainly focus on the distribution of electronic components. Line cards we deal with include Microchip,ALPS,ROHM,Xilinx,Pulse,ON,Everlight and Freescale. Main products comprise IC,Modules,Potentiometer,IC Socket,Relay,Connector.Our parts cover such applications as commercial,industrial, and automotives areas.

We are looking forward to setting up business relationship with you and hope to provide you with the best service and solution. Let us make a better world for our industry!



Contact us

Tel: +86-755-8981 8866 Fax: +86-755-8427 6832

Email & Skype: info@chipsmall.com Web: www.chipsmall.com

Address: A1208, Overseas Decoration Building, #122 Zhenhua RD., Futian, Shenzhen, China



RockClassic series

Overview D.2 - D.3

RockClassic – for standard use

| | |
|---------------|-------------|
| Group size 1 | D.4 - D.7 |
| Group size 2 | D.8 - D.9 |
| Group size 3 | D.10 - D.11 |
| Group size 4 | D.12 - D.17 |
| Group size 5 | D.18 - D.19 |
| Group size 6 | D.20 - D.25 |
| Group size 7 | D.26 - D.29 |
| Group size 8 | D.30 - D.35 |
| Group size 9 | D.36 - D.37 |
| Group size 10 | D.38 - D.42 |
| Group size 12 | D.43 |

RockClassic Stainless – with corrosion protection

| | |
|---------------|-------------|
| Group size 2 | D.44 |
| Group size 3 | D.44 |
| Group size 4 | D.45 |
| Group size 5 | D.46 |
| Group size 6 | D.46 - D.47 |
| Group size 8 | D.47 - D.48 |
| Group size 10 | D.48 |
| Group size 12 | D.49 |

RockStar series

Overview D.50 - D.51

RockStar Impact – for toughest demands

| | |
|--------------|-------------|
| Group size 1 | D.52 |
| Group size 3 | D.53 |
| Group size 4 | D.54 |
| Group size 6 | D.55 |
| Group size 8 | D.56 - D.57 |

RockStar Shielded – with EMC-protection

| | |
|--------------|-------------|
| Group size 1 | D.58 |
| Group size 3 | D.59 |
| Group size 4 | D.60 |
| Group size 6 | D.61 |
| Group size 8 | D.62 - D.63 |

RockStar Impact XXL – with maximum circuitry space

| | |
|---------------|------|
| Group size 8 | D.64 |
| Group size 12 | D.65 |

RockStar Shielded XXL – with maximum circuitry space

| | |
|---------------|------|
| Group size 8 | D.66 |
| Group size 12 | D.67 |

Motor connection housings

| | |
|--------------|------|
| Group size 4 | D.68 |
|--------------|------|

RockClassic series

RockClassic
– the solution for standard use



RockClassic Stainless
– the version with corrosion protection



Weidmüller's RockClassic standard housings are robust enclosures made of aluminium die-casting or self-extinguishing thermoplastic (type HAD7).

They are available in different versions, with or without a fixed cover and with mobile protective covers.

RockClassic housings have metric or PG threads. Customers can use Weidmüller's specially developed PG-M Finder to identify every thread quickly and easily.

The black RockClassic Stainless housings with additionally hardened surface are ideal for particularly aggressive environmental and climatic conditions.

All metal parts consist of stainless steel to guarantee optimum corrosion protection.

Weidmüller also offers RockClassic housings with several cable entries as a standard feature.

This means that different cables can be introduced individually into the housings, offering the user enhanced strain relief and greater tightness. This version is particularly recommended when using Weidmüller's modular system.

- Sizes: 1, 2, 3, 4, 5, 6, 7, 8, 9, 10, 12
- Protection: IP65 / IP54 (plastic enclosure size 1)
- 2 types: high, low
- Fastening systems:
 - Side locking on top/bottom
 - End locking lever
 - Central lock in some cases
- Material: aluminium die-casting alloy
- Designs:
 - Silver-grey powder coating
 - Black corrosion protected

RockClassic series

Plug Hood Types

Plug hoods are used in most applications with the female inserts and the hot end of the connector. Modular connector inserts require a high configuration plug hoods.

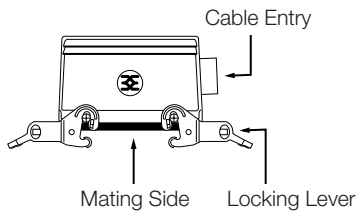

Side cable entry
Side locking position
Locking spigot
Low construction



Side cable entry
End locking position
Locking spigot
High construction



Side cable entry
Side locking position
Two locking levers
High construction

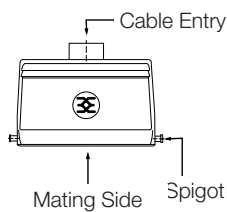

Side cable entry
Center locking position
One locking lever
Low construction



Top cable entry
Side locking position
Two locking levers
Low construction



Top cable entry
End locking position
Locking spigot
High construction

Bulkhead Housings

Bulkhead housings are used for tough panel bulkhead applications. Weidmüller supplies bulkhead housings with a gasket to create a seal between the panel cutout and the bulkhead housing. In addition, Weidmüller offers bulkhead housings with or without covers. For measurements of the panel cutout, see the dimensional drawings and chart on the page XIV.

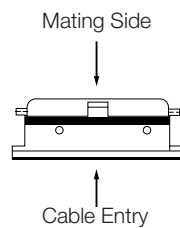

With cover
Side locking position
With locking spigot



Without cover
Center locking position
With locking spigot

Base Housings

Base housing are used for surface mounting on a base plate. Weidmüller base housing are available for all pole numbers and group sizes and can have either one or two side-cable entries. Base housings are offered with or without covers.

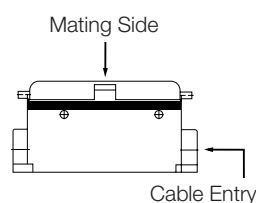

One side cable entry
With cover
Side locking position
With locking spigot
High construction

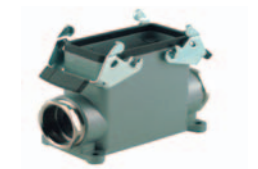

One side cable entry
Without cover
Side locking position
With two locking levers
Low construction

Coupling Hoods

Coupling hoods, which are similar to plug hoods in almost every respect, are used with plug hoods to create a free standing coupling.

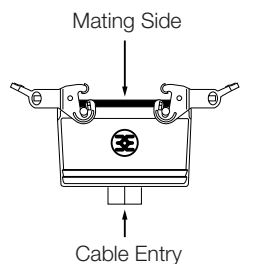

Top cable entry
Without cover
Side locking position
With two locking levers
High construction



Top cable entry
Without cover
End locking position
With one locking lever
High construction

RockClassic

Housing, tops Size 1

Metal housing

Hood

HA-3 TWVL

Cable entry sideways

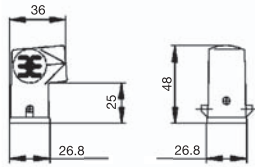

| Metric version | Entry on top | Entry sideways | Qty. | Tall model | Standard model |
|----------------|--------------|----------------|------|------------|----------------|
| w/o sleeve | | 1xM20 | 10 | | 1788810000 |
| | | | | | |
| | | | | | |
| PG | | | | | |
| w. sleeve | | 1xPG11 | 10 | | 1652480000 |
| w. cable gland | | 1xPG11 | 10 | | 1498600000 |
| | | | | | |
| | | | | | |

Hood

HA-3 TOVL

Cable entry on top

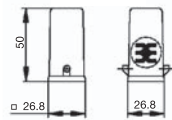

| Metric version | Entry on top | Entry sideways | Qty. | Tall model | Standard model |
|----------------|--------------|----------------|------|------------|----------------|
| w/o sleeve | 1xM20 | | 10 | | 1788820000 |
| | | | | | |
| | | | | | |
| PG | | | | | |
| w. sleeve | 1xPG11 | | 10 | | 1652470000 |
| w. cable gland | 1xPG11 | | 10 | | 1498500000 |
| | | | | | |
| | | | | | |

Cable entry on top and on the side

| Metric version | Entry on top | Entry sideways | Qty. | Tall model | Standard model |
|----------------|--------------|----------------|------|------------|----------------|
| | | | | | |

Cover for plug-, coupling- hood, bulkhead-, base housing

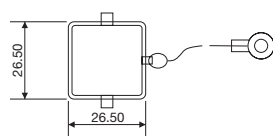

| Version | Qty. | Order No. |
|--------------------|------|------------|
| for bush insertion | 10 | 1665750000 |
| for pin insertion | 10 | 1665740000 |

Housing, bottoms Size 1

Metal housing

Bulkhead housing

HA-3 AVL

Without cover

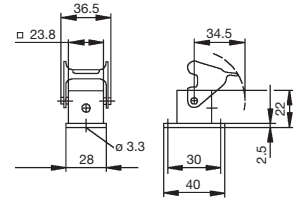

| Version | Qty. | Standard model |
|---------|------|----------------|
| | 1 | 1497600000 |

Bulkhead housing

HA-3 AWVL

with Cover

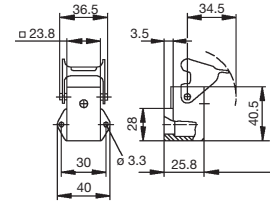

| Version | Qty. | Standard model |
|---------|------|----------------|
| | 10 | 1497700000 |

Cover for plug-, coupling- hood, bulkhead-, base housing

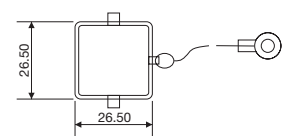

| Version | Qty. | Order No. |
|--------------------|------|------------|
| for bush insertion | 10 | 1665750000 |
| for pin insertion | 10 | 1665740000 |

RockClassic

Housing, bottoms Size 1

Metal housing

Base housing

HA-3 SVL

Without cover

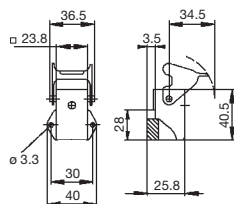

| Metric version | | Qty. | Tall model | Standard model |
|----------------|--------|------|------------|----------------|
| w. sleeve | 1xM20 | 10 | | 1788830000 |
| | | | | |
| | | | | |
| PG | | | | |
| w. sleeve | 1xPG11 | 10 | | 1652490000 |
| w. cable gland | 1xPG11 | 10 | | 1497800000 |
| | | | | |
| | | | | |
| | | | | |
| | | | | |
| | | | | |
| | | | | |

Housing, bottoms Size 1

Metal housing

Coupling hood

HA-3 KVL

Standard version

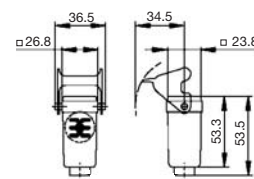

| Metric version | Entry on top | Entry sideways | Qty. | Tall model | Standard model |
|----------------|--------------|----------------|------|------------|----------------|
| w/o sleeve | 1xM20 | | 10 | | 1788840000 |
| | | | | | |
| | | | | | |
| PG | | | | | |
| w. sleeve | 1xPG11 | | 10 | | 1652500000 |
| w. cable gland | 1xPG11 | | 10 | | 1497900000 |
| | | | | | |
| | | | | | |
| | | | | | |
| | | | | | |
| | | | | | |
| | | | | | |

Cover for plug-, coupling- hood, bulkhead-, base housing

| Version | Qty. | Order No. |
|--------------------|------|------------|
| for bush insertion | 10 | 1665750000 |
| for pin insertion | 10 | 1665740000 |

Cover for plug-, coupling- hood, bulkhead-, base housing

| Version | Qty. | Order No. |
|--------------------|------|------------|
| for bush insertion | 10 | 1665750000 |
| for pin insertion | 10 | 1665740000 |

Articles with coloured order number are kept permanently in stock at the central warehouse in Germany.
Delivery times see page X.2

RockClassic

Housing, tops Size 1

Plastic housing

Hood

HAD-7 TWVL

Cable entry sideways

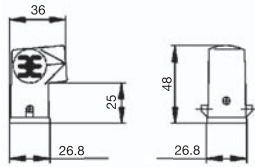

| Metric version | Entry on top | Entry sideways | Qty. | Tall model | Standard model |
|----------------|--------------|----------------|------|------------|----------------|
| w/o sleeve | | 1xM20 | 10 | | 1788510000 |
| | | | | | |
| | | | | | |
| PG | | | | | |
| w. sleeve | | 1xPG11 | 10 | | 1652400000 |
| w. cable gland | | 1xPG11 | 10 | | 1652390000 |
| | | | | | |
| | | | | | |
| | | | | | |

Hood

HAD-7 TOVL

Cable entry on top

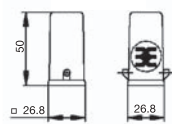

| Metric version | Entry on top | Entry sideways | Qty. | Tall model | Standard model |
|----------------|--------------|----------------|------|------------|----------------|
| w/o sleeve | 1xM20 | | 10 | | 1788520000 |
| | | | | | |
| | | | | | |
| PG | | | | | |
| w. sleeve | 1xPG11 | | 10 | | 1652380000 |
| w. cable gland | 1xPG11 | | 10 | | 1652370000 |
| | | | | | |
| | | | | | |
| | | | | | |

Cable entry on top and on the side

| Metric version | Entry on top | Entry sideways | Qty. | Tall model | Standard model |
|----------------|--------------|----------------|------|------------|----------------|
| | | | | | |

Cover for plug-, coupling- hood, bulkhead-, base housing

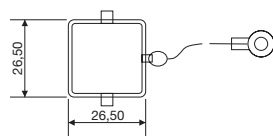

| Version | Qty. | Order No. |
|--------------------|------|------------|
| for bush insertion | 10 | 1665770000 |
| for pin insertion | 10 | 1665760000 |

Housing, bottoms Size 1

Plastic housing

Bulkhead housing

HAD-7 AVL

Without cover

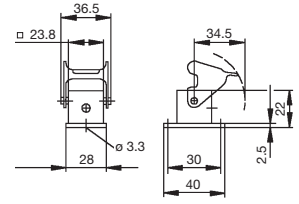

| Version | Qty. | Standard model |
|---------|------|----------------|
| | 1 | 1652410000 |

Bulkhead housing

HAD-7 AWVL

with Cover

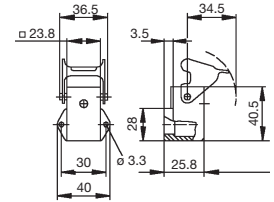

| Version | Qty. | Standard model |
|---------|------|----------------|
| | 1 | 1652420000 |

Cover for plug-, coupling- hood, bulkhead-, base housing

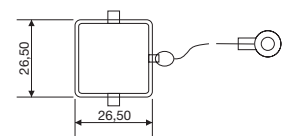

| Version | Qty. | Order No. |
|--------------------|------|------------|
| for bush insertion | 10 | 1665770000 |
| for pin insertion | 10 | 1665760000 |

RockClassic

Housing, bottoms Size 1

Plastic housing

Base housing

HAD-7 SVL

Without cover

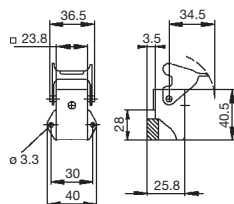

| Metric version | | Qty. | Tall model | Standard model |
|----------------|--------|------|------------|----------------|
| w/o sleeve | 1xM20 | 10 | | 1788530000 |
| | | | | |
| | | | | |
| PG | | | | |
| w. sleeve | 1xPG11 | 10 | | 1652440000 |
| w. cable gland | 1xPG11 | 10 | | 1652430000 |
| | | | | |
| | | | | |
| | | | | |
| | | | | |
| | | | | |
| | | | | |

Housing, bottoms Size 1

Plastic housing

Coupling hood

HAD-7 KVL

Standard version

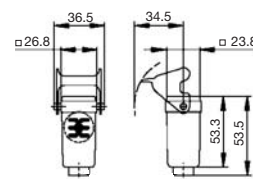

| Metric version | Entry on top | Entry sideways | Qty. | Tall model | Standard model |
|----------------|--------------|----------------|------|------------|----------------|
| w/o sleeve | 1xM20 | | 10 | | 1788540000 |
| | | | | | |
| | | | | | |
| PG | | | | | |
| w. sleeve | 1xPG11 | | 10 | | 1652460000 |
| w. cable gland | 1xPG11 | | 10 | | 1652450000 |
| | | | | | |
| | | | | | |
| | | | | | |
| | | | | | |
| | | | | | |
| | | | | | |
| | | | | | |

Cover for plug-, coupling- hood, bulkhead-, base housing

| Version | Qty. | Order No. |
|--------------------|------|------------|
| for bush insertion | 10 | 1665770000 |
| for pin insertion | 10 | 1665760000 |

Cover for plug-, coupling- hood, bulkhead-, base housing

| Version | Qty. | Order No. |
|--------------------|------|------------|
| for bush insertion | 10 | 1665770000 |
| for pin insertion | 10 | 1665760000 |

Articles with coloured order number are kept permanently in stock at the central warehouse in Germany.
Delivery times see page X.2

RockClassic

Housing, tops Size 2

End locking, bottom

Hood

HA-10 / HAD-15 TSVL

Cable entry sideways

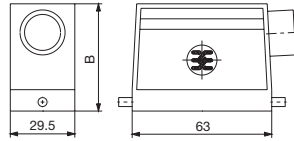

Tall model [mm] B = 67.3
Standard model [mm] B = 53.5

| Metric version | Entry on top | Entry sideways | Qty. | Tall model | Standard model |
|----------------|--------------|----------------|------|------------|----------------|
| w. sleeve | | 1xM20 | 5 | | 1788600000 |
| w. sleeve | | 1xM25 | 5 | | 1788590000 |
| w/o sleeve | | 1xM20 | 5 | 1788860000 | |
| w/o sleeve | | 1xM25 | 5 | 1788850000 | |
| PG | | | | | |
| w. sleeve | | 1xPG16 | 5 | 1663850000 | 1663810000 |
| w. cable gland | | 1xPG16 | 5 | 1663840000 | 1663800000 |
| w. sleeve | | 1xPG21 | 5 | 1663870000 | |
| w. cable gland | | 1xPG21 | 5 | 1663860000 | |

Hood

HA-10 / HAD-15 TOVL

Cable entry on top

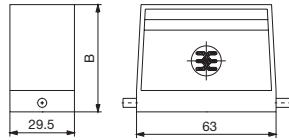

Tall model [mm] B = 67.3
Standard model [mm] B = 53.5

| Metric version | Entry on top | Entry sideways | Qty. | Tall model | Standard model |
|----------------|--------------|----------------|------|------------|----------------|
| w/o sleeve | 1xM20 | | 5 | 1788880000 | 1788620000 |
| w/o sleeve | 1xM25 | | 5 | 1788870000 | 1788610000 |
| PG | | | | | |
| w. sleeve | 1xPG16 | | 5 | 1663970000 | 1663930000 |
| w. cable gland | 1xPG16 | | 5 | 1663960000 | 1663920000 |
| w. sleeve | 1xPG21 | | 5 | 1663990000 | |
| w. cable gland | 1xPG21 | | 5 | 1663980000 | |

Cable entry on top and on the side

| Metric version | Entry on top | Entry sideways | Qty. | Tall model | Standard model |
|----------------|--------------|----------------|------|------------|----------------|
|----------------|--------------|----------------|------|------------|----------------|

Cover for hood

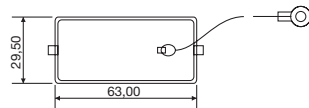

| Version | Qty. | Order No. |
|---------|------|------------|
| | 5 | 1665890000 |

Housing, bottoms Size 2

End locking, bottom

Bulkhead housing

HA-10 AVL

Without cover

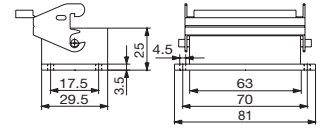

| Version | Qty. | Standard model |
|---------|------|----------------|
| | 1 | 1664040000 |

Bulkhead housing

HA-10 ADVL

with Cover

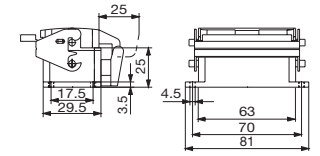

| Version | Qty. | Standard model |
|---------|------|----------------|
| | 1 | 1664060000 |

Cover for housing bottoms

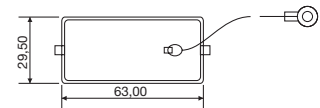

| Version | Qty. | Order No. |
|---------|------|------------|
| | 5 | 1665880000 |

RockClassic

Housing, bottoms Size 2

End locking, bottom

Base housing

HA-10 SVL

Without cover

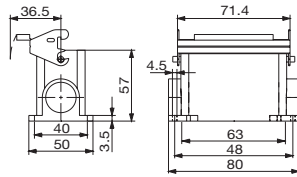

| Metric version | | Qty. | Tall model | Standard model |
|----------------|--------|------|------------|----------------|
| w/o sleeve | 2xM20 | 5 | | 1788640000 |
| w/o sleeve | 2xM25 | 5 | | 1788630000 |
| PG | | | | |
| w. sleeve | 1xPG16 | 5 | | 1664170000 |
| w. cable gland | 1xPG16 | 5 | | 1664160000 |
| w. sleeve | 1xPG21 | 5 | | 1664210000 |
| w. cable gland | 1xPG21 | 5 | | 1664200000 |
| w. sleeve | 2xPG16 | 5 | | 1664190000 |
| w. cable gland | 2xPG16 | 5 | | 1664180000 |

Base housing

HA-10 SDVL

With cover

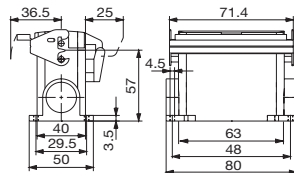

| Metric version | | Qty. | Tall model | Standard model |
|----------------|--------|------|------------|----------------|
| w/o sleeve | 2xM20 | 5 | | 1788660000 |
| PG | | | | |
| w. sleeve | 1xPG16 | 5 | | 1664410000 |
| w. cable gland | 1xPG16 | 5 | | 1664400000 |

Cover for housing bottoms

| Version | Qty. | Order No. |
|---------|------|------------|
| | 5 | 1665880000 |

Housing, bottoms Size 2

End locking, bottom

Coupling hood

HA-10 / HAD-15 KVL

Standard version

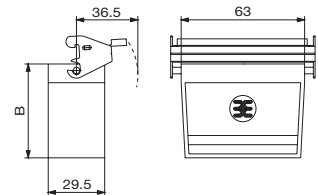

Tall model [mm]
Standard model [mm]
B = 62
B = 48

| Metric version | Entry on top | Entry sideways | Qty. | Tall model | Standard model |
|----------------|--------------|----------------|------|------------|----------------|
| w/o sleeve | 1xM25 | | 5 | 1788890000 | 1788670000 |
| PG | | | | | |
| w. cable gland | 1xPG16 | | 5 | | 1664560000 |
| w. sleeve | 1xPG21 | | 2 | 1664630000 | |
| w. cable gland | 1xPG21 | | 2 | 1664620000 | |

Cover for housing bottoms

| Version | Qty. | Order No. |
|---------|------|------------|
| | 5 | 1665880000 |

Articles with coloured order number are kept permanently in stock at the central warehouse in Germany.
Delivery times see page X.2

RockClassic

Housing, tops Size 3

End locking, bottom

Housing, bottoms Size 3

End locking, bottom

Hood

HB-6 / HBD-16 TSVL

Cable entry sideways

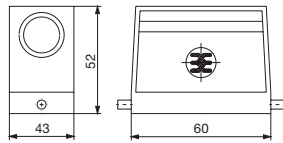

Tall model [mm] B = 72
Standard model [mm] B = 52

| Metric version | Entry on top | Entry sideways | Qty. | Tall model | Standard model |
|----------------|--------------|----------------|------|------------|----------------|
| w. sleeve | | 1xM20 | 10 | | 1788100000 |
| w/o sleeve | | 1xM20 | 10 | | 1805930000 |
| w. sleeve | | 1xM25 | 10 | | 1788090000 |
| w/o sleeve | | 1xM25 | 10 | 1787480000 | |
| PG | | | | | |
| w. sleeve | | 1xPG13 | 5 | | 1670530000 |
| w. cable gland | | 1xPG13 | 5 | | 1201900000 |
| w. sleeve | | 1xPG16 | 5 | | 1652520000 |
| w. cable gland | | 1xPG16 | 5 | | 1652510000 |
| w. sleeve | | 1xPG21 | 5 | 1652560000 | |
| w. cable gland | | 1xPG21 | 5 | 1652550000 | |

Hood

HB-6 / HBD-16 TOVL

Cable entry on top

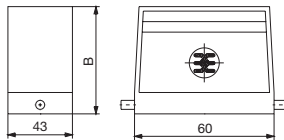

Tall model [mm] B = 72
Standard model [mm] B = 52

| Metric version | Entry on top | Entry sideways | Qty. | Tall model | Standard model |
|----------------|--------------|----------------|------|------------|----------------|
| w/o sleeve | 1xM20 | | 10 | | 1788120000 |
| w/o sleeve | 1xM25 | | 10 | 1787500000 | 1788110000 |
| w/o sleeve | 1xM32 | | 10 | 1787490000 | |
| PG | | | | | |
| w. sleeve | 1xPG13 | | 5 | | 1670500000 |
| w. cable gland | 1xPG13 | | 5 | | 1201800000 |
| w. sleeve | 1xPG16 | | 5 | | 1652640000 |
| w. cable gland | 1xPG16 | | 5 | | 1652630000 |
| w. sleeve | 1xPG21 | | 5 | 1652680000 | |
| w. cable gland | 1xPG21 | | 5 | 1652670000 | |

Hood

HB-6 / HBD-16 TVL

Cable entry on top and on the side

| Metric version | Entry on top | Entry sideways | Qty. | Tall model | Standard model |
|----------------|--------------|----------------|------|------------|----------------|
| | 1xM32 | 2xM16 | 10 | 1851840000 | |

Cover for hood

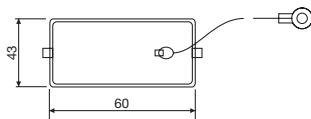

| Version | Qty. | Order No. |
|---------|------|------------|
| | 2 | 1665210000 |

Bulkhead housing

HB-6 AVL

Without cover

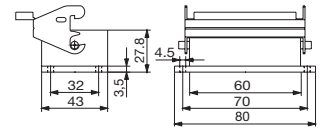

| Version | Qty. | Standard model |
|---------|------|----------------|
| | 5 | 1202100000 |

Bulkhead housing

HB-6 ADVL

with Cover

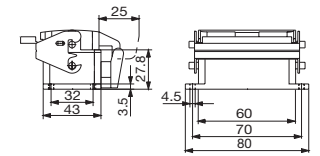

| Version | Qty. | Standard model |
|---------|------|----------------|
| | 1 | 1202500000 |

Cover for housing bottoms

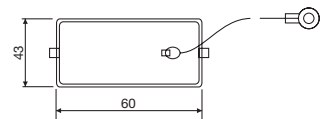

| Version | Qty. | Order No. |
|---------|------|------------|
| | 5 | 1665200000 |

RockClassic

Housing, bottoms Size 3

End locking, bottom

Base housing

HB-6 / HBD-16 SVL

Without cover

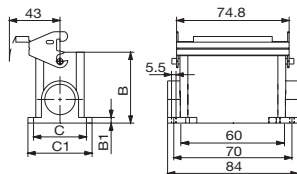

Tall model [mm] B = 74 / B1 = 6 / C = 45 / C1 = 58
Standard model [mm] B = 54 / B1 = 4.5 / C = 40 / C1 = 54

| Metric version | | Qty. | Tall model | Standard model |
|----------------|--------|------|------------|----------------|
| w/o sleeve | 2xM20 | 10 | | 1788140000 |
| w/o sleeve | 2xM25 | 10 | 1787520000 | 1788130000 |
| w/o sleeve | 2xM32 | 10 | 1787510000 | |
| PG | | | | |
| w. sleeve | 1xPG16 | 5 | | 1652750000 |
| w. cable gland | 1xPG16 | 5 | | 1202200000 |
| w. sleeve | 2xPG16 | 5 | | 1652760000 |
| w. cable gland | 2xPG16 | 5 | | 1202300000 |
| w. sleeve | 1xPG21 | 5 | 1652820000 | |
| w. cable gland | 1xPG21 | 5 | 1652810000 | |
| w. sleeve | 2xPG21 | 5 | 1652840000 | |

Base housing

HB-6 / HBD-16 SDVL

With cover

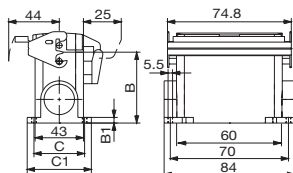

Tall model [mm] B = 74 / B1 = 6 / C = 45 / C1 = 58
Standard model [mm] B = 54 / B1 = 4.5 / C = 40 / C1 = 54

| Metric version | | Qty. | Tall model | Standard model |
|----------------|--------|------|------------|----------------|
| w/o sleeve | 1xM25 | 2 | 1787540000 | 1802240000 |
| w/o sleeve | 2xM20 | 10 | 1787530000 | 1788170000 |
| w/o sleeve | 2xM25 | 10 | | 1788160000 |
| PG | | | | |
| w. sleeve | 1xPG16 | 2 | | 1652980000 |
| w. cable gland | 1xPG16 | 2 | 1653040000 | 1202600000 |
| w. sleeve | 2xPG16 | 2 | | 1652990000 |
| w. cable gland | 2xPG16 | 2 | | 1202700000 |

Cover for housing bottoms

| Version | Qty. | Order No. |
|---------|------|------------|
| | 5 | 1665200000 |

Housing, bottoms Size 3

End locking, bottom

Coupling hood

HB-6 / HBD-16 KVL

Standard version

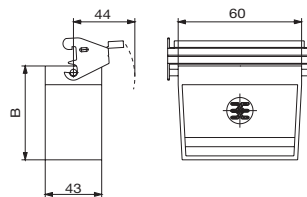

Tall model [mm] B = 74.8
Standard model [mm] B = 54.8

| Metric version | Entry on top | Entry sideways | Qty. | Tall model | Standard model |
|----------------|--------------|----------------|------|------------|----------------|
| w/o sleeve | 1xM20 | | 5 | | 1837550000 |
| PG | | | | | |
| w. sleeve | 1xPG16 | | 5 | | 1653200000 |
| w. cable gland | 1xPG16 | | 5 | | 1202400000 |
| w. cable gland | 1xPG21 | | 5 | 1653230000 | |

Cover for housing bottoms

| Version | Qty. | Order No. |
|---------|------|------------|
| | 5 | 1665200000 |

Articles with coloured order number are kept permanently in stock at the central warehouse in Germany.
Delivery times see page X.2

RockClassic

Housing, tops Size 4

Side locking, bottom

Housing, bottoms Size 4

Side locking, bottom

Hood

HB-10 / HBD-24 TSVU

Cable entry sideways

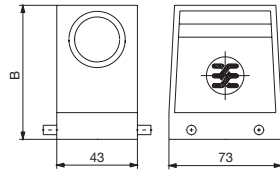

Tall model [mm] B = 72
Standard model [mm] B = 52

| Metric version | Entry on top | Entry sideways | Qty. | Tall model | Standard model |
|----------------|--------------|----------------|------|------------|----------------|
| w. sleeve | | 1xM20 | 10 | | 1787560000 |
| w. sleeve | | 1xM25 | 10 | | 1787550000 |
| w/o sleeve | | 1xM25 | 10 | 1787240000 | |
| w/o sleeve | | 1xM32 | 10 | 1787230000 | |
| PG | | | | | |
| w. sleeve | | 1xPG16 | 5 | | 1654070000 |
| w. cable gland | | 1xPG16 | 5 | | 1204800000 |
| w. sleeve | | 1xPG21 | 5 | 1654150000 | 1654090000 |
| w. cable gland | | 1xPG21 | 5 | 1654140000 | 1654080000 |
| w. sleeve | | 1xPG29 | 5 | 1654170000 | |
| w. cable gland | | 1xPG29 | 5 | 1654160000 | |

Hood

HB-10 / HBD-24 TOVU

Cable entry on top

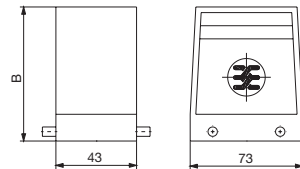

Tall model [mm] B = 72
Standard model [mm] B = 52

| Metric version | Entry on top | Entry sideways | Qty. | Tall model | Standard model |
|----------------|--------------|----------------|------|------------|----------------|
| w/o sleeve | 1xM20 | | 10 | | 1787600000 |
| w/o sleeve | 1xM25 | | 10 | 1787300000 | 1787590000 |
| w/o sleeve | 1xM32 | | 10 | 1787290000 | |
| PG | | | | | |
| w. sleeve | 1xPG16 | | 5 | | 1654220000 |
| w. cable gland | 1xPG16 | | 5 | | 1204700000 |
| w. cable gland | 1xPG21 | | 5 | 1654290000 | 1654230000 |
| w. sleeve | 1xPG21 | | 5 | | 1654240000 |
| w. sleeve | 1xPG29 | | 5 | 1654320000 | |
| w. cable gland | 1xPG29 | | 5 | 1654310000 | |

Hood

HB-10 / HBD-24 TVU

Cable entry on top and on the side

| Metric version | Entry on top | Entry sideways | Qty. | Tall model | Standard model |
|----------------|--------------|----------------|------|------------|----------------|
| | 1xM25 | 2xM16 | 10 | 1851850000 | |

Cover for hood

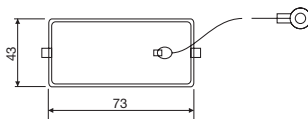

| Version | Qty. | Order No. |
|---------|------|------------|
| | 2 | 1665240000 |

Bulkhead housing

HB-10 AVU

Without cover

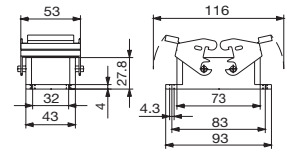

| Version | Qty. | Standard model |
|---------|------|----------------|
| | 1 | 1205000000 |

Cover for housing bottoms

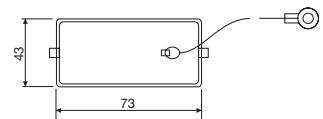

| Version | Qty. | Order No. |
|---------|------|------------|
| | 5 | 1665230000 |

RockClassic

Housing, bottoms Size 4

Side locking, bottom

Base housing

HB-10 / HBD-24 SVU

Without cover



Tall model [mm]
Standard model [mm]

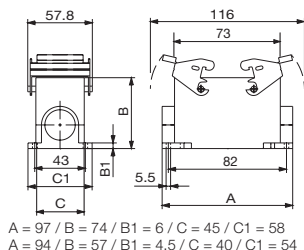

A = 97 / B = 74 / B1 = 6 / C = 45 / C1 = 58
A = 94 / B = 57 / B1 = 4.5 / C = 40 / C1 = 54

| Metric version | | Qty. | Tall model | Standard model |
|----------------|--------|------|------------|----------------|
| w/o sleeve | 2xM20 | 10 | | 1787640000 |
| w/o sleeve | 2xM25 | 10 | 1787350000 | 1787630000 |
| w/o sleeve | 2xM32 | 10 | 1787360000 | |
| PG | | | | |
| w. sleeve | 1xPG16 | 2 | | 1654370000 |
| w. cable gland | 1xPG16 | 2 | | 1205100000 |
| w. sleeve | 2xPG16 | 2 | | 1654380000 |
| w. cable gland | 2xPG16 | 2 | | 1205200000 |
| w. sleeve | 1xPG21 | 2 | 1654430000 | |
| w. cable gland | 1xPG21 | 2 | 1654420000 | |
| w. sleeve | 1xPG29 | 2 | 1654470000 | |
| w. sleeve | 2xPG21 | 2 | 1654450000 | |
| w. cable gland | 2xPG21 | 2 | 1654440000 | |
| w. cable gland | 2xPG29 | 2 | 1654480000 | |

Housing, bottoms Size 4

Side locking, bottom

Coupling hood

HB-10 / HBD-24 KVV

Standard version



Tall model [mm]
Standard model [mm]

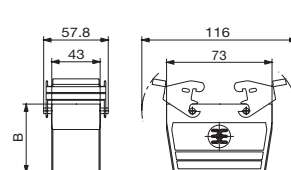

B = 74.8
B = 54.8

| Metric version | Entry on top | Entry sideways | Qty. | Tall model | Standard model |
|----------------|--------------|----------------|------|------------|----------------|
| w/o sleeve | 1xM20 | | 10 | | 1787720000 |
| w/o sleeve | 1xM25 | | 10 | 1787440000 | 1787710000 |
| w/o sleeve | 1xM32 | | 10 | 1787430000 | |
| PG | | | | | |
| w. sleeve | 1xPG16 | | 5 | | 1654580000 |
| w. cable gland | 1xPG16 | | 5 | | 1205300000 |
| w. cable gland | 1xPG21 | | 5 | 1654650000 | 1654590000 |
| w. cable gland | 1xPG29 | | 5 | 1654670000 | |
| | | | | | |
| | | | | | |
| | | | | | |
| | | | | | |
| | | | | | |

Cover for housing bottoms

| Version | Qty. | Order No. |
|---------|------|------------|
| | 5 | 1665230000 |

Cover for housing bottoms

| Version | Qty. | Order No. |
|---------|------|------------|
| | 5 | 1665230000 |

Articles with coloured order number are kept permanently in stock at the central warehouse in Germany.
Delivery times see page X.2

RockClassic

Housing, tops Size 4

End locking, bottom

Housing, bottoms Size 4

End locking, bottom

Hood

HB-10 / HBD-24 TSVL

Cable entry sideways

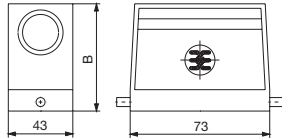

Tall model [mm] B = 72
Standard model [mm] B = 52

| Metric version | Entry on top | Entry sideways | Qty. | Tall model | Standard model |
|----------------|--------------|----------------|------|------------|----------------|
| w. sleeve | | 1xM25 | 10 | | 1787580000 |
| w/o sleeve | | 1xM25 | 10 | 1787280000 | |
| w/o sleeve | | 1xM32 | 10 | 1787270000 | |

PG

| | | | | | |
|----------------|--|--------|---|------------|------------|
| w. sleeve | | 1xPG16 | 5 | | 1655210000 |
| w. cable gland | | 1xPG16 | 5 | | 1206000000 |
| w. sleeve | | 1xPG21 | 2 | 1655250000 | |
| w. cable gland | | 1xPG21 | 2 | 1655240000 | |
| w. sleeve | | 1xPG29 | 2 | 1655270000 | |
| w. cable gland | | 1xPG29 | 2 | 1655260000 | |

Hood

HB-10 / HBD-24 TOVL

Cable entry on top

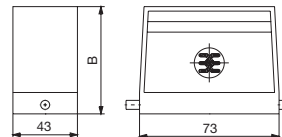

Tall model [mm] B = 72
Standard model [mm] B = 52

| Metric version | Entry on top | Entry sideways | Qty. | Tall model | Standard model |
|----------------|--------------|----------------|------|------------|----------------|
| w/o sleeve | 1xM25 | | 10 | 1787340000 | 1787620000 |
| w/o sleeve | 1xM32 | | 10 | 1787330000 | |

PG

| | | | | | |
|----------------|--------|--|---|------------|------------|
| w. sleeve | 1xPG16 | | 5 | | 1655320000 |
| w. cable gland | 1xPG16 | | 5 | | 1205900000 |
| w. sleeve | 1xPG21 | | 2 | 1655360000 | |
| w. cable gland | 1xPG21 | | 2 | 1655350000 | |
| w. sleeve | 1xPG29 | | 2 | 1655380000 | |
| w. cable gland | 1xPG29 | | 2 | 1655370000 | |

Cable entry on top and on the side

| Metric version | Entry on top | Entry sideways | Qty. | Tall model | Standard model |
|----------------|--------------|----------------|------|------------|----------------|
|----------------|--------------|----------------|------|------------|----------------|

Bulkhead housing

HB-10 AVL

Without cover

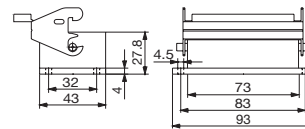

| Version | Qty. | Standard model |
|---------|------|----------------|
| | 5 | 1206100000 |

Bulkhead housing

HB-10 ADVL

with Cover

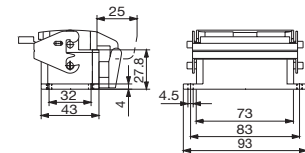

| Version | Qty. | Standard model |
|---------|------|----------------|
| | 1 | 1206500000 |

RockClassic

Housing, bottoms Size 4

End locking, bottom

Base housing

HB-10 / HBD-24 SVL

Without cover

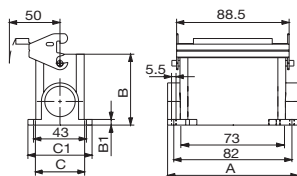

Tall model [mm]
Standard model [mm]

B = 74 / B1 = 6 / C = 45 / C1 = 58
B = 57 / B1 = 4.5 / C = 40 / C1 = 54

| Metric version | | Qty. | Tall model | Standard model |
|----------------|--------|------|------------|----------------|
| w/o sleeve | 2xM20 | 10 | | 1787660000 |
| w/o sleeve | 2xM25 | 10 | 1787380000 | 1787650000 |
| w/o sleeve | 2xM32 | 10 | 1787370000 | |
| PG | | | | |
| w. sleeve | 1xPG16 | 2 | | 1655460000 |
| w. cable gland | 1xPG16 | 2 | | 1206200000 |
| w. sleeve | 2xPG16 | 2 | | 1655470000 |
| w. cable gland | 2xPG16 | 2 | | 1206300000 |
| w. cable gland | 1xPG21 | 2 | 1655510000 | |
| w. cable gland | 1xPG29 | 2 | 1655550000 | |
| | | | | |
| | | | | |
| | | | | |
| | | | | |
| | | | | |

Base housing

HB-10 / HBD-24 SDVL

With cover

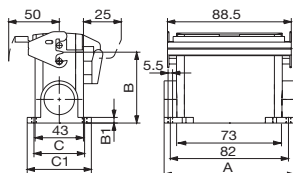

Tall model [mm]
Standard model [mm]

B = 74 / B1 = 6 / C = 45 / C1 = 58
B = 57 / B1 = 4.5 / C = 40 / C1 = 54

| Metric version | | Qty. | Tall model | Standard model |
|----------------|--------|------|------------|----------------|
| w/o sleeve | 2xM20 | 10 | 1787420000 | 1787700000 |
| w/o sleeve | 2xM25 | 10 | 1787410000 | 1787690000 |
| PG | | | | |
| w. sleeve | 1xPG16 | 2 | | 1655670000 |
| w. cable gland | 1xPG16 | 2 | 1655720000 | 1206600000 |
| w. sleeve | 2xPG16 | 2 | | 1655680000 |
| w. cable gland | 2xPG16 | 2 | | 1206700000 |
| | | | | |
| | | | | |
| | | | | |
| | | | | |
| | | | | |

Housing, bottoms Size 4

End locking, bottom

Coupling hood

HB-10 / HBD-24 KVL

Standard version

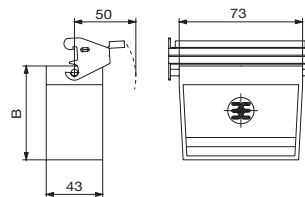

Tall model [mm]
Standard model [mm]

B = 74.8
B = 54.8

| Metric version | Entry on top | Entry sideways | Qty. | Tall model | Standard model |
|----------------|--------------|----------------|------|------------|----------------|
| w/o sleeve | 1xM20 | | 10 | | 1787740000 |
| w/o sleeve | 1xM25 | | 10 | 1787460000 | 1787730000 |
| w/o sleeve | 1xM32 | | 10 | 1787450000 | |
| PG | | | | | |
| w. sleeve | 1xPG16 | | 2 | | 1655890000 |
| w. cable gland | 1xPG16 | | 2 | | 1655880000 |
| w. cable gland | 1xPG21 | | 2 | | 1655900000 |
| | | | | | |
| | | | | | |
| | | | | | |
| | | | | | |
| | | | | | |

RockClassic

Top Size 4

Side locking, top

Bottom Size 4

Side locking, top

Hood

HB-10 / HBD-24 TSVO

Cable entry sideways

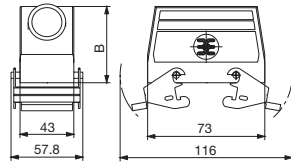

Tall model [mm]
Standard model [mm]

B = 72
B = 52

| Metric version | Entry on top | Entry sideways | Qty. | Tall model | Standard model |
|----------------|--------------|----------------|------|------------|----------------|
| w. sleeve | | 1xM25 | 10 | | 1787570000 |
| w/o sleeve | | 1xM25 | 10 | 1787260000 | |
| w/o sleeve | | 1xM32 | 10 | 1787250000 | |

PG

| | | | | | |
|----------------|--|--------|---|------------|------------|
| w. sleeve | | 1xPG16 | 5 | | 1654750000 |
| w. cable gland | | 1xPG16 | 5 | | 1205500000 |
| w. sleeve | | 1xPG21 | 2 | 1654790000 | |
| w. cable gland | | 1xPG21 | 2 | 1654780000 | |
| w. sleeve | | 1xPG29 | 2 | 1654810000 | |
| w. cable gland | | 1xPG29 | 2 | 1654800000 | |

Hood

HB-10 / HBD-24 TOVO

Cable entry on top

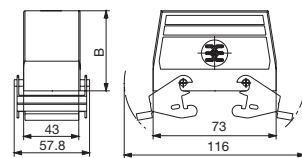

Tall model [mm]
Standard model [mm]

B = 72
B = 52

| Metric version | Entry on top | Entry sideways | Qty. | Tall model | Standard model |
|----------------|--------------|----------------|------|------------|----------------|
| w/o sleeve | 1xM25 | | 10 | 1787320000 | 1787610000 |
| w/o sleeve | 1xM32 | | 10 | 1787310000 | |

PG

| | | | | | |
|----------------|--------|--|---|------------|------------|
| w. sleeve | 1xPG16 | | 5 | | 1654860000 |
| w. cable gland | 1xPG16 | | 5 | | 1205400000 |
| w. cable gland | 1xPG21 | | 2 | 1654890000 | |
| w. sleeve | 1xPG29 | | 2 | 1654920000 | |
| w. cable gland | 1xPG29 | | 2 | 1654910000 | |

Bulkhead housing

HB-10 ADVO

Without cover

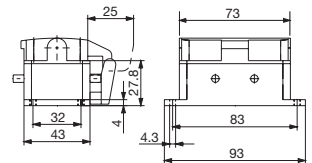

| Metric version | Qty. | Standard model |
|----------------|------|----------------|
| | 1 | 1205600000 |

Base housing

HB-10 / HBD-24 SDVO

Without cover

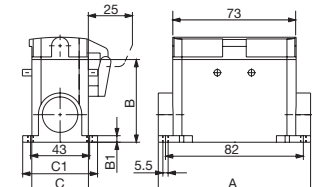

Tall model [mm]
Standard model [mm]

B = 74 / B1 = 6
B = 57 / B1 = 4.5

| Metric version | Entry on top | Entry sideways | Qty. | Tall model | Standard model |
|----------------|--------------|----------------|------|------------|----------------|
| w/o sleeve | | 2xM20 | 10 | 1787400000 | 1787680000 |
| w/o sleeve | | 2xM25 | 10 | 1787390000 | 1787670000 |

PG

| | | | | | |
|----------------|--------|--|---|------------|------------|
| w. sleeve | 1xPG16 | | 2 | | 1654990000 |
| w. cable gland | 1xPG16 | | 2 | 1655050000 | 1205700000 |
| w. sleeve | 2xPG16 | | 2 | | 1655000000 |
| w. cable gland | 2xPG16 | | 2 | 1655090000 | 1205800000 |
| w. cable gland | 2xPG29 | | 1 | 1655110000 | |

Cover for hood

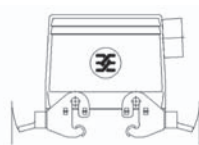

| Version | Qty. | Order No. |
|---------|------|------------|
| | 5 | 1665250000 |

RockClassic

Housing, tops Size 5

End locking, bottom

Hood

HA-16 / HAD-25 TSVL

Cable entry sideways

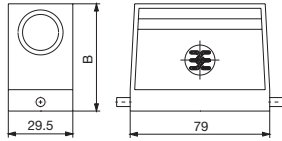

Tall model [mm] B = 72.3
Standard model [mm] B = 58.3

| Metric version | Entry on top | Entry sideways | Qty. | Tall model | Standard model |
|----------------|--------------|----------------|------|------------|----------------|
| w. sleeve | | 1xM20 | 5 | | 1804620000 |
| w. sleeve | | 1xM25 | 5 | | 1788740000 |
| w/o sleeve | | 1xM20 | 5 | 1788680000 | |
| w/o sleeve | | 1xM25 | 5 | 1788690000 | |
| PG | | | | | |
| w. sleeve | | 1xPG16 | 5 | 1664730000 | 1664690000 |
| w. cable gland | | 1xPG16 | 5 | 1664720000 | 1664680000 |
| w. sleeve | | 1xPG21 | 5 | 1664750000 | |
| w. cable gland | | 1xPG21 | 5 | 1664740000 | |

Hood

HA-16 / HAD-25 TOVL

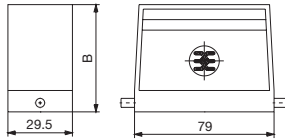
Cable entry on top



Tall model [mm] B = 72.3
Standard model [mm] B = 58.3

| Metric version | Entry on top | Entry sideways | Qty. | Tall model | Standard model |
|----------------|--------------|----------------|------|------------|----------------|
| w/o sleeve | 1xM20 | | 5 | 1788710000 | 1804680000 |
| w/o sleeve | 1xM25 | | 5 | 1788700000 | 1788750000 |
| PG | | | | | |
| w. sleeve | 1xPG16 | | 5 | | 1664810000 |
| w. cable gland | 1xPG16 | | 5 | 1664840000 | 1664800000 |
| w. sleeve | 1xPG21 | | 5 | 1664870000 | |
| w. cable gland | 1xPG21 | | 5 | 1664860000 | |

Cable entry on top and on the side

| Metric version | Entry on top | Entry sideways | Qty. | Tall model | Standard model |
|----------------|--------------|----------------|------|------------|----------------|
| | | | | | |

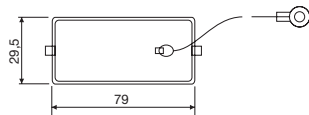
Cover for hood



| Version | Qty. | Order No. |
|---------|------|------------|
| | 5 | 1665910000 |

Housing, bottoms Size 5

End locking, bottom

Bulkhead housing

HA-16 AVL

Without cover

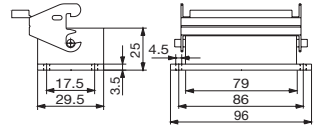

| Version | Qty. | Standard model |
|---------|------|----------------|
| | 1 | 1664920000 |

Bulkhead housing

HA-16 ADVL

with Cover

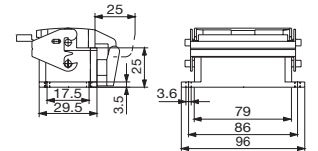

| Version | Qty. | Standard model |
|---------|------|----------------|
| | 1 | 1664940000 |

Cover for housing bottoms

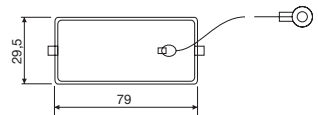

| Version | Qty. | Order No. |
|---------|------|------------|
| | 5 | 1665900000 |

RockClassic

Housing, bottoms Size 5

End locking, bottom

Base housing

HA-16 SVL

Without cover

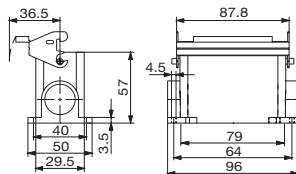

| Metric version | | Qty. | Tall model | Standard model |
|----------------|--------|------|------------|----------------|
| w/o sleeve | 2xM20 | 5 | | 1788770000 |
| w/o sleeve | 2xM25 | 5 | | 1788760000 |
| PG | | | | |
| w. sleeve | 1xPG16 | 5 | | 1665050000 |
| w. cable gland | 1xPG16 | 5 | | 1665040000 |
| w. sleeve | 1xPG21 | 5 | | 1665090000 |
| w. cable gland | 1xPG21 | 5 | | 1665080000 |
| w. sleeve | 2xPG16 | 2 | | 1665070000 |
| w. cable gland | 2xPG16 | 2 | | 1665060000 |
| w. cable gland | 2xPG21 | 2 | | 1665100000 |

Base housing

HA-16 SDVL

With cover

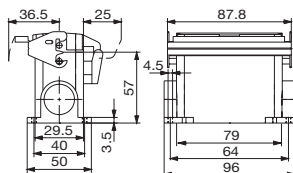

| Metric version | | Qty. | Tall model | Standard model |
|----------------|--------|------|------------|----------------|
| w/o sleeve | 2xM20 | 5 | | 1788790000 |
| PG | | | | |
| w. cable gland | 1xPG16 | 2 | | 1665280000 |
| w. cable gland | 2xPG16 | 2 | | 1665300000 |
| w. cable gland | 2xPG21 | 2 | | 1665340000 |

Cover for housing bottoms

| Version | Qty. | Order No. |
|---------|------|------------|
| | 5 | 1665900000 |

Housing, bottoms Size 5

End locking, bottom

Coupling hood

HA-16 / HAD-25 KVL

Standard version

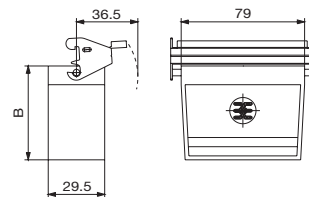

| Metric version | Entry on top | Entry sideways | Qty. | Tall model | Standard model |
|----------------|--------------|----------------|------|------------|----------------|
| w/o sleeve | 1xM25 | | 5 | 1788720000 | 1788800000 |
| w/o sleeve | 1xM20 | | 5 | 1788730000 | |
| PG | | | | | |
| w. sleeve | 1xPG16 | | 5 | | 1665450000 |
| w. cable gland | 1xPG16 | | 5 | 1665480000 | 1665440000 |
| w. cable gland | 1xPG21 | | 2 | 1665500000 | |

| Version | Qty. | Order No. |
|---------|------|------------|
| | 5 | 1665900000 |

Articles with coloured order number are kept permanently in stock at the central warehouse in Germany.
Delivery times see page X.2

RockClassic

Housing, tops Size 6

Side locking, bottom

Housing, bottoms Size 6

Side locking, bottom

Hood

HB-16 / HBD-40 TSVU

Cable entry sideways

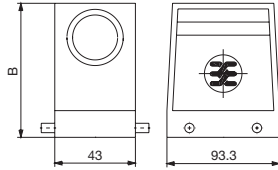

Tall model [mm] B = 76
Standard model [mm] B = 61

| Metric version | Entry on top | Entry sideways | Qty. | Tall model | Standard model |
|----------------|--------------|----------------|------|------------|----------------|
| w. sleeve | | 1xM25 | 5 | | 1788180000 |
| w/o sleeve | | 1xM25 | 5 | 1787010000 | |
| w/o sleeve | | 1xM32 | 5 | 1787000000 | |
| PG | | | | | |
| w. sleeve | | 1xPG21 | 5 | 1656520000 | 1656480000 |
| w. cable gland | | 1xPG21 | 5 | 1656510000 | 1208400000 |
| w. sleeve | | 1xPG29 | 5 | 1656540000 | |
| w. cable gland | | 1xPG29 | 5 | 1656530000 | |

Hood

HB-16 / HBD-40 TOVU

Cable entry on top

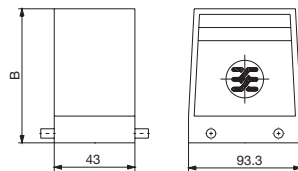

Tall model [mm] B = 76
Standard model [mm] B = 61

| Metric version | Entry on top | Entry sideways | Qty. | Tall model | Standard model |
|----------------|--------------|----------------|------|------------|----------------|
| w/o sleeve | 1xM25 | | 5 | 1787070000 | 1788210000 |
| w/o sleeve | 1xM32 | | 5 | 1787060000 | |
| PG | | | | | |
| w. sleeve | 1xPG21 | | 5 | 1656630000 | 1656590000 |
| w. cable gland | 1xPG21 | | 5 | 1656620000 | 1208300000 |
| w. sleeve | 1xPG29 | | 5 | 1656650000 | |
| w. cable gland | 1xPG29 | | 5 | 1656640000 | |

Hood

HB-16 / HBD-40 TVU

Cable entry on top and on the side

| Metric version | Entry on top | Entry sideways | Qty. | Tall model | Standard model |
|----------------|--------------|----------------|------|------------|----------------|
| | 1xM32 | 1xM25 | 5 | | 1851860000 |

Cover for hood

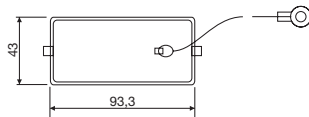

| Version | Qty. | Order No. |
|---------|------|------------|
| | 2 | 1665270000 |

Bulkhead housing

HB-16 AVU

Without cover

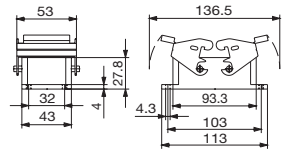

| Version | Qty. | Standard model |
|---------|------|----------------|
| | 1 | 1208600000 |

Cover for housing bottoms

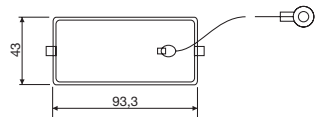

| Version | Qty. | Order No. |
|---------|------|------------|
| | 2 | 1665260000 |

RockClassic

Housing, bottoms Size 6

Side locking, bottom

Base housing

HB-16 / HBD-40 SVU

Without cover

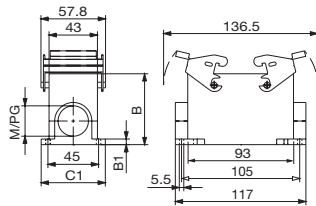

Tall model [mm]
Standard model [mm]

B = 84 / B1 = 6 / C1 = 58
B = 64 / B1 = 4.5 / C1 = 57

| Metric version | | Qty. | Tall model | Standard model |
|----------------|--------|------|------------|----------------|
| w/o sleeve | 1xM25 | 2 | | 1802250000 |
| w/o sleeve | 2xM25 | 5 | 1787120000 | 1788240000 |
| w/o sleeve | 2xM32 | 5 | 1787110000 | |
| PG | | | | |
| w. sleeve | 1xPG21 | 2 | | 1656720000 |
| w. cable gland | 1xPG21 | 2 | 1656780000 | 1208700000 |
| w. sleeve | 2xPG21 | 2 | 1656810000 | 1656730000 |
| w. cable gland | 2xPG21 | 2 | 1656800000 | 1208800000 |
| w. sleeve | 1xPG29 | 2 | 1656830000 | |
| w. cable gland | 1xPG29 | 2 | 1656820000 | |
| w. cable gland | 2xPG29 | 2 | 1656840000 | |

Housing, bottoms Size 6

Side locking, bottom

Coupling hood

HB-16 / HBD-40 KVV

Standard version

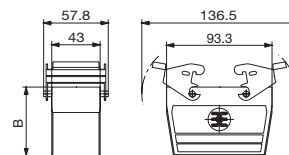

Tall model [mm]
Standard model [mm]

B = 78.8
B = 63.8

| Metric version | Entry on top | Entry sideways | Qty. | Tall model | Standard model |
|----------------|--------------|----------------|------|------------|----------------|
| w/o sleeve | 1xM25 | | 5 | 1787200000 | 1788280000 |
| w/o sleeve | 1xM32 | | 5 | 1787190000 | |
| PG | | | | | |
| w. sleeve | 1xPG21 | | 2 | 1657310000 | 1657270000 |
| w. cable gland | 1xPG21 | | 2 | 1657300000 | 1208900000 |
| w. cable gland | 1xPG29 | | 2 | 1657320000 | |
| | | | | | |
| | | | | | |
| | | | | | |
| | | | | | |
| | | | | | |

Cover for housing bottoms

| Version | Qty. | Order No. |
|---------|------|------------|
| | 2 | 1665260000 |

Cover for housing bottoms

| Version | Qty. | Order No. |
|---------|------|------------|
| | 2 | 1665260000 |

Articles with coloured order number are kept permanently in stock at the central warehouse in Germany.
Delivery times see page X.2

RockClassic

Housing, tops Size 6

End locking, bottom

Housing, bottoms Size 6

End locking, bottom

Hood

HB-16 / HBD-40 TSVL

Cable entry sideways

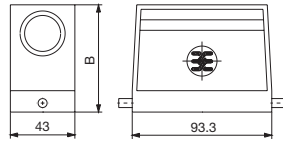

Tall model [mm] B = 76
Standard model [mm] B = 61

| Metric version | Entry on top | Entry sideways | Qty. | Tall model | Standard model |
|----------------|--------------|----------------|------|------------|----------------|
| w. sleeve | | 1xM25 | 5 | | 1788200000 |
| w/o sleeve | | 1xM32 | 5 | 1787040000 | 1804640000 |
| w/o sleeve | | 1xM40 | 10 | | 1804650000 |
| w/o sleeve | | 1xM25 | 5 | 1787050000 | |
| PG | | | | | |
| w. sleeve | | 1xPG21 | 5 | 1657890000 | 1657850000 |
| w. cable gland | | 1xPG21 | 5 | 1657880000 | 1209600000 |
| w. sleeve | | 1xPG29 | 5 | 1657910000 | |
| w. cable gland | | 1xPG29 | 5 | 1657900000 | |

Hood

HB-16 / HBD-40 TOVL

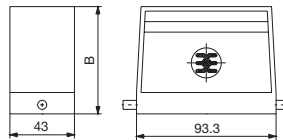
Cable entry on top

Tall model [mm] B = 76
Standard model [mm] B = 61

| Metric version | Entry on top | Entry sideways | Qty. | Tall model | Standard model |
|----------------|--------------|----------------|------|------------|----------------|
| w/o sleeve | 1xM25 | | 5 | | 1788230000 |
| w/o sleeve | 1xM32 | | 10 | 1787100000 | 1804630000 |
| PG | | | | | |
| w. sleeve | 1xPG21 | | 5 | 1658000000 | 1657960000 |
| w. cable gland | 1xPG21 | | 5 | 1657990000 | 1209500000 |
| w. sleeve | 1xPG29 | | 5 | 1658020000 | |
| w. cable gland | 1xPG29 | | 5 | 1658010000 | |

Hood

HB-16 / HBD-40 TVL

Cable entry on top and on the side

| Metric version | Entry on top | Entry sideways | Qty. | Tall model | Standard model |
|----------------|--------------|----------------|------|------------|----------------|
| | 1xM25 | 1xM16, 1xM32 | 5 | 1851880000 | |

Bulkhead housing

HB-16 AVL

Without cover

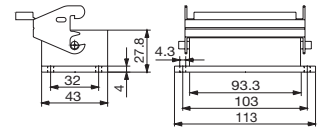

| Version | Qty. | Standard model |
|---------|------|----------------|
| | 1 | 1209700000 |

Bulkhead housing

HB-16 ADVL

with Cover

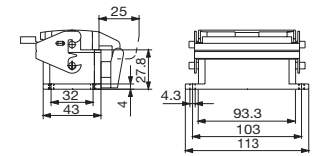

| Version | Qty. | Standard model |
|---------|------|----------------|
| | 1 | 1210100000 |

RockClassic

Housing, bottoms Size 6

End locking, bottom

Base housing

HB-16 / HBD-40 SVL

Without cover

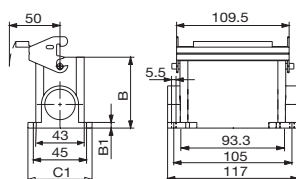

Tall model [mm]
Standard model [mm]

B = 84 / B1 = 6 / C1 = 58
B = 64 / B1 = 4.5 / C1 = 57

| Metric version | | Qty. | Tall model | Standard model |
|----------------|--------|------|------------|----------------|
| w/o sleeve | 2xM25 | 5 | 1787140000 | 1788250000 |
| w/o sleeve | 1xM32 | 5 | 1804660000 | |
| w/o sleeve | 1xM32 | 5 | 1787130000 | |
| PG | | | | |
| w. sleeve | 1xPG21 | 2 | | 1658110000 |
| w. cable gland | 1xPG21 | 2 | | 1209800000 |
| w. sleeve | 2xPG21 | 2 | | 1658120000 |
| w. cable gland | 2xPG21 | 2 | | 1209900000 |
| w. cable gland | 1xPG29 | 2 | 1658200000 | |
| | | | | |
| | | | | |
| | | | | |
| | | | | |

Base housing

HB-16 / HBD-40 SDVL

With cover

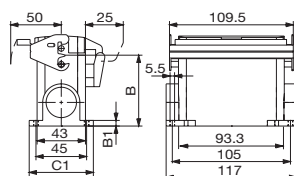

Tall model [mm]
Standard model [mm]

B = 84 / B1 = 6 / C1 = 58
B = 64 / B1 = 4.5 / C1 = 57

| Metric version | | Qty. | Tall model | Standard model |
|----------------|--------|------|------------|----------------|
| w/o sleeve | 2xM25 | 5 | 1787180000 | 1788270000 |
| w/o sleeve | 2xM32 | 5 | 1787170000 | |
| PG | | | | |
| w. sleeve | 1xPG21 | 2 | 1658400000 | 1658320000 |
| w. cable gland | 1xPG21 | 2 | 1658370000 | 1210200000 |
| w. sleeve | 2xPG21 | 2 | | 1658330000 |
| w. cable gland | 2xPG21 | 2 | 1658410000 | 1210300000 |
| w. cable gland | 2xPG29 | 2 | 1658430000 | |
| | | | | |
| | | | | |
| | | | | |
| | | | | |

Housing, bottoms Size 6

End locking, bottom

Coupling hood

HB-16 / HBD-40 KVL

Standard version

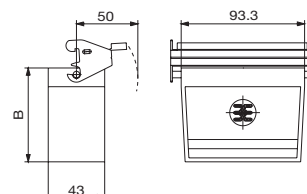

Tall model [mm]
Standard model [mm]

B = 78.5
B = 63.5

| Metric version | Entry on top | Entry sideways | Qty. | Tall model | Standard model |
|----------------|--------------|----------------|------|------------|----------------|
| w/o sleeve | 1xM25 | | 5 | 1787220000 | 1788290000 |
| w/o sleeve | 1xM32 | | 5 | 1787210000 | |
| PG | | | | | |
| w. cable gland | 1xPG21 | | 2 | | 1210000000 |
| w. sleeve | 1xPG21 | | 2 | 1658570000 | |
| w. cable gland | 1xPG29 | | 2 | 1658580000 | |
| | | | | | |
| | | | | | |
| | | | | | |
| | | | | | |

RockClassic

Top Size 6

Side locking, top

Bottom Size 6

Side locking, top

Hood

HB-16 / HBD-40 TSVO

Cable entry sideways

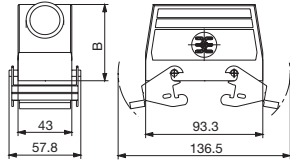
Tall model [mm] B = 76
Standard model [mm] B = 61

| Metric version | Entry on top | Entry sideways | Qty. | Tall model | Standard model |
|----------------|--------------|----------------|------|------------|----------------|
| w. sleeve | | 1xM25 | 5 | | 1788190000 |
| w/o sleeve | | 1xM25 | 5 | 1787030000 | |
| w/o sleeve | | 1xM32 | 5 | 1787020000 | |

PG

| | | | | | |
|----------------|--|--------|---|------------|------------|
| w. sleeve | | 1xPG21 | 2 | 1657420000 | 1657380000 |
| w. cable gland | | 1xPG21 | 2 | 1657410000 | 1209100000 |
| w. cable gland | | 1xPG29 | 2 | 1657430000 | |

Hood

HB-16 / HBD-40 TOVO

Cable entry on top

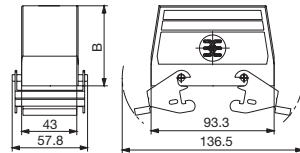
Tall model [mm] B = 76
Standard model [mm] B = 61

| Metric version | Entry on top | Entry sideways | Qty. | Tall model | Standard model |
|----------------|--------------|----------------|------|------------|----------------|
| w/o sleeve | 1xM25 | | 5 | 1787090000 | 1788220000 |
| w/o sleeve | 1xM32 | | 5 | 1787080000 | |

PG

| | | | | | |
|----------------|--------|--|---|------------|------------|
| w. sleeve | 1xPG21 | | 2 | | 1657490000 |
| w. cable gland | 1xPG21 | | 2 | 1657520000 | 1209000000 |
| w. sleeve | 1xPG29 | | 2 | 1657550000 | |
| w. cable gland | 1xPG29 | | 2 | 1657540000 | |

Bulkhead housing

HB-16 ADVO

Without cover

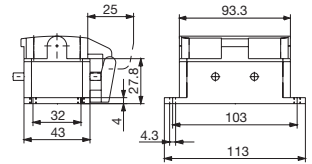

| Metric version | Qty. | Standard model |
|----------------|------|----------------|
| | 1 | 1209200000 |

Cover for hood

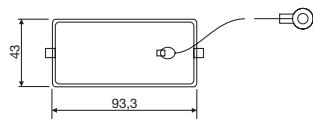

| Version | Qty. | Order No. |
|---------|------|------------|
| | 2 | 1665620000 |

RockClassic

Central lock, top

Cable entry sideways

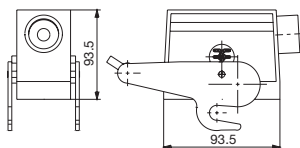

| Metric version | Entry on top | Entry sideways | Qty. | Tall model | Standard model |
|----------------|--------------|----------------|------|------------|----------------|
| | | | | | |
| | | | | | |
| | | | | | |
| PG | | | | | |
| w. cable gland | | 1xPG21 | 2 | 1658680000 | |
| w. cable gland | | 1xPG29 | | 1658700000 | |
| | | | | | |
| | | | | | |

Central lock, top

| Without cover |
|---------------|
|---------------|

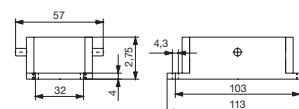

| Metric version | Qty. | Standard model |
|----------------|------|----------------|
| | 1 | 1611360000 |

| Base modeling | | HE 10, HE 15, HE 20 |
|---------------|--|---------------------|
| Without cover | | |

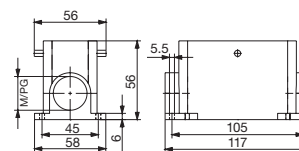

| Metric version | Entry on top | Entry sideways | Qty. | Tall model | Standard model |
|----------------|--------------|----------------|------|------------|-------------------|
| | | | | | |
| | | | | | |
| | | | | | |
| PG | | | | | |
| w. sleeve | | 1xPG21 | 2 | | 1600610000 |
| w. cable gland | | 2xPG21 | 2 | | 1658870000 |
| | | | | | |
| | | | | | |
| | | | | | |