



Chipsmall Limited consists of a professional team with an average of over 10 year of expertise in the distribution of electronic components. Based in Hongkong, we have already established firm and mutual-benefit business relationships with customers from,Europe,America and south Asia,supplying obsolete and hard-to-find components to meet their specific needs.

With the principle of “Quality Parts,Customers Priority,Honest Operation,and Considerate Service”,our business mainly focus on the distribution of electronic components. Line cards we deal with include Microchip,ALPS,ROHM,Xilinx,Pulse,ON,Everlight and Freescale. Main products comprise IC,Modules,Potentiometer,IC Socket,Relay,Connector.Our parts cover such applications as commercial,industrial, and automotives areas.

We are looking forward to setting up business relationship with you and hope to provide you with the best service and solution. Let us make a better world for our industry!



Contact us

Tel: +86-755-8981 8866 Fax: +86-755-8427 6832

Email & Skype: info@chipsmall.com Web: www.chipsmall.com

Address: A1208, Overseas Decoration Building, #122 Zhenhua RD., Futian, Shenzhen, China



THIS DRAWING IS UNPUBLISHED. RELEASED FOR PUBLICATION
 © COPYRIGHT - By - ALL RIGHTS RESERVED.

LOC	DIST	REVISIONS			
P	LTR	DESCRIPTION	DATE	DWN	APVD
	C	ECR-11-003229	15FEB2011	C.C	K.K
	D	ECR-11-023990	13FEB2012	J.C	K.K

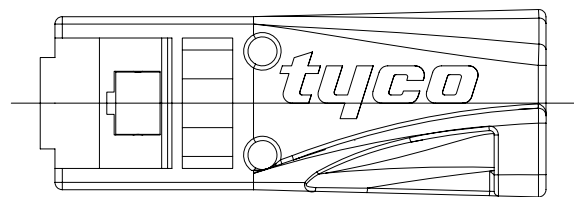
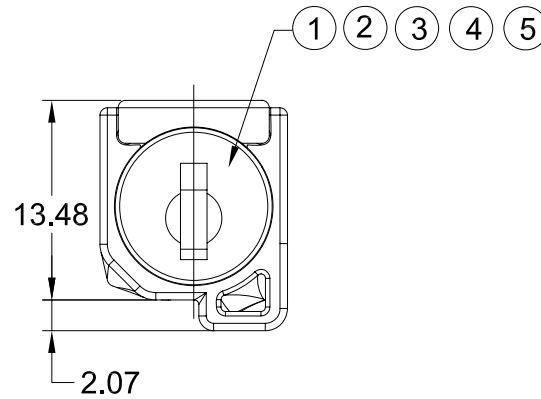
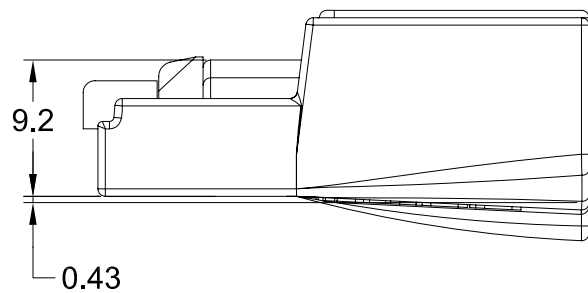
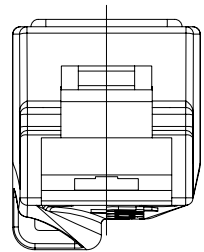
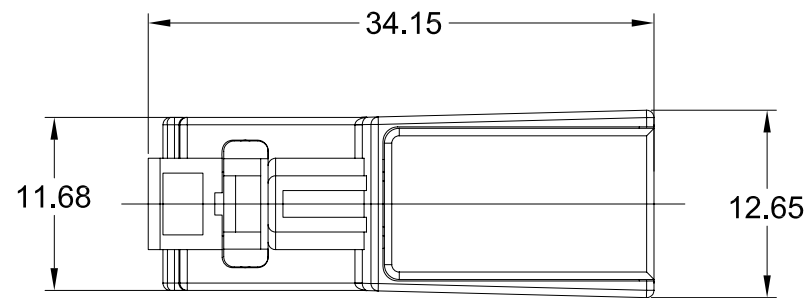

KEY PLUG WEIGHT 8.3g

NOTE
 1. Manufactured and provided by Tomei Tsushin Kogyo Co., Ltd.
 2. MATERIAL : PLUG HOUSING-PC+ABS(V-0), ROTER UNIT-ZINC ALLOY CHROME PLATE, KEY-BRASS NICHEL PLATE
 3. KEY-TYPE OF SECURITY PLUG SET: 1871456-1-RANDAM NO.T800 ~T899, 1871456-2-NO.456A, 2-1871456-2-NO.456B, 3-1871456-2-NO.456C, 4-1871456-2-NO.456D.
 4. 1871456-1, 1871456-2, 2-1871456-2, 3-1871456-2, 4-1871456-2 WITH 2 KEYS
 5. PART NUMBER FOR SPARE KEY ITSELF AVAILABLE :1871456-4-NO.456A,2-1871456-4-NO.456B, 3-1871456-4-NO.456C,4-1871456-4-NO.456D.
 6. PART NUMBER FOR SECURITY KEY PLUG ITSELF AVAILABLE : 1871456-3-NO.456A, 2-1871456-3-NO.456B, 3-1871456-3-NO.456C, 4-1871456-4-NO.456D.

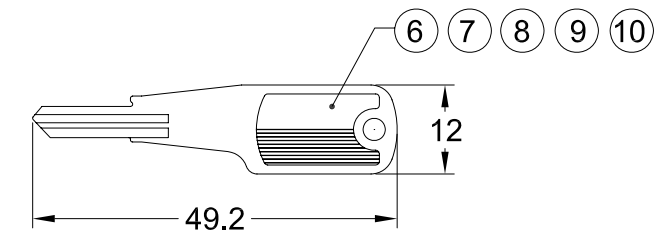

TWO KEYS WEIGHT 9.8g

1	-	2	-	-	-	-	-	-	-	-	-	-	KEY TYPE NO.456D P/N:4-1871456-4	10
-	-	-	1	-	2	-	-	-	-	-	-	-	KEY TYPE NO.456C P/N:3-1871456-4	9
-	-	-	-	-	-	1	-	2	-	-	-	-	KEY TYPE NO.456B P/N:2-1871456-4	8
-	-	-	-	-	-	-	-	1	-	2	-	-	KEY TYPE NO.456A P/N:1871456-4	7
-	-	-	-	-	-	-	-	-	-	-	2	-	KEY TYPE RANDAM NO.T800~T899	6
-	1	1	-	-	-	-	-	-	-	-	-	-	ROTER UNIT NO.456D	5
-	-	-	-	1	1	-	-	-	-	-	-	-	ROTER UNIT NO.456C	4
-	-	-	-	-	-	-	1	1	-	-	-	-	ROTER UNIT NO.456B	3
-	-	-	-	-	-	-	-	-	-	1	1	-	ROTER UNIT NO.456A	2
-	-	-	-	-	-	-	-	-	-	-	-	1	ROTER UNIT RANDAM NO.T800~T899	1
4--4	4--3	4--2	3--4	3--3	3--2	2--4	2--3	2--2	-4	-3	-2	-1	NAME	ITEM NO
Q'TY												PART LIST		

THIS DRAWING IS A CONTROLLED DOCUMENT.		DWN C. Chen 23FEB2011				
		CHK A. Yushiro 23FEB2011				
DIMENSIONS: mm 		TOLERANCES UNLESS OTHERWISE SPECIFIED: 0 PLC ± - 1 PLC ± - 2 PLC ± - 3 PLC ± - 4 PLC ± - ANGLES ± -		APVD K. Kurose 23FEB2011 NAME SECURITY KEY PLUG		
MATERIAL		FINISH		PRODUCT SPEC - APPLICATION SPEC - WEIGHT - SIZE A3 CAGE CODE 00779 DRAWING NO C=1871456 RESTRICTED TO -		
CUSTOMER DRAWING				SCALE 1:1	SHEET 1 of 2	REV D

4

3

2

1

THIS DRAWING IS UNPUBLISHED.

RELEASED FOR PUBLICATION

-. - .

© COPYRIGHT - By -

ALL RIGHTS RESERVED.

LOC	DIST	REVISIONS				
P	LTR	DESCRIPTION	DATE	DWN	APVD	
J	-	SEE SHEET 1	-	-	-	

NOTE

- 1 Manufactured and provided by Tomei Tsushin Kogyo Co., Ltd.
- 2 MATERIAL : JACK HOUSING-PC+ABS(V-0), ROTER UNIT-ZINC ALLOY CHROME PLATE, KEY-BRASS NICHEL PLATE
- 3 KEY-TYPE OF SECURITY JACK SET: 1-1871456-1-RANDAM NO.T800 ~T899, 1-1871456-2-NO.456A, 1-1871456-4-NO.456B
- 4 1-1871456-1, 1-1871456-2, 1-1871456-4 WITH 2 KEYS
- 5 PART NUMBR FOR SPARE KEY ITSELF AVAILABLE : 1871456-4-NO.456A, 2-1871456-4-NO.456B
- 6 PART NUMBER FOR SECURITY KEY JACK ITSELF AVAILABLE : 1-1871456-3-NO.456A, 1-1871456-5-NO.456B

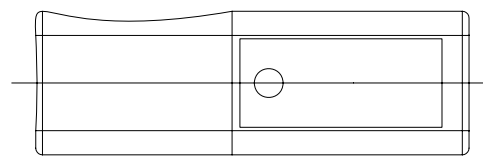
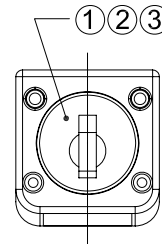
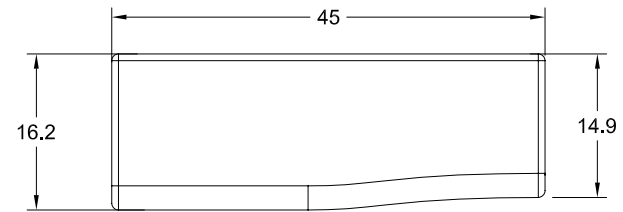
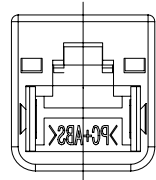

KEY JACK WEIGHT 11.9g

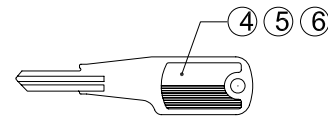

TWO KEYS WEIGHT 9.8g

-	2	-	-	-	KEY TYPE NO.456B P/N:2-1871456-4	6
-	-	-	2	-	KEY TYPE NO.456A P/N:1871456-4	5
-	-	-	-	2	KEY TYPE RANDAM NO.T800~T899	4
1	1	-	-	-	ROTER UNIT NO.456B	3
-	-	1	1	-	ROTER UNIT NO.456A	2
-	-	-	-	1	ROTER UNIT RANDAM NO.T800~T899	1
1--5	1--4	1--3	1--2	1--1	NAME	ITEM NO
Q'TY					PART LIST	

THIS DRAWING IS A CONTROLLED DOCUMENT.		DWN C. Chen 23FEB2011																
DIMENSIONS: mm		CHK A. Yushiro 23FEB2011																
TOLERANCES UNLESS OTHERWISE SPECIFIED:		APVD K. Kurose 23FEB2011	NAME SECURITY KEY JACK															
<table border="0"> <tr><td>0 PLC</td><td>± -</td></tr> <tr><td>1 PLC</td><td>± -</td></tr> <tr><td>2 PLC</td><td>± -</td></tr> <tr><td>3 PLC</td><td>± -</td></tr> <tr><td>4 PLC</td><td>± -</td></tr> <tr><td>ANGLES</td><td>± -</td></tr> </table>		0 PLC	± -	1 PLC	± -	2 PLC	± -	3 PLC	± -	4 PLC	± -	ANGLES	± -	PRODUCT SPEC -	-			
0 PLC	± -																	
1 PLC	± -																	
2 PLC	± -																	
3 PLC	± -																	
4 PLC	± -																	
ANGLES	± -																	
MATERIAL -		FINISH -	APPLICATION SPEC -	WEIGHT -	SIZE A3	CAGE CODE 00779	DRAWING NO C=1871456	RESTRICTED TO -										
CUSTOMER DRAWING				SCALE 1:1	SHEET 2 of 2	REV D												