



Chipsmall Limited consists of a professional team with an average of over 10 year of expertise in the distribution of electronic components. Based in Hongkong, we have already established firm and mutual-benefit business relationships with customers from,Europe,America and south Asia,supplying obsolete and hard-to-find components to meet their specific needs.

With the principle of “Quality Parts,Customers Priority,Honest Operation,and Considerate Service”,our business mainly focus on the distribution of electronic components. Line cards we deal with include Microchip,ALPS,ROHM,Xilinx,Pulse,ON,Everlight and Freescale. Main products comprise IC,Modules,Potentiometer,IC Socket,Relay,Connector.Our parts cover such applications as commercial,industrial, and automotives areas.

We are looking forward to setting up business relationship with you and hope to provide you with the best service and solution. Let us make a better world for our industry!



## Contact us

Tel: +86-755-8981 8866 Fax: +86-755-8427 6832

Email & Skype: info@chipsmall.com Web: www.chipsmall.com

Address: A1208, Overseas Decoration Building, #122 Zhenhua RD., Futian, Shenzhen, China



# Feed-through header - EMSTBV 2,5/ 6-GF-5,08 - 1915259

Please be informed that the data shown in this PDF Document is generated from our Online Catalog. Please find the complete data in the user's documentation. Our General Terms of Use for Downloads are valid (<http://phoenixcontact.com/download>)

PCB headers, nominal current: 12 A, rated voltage (III/2): 320 V, number of positions: 6, pitch: 5.08 mm, color: green, contact surface: Tin, mounting: Press-in technology



The figure shows a 10-position version of the product

## Why buy this product

- Processing according to EN 60352-5
- Long-term stable press-in connection ensures high holding force without thermal load
- Maximum flexibility when it comes to device design – one header for connectors with different connection technologies
- Vertical connection enables multi-row arrangement on the PCB
- Screwable flange for superior mechanical stability

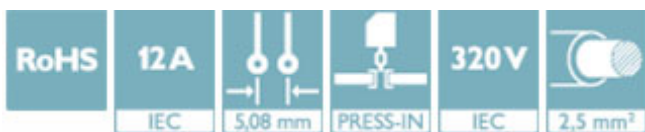

## Key Commercial Data

|              |               |
|--------------|---------------|
| Packing unit | 50 STK        |
| GTIN         |               |
| GTIN         | 4017918182076 |

## Technical data

### Dimensions

|                          |         |
|--------------------------|---------|
| Length [!]               | 8.6 mm  |
| Pitch                    | 5.08 mm |
| Dimension a              | 25.4 mm |
| Constructional height    | 12 mm   |
| Length of the solder pin | 3.9 mm  |
| Length                   | 8.6 mm  |

### General

|                             |                   |
|-----------------------------|-------------------|
| Range of articles           | EMSTBV 2,5/...-GF |
| Insulating material group   | IIIa              |
| Rated surge voltage (III/3) | 4 kV              |

# Feed-through header - EMSTBV 2,5/ 6-GF-5,08 - 1915259

## Technical data

### General

|  |        |
|--|--------|
| Rated surge voltage (III/2)            | 4 kV   |
| Rated surge voltage (II/2)             | 4 kV   |
| Rated voltage (III/3)                  | 200 V  |
| Rated voltage (III/2)                  | 320 V  |
| Rated voltage (II/2)                   | 320 V  |
| Connection in acc. with standard       | EN-VDE |
| Nominal current $I_N$                  | 12 A   |
| Maximum load current                   | 12 A   |
| Insulating material                    | PBT    |
| Flammability rating according to UL 94 | V0     |
| Color                                  | green  |
| Number of positions                    | 6      |

### Standards and Regulations

|  |        |
|--|--------|
| Connection in acc. with standard       | EN-VDE |
|  | CUL    |
| Flammability rating according to UL 94 | V0     |

### Environmental Product Compliance

|            |   |
|------------|---|
| REACH SVHC | Lead 7439-92-1  |
| China RoHS | Environmentally Friendly Use Period = 50  |
|            | For details about hazardous substances go to tab "Downloads", Category "Manufacturer's declaration" |

## Drawings

Drilling diagram

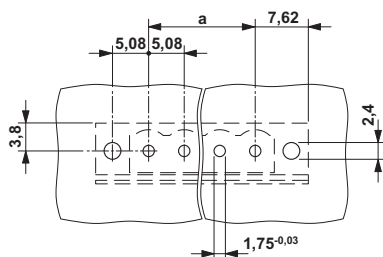

Dimensional drawing

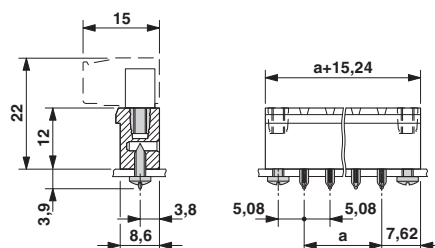

## Approvals

Approvals

Approvals

VDE Gutachten mit Fertigungsüberwachung / IECCE CB Scheme / cULus Recognized / EAC

# Feed-through header - EMSTBV 2,5/ 6-GF-5,08 - 1915259

## Approvals

Ex Approvals

### Approval details

|   |       |   |          |
|---|-------|---|----------|
| VDE Gutachten mit Fertigungsüberwachung |       | <a href="http://www2.vde.com/de/Institut/Online-Service/VDE-gepruefteProdukte/Seiten/Online-Suche.aspx">http://www2.vde.com/de/Institut/Online-Service/VDE-gepruefteProdukte/Seiten/Online-Suche.aspx</a> | 40004701 |
|   |       |   |          |
| Nominal voltage UN                      | 250 V |   |          |
| Nominal current IN                      | 12 A  |   |          |

|                    |       |   |                |
|--------------------|-------|---|----------------|
| IECEE CB Scheme    |       | <a href="http://www.iecee.org/">http://www.iecee.org/</a> | DE1-58978-B1B2 |
|                    |       |   |                |
| Nominal voltage UN | 250 V |   |                |
| Nominal current IN | 12 A  |   |                |

|                    |       |   |                 |
|--------------------|-------|---|-----------------|
| cULus Recognized   |       | <a href="http://database.ul.com/cgi-bin/XYV/template/LISEXT/1FRAME/index.htm">http://database.ul.com/cgi-bin/XYV/template/LISEXT/1FRAME/index.htm</a> | E60425-19931011 |
|                    | D     | B   |                 |
| Nominal voltage UN | 300 V | 300 V   |                 |
| Nominal current IN | 10 A  | 12 A  |                 |

|     |  |         |
|-----|--|---------|
| EAC |  | B.01742 |
|-----|--|---------|

Phoenix Contact 2018 © - all rights reserved  
<http://www.phoenixcontact.com>

PHOENIX CONTACT GmbH & Co. KG  
 Flachsmarktstr. 8  
 32825 Blomberg  
 Germany  
 Tel. +49 5235 300  
 Fax +49 5235 3 41200  
<http://www.phoenixcontact.com>