



Chipsmall Limited consists of a professional team with an average of over 10 year of expertise in the distribution of electronic components. Based in Hongkong, we have already established firm and mutual-benefit business relationships with customers from,Europe,America and south Asia,supplying obsolete and hard-to-find components to meet their specific needs.

With the principle of “Quality Parts,Customers Priority,Honest Operation,and Considerate Service”,our business mainly focus on the distribution of electronic components. Line cards we deal with include Microchip,ALPS,ROHM,Xilinx,Pulse,ON,Everlight and Freescale. Main products comprise IC,Modules,Potentiometer,IC Socket,Relay,Connector.Our parts cover such applications as commercial,industrial, and automotives areas.

We are looking forward to setting up business relationship with you and hope to provide you with the best service and solution. Let us make a better world for our industry!



Contact us

Tel: +86-755-8981 8866 Fax: +86-755-8427 6832

Email & Skype: info@chipsmall.com Web: www.chipsmall.com

Address: A1208, Overseas Decoration Building, #122 Zhenhua RD., Futian, Shenzhen, China



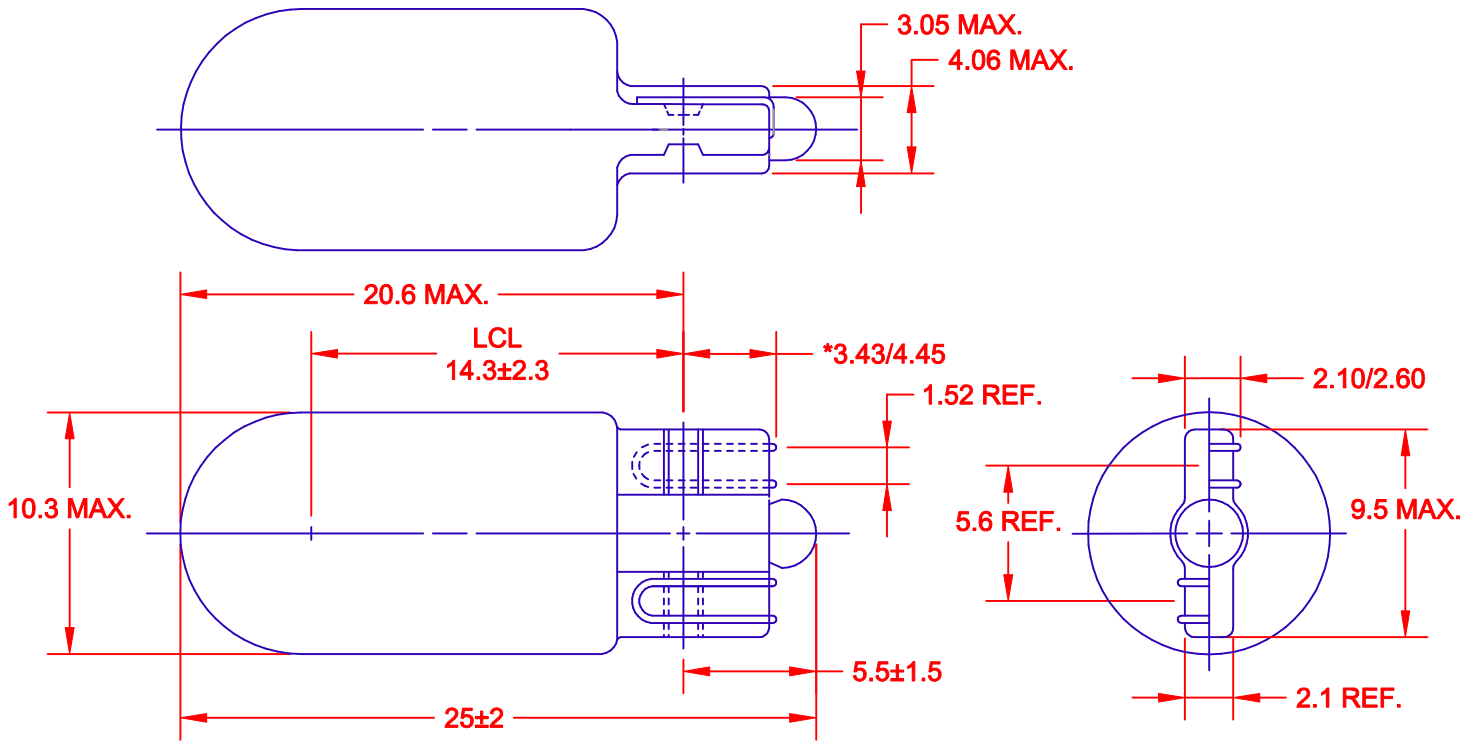

*TO BE MEASURED ON LONGEST SIDE ONLY WITH THE WIRE IN INTIMATE CONTACT WITH THE BOTTOM OF THE GLASS WEDGE.

JKL LAMP NUMBER	VOLTS RATED	AMPS ±10%	*MSCP ±25%	*LUMENS ±25%	AVERAGE LIFE HRS.	FILAMENT TYPE
127	2.47	.275	.48	6.03	30	C-2R
159	6.3	.150	.33	4.15	20,000	C-2R
259	6.3	.250	.65	8.17	10,000	C-2R
555	6.3	.250	.90	11.31	3,000	C-2R
658	14.0	.080	.31	3.90	15,000	C-2F
161	14.0	.190	1.00	12.57	4,000	C-2F
158	14.0	.240	2.00	25.14	500	C-2V
194	14.0	.270	2.00	25.14	2,500	C-2F
193	14.0	.330	2.00	25.14	7,500	C-2F
168	14.0	.350	3.00	37.71	1,500	C-2F
585	28.0	.040	.30	3.77	7,000	C-2F
656	28.0	.060	.62	7.79	2,500	C-2F
657	28.0	.080	.62	7.79	15,000	C-2F
400	28.0	.100	1.60	20.11	1,000	C-2F
464	28.0	.170	3.00	37.71	1,500	C-2F
655	28.0	.200	3.00	37.71	7,000	C-2F

 THIRD ANGLE PROJECTION		METRIC DIMENSIONS ARE IN MILLIMETERS TOLERANCE UNLESS OTHERWISE SPECIFIED 1 PL +/- 0.2 2 PL +/- 0.20 ANGLE +/- 0		COMPONENTS CORPORATION					
		TITLE T-3 1/4 STANDARD GLASS WEDGE BASE							
A DELETE REPEATED DIM. RELEASED & CANCEL GW-STD-T3 1/4, 447 & 509		3/26/01 5/17/00	DRAWN BY L. WENGSTROM	APP'VD BY DATE J.K. 3/26/01	SIZE A	FSCM NO. 55335	DRAWING NO. GLASS WEDGE BASE T-3 1/4		
REV. NO. DESCRIPTION/ECO NUMBER		APP'VD DATE	- CAD DRAWING - MANUAL REVISIONS NOT PERMITTED		SCALE NONE	RELEASED DATE 5/17/00	REVISION DATE 3/25/01	REV. NO. A	SHEET 1 OF 1