



Chipsmall Limited consists of a professional team with an average of over 10 year of expertise in the distribution of electronic components. Based in Hongkong, we have already established firm and mutual-benefit business relationships with customers from,Europe,America and south Asia,supplying obsolete and hard-to-find components to meet their specific needs.

With the principle of “Quality Parts,Customers Priority,Honest Operation,and Considerate Service”,our business mainly focus on the distribution of electronic components. Line cards we deal with include Microchip,ALPS,ROHM,Xilinx,Pulse,ON,Everlight and Freescale. Main products comprise IC,Modules,Potentiometer,IC Socket,Relay,Connector.Our parts cover such applications as commercial,industrial, and automotives areas.

We are looking forward to setting up business relationship with you and hope to provide you with the best service and solution. Let us make a better world for our industry!



Contact us

Tel: +86-755-8981 8866 Fax: +86-755-8427 6832

Email & Skype: info@chipsmall.com Web: www.chipsmall.com

Address: A1208, Overseas Decoration Building, #122 Zhenhua RD., Futian, Shenzhen, China



4

3

2

1

THIS DRAWING IS UNPUBLISHED. RELEASED FOR PUBLICATION
© COPYRIGHT BY TYCO ELECTRONICS CORPORATION. ALL INTERNATIONAL RIGHTS RESERVED.

LOC	DIST	REVISIONS					
G	86	P	LTR	DESCRIPTION	DATE	DWN	APVD
		B		REVISED PER ECR-09-001663	22JAN09	JR	TM

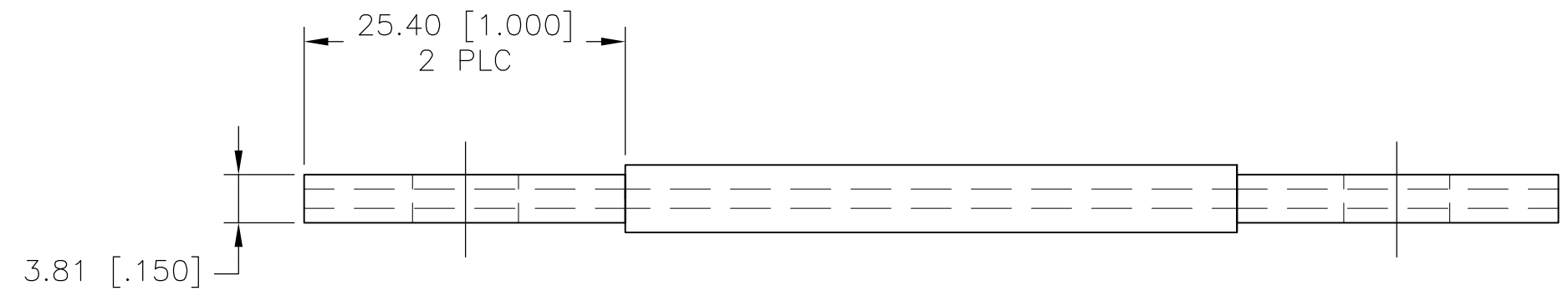
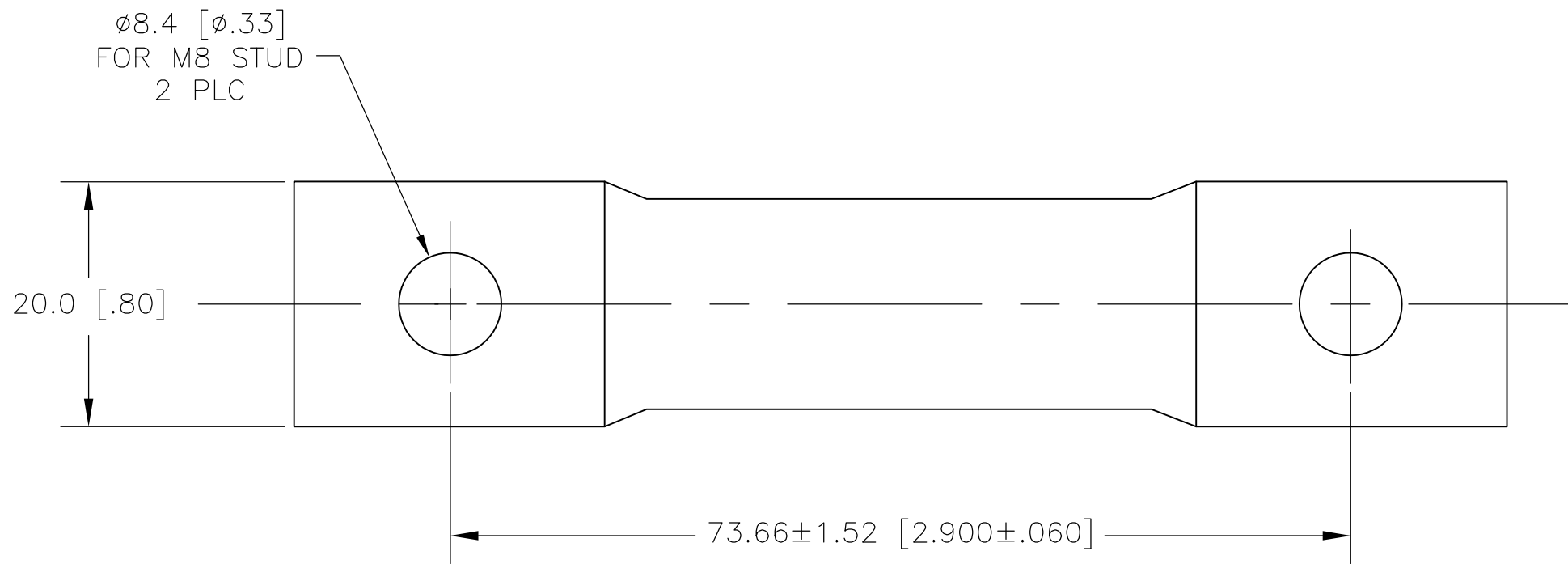

- 1 MATERIAL: ELECTROLYTIC TINNED COPPER BRAID OR EQUIVALENT
HIGH RESISTANCE 105°C DIELECTRIC MATERIAL
- 2 ALL SHARP EDGES BROKEN AND BURRS REMOVED
- 3 ITEM FREE OF DIRT, OIL, GREASE, AND ALL CONTAMINANTS.

1958289-1
PART NO

THIS DRAWING IS A CONTROLLED DOCUMENT.		DWN jr_ruth 19DEC08	Tyco Electronics Corporation Harrisburg, PA 17105-3608	
DIMENSIONS: mm [INCHES]		CHK TOM MICHIELUTTI 19DEC08	NAME	
TOLERANCES UNLESS OTHERWISE SPECIFIED: 0 PLC ± - 1 PLC ± 2.5 [.1] 2 PLC ± 0.25 [.010] 3 PLC ± - 4 PLC ± - ANGLES ± 5°		APVD TOM MICHIELUTTI 19DEC08	INSULATED INTERCONNECT FOR BATTERY CELL	
MATERIAL 1		PRODUCT SPEC -	APPLICATION SPEC -	RESTRICTED TO -
FINISH 1		WEIGHT -	SIZE A3	CAGE CODE 00779
		DRAWING NO G-1958289		SCALE 2:1
		CUSTOMER DRAWING		SHEET 1 OF 1
				REV B