



Chipsmall Limited consists of a professional team with an average of over 10 year of expertise in the distribution of electronic components. Based in Hongkong, we have already established firm and mutual-benefit business relationships with customers from,Europe,America and south Asia,supplying obsolete and hard-to-find components to meet their specific needs.

With the principle of “Quality Parts,Customers Priority,Honest Operation,and Considerate Service”,our business mainly focus on the distribution of electronic components. Line cards we deal with include Microchip,ALPS,ROHM,Xilinx,Pulse,ON,Everlight and Freescale. Main products comprise IC,Modules,Potentiometer,IC Socket,Relay,Connector.Our parts cover such applications as commercial,industrial, and automotives areas.

We are looking forward to setting up business relationship with you and hope to provide you with the best service and solution. Let us make a better world for our industry!



## Contact us

Tel: +86-755-8981 8866 Fax: +86-755-8427 6832

Email & Skype: info@chipsmall.com Web: www.chipsmall.com

Address: A1208, Overseas Decoration Building, #122 Zhenhua RD., Futian, Shenzhen, China



THIS DRAWING IS UNPUBLISHED. RELEASED FOR PUBLICATION 20  
 © COPYRIGHT 20 BY - ALL RIGHTS RESERVED.

REVISIONS					
P	LTR	DESCRIPTION	DATE	DWN	APVD
A1		REVISED PER ECO-10-001873	19FEB2010	DH	JE
A2		REVISED PER ECO-15-004981	31MAR2015	RG	MC

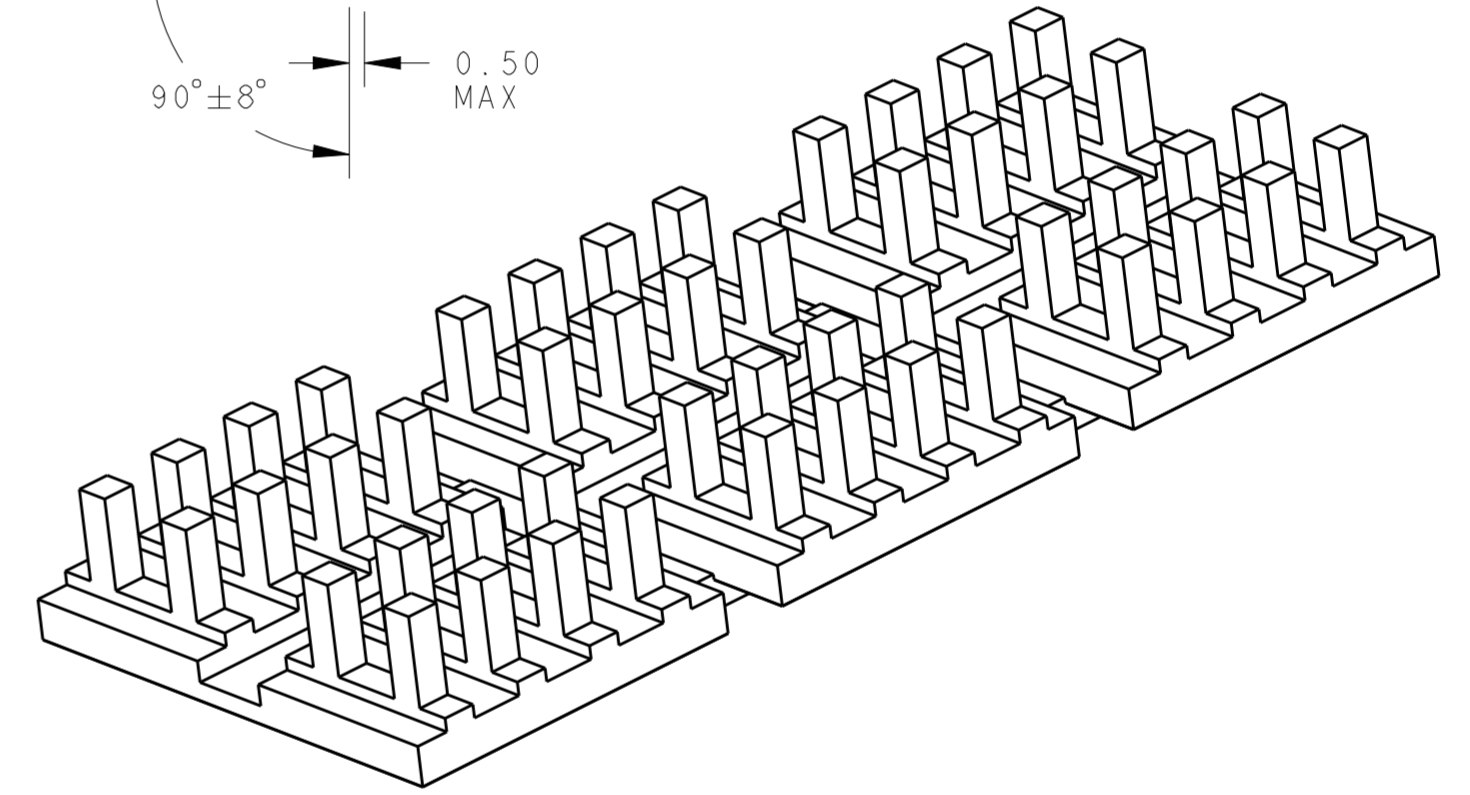
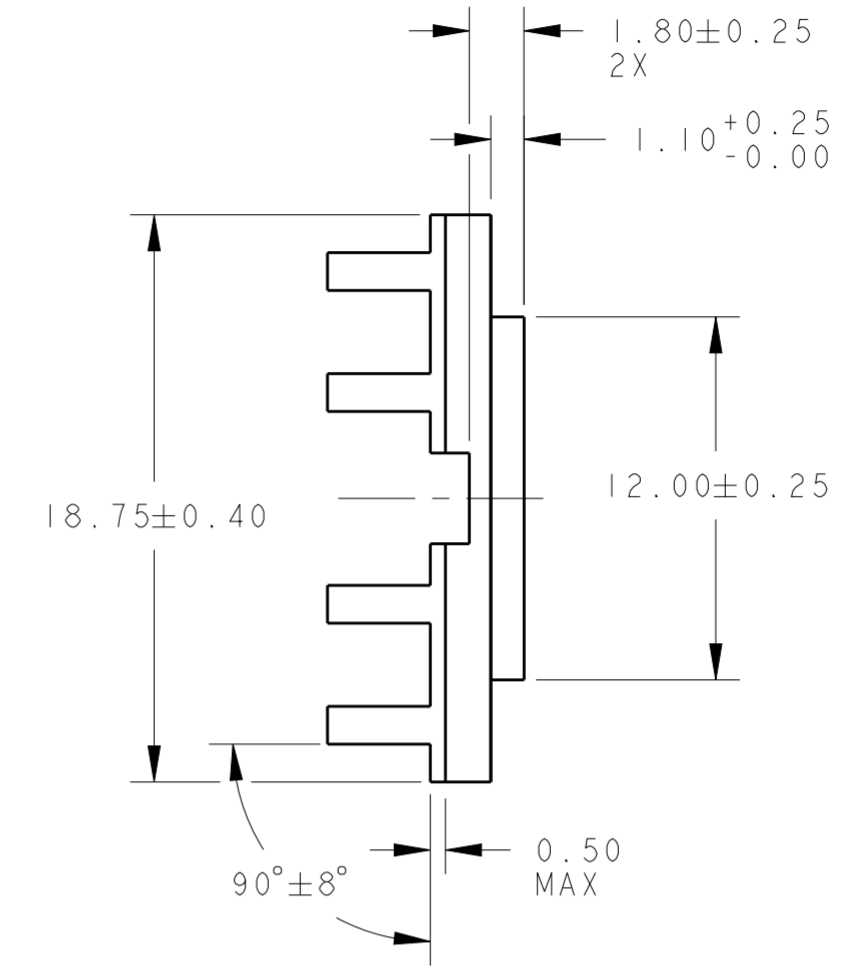
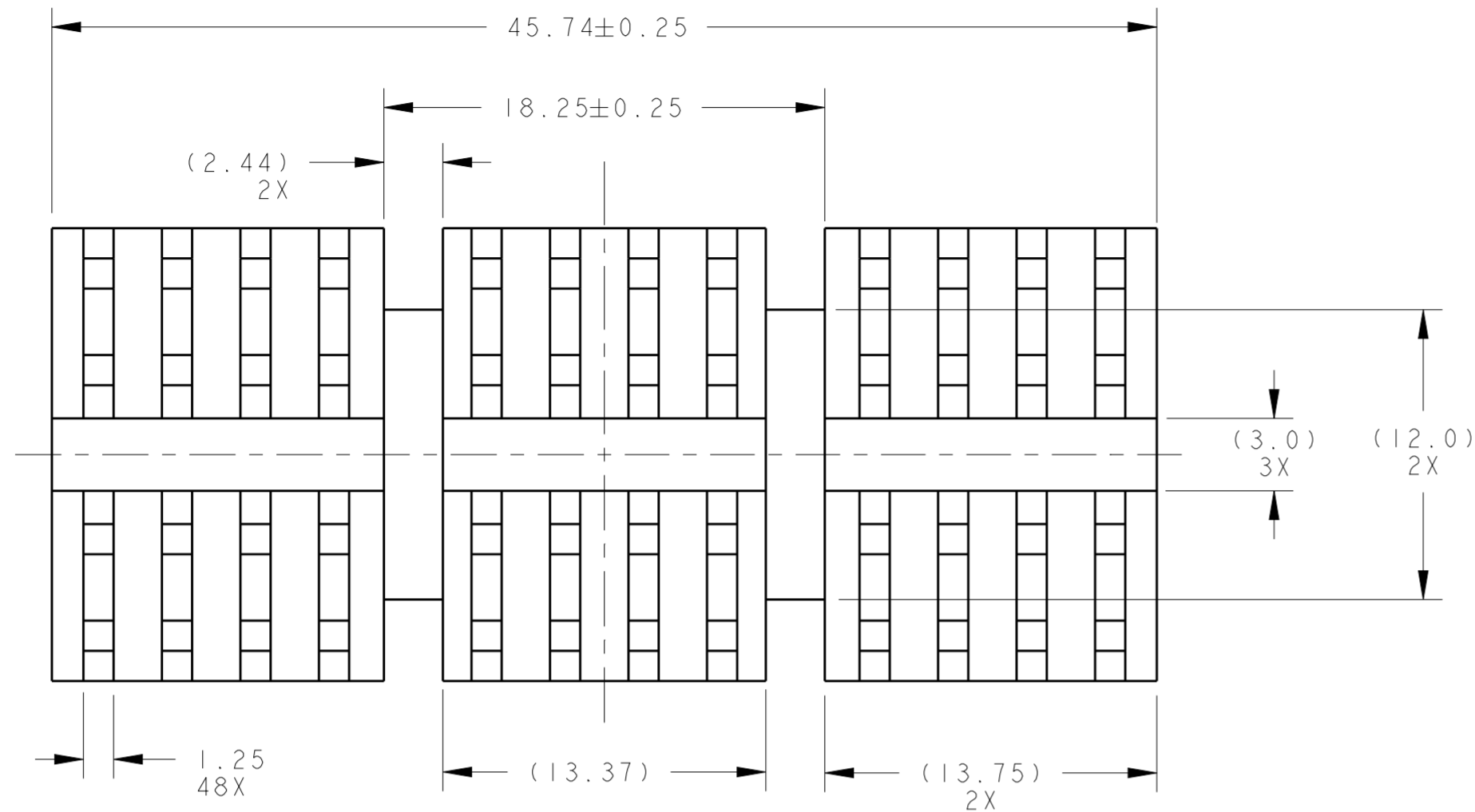

NOTES:

- UNLESS OTHERWISE SPECIFIED
- 1. INTERPRET DRAWING PER ASME Y14.5M - 1994.
- 2. 0,2mm MAX BURR.
- 3. VARIATION IN PLATING COLOR IS NORMAL AND ALLOWED.
- 4. RoHS COMPLIANT AND CERTIFIED.

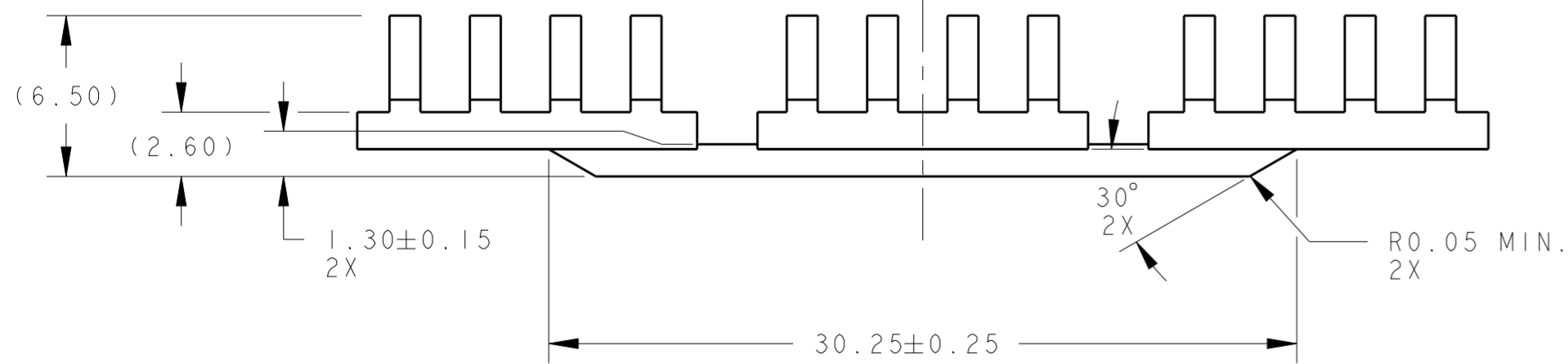

FINISH	MATERIAL	PART NUMBER
BLACK ANODIZED	ALUMINUM	1963842-5
NICKEL PLATED	ALUMINUM	1963842-3
NONE	ALUMINUM	1963842-1

THIS DRAWING IS A CONTROLLED DOCUMENT.		DWN E. TAO 6-17-08	TE Connectivity	
		CHK B. PETROCELLI 6-23-08		
DIMENSIONS: mm	TOLERANCES UNLESS OTHERWISE SPECIFIED:	APVD -	NAME QSFP SINGLE SAN EXTRUSION HEATSINK 6.5mm TALL	
0 PLC ±	1 PLC ±0.2	PRODUCT SPEC -	SIZE A2	CAGE CODE 0779
2 PLC ±0.10	3 PLC ±0.08	APPLICATION SPEC -	DRAWING NO C-1963842	RESTRICTED TO -
4 PLC ±	ANGLES ±5°	WEIGHT -	SCALE 4.000	SHEET 1 OF 1
MATERIAL SEE TABLE	FINISH SEE TABLE	CUSTOMER DRAWING	REV A2	