



Chipsmall Limited consists of a professional team with an average of over 10 year of expertise in the distribution of electronic components. Based in Hongkong, we have already established firm and mutual-benefit business relationships with customers from,Europe,America and south Asia,supplying obsolete and hard-to-find components to meet their specific needs.

With the principle of “Quality Parts,Customers Priority,Honest Operation,and Considerate Service”,our business mainly focus on the distribution of electronic components. Line cards we deal with include Microchip,ALPS,ROHM,Xilinx,Pulse,ON,Everlight and Freescale. Main products comprise IC,Modules,Potentiometer,IC Socket,Relay,Connector.Our parts cover such applications as commercial,industrial, and automotives areas.

We are looking forward to setting up business relationship with you and hope to provide you with the best service and solution. Let us make a better world for our industry!



Contact us

Tel: +86-755-8981 8866 Fax: +86-755-8427 6832

Email & Skype: info@chipsmall.com Web: www.chipsmall.com

Address: A1208, Overseas Decoration Building, #122 Zhenhua RD., Futian, Shenzhen, China



**Industrial Ethernet
IE-BS-V01M-LCD-MM-C**

Weidmüller Interface GmbH & Co. KG
Klingenbergstraße 16
D-32758 Detmold
Germany
Fon: +49 5231 14-0
Fax: +49 5231 14-292083
www.weidmueller.com



Bayonet plug-in connector sets according to IEC
61076-3-106 ver.1 (EtherNet/IP), RJ45 metal insert incl.
LC insert

General ordering data

Type	IE-BS-V01M-LCD-MM-C
Order No.	1964440000
Version	Flange FO, IP 67, Version 1, LC Duplex coupling, Multimode
GTIN (EAN)	403224864905 1
Qty.	10 pc(s).

Data sheet

**Industrial Ethernet
IE-BS-V01M-LCD-MM-C**

Weidmüller Interface GmbH & Co. KG
 Klingenbergstraße 16
 D-32758 Detmold
 Germany
 Fon: +49 5231 14-0
 Fax: +49 5231 14-292083
 www.weidmueller.com

Technical data

Dimensions and weights

Net weight 60.1 g

Temperatures

Operating temperature, max.	70 °C	Operating temperature	-40 °C...70 °C
Storage temperature		Installation temperature	

Downloads

GOST Approval POCC
 DE.ME25.B01411.pdf

General data

Colour	Miscellaneous	Connection 1	LC Duplex
Connection 2	LC Duplex	Description of article	Version 1, LC Duplex coupling
Fibre type	Multimode	Housing main material	Zinc diecast
Insertion loss	≤ 0.4 dB	Plugging cycles	500
Protection degree	IP 67	Return loss (attenuation)	≥ 30 dB
Seal material	NBR		

Standards

Connector standard IEC 61076-3-106 Var. 1,
 IEC 61754-20

Classifications

ETIM 3.0	EC001121	ETIM 4.0	EC000437
ETIM 5.0	EC000437	ETIM 6.0	EC000437
UNSPSC	30-21-18-17	eClass 5.1	27-26-12-03
eClass 6.2	27-26-12-03	eClass 7.1	27-25-05-04
eClass 8.1	19-17-01-25	eClass 9.0	19-17-01-25

Approvals

Approvals



ROHS Conform

**Industrial Ethernet
IE-BS-V01M-LCD-MM-C**

Weidmüller Interface GmbH & Co. KG
Klingenbergstraße 16
D-32758 Detmold
Germany
Fon: +49 5231 14-0
Fax: +49 5231 14-292083
www.weidmueller.com

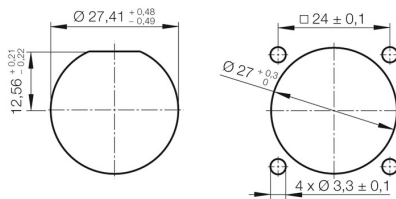
Drawings**Installation cut-out**

Mounting cut-out: 1. With central screw connection / 2. For mounting with four M3 screws