



Chipsmall Limited consists of a professional team with an average of over 10 year of expertise in the distribution of electronic components. Based in Hongkong, we have already established firm and mutual-benefit business relationships with customers from,Europe,America and south Asia,supplying obsolete and hard-to-find components to meet their specific needs.

With the principle of “Quality Parts,Customers Priority,Honest Operation,and Considerate Service”,our business mainly focus on the distribution of electronic components. Line cards we deal with include Microchip,ALPS,ROHM,Xilinx,Pulse,ON,Everlight and Freescale. Main products comprise IC,Modules,Potentiometer,IC Socket,Relay,Connector.Our parts cover such applications as commercial,industrial, and automotives areas.

We are looking forward to setting up business relationship with you and hope to provide you with the best service and solution. Let us make a better world for our industry!



Contact us

Tel: +86-755-8981 8866 Fax: +86-755-8427 6832

Email & Skype: info@chipsmall.com Web: www.chipsmall.com

Address: A1208, Overseas Decoration Building, #122 Zhenhua RD., Futian, Shenzhen, China



P	LTR	DESCRIPTION	DATE	DWN	APVD
	C	REVISED PER ECO-16-013278	09SEP2016	RS	GJ

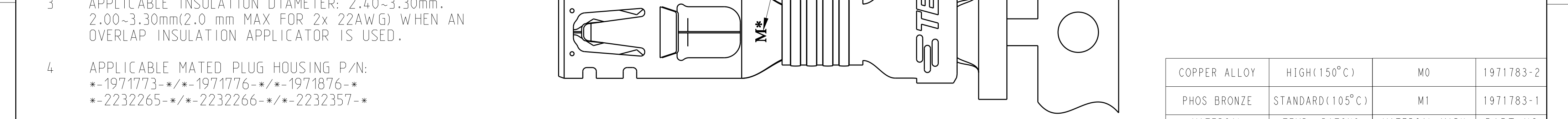
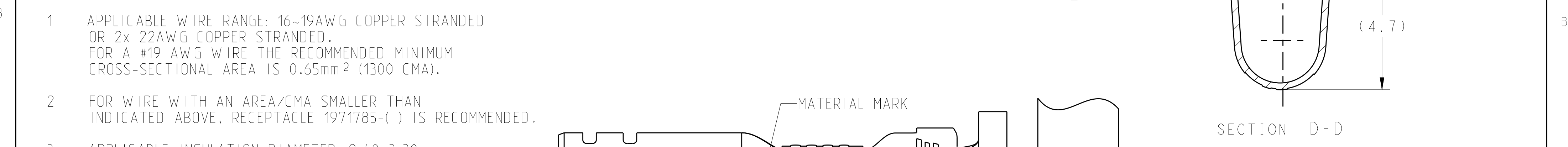
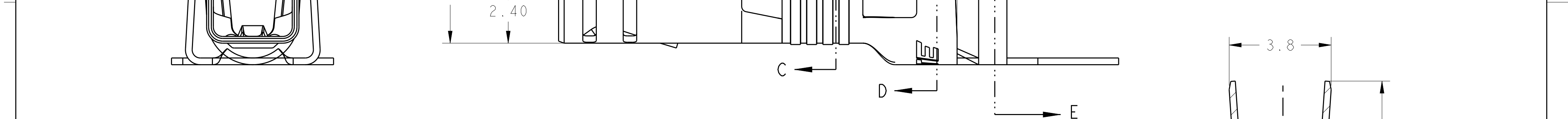
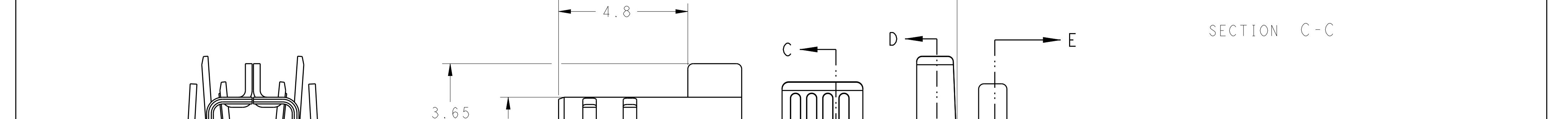
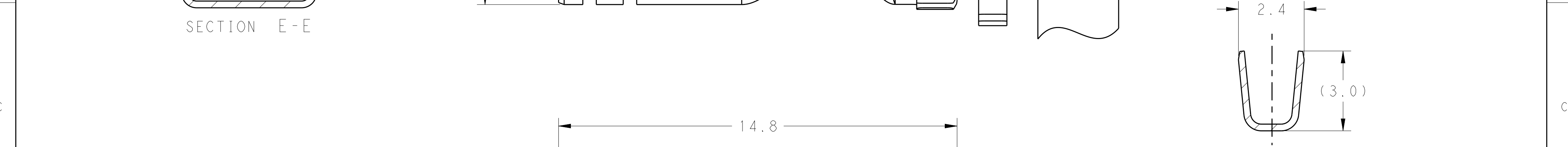
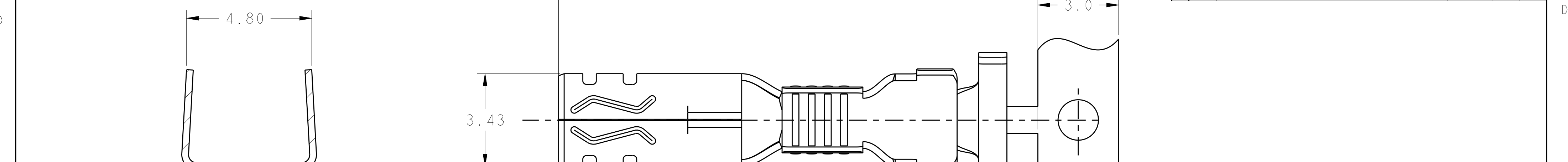

1

APPLICABLE WIRE RANGE: 16~19AWG COPPER STRANDED OR 2x 22AWG COPPER STRANDED.
FOR A #19 AWG WIRE THE RECOMMENDED MINIMUM CROSS-SECTIONAL AREA IS 0.65mm² (1300 CMA).

2

FOR WIRE WITH AN AREA/CMA SMALLER THAN INDICATED ABOVE, RECEPTACLE 1971785-() IS RECOMMENDED.

3

APPLICABLE INSULATION DIAMETER: 2.40~3.30mm.
2.00~3.30mm(2.0 mm MAX FOR 2x 22AWG) WHEN AN OVERLAP INSULATION APPLICATOR IS USED.

4

APPLICABLE MATED PLUG HOUSING P/N:
-1971773-/*-1971776-*/*-1971876-*/
-2232265-/*-2232266-*/*-2232357-*

5

THIS PRODUCT HAS NOT COMPLETED VALIDATION TESTING.

THIS DRAWING IS A CONTROLLED DOCUMENT.

DIMENSIONS:
mm

MATERIAL
SEE TABLE

TOLERANCES UNLESS OTHERWISE SPECIFIED:

0 PLC	±	0.5
1 PLC	±	0.30
2 PLC	±	0.30
3 PLC	±	0.30
4 PLC	±	0.30
ANGLES	±	
FINISH		

PRE-TIN

DWN
TOMMY WU
CHK
HAPYE WU
APVD
YUJHONG MAO

PRODUCT SPEC
108-106118
APPLICATION SPEC
114-106118
WEIGHT
-

Customer Drawing

11JUL2012
11JUL2012
11JUL2012

NAME
RECEPTACLE CONTACT
POWER TRIPLE LOCK

SIZE	CAGE CODE	DRAWING NO	RESTRICTED TO
A2	00779	1971783	-

SCALE 6:1 SHEET 1 OF 1 REV C

COPPER ALLOY

HIGH(150°C)

M0

1971783-2

PHOS BRONZE

STANDARD(105°C)

M1

1971783-1

MATERIAL

TEMP. RATING

MATERIAL MARK

PART NO

STE

TE Connectivity