



Chipsmall Limited consists of a professional team with an average of over 10 year of expertise in the distribution of electronic components. Based in Hongkong, we have already established firm and mutual-benefit business relationships with customers from,Europe,America and south Asia,supplying obsolete and hard-to-find components to meet their specific needs.

With the principle of “Quality Parts,Customers Priority,Honest Operation,and Considerate Service”,our business mainly focus on the distribution of electronic components. Line cards we deal with include Microchip,ALPS,ROHM,Xilinx,Pulse,ON,Everlight and Freescale. Main products comprise IC,Modules,Potentiometer,IC Socket,Relay,Connector.Our parts cover such applications as commercial,industrial, and automotives areas.

We are looking forward to setting up business relationship with you and hope to provide you with the best service and solution. Let us make a better world for our industry!



## Contact us

Tel: +86-755-8981 8866 Fax: +86-755-8427 6832

Email & Skype: info@chipsmall.com Web: www.chipsmall.com

Address: A1208, Overseas Decoration Building, #122 Zhenhua RD., Futian, Shenzhen, China



# 1SMA10CAT3G Series, SZ1SMA10CAT3G Series



Expertise Applied | Answers Delivered

## 400 Watt Peak Power Zener Transient Voltage Suppressors

Littelfuse.com

### Bidirectional

The SMA series is designed to protect voltage sensitive components from high voltage, high energy transients. They have excellent clamping capability, high surge capability, low zener impedance and fast response time. The SMA series is supplied in the Littelfuse exclusive, cost-effective, highly reliable package and is ideally suited for use in communication systems, automotive, numerical controls, process controls, medical equipment, business machines, power supplies and many other industrial/consumer applications.

### Features

- Working Peak Reverse Voltage Range – 10 V to 78 V
- Standard Zener Breakdown Voltage Range – 11.7 V to 91.3 V
- Peak Power – 400 Watts @ 1 ms
- ESD Rating of Class 3 (> 16 kV) per Human Body Model
- Response Time is Typically < 1 ns
- Flat Handling Surface for Accurate Placement
- Package Design for Top Slide or Bottom Circuit Board Mounting
- Low Profile Package
- SZ Prefix for Automotive and Other Applications Requiring Unique Site and Control Change Requirements; AEC-Q101 Qualified and PPAP Capable
- These are Pb-Free Devices

### Mechanical Characteristics:

**CASE:** Void-free, transfer-molded plastic

**FINISH:** All external surfaces are corrosion resistant and leads are readily solderable

**MAXIMUM CASE TEMPERATURE FOR SOLDERING PURPOSES:**  
260°C for 10 Seconds

**POLARITY:** Cathode polarity notch does not indicate polarity

**MOUNTING POSITION:** Any

### PLASTIC SURFACE MOUNT ZENER OVERVOLTAGE TRANSIENT SUPPRESSORS 10-78 V V<sub>R</sub> 400 W PEAK POWER



SMA  
CASE 403D  
PLASTIC



### MARKING DIAGRAM



- xxC = Device Code (Refer to page 3)
- A = Assembly Location
- Y = Year
- WW = Work Week
- = Pb-Free Package

### ORDERING INFORMATION

| Device**      | Package          | Shipping               |
|---------------|------------------|------------------------|
| 1SMAxxCAT3G   | SMA<br>(Pb-Free) | 5,000 /<br>Tape & Reel |
| SZ1SMAxxCAT3G | SMA<br>(Pb-Free) | 5,000 /<br>Tape & Reel |

\*\*The "T3" suffix refers to a 13 inch reel.

### DEVICE MARKING INFORMATION

See specific marking information in the device marking column of the Electrical Characteristics table on page 3 of this data sheet.

# 1SMA10CAT3G Series, SZ1SMA10CAT3G Series

## MAXIMUM RATINGS

| Rating  | Symbol          | Value       | Unit                       |
|---|-----------------|-------------|----------------------------|
| Peak Power Dissipation (Note 1) @ $T_L = 25^\circ\text{C}$ , Pulse Width = 1 ms                                       | $P_{PK}$        | 400         | W                          |
| DC Power Dissipation @ $T_L = 75^\circ\text{C}$ Measured Zero Lead Length (Note 2)<br>Derate Above $75^\circ\text{C}$ | $P_D$           | 1.5         | W                          |
| Thermal Resistance from Junction-to-Lead  | $R_{\theta JL}$ | 20          | $\text{mW}/^\circ\text{C}$ |
| Thermal Resistance from Junction-to-Lead  | $R_{\theta JL}$ | 50          | $^\circ\text{C}/\text{W}$  |
| DC Power Dissipation (Note 3) @ $T_A = 25^\circ\text{C}$<br>Derate Above $25^\circ\text{C}$                           | $P_D$           | 0.5         | W                          |
| Thermal Resistance from Junction-to-Ambient   | $R_{\theta JA}$ | 4.0         | $\text{mW}/^\circ\text{C}$ |
| Thermal Resistance from Junction-to-Ambient   | $R_{\theta JA}$ | 250         | $^\circ\text{C}/\text{W}$  |
| Operating and Storage Temperature Range   | $T_J, T_{stg}$  | -65 to +150 | $^\circ\text{C}$           |

Stresses exceeding those listed in the Maximum Ratings table may damage the device. If any of these limits are exceeded, device functionality should not be assumed, damage may occur and reliability may be affected.

- 10 X 1000  $\mu\text{s}$ , non-repetitive.
- 1 in square copper pad, FR-4 board.
- FR-4 board, using Littelfuse minimum recommended footprint, as shown in 403B case outline dimensions spec.

## ELECTRICAL CHARACTERISTICS

( $T_A = 25^\circ\text{C}$  unless otherwise noted)

| Symbol    | Parameter                                   |
|-----------|---|
| $I_{PP}$  | Maximum Reverse Peak Pulse Current          |
| $V_C$     | Clamping Voltage @ $I_{PP}$                 |
| $V_{RWM}$ | Working Peak Reverse Voltage                |
| $I_R$     | Maximum Reverse Leakage Current @ $V_{RWM}$ |
| $V_{BR}$  | Breakdown Voltage @ $I_T$                   |
| $I_T$     | Test Current                                |

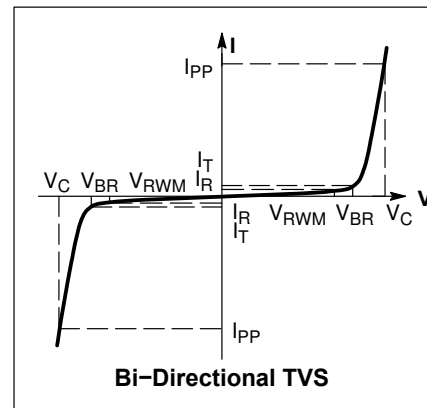

# 1SMA10CAT3G Series, SZ1SMA10CAT3G Series

## ELECTRICAL CHARACTERISTICS

| Device*     | Device Marking | V <sub>RWM</sub><br>(Note 4)<br>Volts | I <sub>R</sub> @ V <sub>RWM</sub><br>μA | Breakdown Voltage                |       |       |                  | V <sub>C</sub> @ I <sub>PP</sub><br>(Note 6) |                 | C Typ.<br>(Note 7)<br>pF |
|-------------|----------------|---------------------------------------|---|----------------------------------|-------|-------|------------------|--|-----------------|--------------------------|
|             |                |                                       |   | V <sub>BR</sub> (Volts) (Note 5) |       |       | @ I <sub>T</sub> | V <sub>C</sub>                               | I <sub>PP</sub> |                          |
|             |                |                                       |   | Min                              | Nom   | Max   | mA               | Volts  | Amps            |                          |
| 1SMA10CAT3G | QXC            | 10                                    | 2.5                                     | 11.1                             | 11.69 | 12.27 | 1.0              | 17.0   | 23.5            | 580                      |
| 1SMA12CAT3G | REC            | 12                                    | 2.5                                     | 13.3                             | 14.00 | 14.70 | 1.0              | 19.9   | 20.1            | 490                      |
| 1SMA13CAT3G | RGC            | 13                                    | 2.5                                     | 14.4                             | 15.16 | 15.92 | 1.0              | 21.5   | 18.6            | 455                      |
| 1SMA15CAT3G | RMC            | 15                                    | 2.5                                     | 16.7                             | 17.58 | 18.46 | 1.0              | 24.4   | 16.4            | 400                      |
| 1SMA16CAT3G | RPC            | 16                                    | 2.5                                     | 17.8                             | 18.74 | 19.67 | 1.0              | 26.0   | 15.4            | 375                      |
| 1SMA18CAT3G | RTC            | 18                                    | 2.5                                     | 20                               | 21.06 | 22.11 | 1.0              | 29.2   | 13.7            | 335                      |
| 1SMA20CAT3G | RVC            | 20                                    | 2.5                                     | 22.2                             | 23.37 | 24.54 | 1.0              | 32.4   | 12.3            | 305                      |
| 1SMA24CAT3G | RZC            | 24                                    | 2.5                                     | 26.7                             | 28.11 | 29.51 | 1.0              | 38.9   | 10.3            | 260                      |
| 1SMA26CAT3G | SEC            | 26                                    | 2.5                                     | 28.9                             | 30.42 | 31.94 | 1.0              | 42.1   | 9.5             | 240                      |
| 1SMA28CAT3G | SGC            | 28                                    | 2.5                                     | 31.1                             | 32.74 | 34.37 | 1.0              | 45.4   | 8.8             | 225                      |
| 1SMA30CAT3G | SKC            | 30                                    | 2.5                                     | 33.3                             | 35.06 | 36.81 | 1.0              | 48.4   | 8.3             | 210                      |
| 1SMA33CAT3G | SMC            | 33                                    | 2.5                                     | 36.7                             | 38.63 | 40.56 | 1.0              | 53.3   | 7.5             | 190                      |
| 1SMA36CAT3G | SPC            | 36                                    | 2.5                                     | 40                               | 42.11 | 44.21 | 1.0              | 58.1   | 6.9             | 175                      |
| 1SMA40CAT3G | SRC            | 40                                    | 2.5                                     | 44.4                             | 46.74 | 49.07 | 1.0              | 64.5   | 6.2             | 160                      |
| 1SMA48CAT3G | SXC            | 48                                    | 2.5                                     | 53.3                             | 56.11 | 58.91 | 1.0              | 77.4   | 5.2             | 135                      |
| 1SMA58CAT3G | TGC            | 58                                    | 2.5                                     | 64.4                             | 67.79 | 71.18 | 1.0              | 93.6   | 4.3             | 115                      |
| 1SMA60CAT3G | TKC            | 60                                    | 2.5                                     | 66.7                             | 70.21 | 73.72 | 1.0              | 96.8   | 4.1             | 110                      |
| 1SMA70CAT3G | TPC            | 70                                    | 2.5                                     | 77.8                             | 81.90 | 85.99 | 1.0              | 113  | 3.5             | 95                       |
| 1SMA78CAT3G | TTC            | 78                                    | 2.5                                     | 86.7                             | 91.27 | 95.83 | 1.0              | 126  | 3.2             | 90                       |

4. A transient suppressor is normally selected according to the working peak reverse voltage (V<sub>RWM</sub>), which should be equal to or greater than the DC or continuous peak operating voltage level

5. V<sub>BR</sub> measured at pulse test current I<sub>T</sub> at an ambient temperature of 25°C

6. Surge current waveform per Figure 2 and derate per Figure 3

7. Bias voltage = 0 V, F = 1.0 MHz, T<sub>J</sub> = 25°C.

† Please see 1SMA5.0AT3 to 1SMA78AT3 for Unidirectional devices.

\* Include SZ-prefix devices where applicable.

# 1SMA10CAT3G Series, SZ1SMA10CAT3G Series

## RATING AND TYPICAL CHARACTERISTIC CURVES

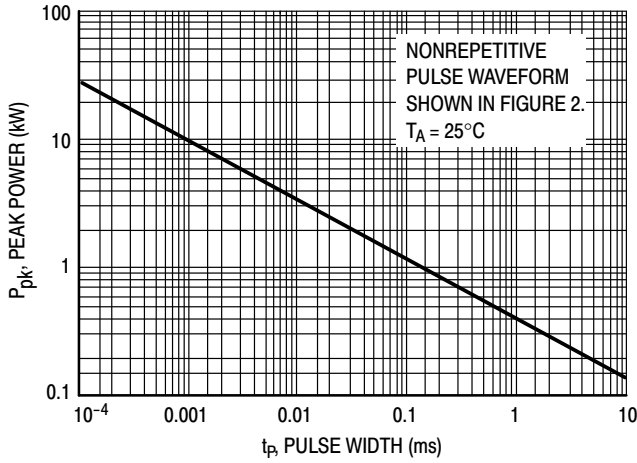

Figure 1. Pulse Rating Curve

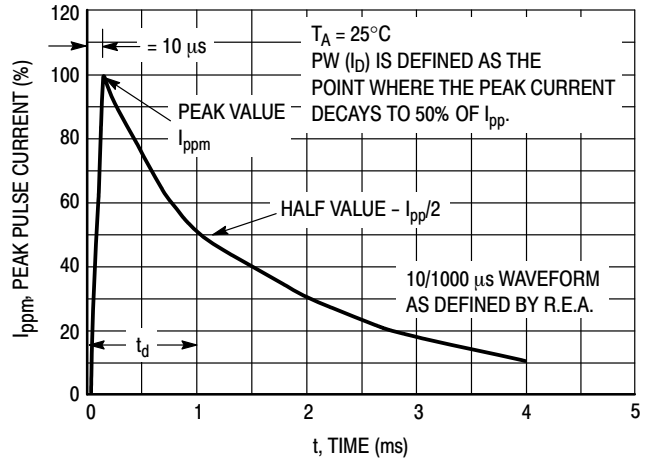

Figure 2. Pulse Waveform

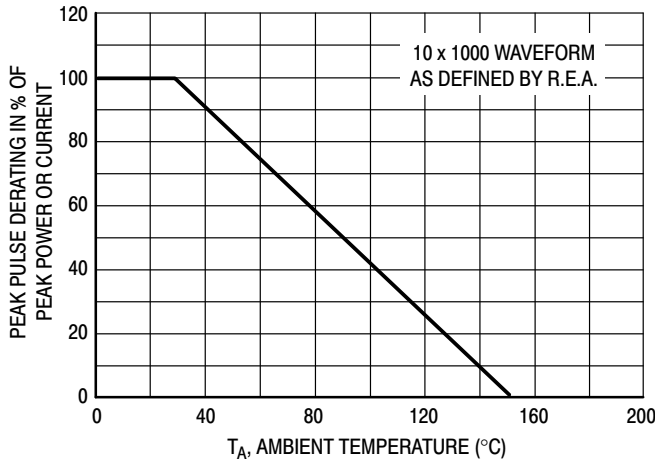

Figure 3. Pulse Derating Curve

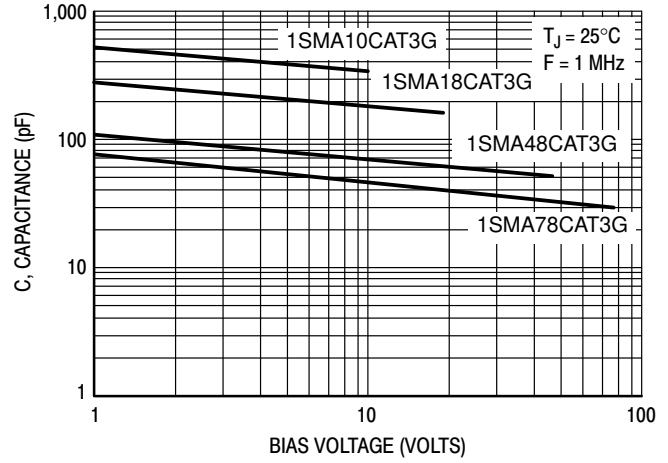
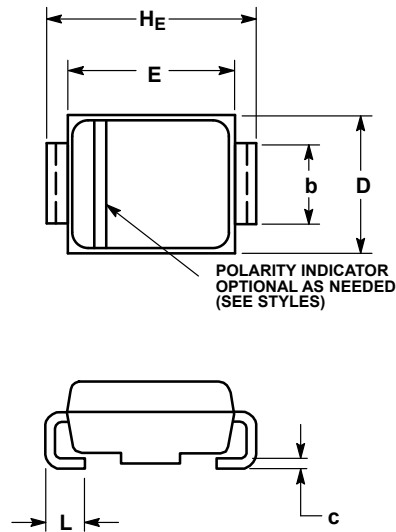

Figure 4. Typical Junction Capacitance vs. Bias Voltage

# 1SMA10CAT3G Series, SZ1SMA10CAT3G Series

## PACKAGE DIMENSIONS

### SMA CASE 403D ISSUE H



NOTES:

1. DIMENSIONING AND TOLERANCING PER ANSI Y14.5M, 1982.
2. CONTROLLING DIMENSION: INCH.
3. DIMENSION b SHALL BE MEASURED WITHIN DIMENSION L.

| DIM | MILLIMETERS |      |      | INCHES |       |       |
|-----|-------------|------|------|--------|-------|-------|
|     | MIN         | NOM  | MAX  | MIN    | NOM   | MAX   |
| A   | 1.97        | 2.10 | 2.20 | 0.078  | 0.083 | 0.087 |
| A1  | 0.05        | 0.10 | 0.20 | 0.002  | 0.004 | 0.008 |
| b   | 1.27        | 1.45 | 1.63 | 0.050  | 0.057 | 0.064 |
| c   | 0.15        | 0.28 | 0.41 | 0.006  | 0.011 | 0.016 |
| D   | 2.29        | 2.60 | 2.92 | 0.090  | 0.103 | 0.115 |
| E   | 4.06        | 4.32 | 4.57 | 0.160  | 0.170 | 0.180 |
| HE  | 4.83        | 5.21 | 5.59 | 0.190  | 0.205 | 0.220 |
| L   | 0.76        | 1.14 | 1.52 | 0.030  | 0.045 | 0.060 |

### SOLDERING FOOTPRINT

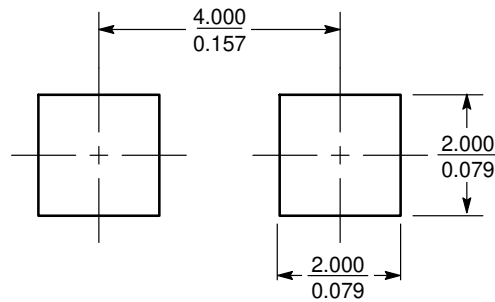

SCALE 8:1  $\left(\frac{\text{mm}}{\text{inches}}\right)$

Information furnished is believed to be accurate and reliable. However, users should independently evaluate the suitability of and test each product selected for their own applications. Littelfuse products are not designed for, and shall not be used for, any purpose (including, without limitation, military, aerospace, medical, life-saving, life-sustaining or nuclear facility applications, devices intended for surgical implant into the body, or any other application in which the failure or lack of desired operation of the product may result in personal injury, death, or property damage) other than those expressly set forth in applicable Littelfuse product documentation. Warranties granted by Littelfuse shall be deemed void for products used for any purpose not expressly set forth in applicable Littelfuse documentation. Littelfuse shall not be liable for any claims or damages arising out of products used in applications not expressly intended by Littelfuse as set forth in applicable Littelfuse documentation. The sale and use of Littelfuse products is subject to Littelfuse Terms and Conditions of Sale, unless otherwise agreed by Littelfuse.