



Chipsmall Limited consists of a professional team with an average of over 10 year of expertise in the distribution of electronic components. Based in Hongkong, we have already established firm and mutual-benefit business relationships with customers from,Europe,America and south Asia,supplying obsolete and hard-to-find components to meet their specific needs.

With the principle of "Quality Parts,Customers Priority,Honest Operation,and Considerate Service",our business mainly focus on the distribution of electronic components. Line cards we deal with include Microchip,ALPS,ROHM,Xilinx,Pulse,ON,Everlight and Freescale. Main products comprise IC,Modules,Potentiometer,IC Socket,Relay,Connector.Our parts cover such applications as commercial,industrial, and automotives areas.

We are looking forward to setting up business relationship with you and hope to provide you with the best service and solution. Let us make a better world for our industry!



## Contact us

Tel: +86-755-8981 8866 Fax: +86-755-8427 6832

Email & Skype: info@chipsmall.com Web: www.chipsmall.com

Address: A1208, Overseas Decoration Building, #122 Zhenhua RD., Futian, Shenzhen, China



THIS DRAWING IS UNPUBLISHED. RELEASED FOR PUBLICATION  
 © COPYRIGHT BY TYCO ELECTRONICS CORPORATION. ALL INTERNATIONAL RIGHTS RESERVED.

LOC	DIST	REVISIONS					
		P	LTR	DESCRIPTION	DATE	DWN	APVD
-	-	A		REDRAW PER ECO-11-000958	19JAN11	HMR	NE

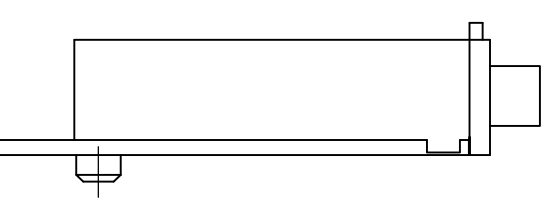
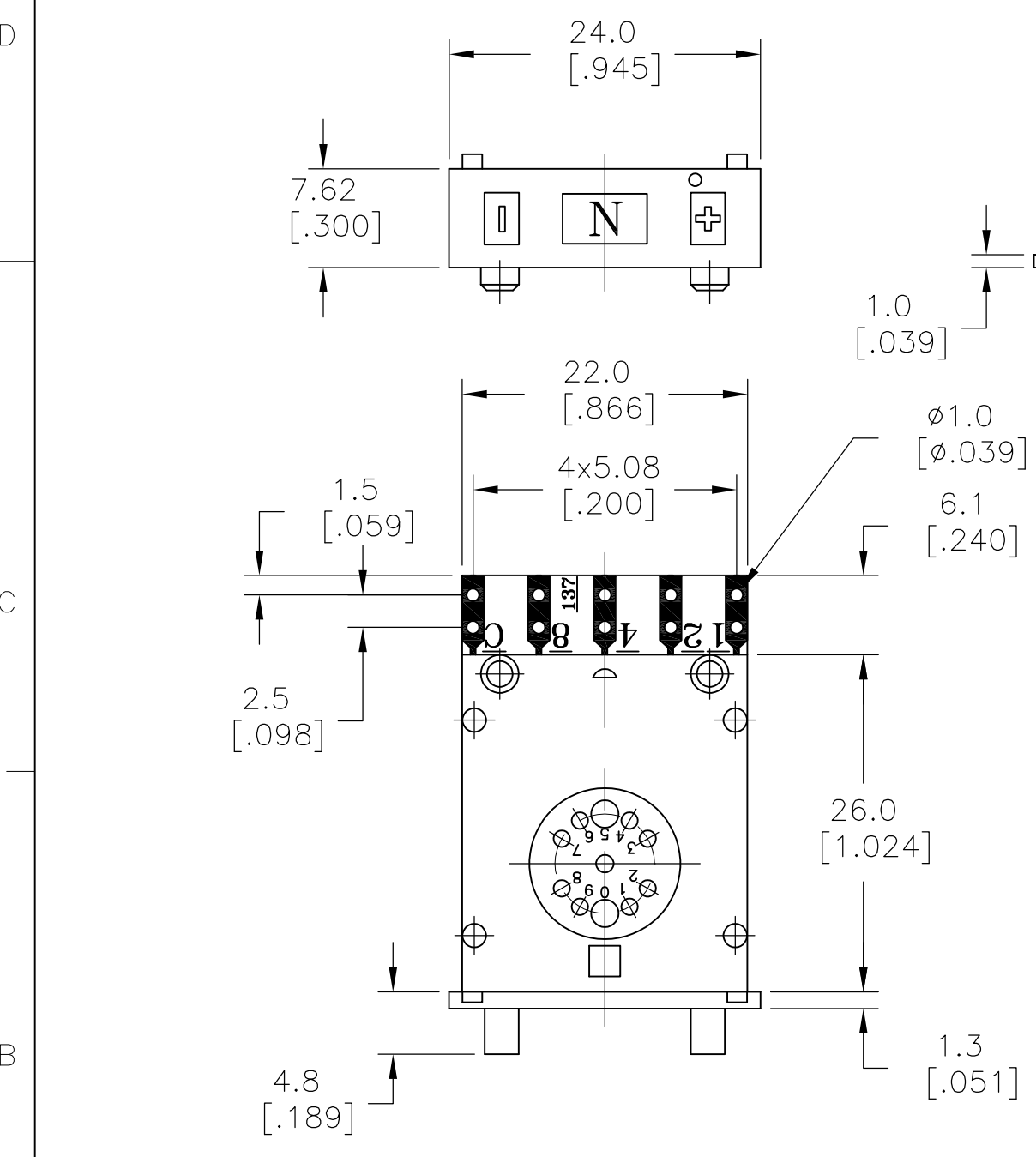

		BCD COMPLEMENT					
		PIN CONNECTION					
		C	1	2	4	8	
POSITION	0	●	●	●	●	●	
	1	●		●	●	●	N
	2	●	●		●	●	Kp
	3	●			●	●	Sc
	4	●	●	●		●	Lb
	5	●		●		●	
	6	●	●			●	
	7	●				●	
	8	●	●	●	●		
	9	●		●	●		

PRINTING

**TECHNICAL DATA**

MECHANICAL

PERMISSIBLE AMBIENT TEMPERATURE: -20°C TO +80°C.  
 EXPECTED LIFE (SWITCHING CYCLES): 1,000,000  
 ACTUATING FORCE APPROX: 4N  
 WEIGHT APPROX: 4g  
 DIGIT HEIGHT: 4.9[.193]  
 CLICK ACTION: MARKED  
 VIBRATION: DIN EN 60068-2-6  
 SHOCK: DIN EN 60068-2-27

ELECTRICAL

OPERATING VOLTAGE: MAX 40V  
 CONTACT LOAD STATIC: MAX 1A  
 CONTACT LOAD DYNAMIC(RESISTIVE): MAX 100mA  
 CONTACT RESISTANCE (MEASURED FROM THE SUPPLY LINE TO THE OUTPUT): <100mΩ

MATERIAL

HOUSING: PPO  
 PC BOARD BASE MATERIAL: FR4  
 CONTACT SURFACE: Au OVER Ni ON Cu  
 SLIDING CONTACT: Au OVER Ni ON COPPER ALLOY

HOUSING BLACK  
 KEYS BLACK  
 DRUM BLACK  
 PAINTING WHITE (TURNED BY 90°, PLUS BUTTON RIGHT)  
 SWITCHABLE 1-4

2-1437602-8  
 PART NO

THIS DRAWING IS A CONTROLLED DOCUMENT.		DWN RAGHAVENDRA 19JAN11	Tyco Electronics Corporation Harrisburg, PA 17105-3608	
DIMENSIONS: mm [INCHES]		CHK EPPLEY NAZ 19JAN11	Tyco Electronics	
TOLERANCES UNLESS OTHERWISE SPECIFIED:		APVD EPPLEY NAZ 19JAN11	NAME	
0 PLC ±		PRODUCT SPEC	BCD COMPLEMENT PUSHWHEEL SWITCH	
1 PLC ± 0.2[.008]		APPLICATION SPEC	SIZE	CAGE CODE
2 PLC ± 0.15[.006]		WEIGHT	A3	00779
3 PLC ±		CUSTOMER DRAWING	DRAWING NO	
4 PLC ±		SCALE	C-2-1437602-8	
ANGLES ± -		SHEET	1 OF 1	
MATERIAL -		RESTRICTED TO	REV A	
FINISH -				