



Chipsmall Limited consists of a professional team with an average of over 10 year of expertise in the distribution of electronic components. Based in Hongkong, we have already established firm and mutual-benefit business relationships with customers from,Europe,America and south Asia,supplying obsolete and hard-to-find components to meet their specific needs.

With the principle of “Quality Parts,Customers Priority,Honest Operation,and Considerate Service”,our business mainly focus on the distribution of electronic components. Line cards we deal with include Microchip,ALPS,ROHM,Xilinx,Pulse,ON,Everlight and Freescale. Main products comprise IC,Modules,Potentiometer,IC Socket,Relay,Connector.Our parts cover such applications as commercial,industrial, and automotives areas.

We are looking forward to setting up business relationship with you and hope to provide you with the best service and solution. Let us make a better world for our industry!



## Contact us

Tel: +86-755-8981 8866 Fax: +86-755-8427 6832

Email & Skype: info@chipsmall.com Web: www.chipsmall.com

Address: A1208, Overseas Decoration Building, #122 Zhenhua RD., Futian, Shenzhen, China



PREFERRED MOUNTING SITUATION FOR CABLE TIE  
 Bevorzugte Montagestellung fuer Kabelbinder

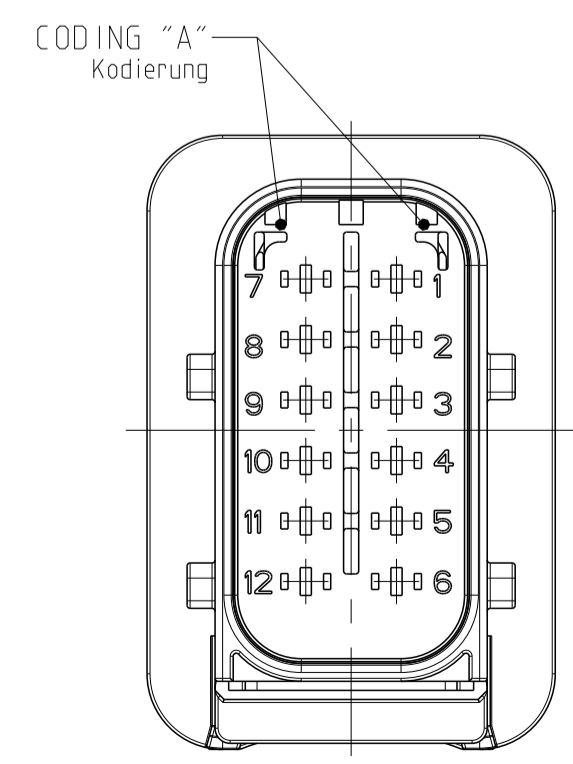
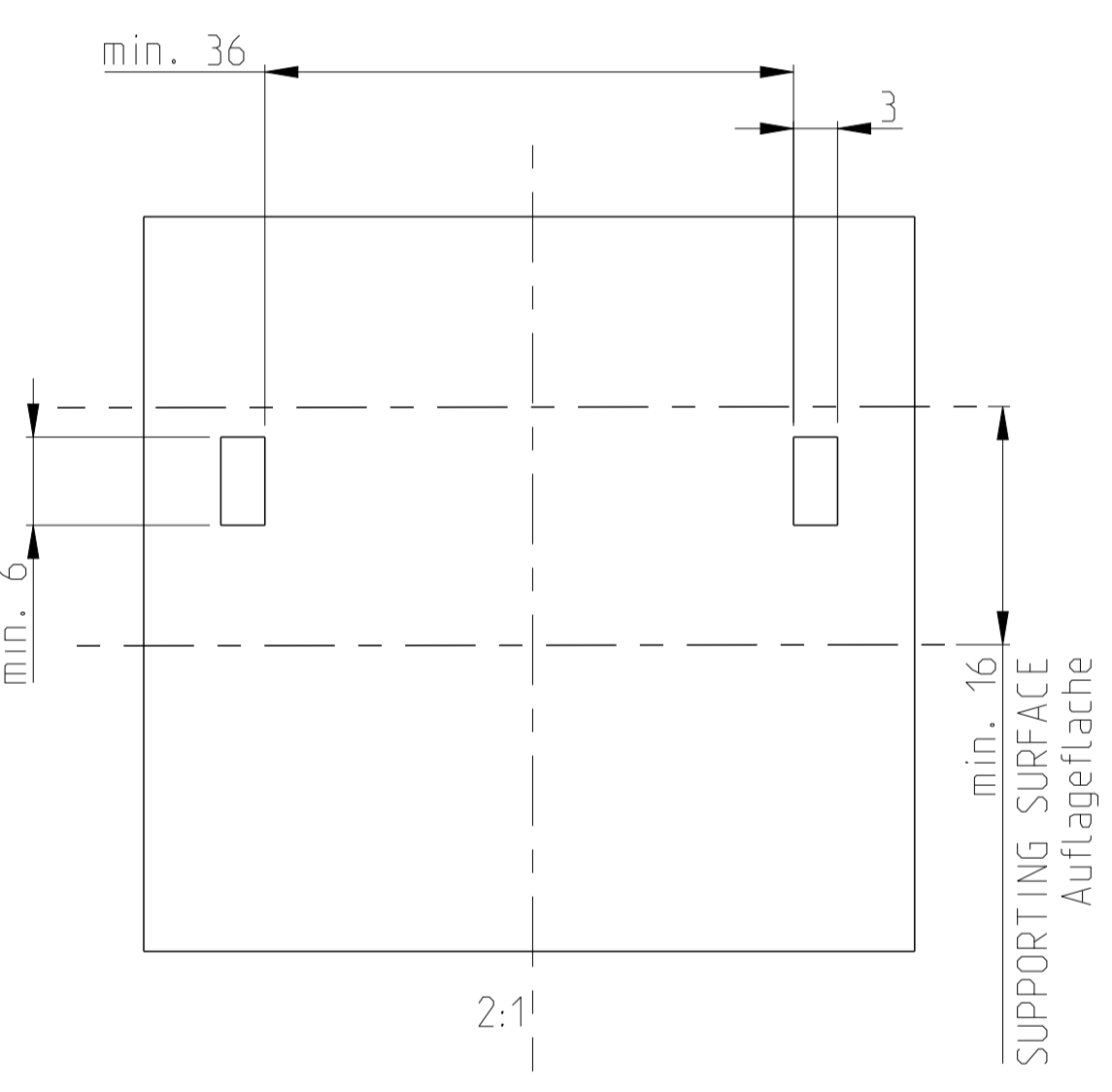
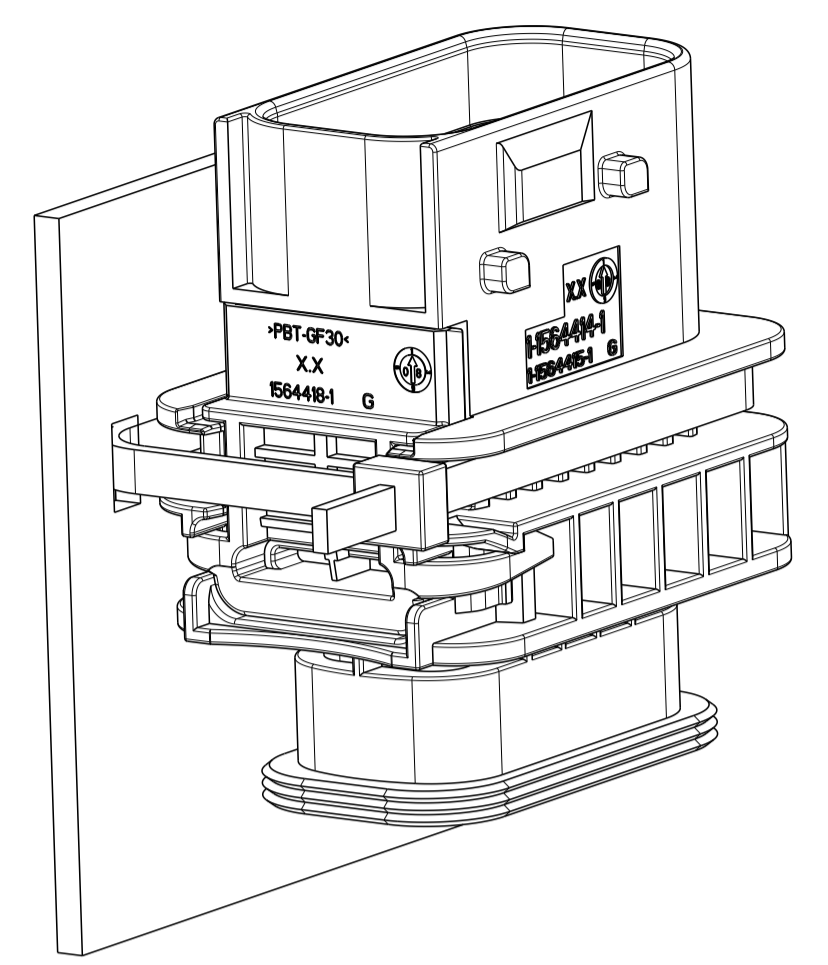

PN: 1-1564414-1

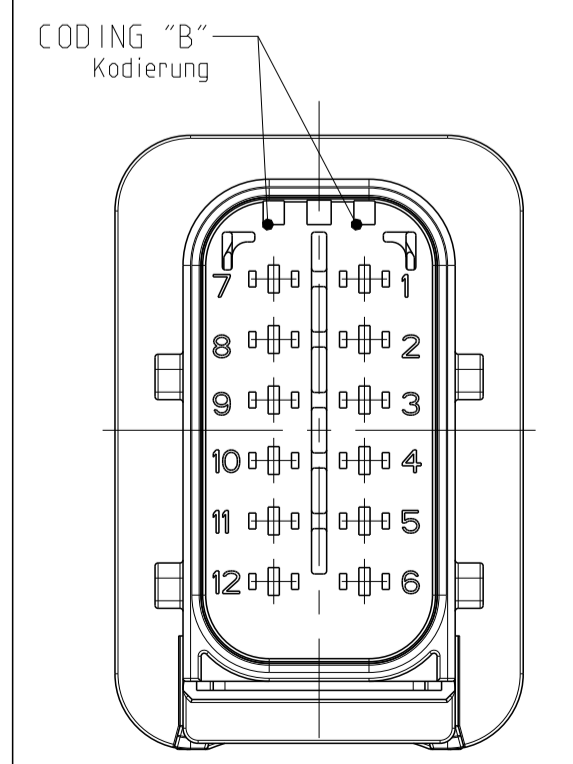

PN: 2-1564414-1

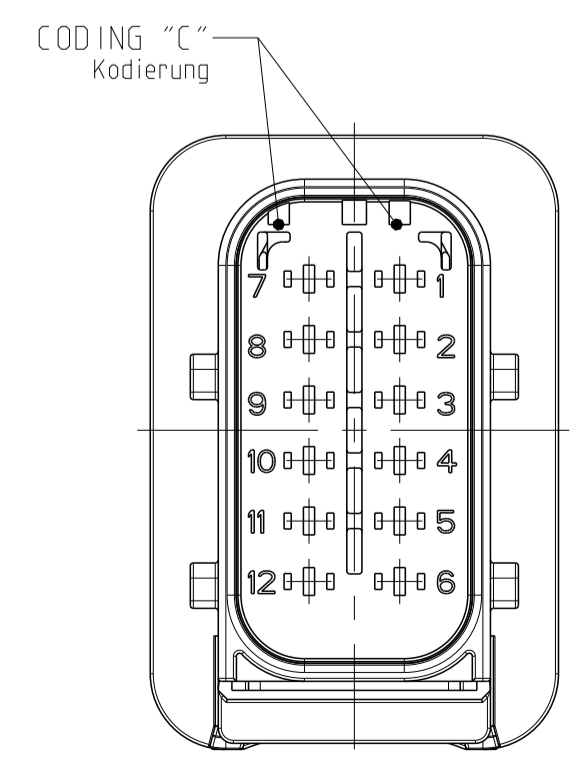

PN: 3-1564414-1

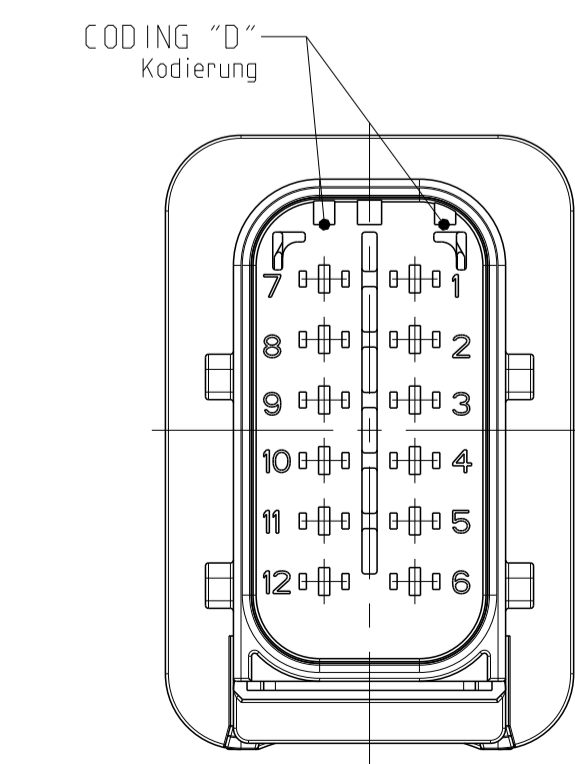

PN: 4-1564414-1

SECTION J-J  
 Schnitt

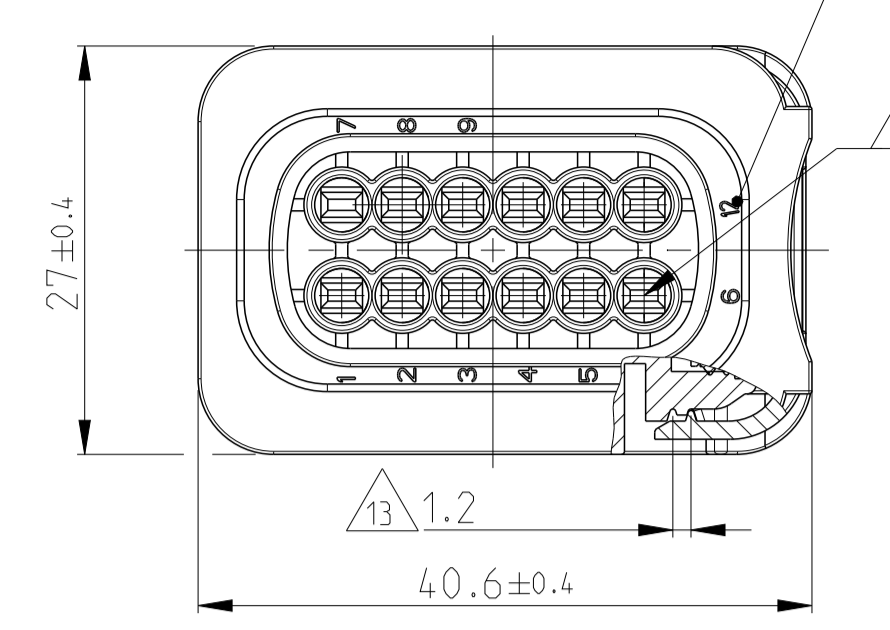

DELIVERY CONDITION:  
 SECONDARY LOCKING DEVICE  
 IN PRE-LOCKED POSITION  
 Lieferzustand:  
 2. Kontaktsicherung in Vorrastellung

1-1564414-1 AS SHOWN  
 1-1564414-1 wie gezeigt

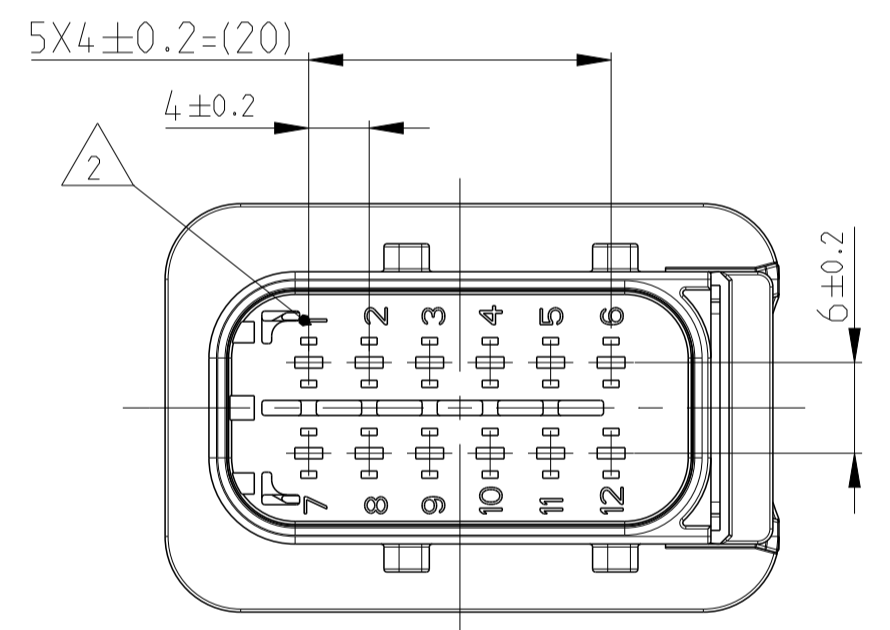
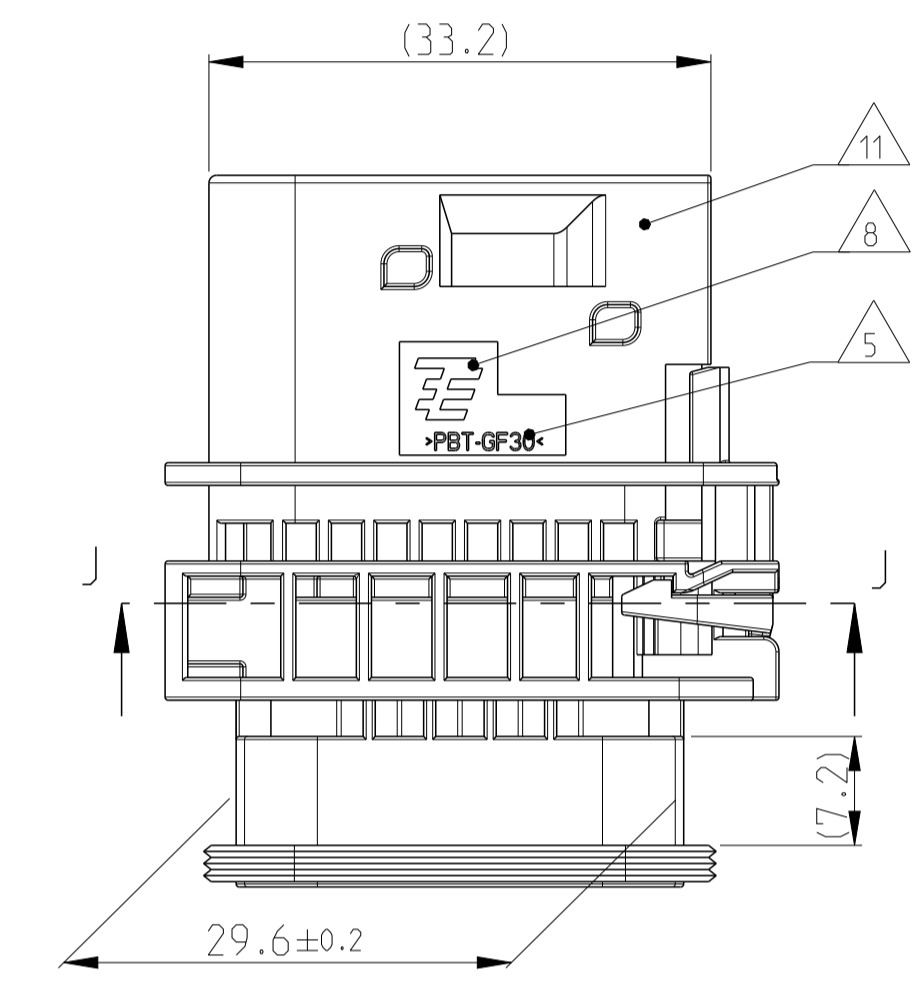
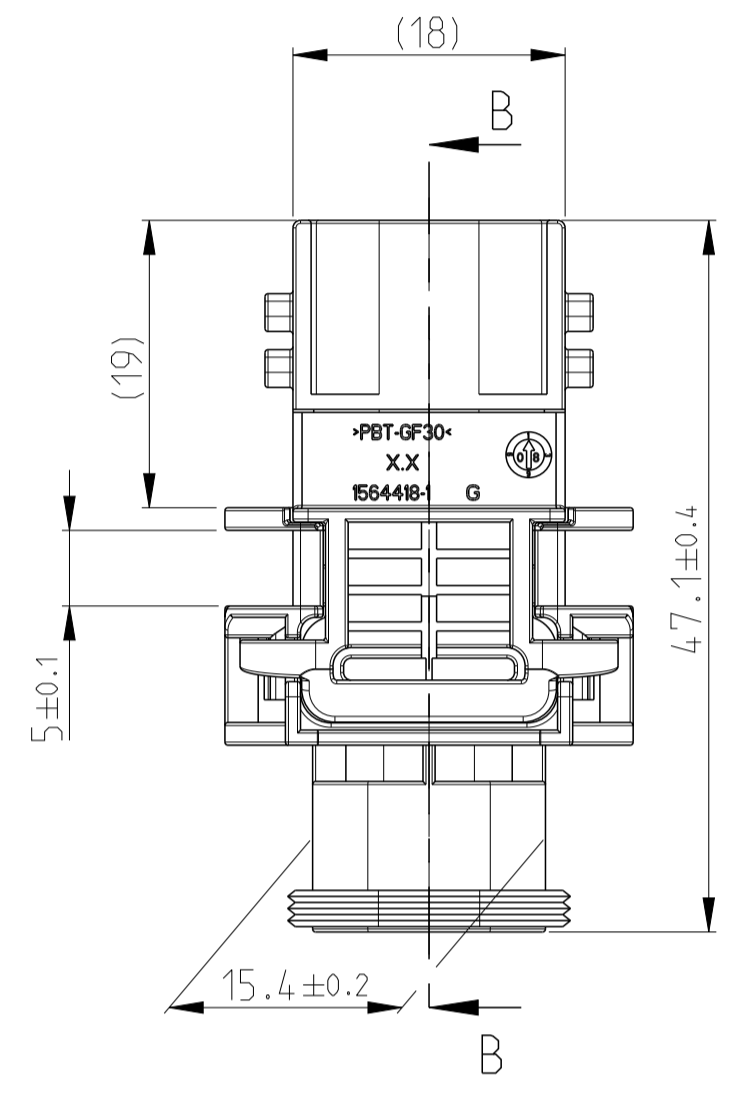

SECTION B-B  
 Schnitt

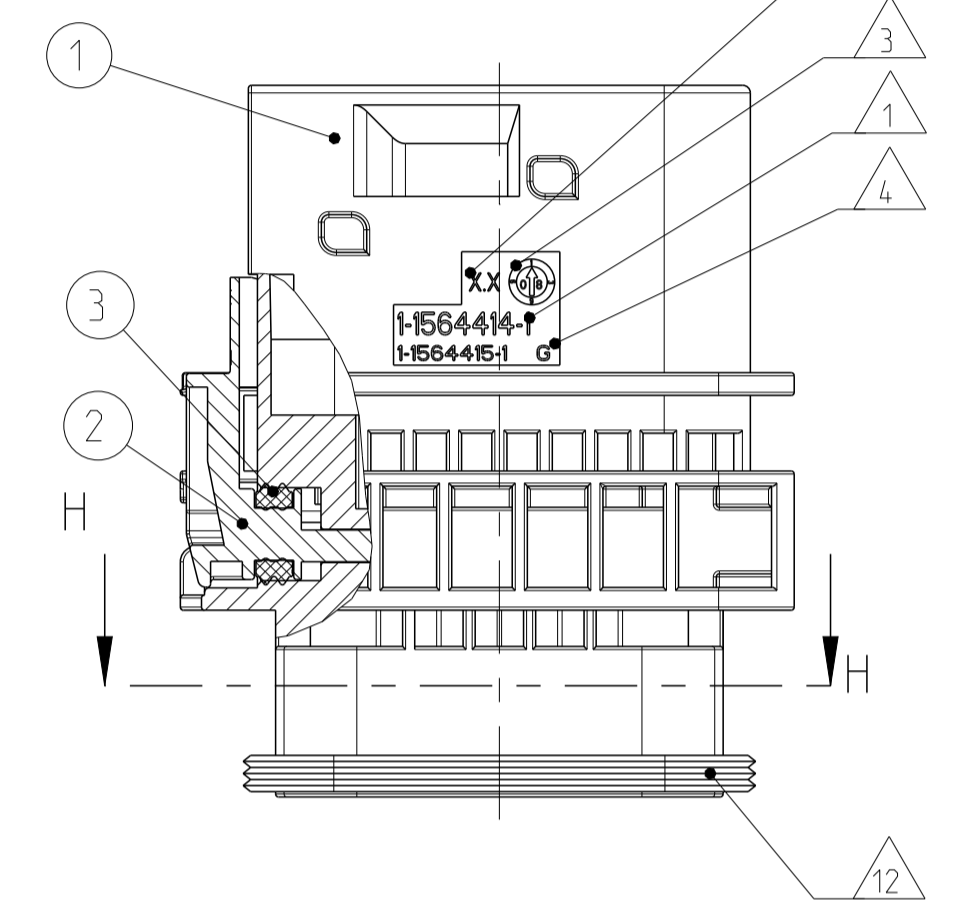

SECTION H-H  
 Schnitt

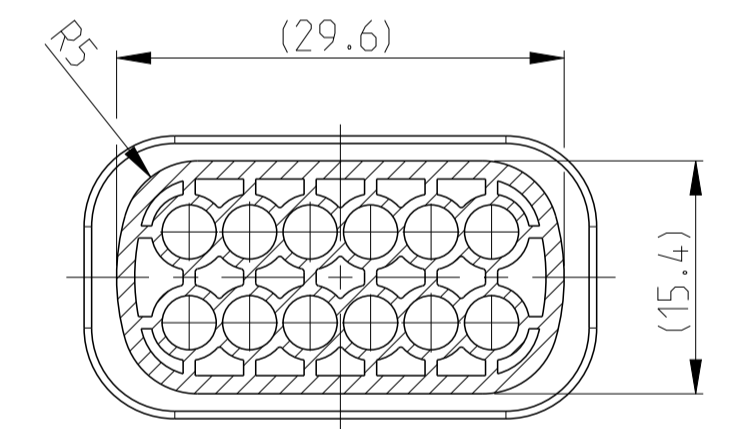

ITEM NO	DESCRIPTION	COLOUR	MATERIAL
1	12POS. TAB HOUSING, CODE "A" 120st. Flachsteckergehause, Kod. "A"	BLACK	PBT-GF30 / V-0
1	2POS. TAB HOUSING, CODE "B" 120st. Flachsteckergehause, Kod. "B"	GREY	PBT-GF30 / V-0
1	2POS. TAB HOUSING, CODE "C" 120st. Flachsteckergehause, Kod. "C"	GREEN	PBT-GF30 / V-0
1	2POS. TAB HOUSING, CODE "D" 120st. Flachsteckergehause, Kod. "D"	GREEN	PBT-GF30 / V-0
2	SECONDARY LOCKING DEVICE zweite Kontaktsicherung	YELLOW	PBT-GF30 / V-0
3	SEAL FOR SECONDARY LOCKING Dichtung fuer Zue Kontaktsicherung	WHITE	MVO

REV.	NO. OF POS.	CODE	QUANTITY	ITEM NO
TE Bestell-Nr.	Polzahl	Kodierung	Stueck	ASSY
4-1564414-1	G	12	D	4
3-1564414-1	G	12	C	3
2-1564414-1	G	12	B	2
1-1564414-1	G	12	A	1

LOC	DIST	REV	DATE	BY	CHK
A1	-	G	19FEB2009	SJ	JG
		G1	25MAY2011	CG	JG
		G2	27APR2016	MAH	GILC

- NOTES  
 Bemerkungen
- TE ORDER-NO.  
TE Bestell-Nr.
  - CAVITY NUMBERING  
Kammerbezeichnung
  - PRODUCTION DATE  
Produktionsdatum
  - LETTER-INSERT FOR THE REVISION STATUS OF THE MOULD  
Schriftsatz fuer Aenderungszustand des Werkzeuges
  - MATERIAL MARKING ACCORDING TO VDA 260  
Werkstoffkennzeichnung nach VDA 260
  - BULK PACKAGING IN CORRUGATED BOX  
Schuettgut im Versandkarton
  - MOULD CAVITY MARKING  
Nestmarkierung
  - TE LOGO  
TE Logo
  - SUITABLE COUNTERPART SEE DRAWING: 1703639  
passendes Gegenstueck siehe Zeichnung: 1703639
  - CAVITIES MATED WITH TAB 1.6 x 0.6 MM (SW5)  
SEE PRODUCT GROUP DRAWING  
TE NO: 1355055  
MAX. WIRE SIZE: 1.0mm<sup>2</sup> FLR  
  
WIRE SIZE: 1.5mm<sup>2</sup> FLR PERMITTED ONLY IN ASSOCIATION WITH SINGLE WIRE SEALING PN 0-2287497-1 ALLOWED TEMPERATURE 120 DEGREE CELSIUS  
  
Kontaktkammer passend fuer Flachstecker 1.6x0.6 mm (EDS) siehe Produktgruppenzeichnung TE Nr: 1355055 max. Drahtgroessenbereich: 1.0mm<sup>2</sup> FLR  
  
Es ist ein Drahtgroessenbereich von 1.5mm<sup>2</sup> FLR nur in Verbindung mit der Einzelliederleitung PN 0-2287497-1 bis zu 120°C zugelassen
  - INTERFACE ACC. Drawing: 114-18807-1  
KragenschluB nach Zeichnung: 114-18807-1
  - MATED WITH COVER SEE DRAWING: 1563110, 1563111  
Passend zu Kappe siehe Zeichnung: 1563110, 1563111
  - SLIDING DISTANCE OF SECONDARY LOCKING  
Verschiebeweg der zweiten Kontaktsicherung
  - MALFUNCTION CAUSED BY LAQUER IS NOT COVERED BY TE WARRANTY  
Funktionsbeeintraechtigung durch Lackieren. Liegt nicht im Einfluss und Gewaehrleistungsumfang von TE

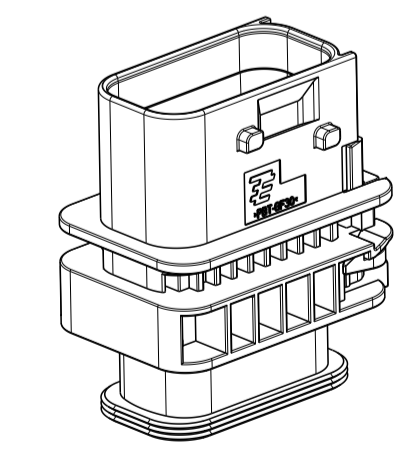

SCALE 1:1  
 Maßstab

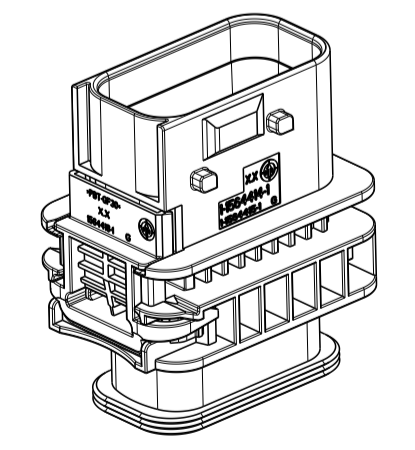

SCALE 1:1  
 Maßstab

THIS DRAWING IS A CONTROLLED DOCUMENT.  
 DIESER ZEICHNUNGSDRUCK IST EIN DURCH AMP KONTROLLIERTES DOKUMENT.  
 ANFORDERN AN DEN TECHNISCHEN VERFAHRENSTAND SIND OBERBETONET.  
 DEN ANWENDUNGSBEREICHEN ANZEIGENDE VERFAHREN SIND ANZUWENDEN.

OWNER: A. Kidane	DATE: 09MAY2008	TE Connectivity
CHK: F. Flitton	DATE: 09MAY2008	
APVD: In Eberwein	DATE: 12MAY2008	
PRODUCT SPEC: 108-94.020	APPLICATION SPEC: 114-18756	
WEIGHT: 18.65g	CAGE CODE: 00779	
CUSTOMER DRAWING	KUNDENZEICHNUNG	

SCALE: MASSSTAB 2:1  
 SHEET: BLATT 1 OF 1  
 REV: 62