



Chipsmall Limited consists of a professional team with an average of over 10 year of expertise in the distribution of electronic components. Based in Hongkong, we have already established firm and mutual-benefit business relationships with customers from,Europe,America and south Asia,supplying obsolete and hard-to-find components to meet their specific needs.

With the principle of "Quality Parts,Customers Priority,Honest Operation,and Considerate Service",our business mainly focus on the distribution of electronic components. Line cards we deal with include Microchip,ALPS,ROHM,Xilinx,Pulse,ON,Everlight and Freescale. Main products comprise IC,Modules,Potentiometer,IC Socket,Relay,Connector.Our parts cover such applications as commercial,industrial, and automotives areas.

We are looking forward to setting up business relationship with you and hope to provide you with the best service and solution. Let us make a better world for our industry!



## Contact us

Tel: +86-755-8981 8866 Fax: +86-755-8427 6832

Email & Skype: info@chipsmall.com Web: www.chipsmall.com

Address: A1208, Overseas Decoration Building, #122 Zhenhua RD., Futian, Shenzhen, China



THIS DRAWING IS UNPUBLISHED. RELEASED FOR PUBLICATION  
 © COPYRIGHT BY TYCO ELECTRONICS CORPORATION. ALL RIGHTS RESERVED.

LOC	DIST	REVISIONS					
FT	0	P	LTR	DESCRIPTION	DATE	DWN	APVD
		T1		REVISED PER ECO-08-006004	10MAR08	HMR	GS
		T2		REVISED PER ECO-09-020935	10SEP09	KK	AEQ

STYLE	(FREE DIA)	LH	LENGTH	MAT'L (NOTE)	MATING PIN φ REF	PLATING (NOTE NO.)	NUM LOUV	MAT'L THK	REF	PART NUMBER	
A	[.46]	[.028]	--	12	9.5 [.375]	6	38	0.18 [.007]	04121	5-192043-0	
A	[.46]	[.028]	--	12	9.5 [.375]	1-2	38	0.18 [.007]	04128	4-192043-9	OBSOLETE
A	[.46]	[.028]	--	12	9.5 [.375]	UNPL	38	0.18 [.007]	04120	4-192043-8	OBSOLETE
A	[.55]	[.024]	--	12	9.5 [.375]	6	38	0.15 [.006]	04108	4-192043-7	△19
A	[.60]	[.028]	--	12	9.5 [.375]	3-2	39	0.15 [.006]	--	4-192043-6	△19
A	[.55]	[.024]	--	12	9.5 [.375]	3-2	38	0.15 [.006]	04053	4-192043-5	
A	[.53]	[.024]	--	12	9.5 [.375]	1-2	38	0.15 [.006]	04067	4-192043-4	OBSOLETE
A	--	--	--	12	9.5 [.375]	1-2	38	0.15 [.006]	04092	4-192043-3	OBSOLETE
SUPERSEDED BY 4-192043-1											
A	[.55]	[.024]	--	12	9.5 [.375]	UNPL	38	0.15 [.006]	04071	4-192043-1	OBSOLETE
A	[.55]	[.026]	--	12	9.5 [.375]	5-2	38	0.12 [.005]	--	4-192043-0	OBSOLETE
A	[.55]	[.026]	--	13	9.5 [.375]	1-2	38	0.12 [.005]	04174	3-192043-9	△19
A	[.55]	[.026]	--	13	9.5 [.375]	UNPL	38	0.12 [.005]	--	3-192043-8	△19
A	[.54]	[.026]	--	12	9.1 [.359]	3-2	36	0.18 [.007]	04204	3-192043-7	OBSOLETE
A	[.54]	[.026]	--	12	9.1 [.359]	1-2	36	0.18 [.007]	04184	3-192043-6	OBSOLETE
A	[.54]	[.026]	--	12	9.1 [.359]	UNPL	36	0.18 [.007]	04183	3-192043-5	△19
A	--	--	--	12	8.9 [.359]	3-2	35	0.115 [.006]	04178	3-192043-4	OBSOLETE
A	--	--	--	12	8 [.315]	3-2	30	0.18 [.007]	04177	3-192043-3	OBSOLETE
A	--	[.026]	--	12	8 [.315]	3-2	29	0.18 [.007]	04179	3-192043-2	OBSOLETE
A	[.38]	[.026]	--	12	8 [.315]	1-2	29	0.18 [.007]	04206	3-192043-1	OBSOLETE
A	[.38]	[.026]	--	12	8 [.315]	UNPL	29	0.18 [.007]	04185	3-192043-0	OBSOLETE
A	[.43]	[.024]	--	12	8 [.315]	3-2	32	0.15 [.006]	--	2-192043-9	△19
A	[.40]	[.024]	--	12	8 [.315]	1-2	31	0.15 [.006]	--	2-192043-8	△19
A	[.43]	[.024]	--	12	8 [.315]	1-2	32	0.15 [.006]	04076	2-192043-7	
A	[.43]	[.024]	--	12	8 [.315]	UNPL	32	0.15 [.006]	04052	2-192043-6	OBSOLETE
A	[.40]	[.026]	--	13	7.9 [.312]	UNPL	32	0.12 [.005]	04079	2-192043-5	OBSOLETE
A	--	--	--	12	7.5 [.296]	1-2	32	0.18 [.007]	04189	2-192043-4	OBSOLETE
A	--	--	--	12	7.49 [.295]	3-2	30	0.15 [.006]	04051	2-192043-3	OBSOLETE
A	--	--	--	12	7.44 [.293]	3-2	29	0.12 [.005]	04050	2-192043-2	OBSOLETE
A	--	--	--	12	7.14 [.281]	3-2	28	0.20 [.008]	04049	2-192043-1	OBSOLETE
A	[.45]	[.024]	--	12	7.1 [.280]	3-2	28	0.15 [.006]	04106	2-192043-0	
A	[.45]	[.024]	--	12	7.1 [.280]	UNPL	28	0.15 [.006]	04199	1-192043-9	OBSOLETE
A	--	--	--	12	7 [.276]	3-2	27	0.12 [.005]	04047	1-192043-8	OBSOLETE
A	--	--	--	12	6.45 [.254]	7-2	26	0.15 [.006]	04065	1-192043-7	OBSOLETE
A	[.35]	[.024]	--	12	6.45 [.254]	3-2	26	0.15 [.006]	04075	1-192043-6	
A	[.35]	[.024]	--	12	6.45 [.254]	1-2	26	0.15 [.006]	04086	1-192043-5	
A	[.35]	[.024]	--	12	6.45 [.254]	UNPL	26	0.15 [.006]	04046	1-192043-4	OBSOLETE
A	[.50]	[.026]	--	13	6.45 [.254]	UNPL	26	0.12 [.005]	04093	1-192043-3	OBSOLETE
A	[.29]	[.024]	--	12	6.35 [.250]	3-2	26	0.20 [.008]	04045	1-192043-2	△19
A	[.29]	[.024]	--	12	6.35 [.250]	1-2	26	0.20 [.008]	04116	1-192043-1	△19
SUPERSEDED BY 1-192043-6											
A	[.29]	[.016]	--	13	6.35 [.250]	UNPL	26	0.12 [.005]	04082	192043-9	OBSOLETE
A	[.28]	[.024]	--	12	6 [.237]	3-2	24	0.15 [.006]	04041	192043-8	OBSOLETE
A	[.28]	[.024]	--	12	6 [.237]	UNPL	24	0.15 [.006]	04042	192043-7	△19
A	[.28]	[.024]	--	12	5.54 [.218]	1-2	23	0.15 [.006]	04146	192043-6	
A	[.28]	[.024]	--	12	5.54 [.218]	UNPL	23	0.15 [.006]	04143	192043-5	OBSOLETE
A	--	--	--	12	5.5 [.217]	3-2	21	0.20 [.008]	04040	192043-4	OBSOLETE
A	[.27]	[.024]	--	12	5.5 [.217]	3-2	21	0.15 [.006]	04105	192043-3	OBSOLETE
A	[.26]	[.024]	--	12	5 [.197]	3-2	20	0.15 [.006]	04215	192043-2	
A	[.26]	[.024]	--	12	5 [.197]	UNPL	20	0.15 [.006]	04216	192043-1	△19

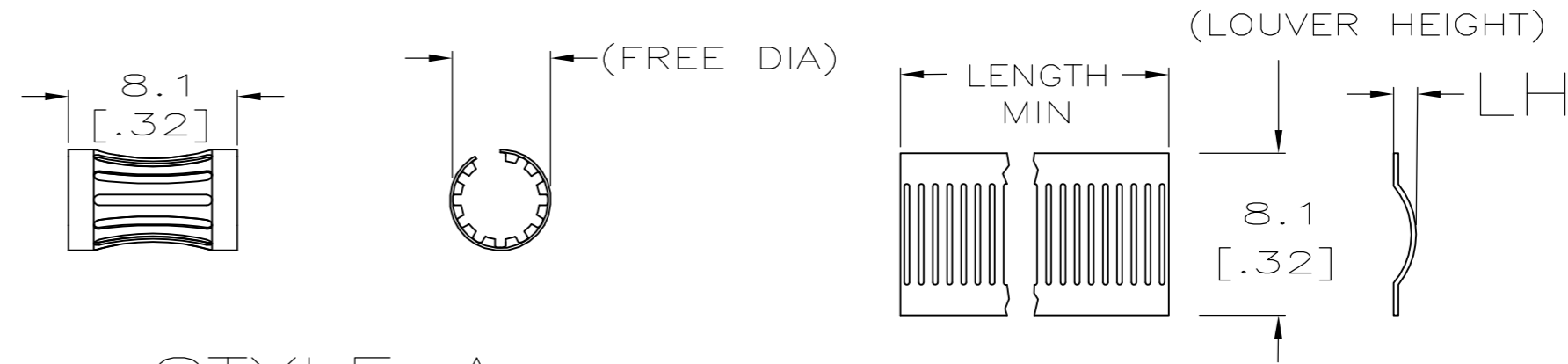

STYLE A  
(FEMALE)

STYLE C  
(STRIP)

- FINISH-SILVER PLATE 200 μINCH THICK MIN.
- FINISH-NICKEL PLATE 40 μINCH THICK MIN.
- FINISH-GOLD PLATE 10 μINCH THICK MIN.
- FINISH
- FINISH-GOLD PLATE 40 μINCH THICK MIN.
- FINISH-TIN PLATE 300 μINCH THICK MIN.
- FINISH-GOLD PLATE 50 μINCH THICK MIN.
- FINISH-NICKEL PLATE 100 μINCH THICK MIN.
- FINISH-PREPLATE
- 
- PLATING NOTES ARE TO BE INTERPRETED AS FOLLOWS,  
6-8 AS 6 OVER 8.
- MATERIAL-CDA172, BeCu.
- MATERIAL-STAINLESS STEEL
- PRODUCT IS SOLD BY THE FOOT.
- △15 OBSOLETE (PENDING).
- △16 MATERIAL: ELGILOY.
- △17 PRELIMINARY PART NUMBER.
- △18 FINISH: COPPER PLATE 10 μINCH THICK MIN.
- △19 OBSOLETE PARTS: OBSOLETE CIS STREAMLINING PER D.RENAUD/D.SINISI

THIS DRAWING IS A CONTROLLED DOCUMENT.		DWN RA JAYNE 09-21-91	Tyco Electronics Corporation Harrisburg, PA 17105-3608	
DIMENSIONS: INCHES		CHK J.TURNER 07-21-93	NAME	
TOLERANCES UNLESS OTHERWISE SPECIFIED:		APVD	PRODUCT SPEC	
0 PLC ± -		APPLICATION SPEC		
1 PLC ± -		WEIGHT		
2 PLC ± 0.5 [.02]		SIZE A2		
3 PLC ± 0.25 [.010]		CAGE CODE 00779		
4 PLC ± -		DRAWING NO. C=192043		
ANGLES ± -		RESTRICTED TO		
FINISH SEE TABLE		SCALE 1:1 SHEET 1 OF 2 REV T2		
MATERIAL		CUSTOMER DRAWING		

THIS DRAWING IS UNPUBLISHED. RELEASED FOR PUBLICATION  
 © COPYRIGHT BY TYCO ELECTRONICS CORPORATION. ALL RIGHTS RESERVED.

LOC		DIST		REVISIONS			
FT	0	P	LTR	DESCRIPTION	DATE	DWN	APVD
				SEE SHEET 1			

A	[.09]	[.024]	--	12	1.57	[.062]	3-2	7	0.12	[.005]	--	9-192043-9	△17
A	[.21]	[.026]	--	12	4.39	[.173]	3-18	17	0.15	[.006]	--	9-192043-8	△17
A	[.17]	[.026]	--	16	3.17	[.125]	3-2	13	0.12	[.005]	--	9-192043-7	△17
A	[1.00]	[.026]	--	12	18.4	[.725]	1-2	73	0.15	[.006]	--	9-192043-6	
C	--	[.038]	NOTE 14	12	--	--	1-2,9	--	0.15	[.006]	--	9-192043-5	OBSOLETE △19
A	[.16]	[.026]	--	12	3.2	[.125]	3-2	11	0.15	[.006]	--	9-192043-4	
A	[.21]	[.026]	--	12	3.98	[.157]	1-2	14	0.15	[.006]	--	9-192043-3	
A	[.21]	[.026]	--	12	3.98	[.157]	UNPL	14	0.15	[.006]	--	9-192043-2	OBSOLETE △19
C	--	[.016]	NOTE 14	12	--	--	UNPL	--	0.12	[.005]	--	9-192043-1	
C	--	[.030]	NOTE 14	12	--	--	UNPL	--	0.15	[.006]	--	9-192043-0	OBSOLETE △19
A	[.58]	[.024]	--	12	11.1	[.439]	UNPL	44	0.20	[.008]	--	8-192043-9	
A	[.50]	[.024]	--	12	10.4	[.410]	UNPL	40	0.20	[.008]	--	8-192043-8	
--	--	--	--	--	--	--	--	--	--	--	--	8-192043-7	OBSOLETE
A	[.40]	[.024]	--	12	10.4	[.408]	1-2	40	0.15	[.006]	04220	8-192043-6	
A	[.29]	[.024]	--	12	6.3	[.250]	UNPL	26	0.20	[.008]	--	8-192043-5	
A	[.26]	[.024]	--	12	5.5	[.217]	UNPL	21	0.15	[.006]	--	8-192043-4	
C	--	[.026]	NOTE 14	12	--	--	UNPL	--	0.15	[.006]	--	8-192043-3	
A	[.19]	[.024]	--	12	4.7	[.187]	UNPL	18	0.15	[.006]	--	8-192043-2	
C	--	[.030]	[.46]	12	--	--	UNPL	15	0.15	[.006]	--	8-192043-1	
A	[.17]	[.028]	--	12	3.2	[.125]	7-2	13	0.15	[.006]	--	8-192043-0	OBSOLETE △19
A	[.65]	[.024]	--	12	15.3	[.602]	UNPL	60	0.15	[.006]	04224	7-192043-9	
C	--	[.036]	NOTE 14	12	--	--	1-2	--	0.15	[.006]	--	7-192043-8	
A	[.16]	[.026]	--	12	3.17	[.125]	UNPL	11	0.15	[.006]	04229	7-192043-7	OBSOLETE △19
A	[.21]	[.024]	--	12	3.98	[.157]	1-2	15	0.15	[.006]	04230	7-192043-6	
A	[.06]	[.018]	--	12	.6	[.025]	UNPL	4	0.12	[.005]	04225	7-192043-5	OBSOLETE △19
A	[.16]	[.026]	--	12	3.2	[.125]	8	11	0.15	[.006]	04227	7-192043-4	
C	--	[.026]	NOTE 14	12	--	--	1-2	--	0.12	[.005]	04001	7-192043-3	
A	[.16]	[.026]	--	12	3.2	[.125]	1-2	11	0.15	[.006]	04228	7-192043-2	
C	[.16]	[.036]	.37	12	--	--	UNPL	12	0.15	[.006]	04221	7-192043-1	OBSOLETE △19
--	--	--	--	--	--	--	--	--	--	--	--	7-192043-0	OBSOLETE
A	--	--	--	12	25.4	[1.00]	7-2	--	0.20	[.008]	04058	6-192043-9	OBSOLETE
A	--	--	--	12	18	[.709]	7-2	--	0.20	[.008]	04056	6-192043-8	OBSOLETE
A	[.65]	[.024]	--	12	15.3	[.602]	7-2	60	0.15	[.006]	04074	6-192043-7	
A	--	[.024]	--	12	12	[.472]	8	48	0.20	[.008]	04172	6-192043-6	OBSOLETE
A	[.72]	[.024]	--	12	12	[.472]	3-2	48	0.20	[.008]	04090	6-192043-5	OBSOLETE
A	[.72]	[.024]	--	12	12	[.472]	1-2	48	0.20	[.008]	04095	6-192043-4	OBSOLETE △19
A	[.72]	[.024]	--	12	12	[.472]	UNPL	48	0.20	[.008]	04096	6-192043-3	
A	--	--	--	12	12	[.472]	3-2	48	0.15	[.006]	04055	6-192043-2	OBSOLETE
A	--	--	--	12	12	[.472]	1-2	48	0.15	[.006]	04091	6-192043-1	OBSOLETE
A	[.58]	[.024]	--	12	11.1	[.439]	3-2	44	0.20	[.008]	04205	6-192043-0	OBSOLETE
A	[.58]	[.024]	--	12	11.1	[.439]	1-2	44	0.20	[.008]	04201	5-192043-9	
A	[.57]	[.024]	--	12	10.4	[.410]	3-2	40	0.20	[.008]	04154	5-192043-8	
A	[.50]	[.024]	--	12	10.4	[.408]	3-2	40	0.15	[.006]	04186	5-192043-7	OBSOLETE
A	[.50]	[.024]	--	12	10.4	[.408]	UNPL	40	0.15	[.006]	04187	5-192043-6	
A	[.50]	[.024]	--	12	9.5	[.375]	1-2	38	0.20	[.008]	04115	5-192043-5	
A	[.50]	[.024]	--	12	9.5	[.375]	UNPL	38	0.20	[.008]	04176	5-193043-4	△19
A	[.45]	[.030]	--	12	9.5	[.375]	3-2	38	0.18	[.007]	04209	5-192043-3	
A	[.45]	[.030]	--	12	9.5	[.375]	6	38	0.18	[.007]	04207	5-192043-2	
A	[.45]	[.030]	--	12	9.5	[.375]	UNPL	38	0.18	[.007]	04208	5-192043-1	

STYLE	(FREE DIA)	LH	LENGTH	MAT'L (NOTE)	MATING PIN φ REF	PLATING (NOTE NO.)	NUM LOUV	MAT'L THK	REF	PART NUMBER
-------	------------	----	--------	--------------	------------------	--------------------	----------	-----------	-----	-------------

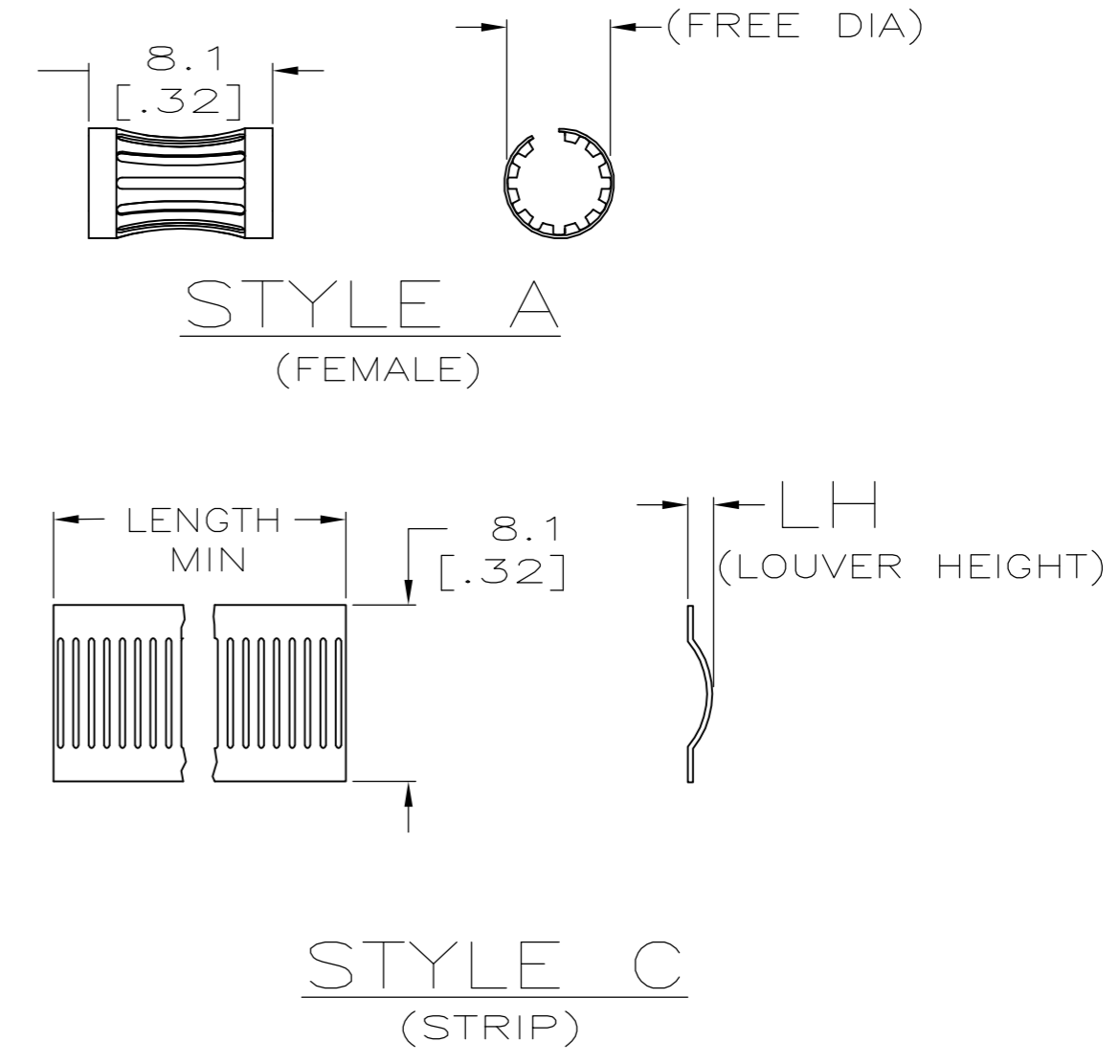

THIS DRAWING IS A CONTROLLED DOCUMENT.		DWN RA JAYNE 09-21-91	Tyco Electronics Corporation Harrisburg, PA 17105-3608	
DIMENSIONS: INCHES		CHK J.TURNER 07-21-93	NAME	
TOLERANCES UNLESS OTHERWISE SPECIFIED:		APVD	PRODUCT SPEC	
0 PLC ± -		APPLICATION SPEC		
1 PLC ± -		WEIGHT		
2 PLC ± 0.5 [02]		SCALE 1:1 SHEET 2 OF 2 REV T2		
3 PLC ± 0.25 [010]		CUSTOMER DRAWING		
4 PLC ± -		SIZE A2 CAGE CODE 00779 DRAWING NO. 192043		
ANGLES ± -		RESTRICTED TO		
FINISH		SEE TABLE		