



Chipsmall Limited consists of a professional team with an average of over 10 year of expertise in the distribution of electronic components. Based in Hongkong, we have already established firm and mutual-benefit business relationships with customers from,Europe,America and south Asia,supplying obsolete and hard-to-find components to meet their specific needs.

With the principle of “Quality Parts,Customers Priority,Honest Operation,and Considerate Service”,our business mainly focus on the distribution of electronic components. Line cards we deal with include Microchip,ALPS,ROHM,Xilinx,Pulse,ON,Everlight and Freescale. Main products comprise IC,Modules,Potentiometer,IC Socket,Relay,Connector.Our parts cover such applications as commercial,industrial, and automotives areas.

We are looking forward to setting up business relationship with you and hope to provide you with the best service and solution. Let us make a better world for our industry!



Contact us

Tel: +86-755-8981 8866 Fax: +86-755-8427 6832

Email & Skype: info@chipsmall.com Web: www.chipsmall.com

Address: A1208, Overseas Decoration Building, #122 Zhenhua RD., Futian, Shenzhen, China



LOC		DIST		REVISIONS			
P	LTR	DESCRIPTION	DATE	DWN	APVD		
C		REVISED PER ECR-09-023963	11NOV09	HMR	KR		

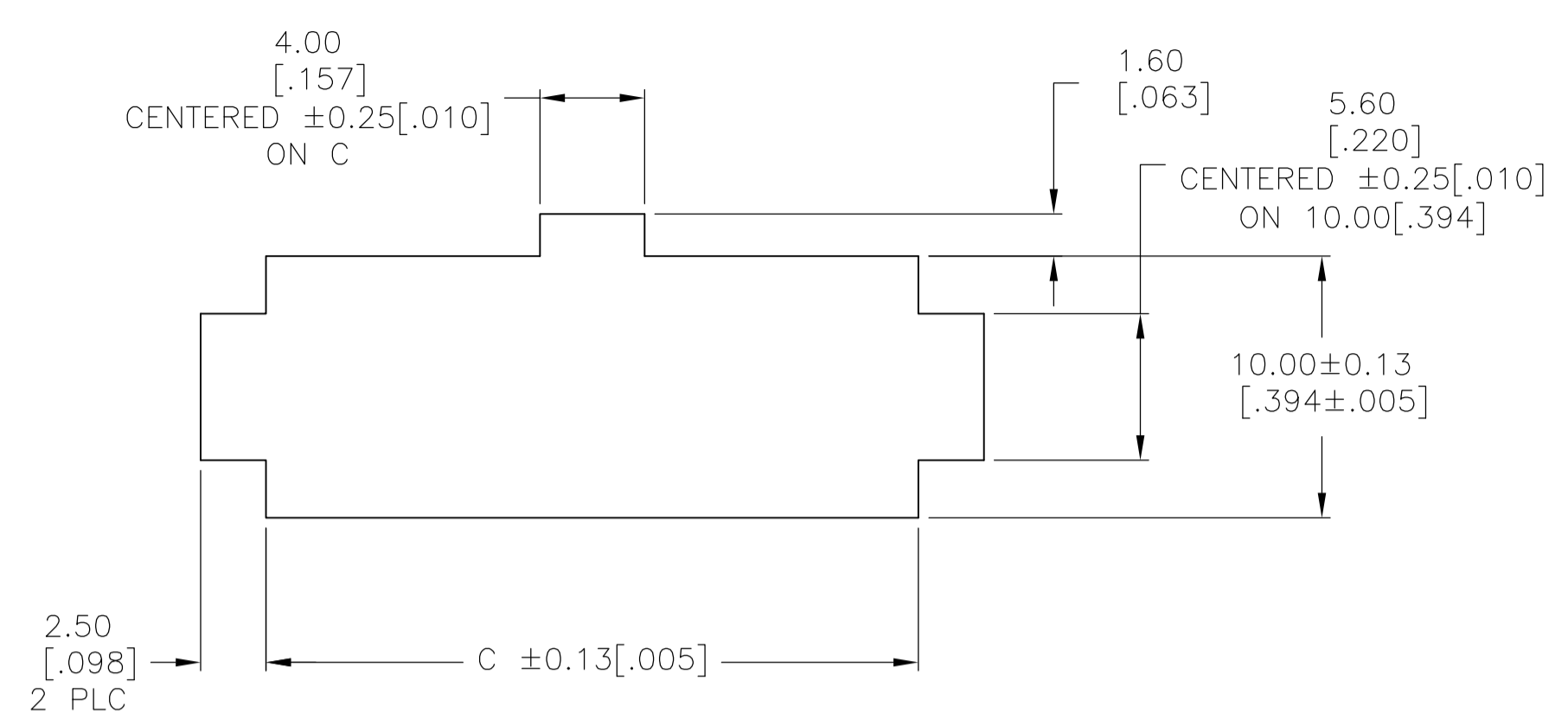
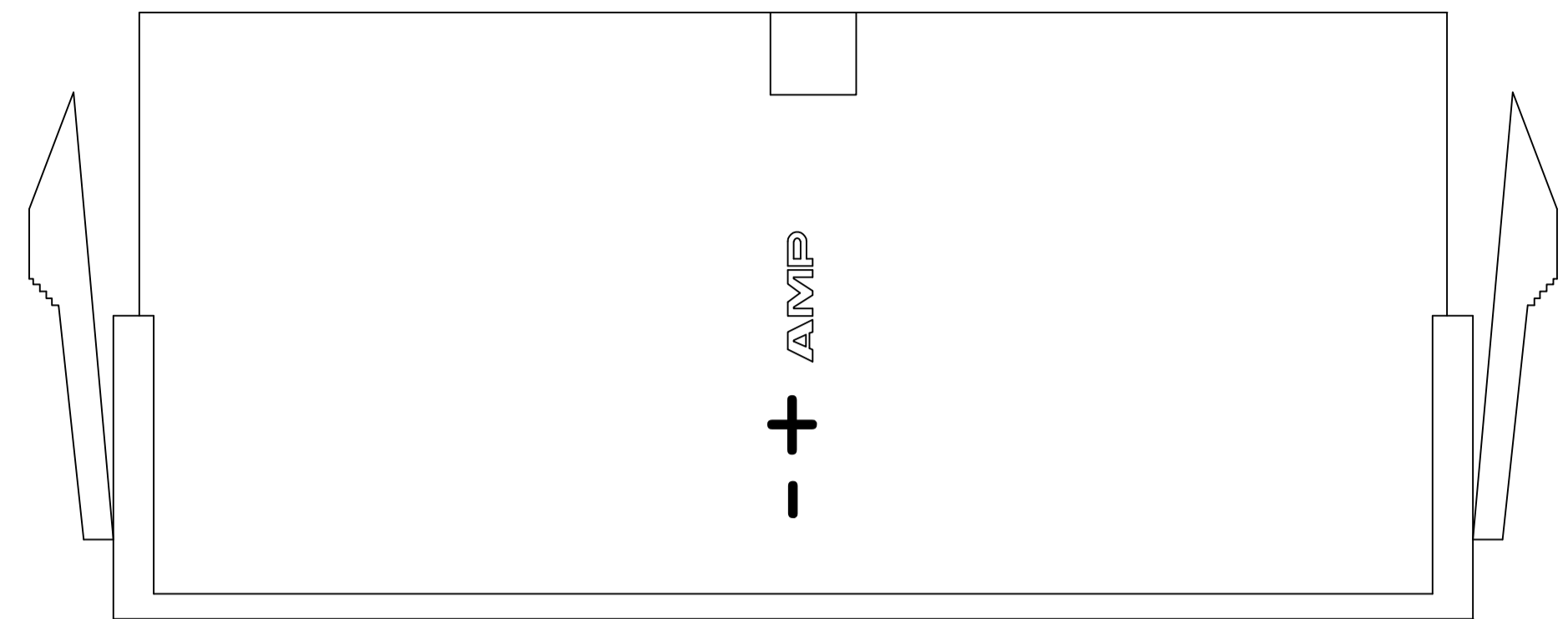

RECOMMENDED CUT OUT FOR
 2.00 [.079] MAX THICK PANEL

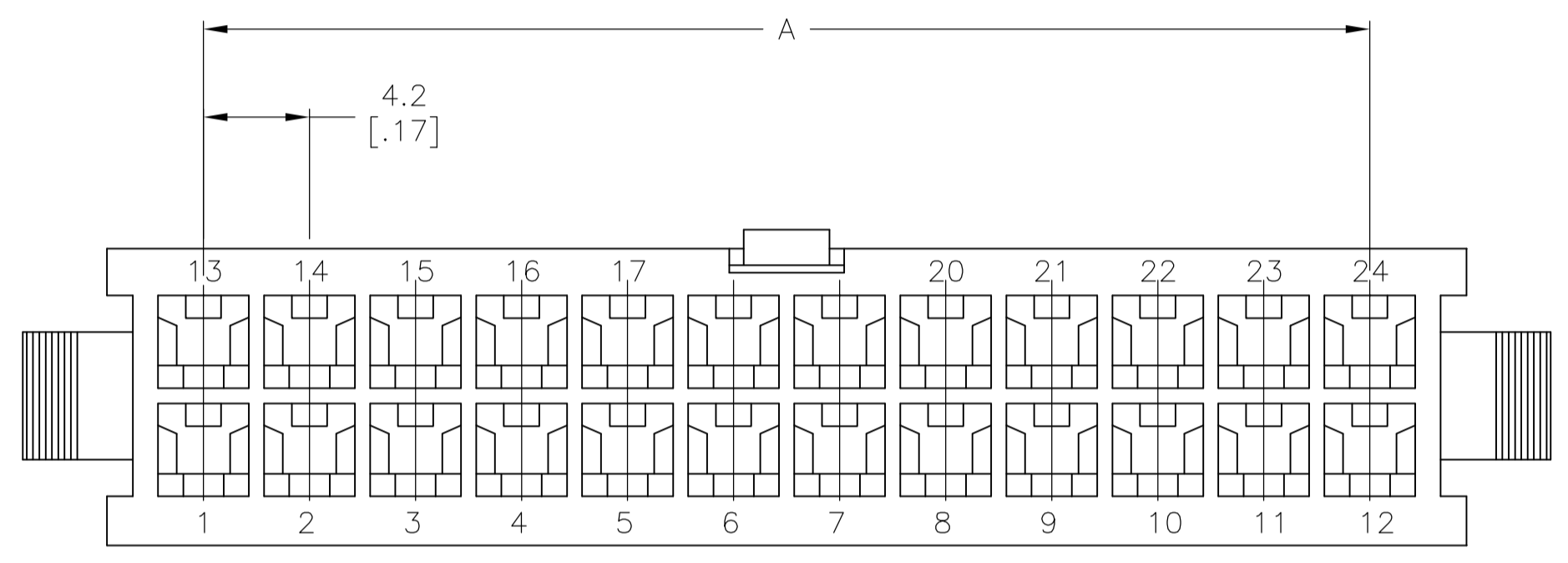

- 1 NYLON, UL94V-0, BLACK.
- 2 PANEL MUST BE PUNCHED SO THAT THE HOUSING ENTERS THE PANEL IN THE SAME DIRECTION AS THE PUNCH.

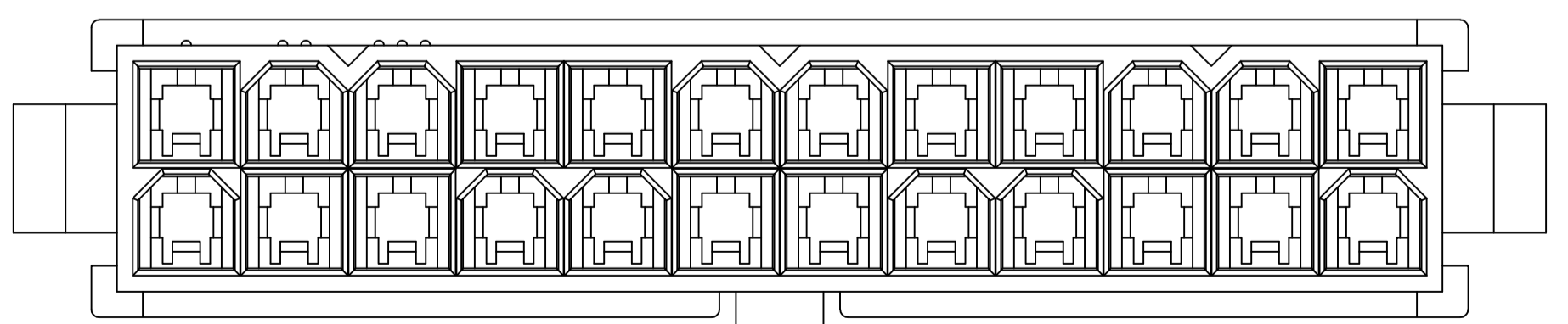
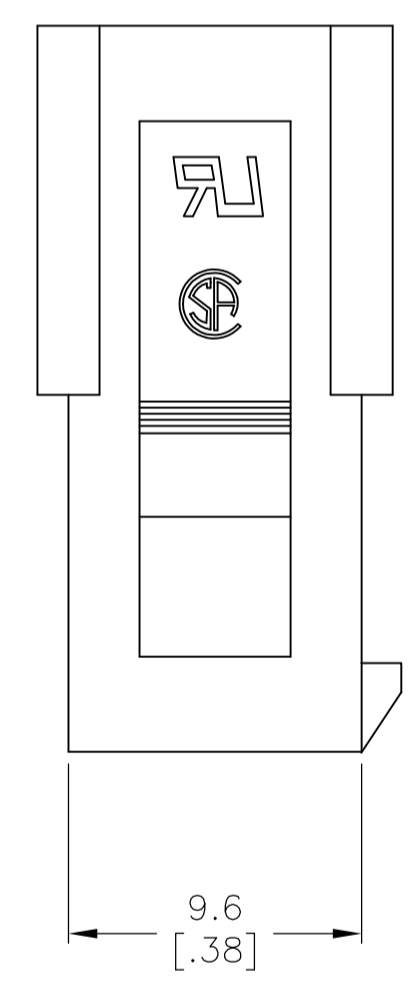
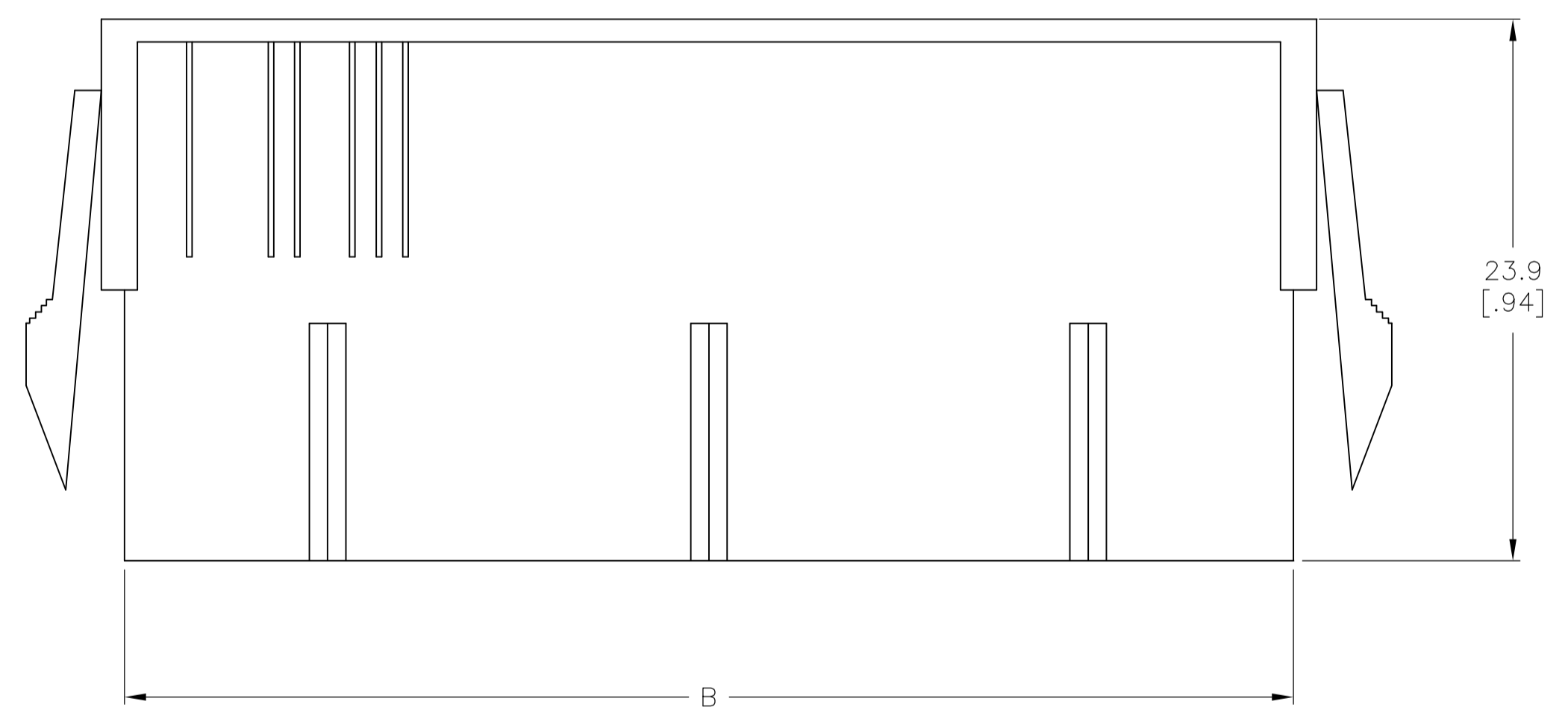
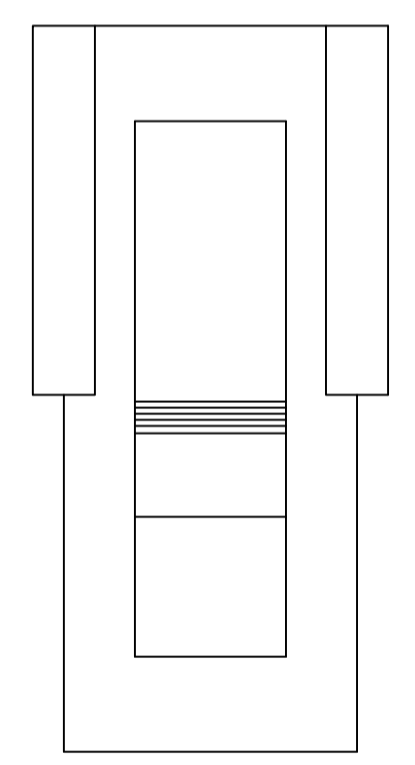

52.00[2.047]	51.60[2.031]	46.2[1.82]	24	2-2029035-4
47.80[1.882]	47.40[1.866]	42.0[1.65]	22	2-2029035-2
43.60[1.717]	43.20[1.701]	37.8[1.49]	20	2-2029035-0
39.40[1.551]	39.00[1.535]	33.6[1.32]	18	1-2029035-8
35.20[1.386]	34.80[1.370]	29.4[1.16]	16	1-2029035-6
31.00[1.220]	30.60[1.205]	25.2[.99]	14	1-2029035-4
26.80[1.055]	26.40[1.039]	21.0[.83]	12	1-2029035-2
22.60[.889]	22.20[.874]	16.8[.66]	10	1-2029035-0
18.40[.724]	18.00[.709]	12.6[.50]	8	2029035-8
14.20[.559]	13.80[.543]	8.4[.33]	6	2029035-6
10.00[.394]	9.60[.378]	4.2[.17]	4	2029035-4
5.80[.223]	5.40[.213]	--	2	2029035-2
DIM C	DIM B	DIM A	POS	PART NUMBER

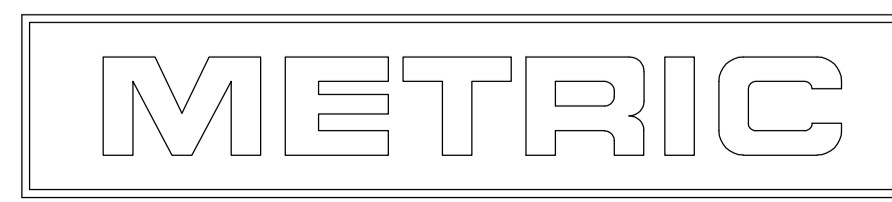

THIS DRAWING IS A CONTROLLED DOCUMENT.

DIMENSIONS: mm [INCHES]	TOLERANCES UNLESS OTHERWISE SPECIFIED: 0 PLC ± 1 PLC ± 0.4 [.02] 2 PLC ± 0.25 [.010] 3 PLC ± 0.150 [.0059] 4 PLC ± ANGLES ±	DWN K. WHITAKER 05FEB2008 CHK C. CASH 05FEB2008 APVD C. CASH 05FEB2008 PRODUCT SPEC APPLICATION SPEC	Tyco Electronics Corporation Harrisburg, PA 17105-3608 NAME PANEL MOUNT PLUG HOUSING, BLACK, VAL-U-LOK(TM)
MATERIAL	FINISH	SIZE A1	RESTRICTED TO
CUSTOMER DRAWING		SCALE 4:1	SHEET 1 OF 1 REV C