



Chipsmall Limited consists of a professional team with an average of over 10 year of expertise in the distribution of electronic components. Based in Hongkong, we have already established firm and mutual-benefit business relationships with customers from,Europe,America and south Asia,supplying obsolete and hard-to-find components to meet their specific needs.

With the principle of “Quality Parts,Customers Priority,Honest Operation,and Considerate Service”,our business mainly focus on the distribution of electronic components. Line cards we deal with include Microchip,ALPS,ROHM,Xilinx,Pulse,ON,Everlight and Freescale. Main products comprise IC,Modules,Potentiometer,IC Socket,Relay,Connector.Our parts cover such applications as commercial,industrial, and automotives areas.

We are looking forward to setting up business relationship with you and hope to provide you with the best service and solution. Let us make a better world for our industry!



Contact us

Tel: +86-755-8981 8866 Fax: +86-755-8427 6832

Email & Skype: info@chipsmall.com Web: www.chipsmall.com

Address: A1208, Overseas Decoration Building, #122 Zhenhua RD., Futian, Shenzhen, China



THIS DRAWING IS UNPUBLISHED. RELEASED FOR PUBLICATION
 © COPYRIGHT - BY TYCO ELECTRONICS CORPORATION. ALL RIGHTS RESERVED.

LOC	DIST	REVISIONS			
P	LTR	DESCRIPTION	DATE	DWN	APVD
H	-	C	ECR-10-009766	07MAY2010	JvH DH

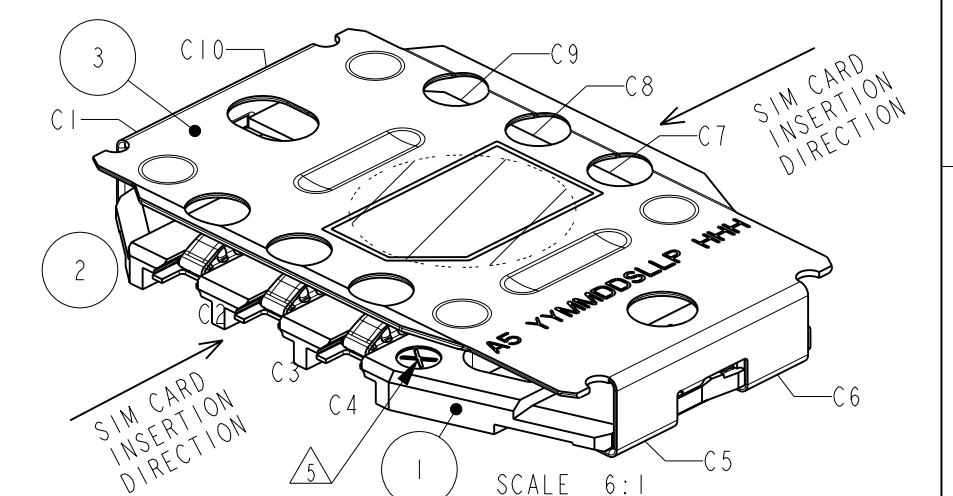
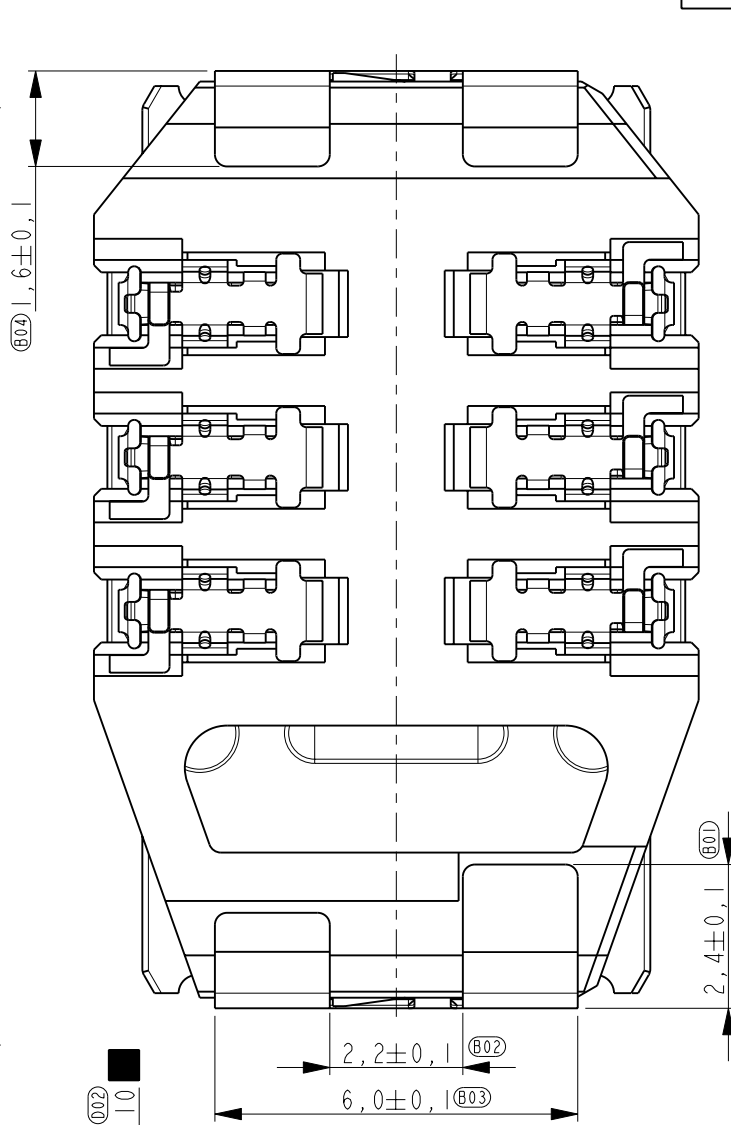
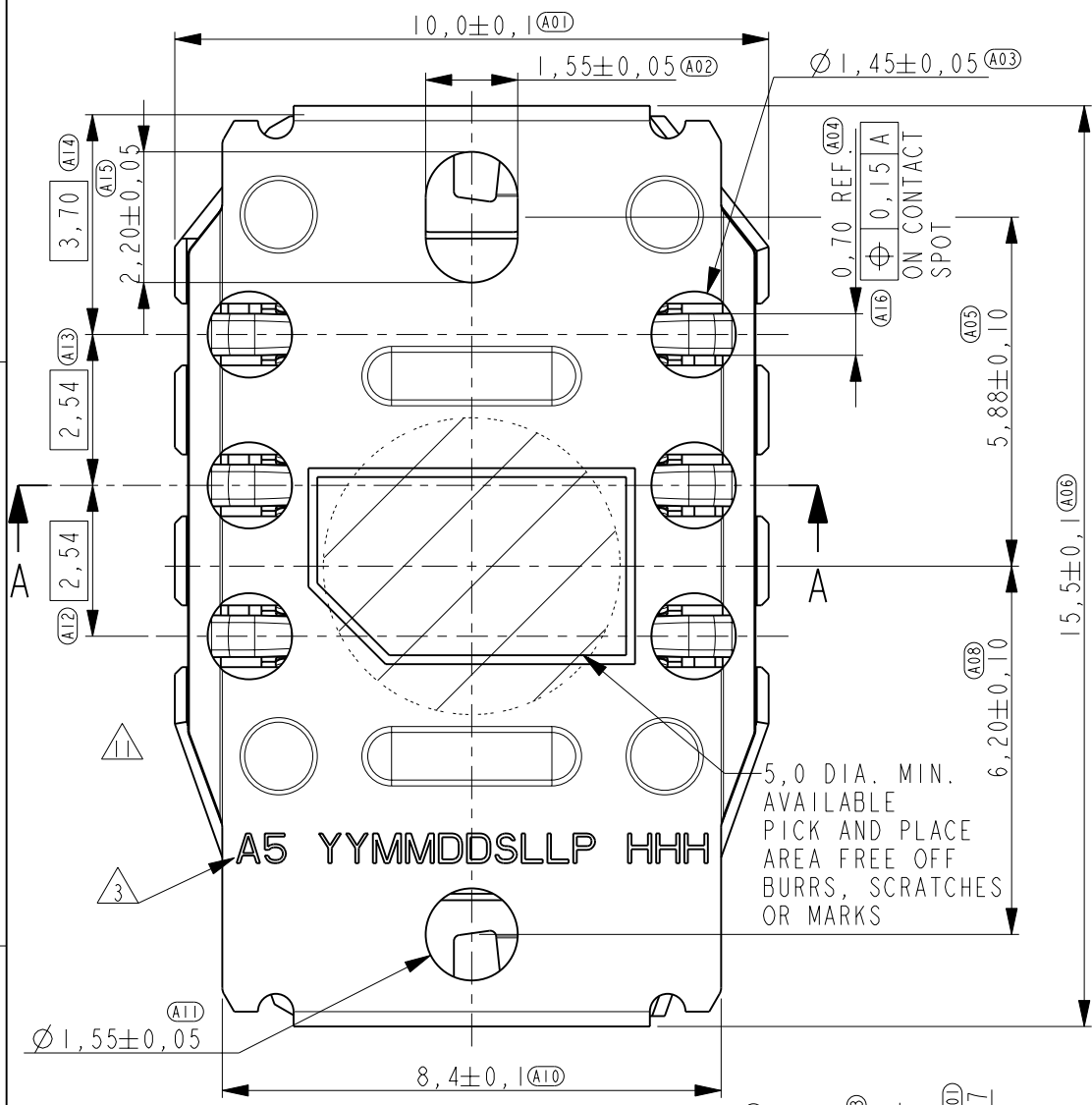

- NOTES:
- 1 CONTACT PLATING:
1,2µm MIN. NICKEL UNDERLAYER.
CARD SIDE: 0,1µm MIN. GOLD OVER 0,3µm MIN. PdNi
SOLDER SIDE 3,0µm MIN. Sn
 - 2 SHIELD PLATING:
1,2µm MIN. NICKEL UNDERLAYER.
SOLDER SIDE: 3,0µm MIN. Sn (AT BOTTOM AND SIDE)
 - 3 VERSION: "A5", PRODUCTION DATE: YMMDD, SHIFT CODE: S,
PRODUCTION LINE NO: LL, LOCATION CODE: P (S=SHANGHAI,
B=BANGALORE), HEIGHT CODE: HHH.
 - 4 FOR PCB LAYOUT SEE SHEET 3.
 - 5 MOULD CAVITY MARKING
 - 6 CONTACT FORCE 0,2N MIN. WHEN COMPRESSED TO THIS HEIGHT
CONTACT FORCE 0,9N MAX. AT MAX. DEFLECTION
 - 7 STAMPING DIRECTION
 - 8 BURR DIRECTION, CHAMFERED EDGE AT SOLDER SIDE AND SIM
CARD INSERTION.
 - 9 CONTACTS LUBRICATED WITH BARRIER LUBRICANT COATING.
 - 10 ■ = CRITICAL DIMENSION WHICH EFFECTS FORM FIT & FUNCTION
 - 11 SIM CARD LOGO LASERMARKED.

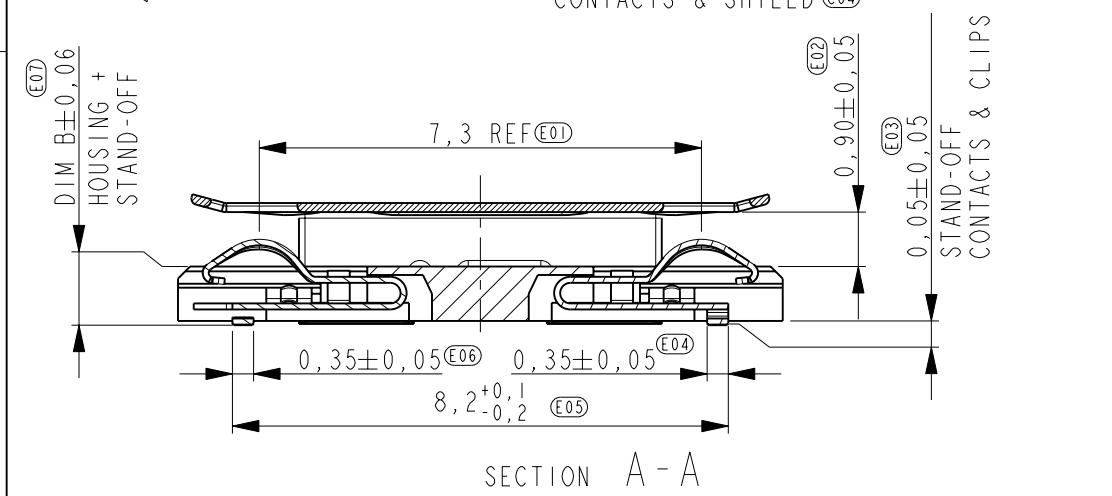
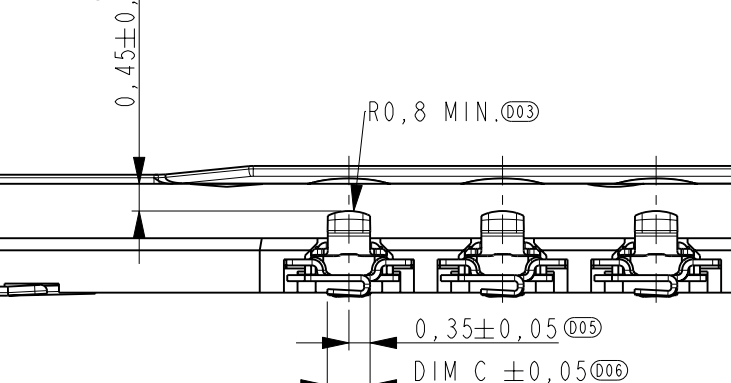
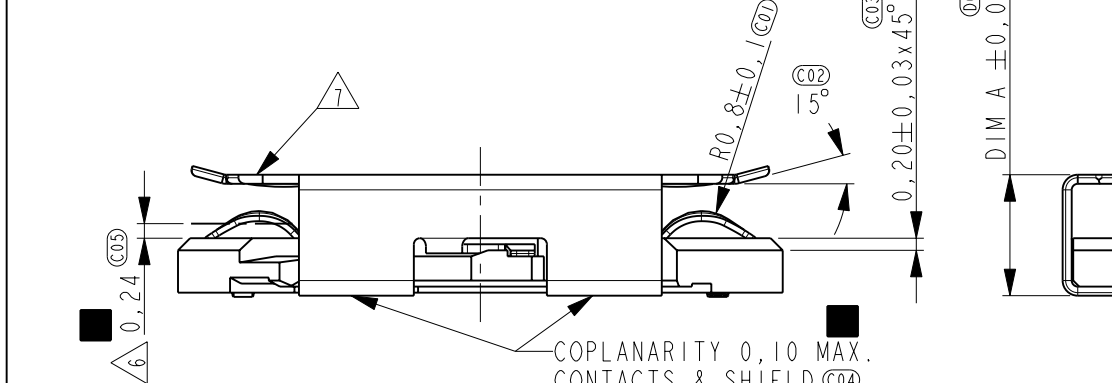

2-2042647-0 AS SHOWN

ITEM NO.	DESCRIPTION	MATERIAL	FINISH
3	SHIELD	STAINLESS STEEL, t=0,15mm	SEE NOTES
2	CONTACT	CuSn6, t=0,10mm	SEE NOTES
1	HOUSING	GF LIQUID CRYSTAL POLYMER	COLOUR BLACK

THIS DRAWING IS A CONTROLLED DOCUMENT FOR TYCO ELECTRONICS CORPORATION IT IS SUBJECT TO CHANGE AND THE CONTROLLING ENGINEERING ORGANIZATION SHOULD BE CONTACTED FOR THE LATEST REVISION.		DWN 26JUN2008 W. Jansen		TYCO ELECTRONICS NEDERLAND B.V. 's-HERTOGENBOSCH, THE NETHERLANDS	
DIMENSIONS: mm		TOLERANCES UNLESS OTHERWISE SPECIFIED: 0 PLC ± 1 PLC ±0,2 2 PLC ±0,1 3 PLC ± 4 PLC ± ANGLES ±2°		NAME SCALABLE SHIELDED SIM 6 positions	
MATERIAL see notes		FINISH see notes		PRODUCT SPEC 108-19368	
WEIGHT see table.[gram]		CUSTOMER DRAWING		SIZE A3 CAGE CODE 00779 DRAWING NO C-2042647 RESTRICTED TO -	
		SCALE 8:1		SHEET 1 OF 3 REV C	

THIS DRAWING IS UNPUBLISHED. RELEASED FOR PUBLICATION
 © COPYRIGHT - BY TYCO ELECTRONICS CORPORATION. ALL RIGHTS RESERVED.

LOC	DIST	REVISIONS					
H	-	P	LTR	DESCRIPTION	DATE	DWN	APVD
				SEE SHEET 1			

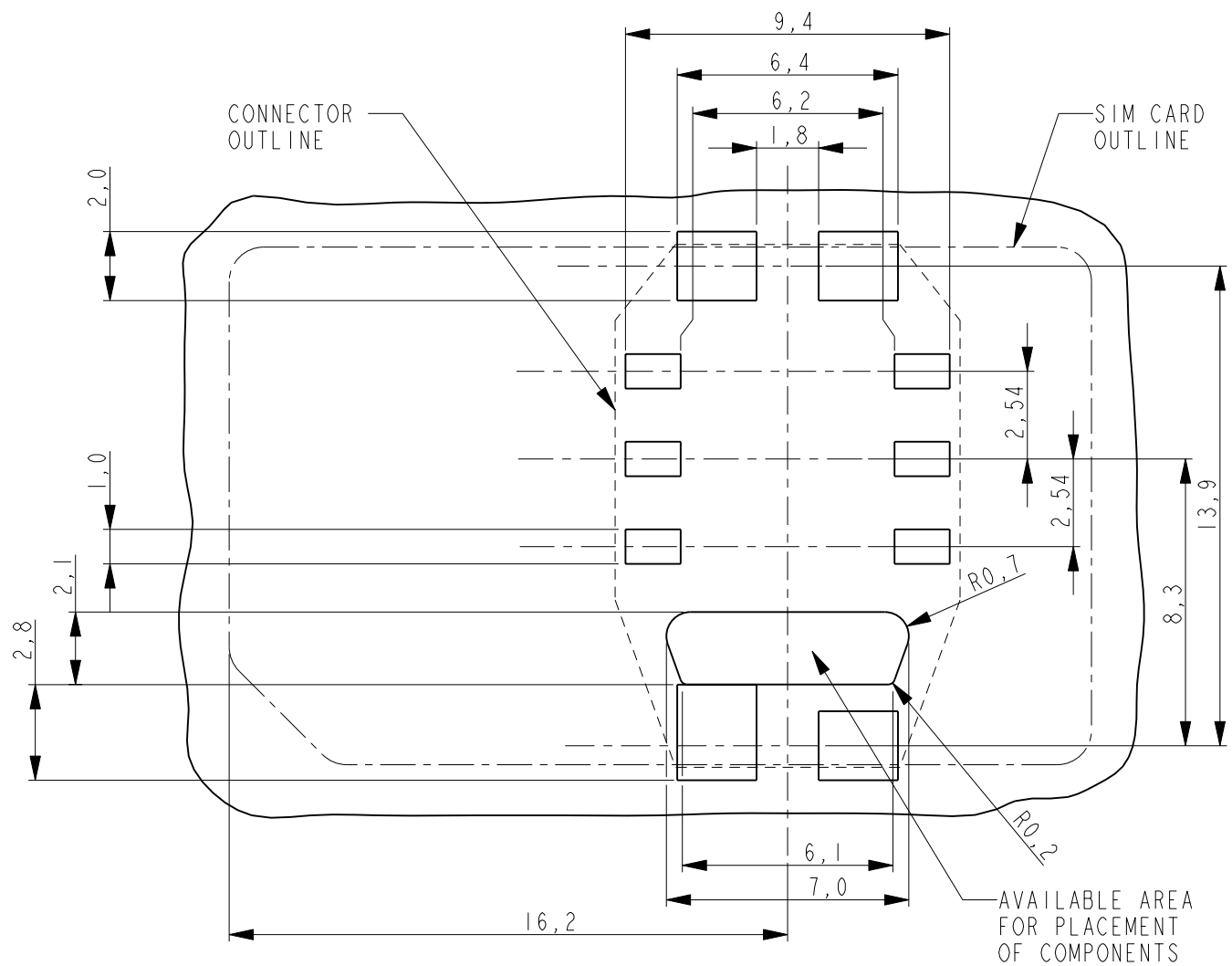

RECOMMENDED PCB LAYOUT (REF.)
SCALE 5:1

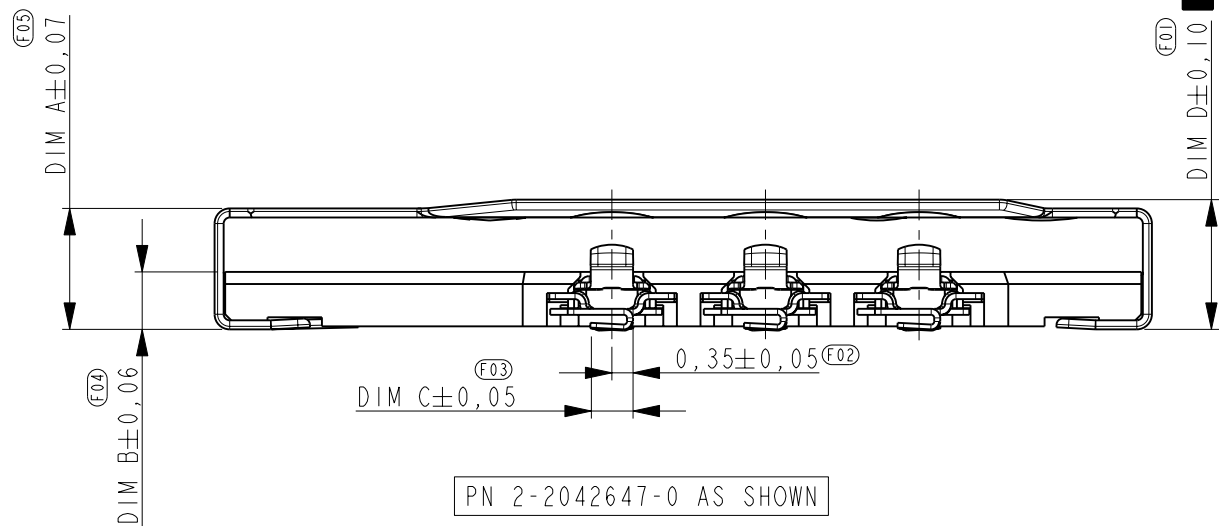

PN 2-2042647-0 AS SHOWN

FORCE-DEFLECTION CURVE

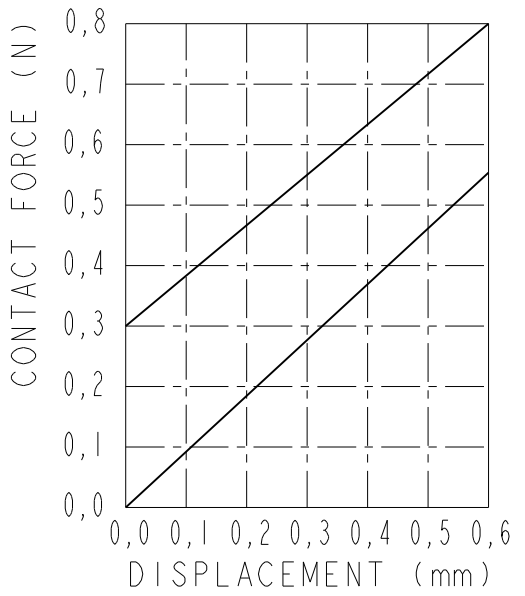

PARTNUMBER	WEIGHT	DIM A	DIM B	DIM C	DIM D
2-2042647-5		2,50	1,45	0,51	2,65
2-2042647-4		2,40	1,35	0,61	2,55
2-2042647-3		2,30	1,25	0,71	2,45
2-2042647-2		2,20	1,15	0,51	2,35
2-2042647-1		2,10	1,05	0,61	2,25
2-2042647-0	0,36	2,00	0,95	0,71	2,15

<small>THIS DRAWING IS A CONTROLLED DOCUMENT FOR TYCO ELECTRONICS CORPORATION IT IS SUBJECT TO CHANGE AND THE CONTROLLING ENGINEERING ORGANIZATION SHOULD BE CONTACTED FOR THE LATEST REVISION.</small>		DWN 26JUN2008 W. Jansen		Tyco Electronics TYCO ELECTRONICS NEDERLAND B.V. 's-HERTOGENBOSCH, THE NETHERLANDS	
DIMENSIONS: mm		TOLERANCES UNLESS OTHERWISE SPECIFIED: 0 PLC ± 1 PLC ±0,2 2 PLC ±0,1 3 PLC ± 4 PLC ± ANGLES ±2°		NAME SCALABLE SHIELDED SIM 6 positions	
MATERIAL see notes		FINISH see notes		PRODUCT SPEC - APPLICATION SPEC - WEIGHT .[gram]	
CUSTOMER DRAWING		SIZE A3 CAGE CODE 00779 DRAWING NO C-2042647		RESTRICTED TO -	
		SCALE 8:1		SHEET 2 OF 3 REV C	

THIS DRAWING IS UNPUBLISHED. RELEASED FOR PUBLICATION
 © COPYRIGHT - BY TYCO ELECTRONICS CORPORATION. ALL RIGHTS RESERVED.

LOC	DIST	REVISIONS					
H	-	P	LTR	DESCRIPTION	DATE	DWN	APVD
			-	SEE SHEET 1			

USER DIRECTION OF UNREELING

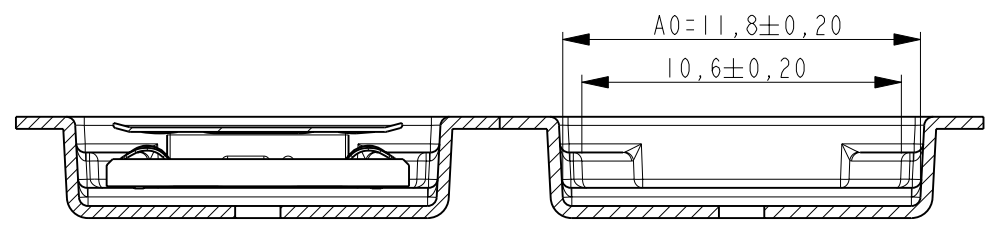
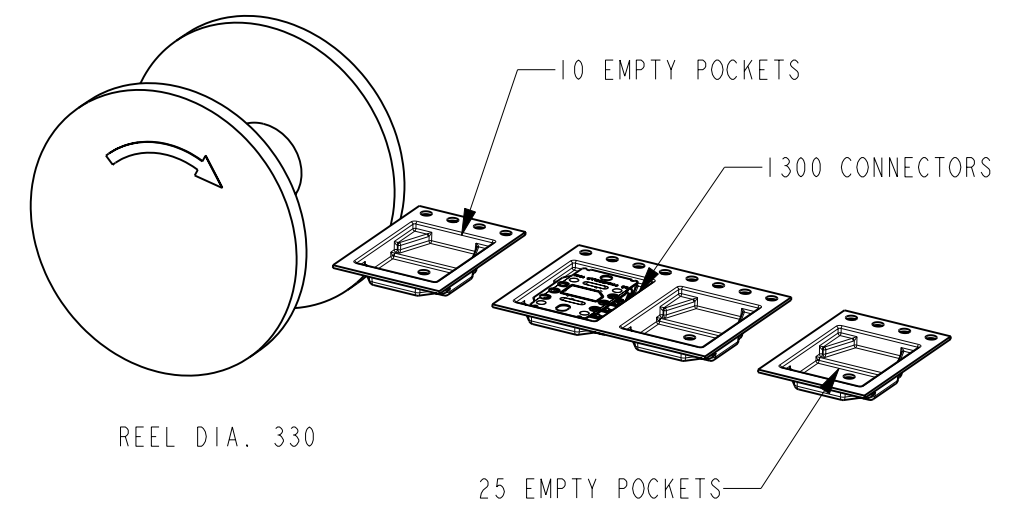
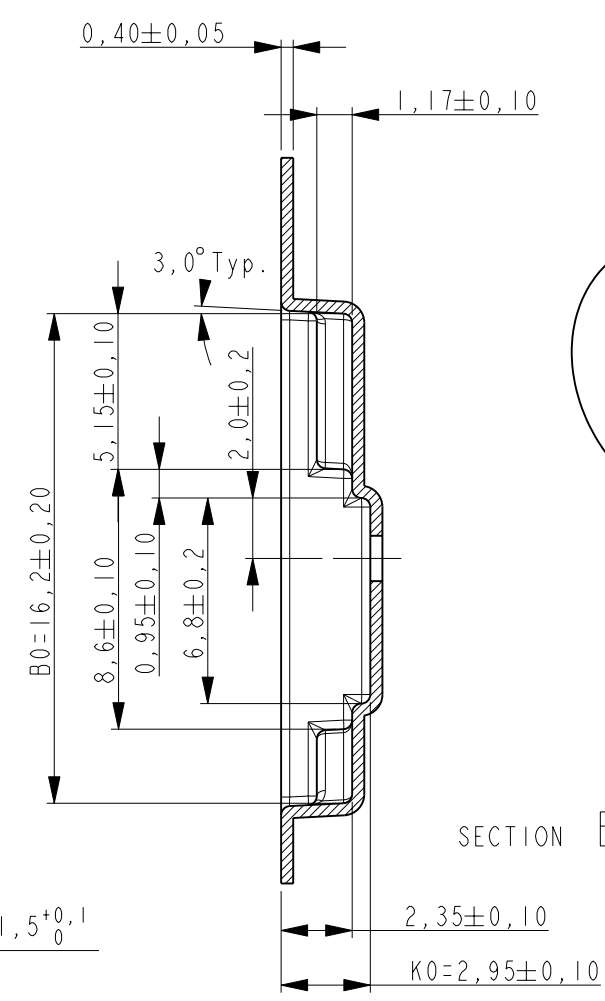
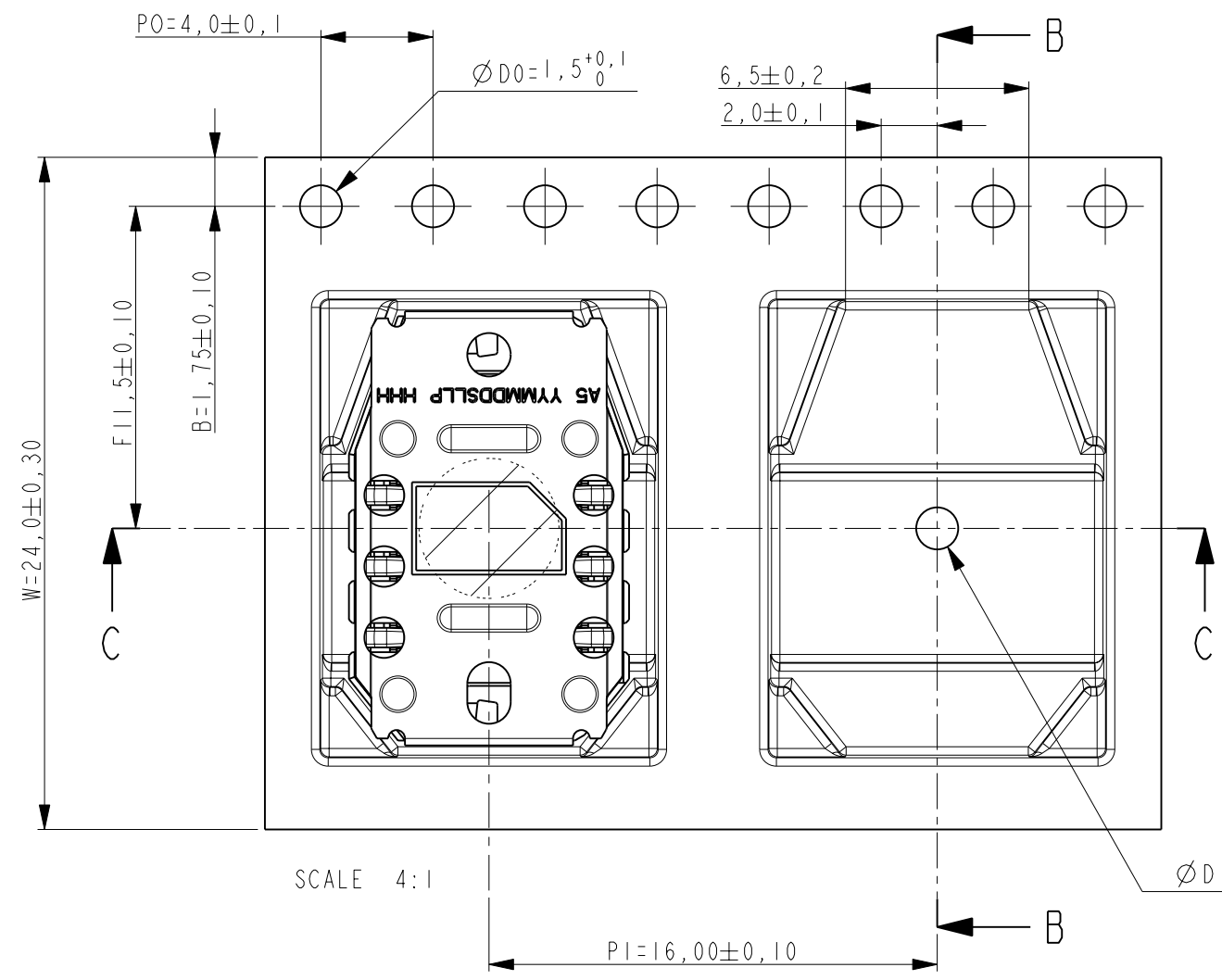

EIA TAPE FOR PN 2-2042647-0

NOTES:
 ANTI-STATIC COVER, EMBOSS TAPE AND REEL ACCORDING EIA STANDARD 481-B
 ELECTROSTATIC REQUIREMENTS:
 -SURFACE RESISTANCE: 1MΩ/SQUARE < R_s < 10GΩ/SQUARE

<small>THIS DRAWING IS A CONTROLLED DOCUMENT FOR TYCO ELECTRONICS CORPORATION IT IS SUBJECT TO CHANGE AND THE CONTROLLING ENGINEERING ORGANIZATION SHOULD BE CONTACTED FOR THE LATEST REVISION.</small>		DWN 26JUN2008 W. Jansen		TYCO ELECTRONICS NEDERLAND B.V. 's-HERTOGENBOSCH, THE NETHERLANDS	
DIMENSIONS: mm		TOLERANCES UNLESS OTHERWISE SPECIFIED: 0 PLC ± 1 PLC ±0,2 2 PLC ±0,1 3 PLC ± 4 PLC ± ANGLES ±2°		NAME SCALABLE SHIELDED SIM 6 positions	
MATERIAL see notes		FINISH see notes		PRODUCT SPEC APPLICATION SPEC WEIGHT . [gram]	
		CUSTOMER DRAWING		SIZE A3 CAGE CODE 00779 DRAWING NO. C=2042647 RESTRICTED TO -	
				SCALE 8:1 SHEET 3 OF 3 REV C	