



Chipsmall Limited consists of a professional team with an average of over 10 year of expertise in the distribution of electronic components. Based in Hongkong, we have already established firm and mutual-benefit business relationships with customers from,Europe,America and south Asia,supplying obsolete and hard-to-find components to meet their specific needs.

With the principle of “Quality Parts,Customers Priority,Honest Operation,and Considerate Service”,our business mainly focus on the distribution of electronic components. Line cards we deal with include Microchip,ALPS,ROHM,Xilinx,Pulse,ON,Everlight and Freescale. Main products comprise IC,Modules,Potentiometer,IC Socket,Relay,Connector.Our parts cover such applications as commercial,industrial, and automotives areas.

We are looking forward to setting up business relationship with you and hope to provide you with the best service and solution. Let us make a better world for our industry!



Contact us

Tel: +86-755-8981 8866 Fax: +86-755-8427 6832

Email & Skype: info@chipsmall.com Web: www.chipsmall.com

Address: A1208, Overseas Decoration Building, #122 Zhenhua RD., Futian, Shenzhen, China



LOC	DIST	REVISIONS				
G	02	P	LTR	DESCRIPTION	DATE	APVD
			M1	REVISED PER ECR-09-026553	04DEC09	JR

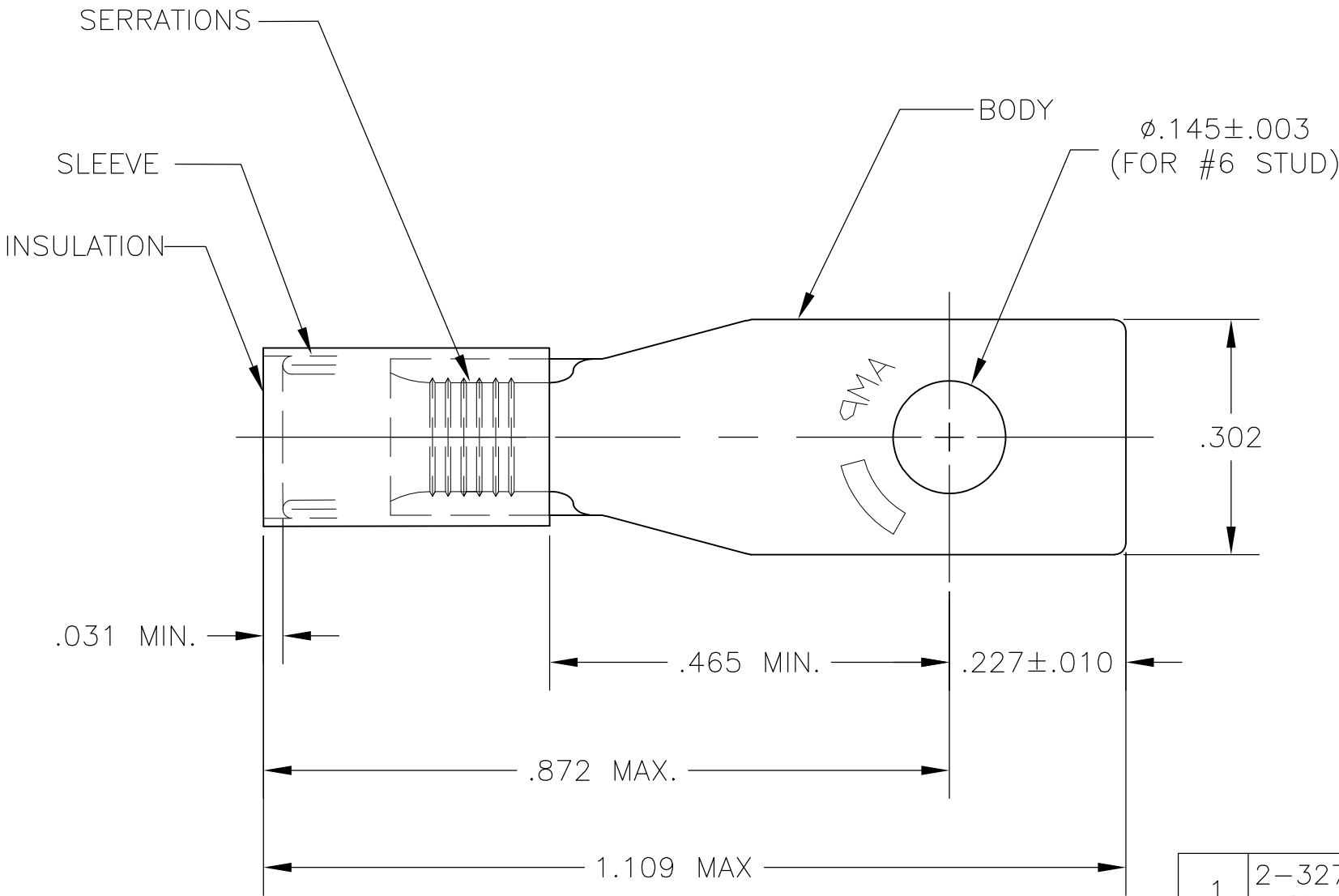

- 1
- SUPERSEDED BY 2-327958-4
- 2
- TONGUE MATERIAL THK=.031±.002
FOR "A" TO "B" WIRE INS. DIA
- 3
- OBSOLETE PART NUMBER.
- 4
- MEETS MS17143-5, CLASS 1 & 2

OBSOLETE

1	2-327940-1 ON TAPE	2-327940-3	INSULATION: NYLON(MIL-M-20693) TYPE I COLOUR: BLUE BODY&SLEEVE: COPPER (QQ-C-576) TIN PL (MIL-T-10727)
1	WIRE TERMINAL	2-327940-1	
1	2-327940-4 ON TAPE	2-327940-5	INSULATION: NYLON COLOUR: BLUE SLEEVE: COPPER (QQ-C-576) BODY: COPPER (QQ-C-576) TIN PL (MIL-T-10727)
1	WIRE TERMINAL	2-327940-4	
1	327940 ON TAPE	2-327940-2	
1	WIRE TERMINAL	327940	
QTY	DESCRIPTION	PART NO	MATERIAL & FINISH

2-327940-4	2-327940-5	.105	.150	1	4
2-327940-1	2-327940-3	.115	.170	3	
327940	2-327940-2	.115	.170	3	
PART NO	PART # ON TAPE	"A"	"B"		

THIS DRAWING IS A CONTROLLED DOCUMENT.

DIMENSIONS:
INCHES

TOLERANCES UNLESS
OTHERWISE SPECIFIED:

0 PLC ± -
1 PLC ± -
2 PLC ± .008
3 PLC ± -
4 PLC ± -
ANGLES ± 5°

MATERIAL
SEE TABLE

FINISH
SEE TABLE

DWN
RAGHAVENDRA HM
09JUN08

CHK
T MICHIELUTTI
09JUN08

APVD
T MICHIELUTTI
09JUN08

PRODUCT SPEC
—

APPLICATION SPEC
—

WEIGHT
—

Tyco Electronics Corporation
Harrisburg, PA 17105-3608

NAME
WIRE TERMINAL, PIDG,
RECTANGULAR TONGUE WIRE SIZE : 16-14
—

SIZE
A3

CAGE CODE
00779

DRAWING NO
C-327940

RESTRICTED TO
—

CUSTOMER DRAWING

SCALE
5:1

SHEET
1 OF 1

REV
M1