



Chipsmall Limited consists of a professional team with an average of over 10 year of expertise in the distribution of electronic components. Based in Hongkong, we have already established firm and mutual-benefit business relationships with customers from,Europe,America and south Asia,supplying obsolete and hard-to-find components to meet their specific needs.

With the principle of “Quality Parts,Customers Priority,Honest Operation,and Considerate Service”,our business mainly focus on the distribution of electronic components. Line cards we deal with include Microchip,ALPS,ROHM,Xilinx,Pulse,ON,Everlight and Freescale. Main products comprise IC,Modules,Potentiometer,IC Socket,Relay,Connector.Our parts cover such applications as commercial,industrial, and automotives areas.

We are looking forward to setting up business relationship with you and hope to provide you with the best service and solution. Let us make a better world for our industry!



Contact us

Tel: +86-755-8981 8866 Fax: +86-755-8427 6832

Email & Skype: info@chipsmall.com Web: www.chipsmall.com

Address: A1208, Overseas Decoration Building, #122 Zhenhua RD., Futian, Shenzhen, China



LOC	DIST	REVISIONS				
		REV	DESCRIPTION	DATE	BY	APPV
HM	00	G1	REVISED PER ECO-11-005033	21MAR11	RK	HMR
		G2	ADD 1/3, REV ECO-11-011931	10JUN2011	LH	SA

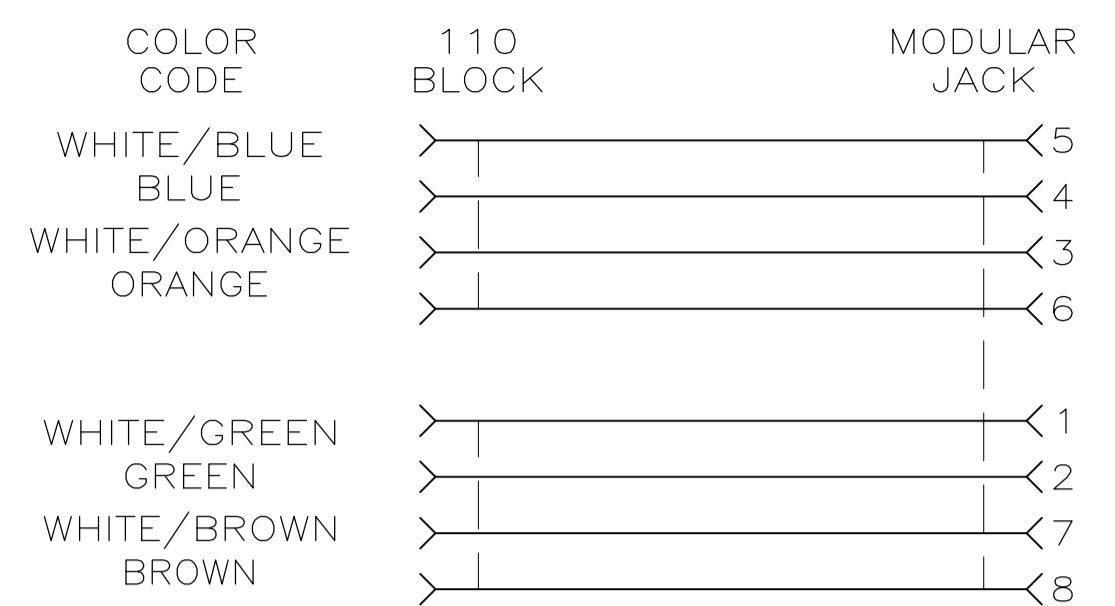

ELECTRICAL SCHEMATIC T568A

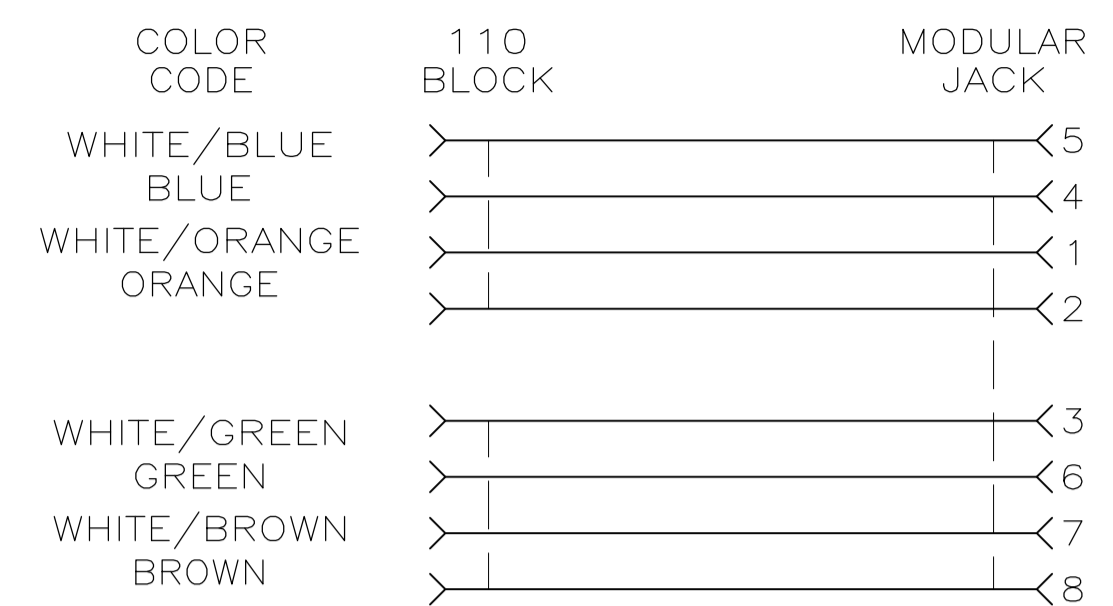

ELECTRICAL SCHEMATIC T568B

- ⚠ MATERIAL: HOUSING - POLYCARBONATE, 94V-0 RATED. SEE TABLE FOR COLOR. JACK CONTACTS - PHOSPHOROUS BRONZE, PLATED WITH 1.27μm [.000050] MINIMUM THICK GOLD IN LOCALIZED AREA AND 3.81μm [.000150] MINIMUM THICK MATTE TIN IN SOLDER AREA OVER 1.27μm [.000050] MINIMUM THICK NICKEL UNDERPLATE.
- 2. 110 BLOCK WILL TERMINATE 22-26 AWG SOLID OR 7 STRAND CONDUCTORS, 1.27 [.050] MAXIMUM INSULATION DIAMETER.
- 3. MOUNTING PANEL THICKNESS 1.473 - 1.600 [.058 - .063].
- ⚠ ONE MODULAR JACK ASSEMBLY PER POLYBAG.
- ⚠ CAVITY CONFORMS TO FCC RULES AND REGULATIONS PART 68 SUBPART F REQUIREMENTS.
- ⚠ THESE TWO SUGGESTED CUTOUT OPENINGS ARE USED IN TANDEM WITH DUAL FRONT AND BACK CUTOUTS.
- ⚠ TWENTY FIVE MODULAR JACK ASSEMBLIES PER POLYBAG.

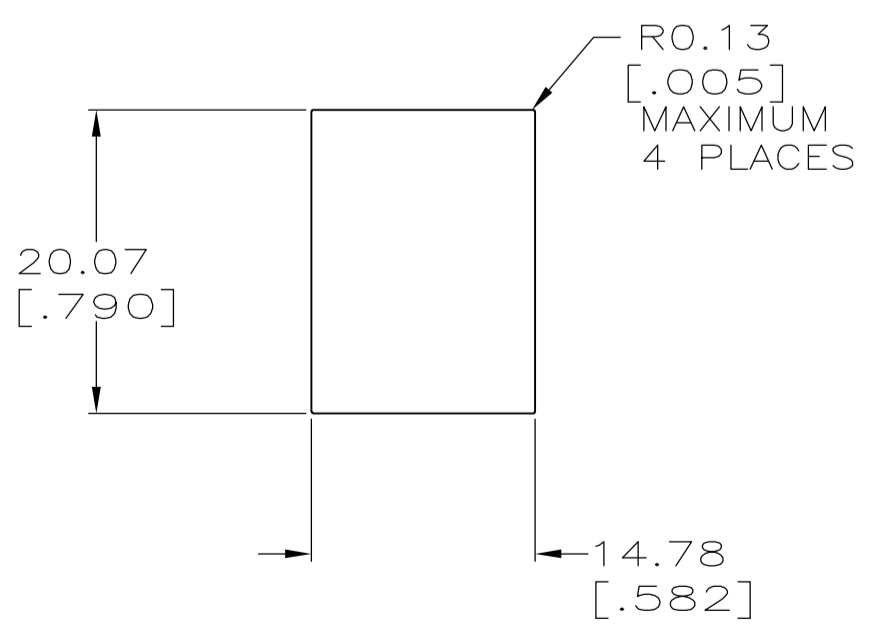
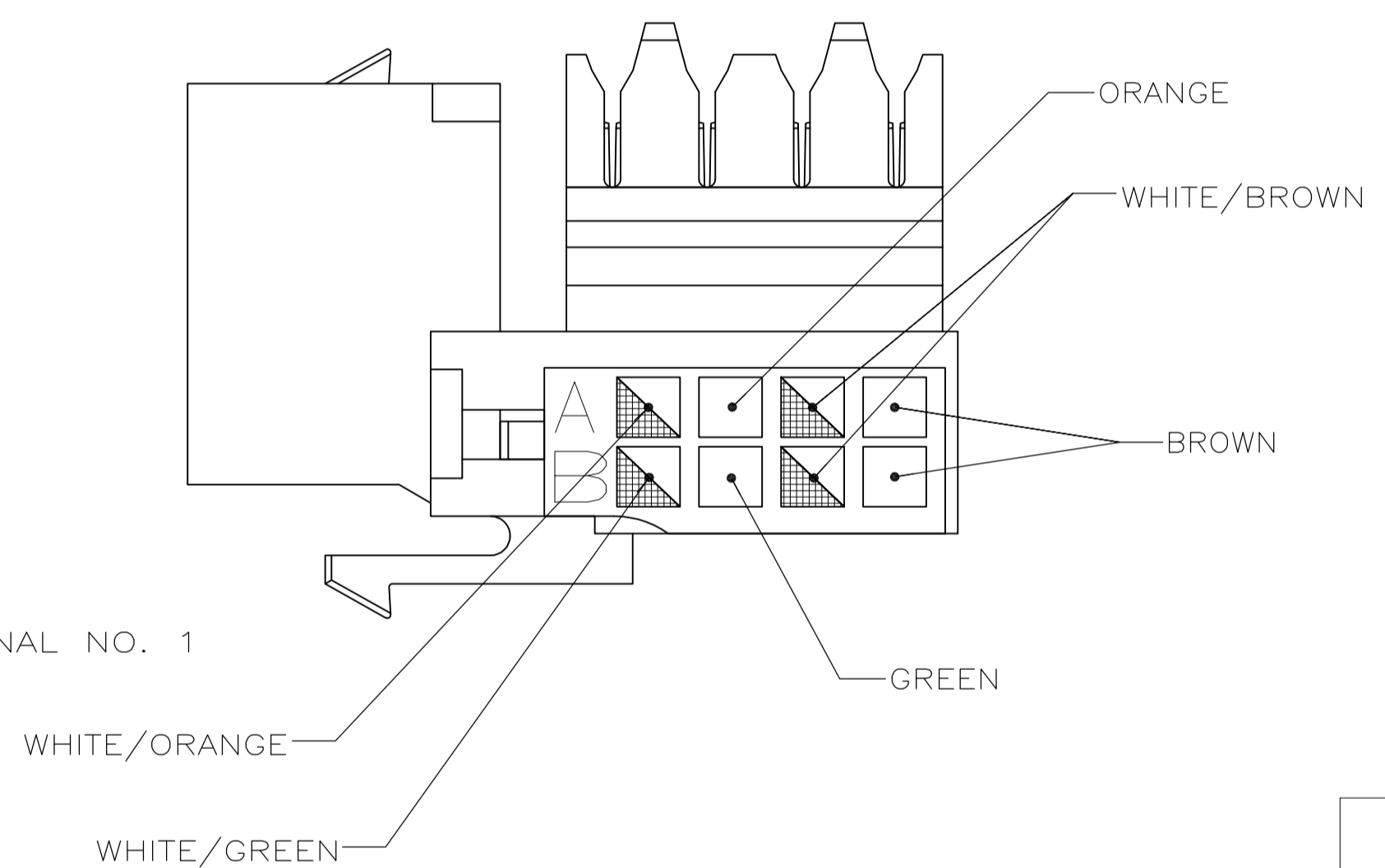
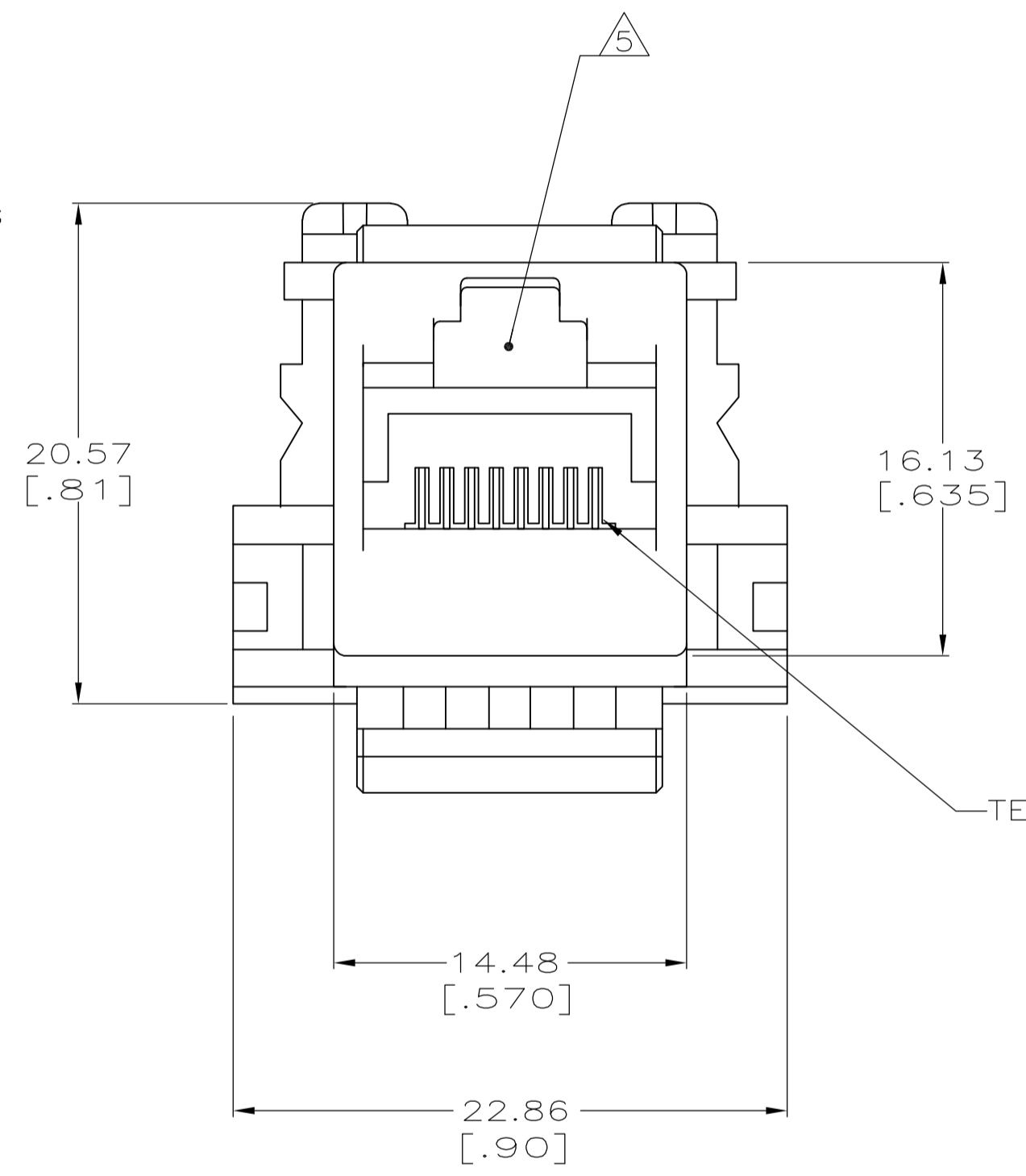
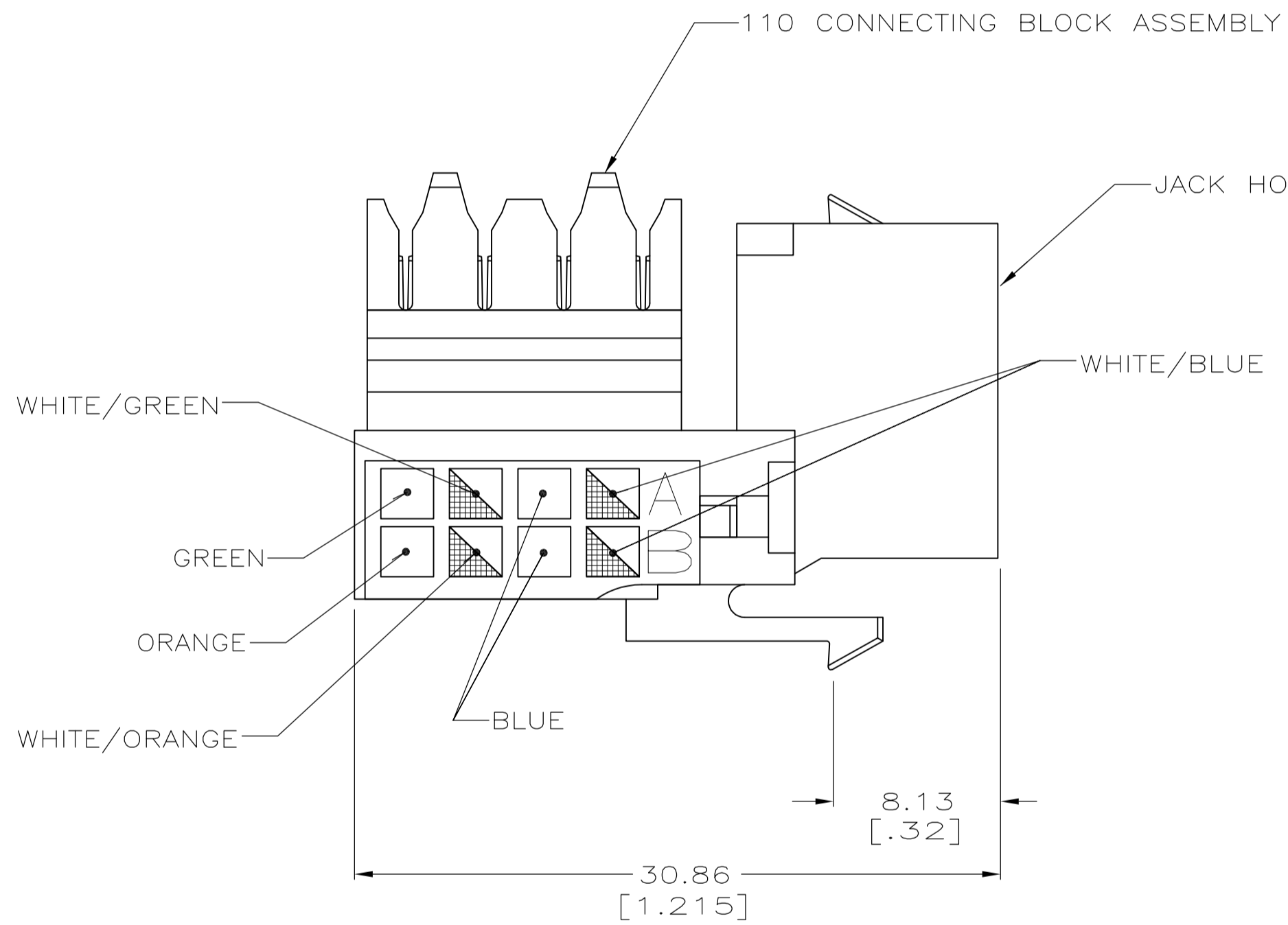

SUGGESTED SINGLE PANEL CUTOUT SCALE 2:1

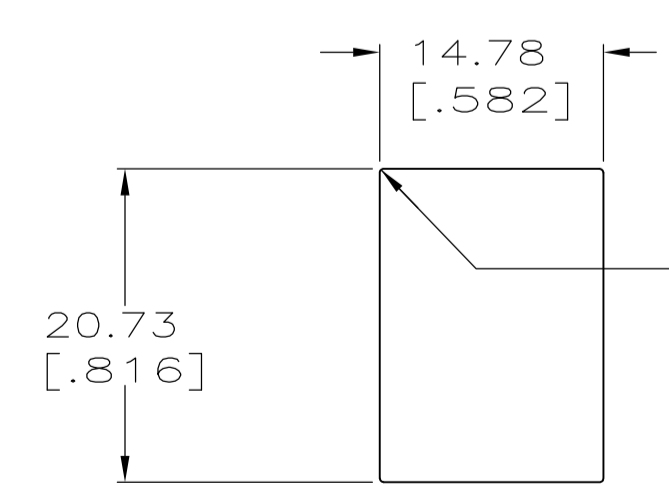

SUGGESTED BACK PANEL CUTOUT SCALE 2:1

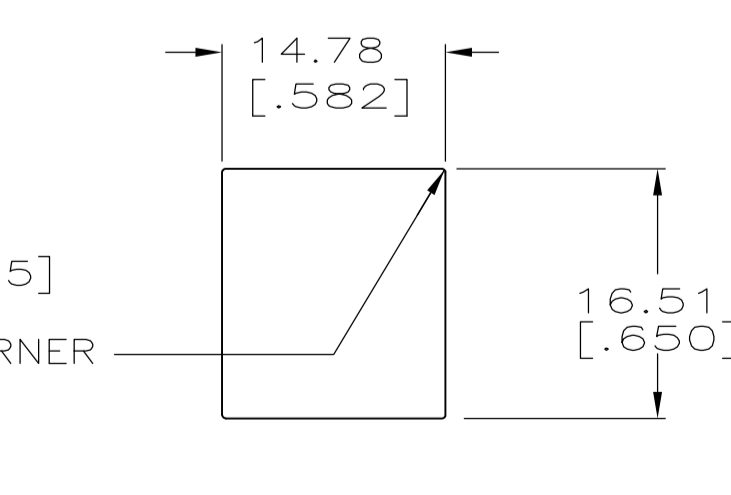

SUGGESTED FRONT PANEL CUTOUT SCALE 2:1

PACKAGED	HOUSING COLOR	PART NUMBER
⚠	ALPINE WHITE	3-406372-3
	ELECTRIC IVORY	3-406372-1
	VIOLET	3-406372-0
	GREEN	2-406372-9
	YELLOW	2-406372-8
	RED	2-406372-7
	BLUE	2-406372-6
	ORANGE	2-406372-5
	NEMA GRAY	2-406372-4
	WHITE	2-406372-3
⚠	BLACK	2-406372-2
	LIGHT ALMOND	2-406372-1
	ALPINE WHITE	1-406372-3
	ELECTRIC IVORY	1-406372-1
	VIOLET	1-406372-0
	GREEN	406372-9
	YELLOW	406372-8
	RED	406372-7
	BLUE	406372-6
	ORANGE	406372-5
NEMA GRAY	406372-4	
WHITE	406372-3	
BLACK	406372-2	
LIGHT ALMOND	406372-1	

THIS DRAWING IS A CONTROLLED DOCUMENT.

DL DRUMMOND 25 NOV 96
T WOOTEN 09 JAN 97
G ROWMAN 09 JAN 97

APPROVED BY: G. ROWMAN

NAME: 110 MODULAR JACK ASSEMBLY, RJ45, ENHANCED CAT5, UNIVERSAL

PRODUCT SPEC: 108-1389

APPLICATION SPEC: 408-3389

SIZE: A1

SCALE: 4:1

SHEET: 1 OF 1

REV: G2

STE TE Connectivity