



Chipsmall Limited consists of a professional team with an average of over 10 year of expertise in the distribution of electronic components. Based in Hongkong, we have already established firm and mutual-benefit business relationships with customers from,Europe,America and south Asia,supplying obsolete and hard-to-find components to meet their specific needs.

With the principle of "Quality Parts,Customers Priority,Honest Operation,and Considerate Service",our business mainly focus on the distribution of electronic components. Line cards we deal with include Microchip,ALPS,ROHM,Xilinx,Pulse,ON,Everlight and Freescale. Main products comprise IC,Modules,Potentiometer,IC Socket,Relay,Connector.Our parts cover such applications as commercial,industrial, and automotives areas.

We are looking forward to setting up business relationship with you and hope to provide you with the best service and solution. Let us make a better world for our industry!



## Contact us

Tel: +86-755-8981 8866 Fax: +86-755-8427 6832

Email & Skype: info@chipsmall.com Web: www.chipsmall.com

Address: A1208, Overseas Decoration Building, #122 Zhenhua RD., Futian, Shenzhen, China



LOC	DIST	REV	DATE	BY	APPV
-	-	U	6-13-13	CT	DM

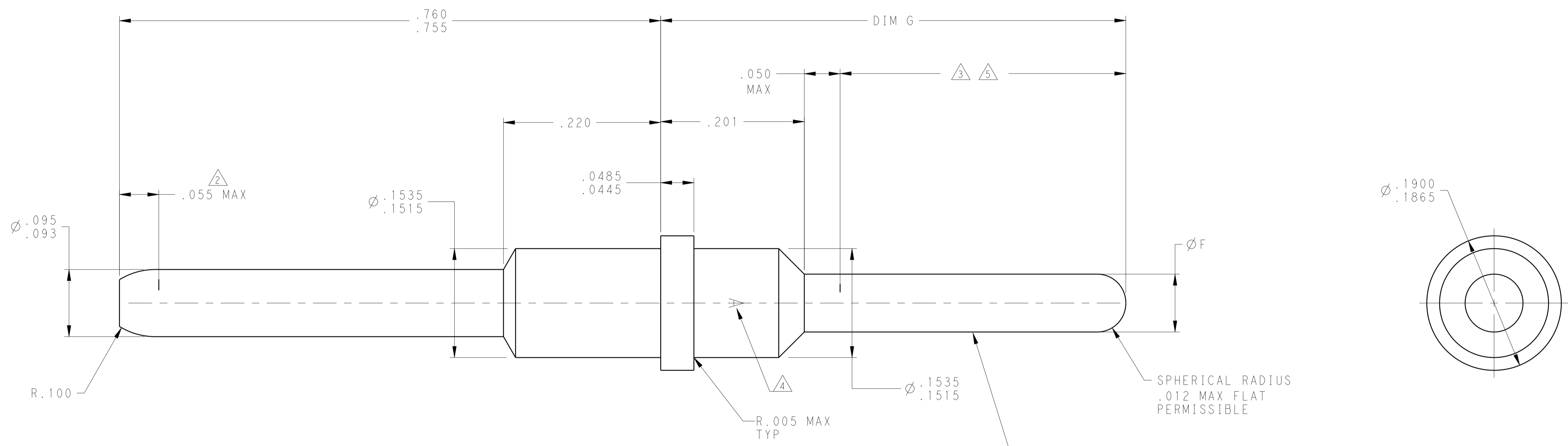

MAT'L: COPPER ALLOY PER ASTM-B-301  
 FINISH: GOLD PLATED .000050 MIN THK  
 PER ASTM-B-488 OVER NICKEL PLATE  
 .000050 MIN THK PER AMS-QQ-N-290

REMARKS	DIM G	DIM F	PART NUMBER
--	.776	.079-.083	3-448140-0
3	.617±.010	.087 MAX	2-448140-7
--	.576	.079-.083	2-448140-6
3 5	.617	.087 MAX	2-448140-3
--	.606	.079-.083	2-448140-2
3	.651	.087 MAX	1-448140-9
--	.505	.079-.083	1-448140-8
--	.617	.079-.083	1-448140-5
--	.404	.079-.083	1-448140-2
3	.536	.087 MAX	448140-9
--	.415	.079-.083	448140-8
--	.651	.079-.083	448140-6
--	.536	.079-.083	448140-3
--	.536	.079-.083	448140-2

2 COLOR CODE: AS SHOWN IN APPROXIMATE LOCATION SHOWN.  
 3 THE YELLOW BAND SHALL BE APPROXIMATELY TWICE THE WIDTH OF THE ORANGE BAND.

- 2 ELECTRICAL ENGAGEMENT POINT.
- 3 THIS AREA SOLDER DIPPED.
- 4 MANUFACTURERS LOGO; LACATION & ORIENTATION OPTIONAL.
- 5 SOLDER IS RoHS-COMPLIANT Sn.

THIS DRAWING IS A CONTROLLED DOCUMENT. DWN: C.C. THOMAS 27OCT2009  
 CHK: K. THACKSTON 27OCT2009  
 APVD: K. THACKSTON 27OCT2009

**STE** TE Connectivity

NAME: POSTED PIN CONTACT, SIZE 12, ARINC 600

SIZE: A1 CAGE CODE: 448140 DRAWING NO: 100779

MATERIAL: SEE CALLOUTS FINISH: SEE CALLOUTS WEIGHT: - SCALE: 12:1 SHEET 1 OF 1 REV U