



Chipsmall Limited consists of a professional team with an average of over 10 year of expertise in the distribution of electronic components. Based in Hongkong, we have already established firm and mutual-benefit business relationships with customers from,Europe,America and south Asia,supplying obsolete and hard-to-find components to meet their specific needs.

With the principle of “Quality Parts,Customers Priority,Honest Operation,and Considerate Service”,our business mainly focus on the distribution of electronic components. Line cards we deal with include Microchip,ALPS,ROHM,Xilinx,Pulse,ON,Everlight and Freescale. Main products comprise IC,Modules,Potentiometer,IC Socket,Relay,Connector.Our parts cover such applications as commercial,industrial, and automotives areas.

We are looking forward to setting up business relationship with you and hope to provide you with the best service and solution. Let us make a better world for our industry!



## Contact us

Tel: +86-755-8981 8866 Fax: +86-755-8427 6832

Email & Skype: info@chipsmall.com Web: www.chipsmall.com

Address: A1208, Overseas Decoration Building, #122 Zhenhua RD., Futian, Shenzhen, China



Detail A  
Scale 5:1

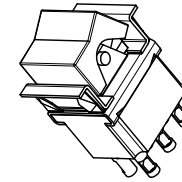
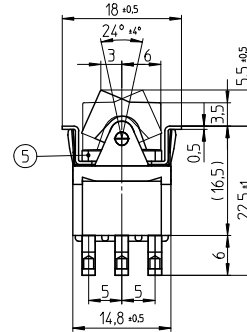
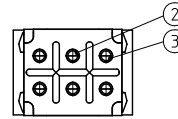
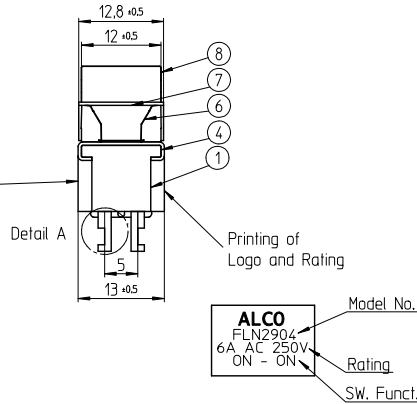
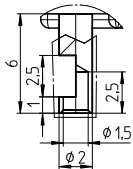

Function Chart

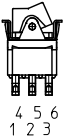
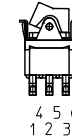

TE PN	Button	Part	Terminals 1 and 2 4 and 5	Terminals 2 and 3 5 and 6
2-6437630-3	white	FLN2904	ON	ON
2-6437630-5	black	FLN2904	ON	ON
4-6437630-7	red	FLN2904	ON	ON

THIS INFORMATION IS CONFIDENTIAL AND PROPRIETARY TO TYCO ELECTRONICS AUSTRIA GMBH AND ITS WORLDWIDE SUBSIDIARIES AND AFFILIATES. IT MAY NOT BE DISCLOSED TO ANYONE OTHER THAN TYCO ELECTRONICS AUSTRIA GMBH WITHOUT WRITTEN AUTHORIZATION FROM TYCO ELECTRONICS AUSTRIA.

Specifications						
TE PN	Part	Rating	Initial Contact Resistance	Insulation Resistance	Dielectric Strength	Endurance
2-6437630-3 2-6437630-5 4-6437630-7	FLN2904	AC 125V 6A AC 250V 6A	MAX 10 milliohms at DC 2 ~ 4V 1A	MIN 1000 M Ohms at DC 500V	AC 1kV/1min (AC 1.2kV/1sec)	electrically 50,000 cycles at 20 cycles/minutes (rated load resistive) mechanically 100,000 cycles at 20 cycles/minutes

Materials Chart			
1	Case	Polyester Resin	Black
2	Common	C3602BD	Ep-Cu/Ni 3,Au F b
3	Fixed contact	C3602BD+Ag	Ep-Cu/Ni 3,Au F b
4	Frame	SUS	
5	Mounting Sleeve	C3602BD	Ep-Cu/Ni 3 b
6	Leaf spring	SUS	
7	Plate	SUS	
8	Button	Nylon Resin	
PART NO:		PART NAME:	
PART LIST		MATERIAL SURFACE:	
TOLERANCES UNLESS OTHERWISE SPECIFIED ACCORDING TO ISO 8015 and ISO 2768-F		DIMENSIONS: mm	
<small>test dimen. / Prüfmaß: □, auxiliary dimen. / Hilfsmaß: ( ), theor. dimen. / theor. Maß: □, production control dimen. / Fertigungskontrollmaß: [ ], dimen. for measure, technology / messtechn. ret. Maß: [ ]</small>			
DEPARTMENT		D/E	
DRAWER		04.012007 SA00874	
CHECKED			
APPROVED			
ECR-NO:	DATE	NAME	INFO
SCALE:	NAME:	DWG NO:	
<p style="text-align: center;"><b>Rocker Switch Double pole</b></p> <p style="text-align: center;">Small Rocker</p>			<p style="text-align: center;">©=1968519</p> <p style="text-align: center;">OPTIONAL NO: Customer Drawing</p>
REPLACEMENT FOR:		DWG LOC NO: F	SHEET: 1 OF 1
		REVISION:	A