



Chipsmall Limited consists of a professional team with an average of over 10 year of expertise in the distribution of electronic components. Based in Hongkong, we have already established firm and mutual-benefit business relationships with customers from,Europe,America and south Asia,supplying obsolete and hard-to-find components to meet their specific needs.

With the principle of “Quality Parts,Customers Priority,Honest Operation,and Considerate Service”,our business mainly focus on the distribution of electronic components. Line cards we deal with include Microchip,ALPS,ROHM,Xilinx,Pulse,ON,Everlight and Freescale. Main products comprise IC,Modules,Potentiometer,IC Socket,Relay,Connector.Our parts cover such applications as commercial,industrial, and automotives areas.

We are looking forward to setting up business relationship with you and hope to provide you with the best service and solution. Let us make a better world for our industry!



Contact us

Tel: +86-755-8981 8866 Fax: +86-755-8427 6832

Email & Skype: info@chipsmall.com Web: www.chipsmall.com

Address: A1208, Overseas Decoration Building, #122 Zhenhua RD., Futian, Shenzhen, China



LOC	DIST	REV	LTN	DESCRIPTION	DATE	DMN	APVD
-	-	D		REV PER ECO 12-014265	8-7-12	CT	DH
-	-	F		ECO-13-004755	26MAR2013	KG	DH

- 1 MATERIAL:
CONTACT - COPPER ALLOY
HOUSING - LCP, COLOR - BLACK
- 2 FINISH:
MATING AREA: 1.27µm MIN GOLD OVER
1.25µm MIN NICKEL
- 3 DATUMS AND BASIC DIMENSIONS ESTABLISHED BY CUSTOMER.
- 4 REFERENCE APPLICATION SPEC 114-13267 FOR RECOMMENDED
PLATING THRU HOLE DIAMETER AND PLATING THICKNESSES.
- 5 FINISH:
COMPLIANT PIN AREA: 0.38µm MIN BRIGHT TIN LEAD OVER
1.27µm MIN NICKEL
- 6 FINISH:
COMPLIANT PIN AREA: 0.38µm MIN MATTE TIN OVER
1.27µm MIN NICKEL
- 7 FINISH:
COMPLIANT PIN AREA: 0.38µm MIN GOLD OVER
1.27µm MIN NICKEL

4
 $\oplus \text{ } \varnothing 0.05 \text{ } \ominus \text{ } X \text{ } Y$
 FINISHED HOLE SIZE
 AND PLATED THRU HOLES

ROW I
 ROW H
 ROW G
 ROW F
 ROW E
 ROW D
 ROW C
 ROW B
 ROW A

CONNECTOR
 OUTLINE

○ = SIGNAL
 ⊗ = GROUND
 RECOMMENDED DIFFERENTIAL PAIR PC BOARD LAYOUT
 COMPONENT SIDE SHOWN
 SCALE 8:1

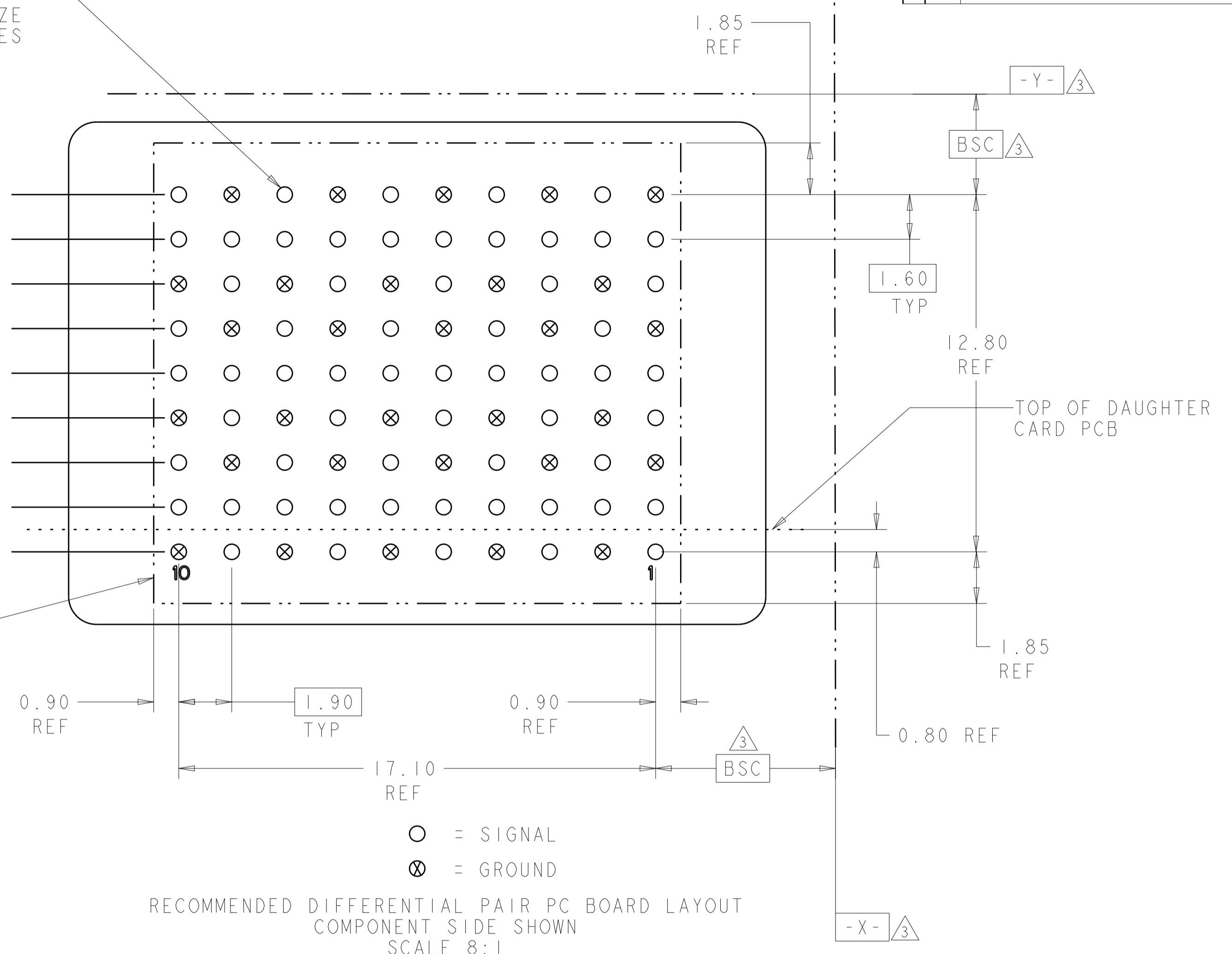
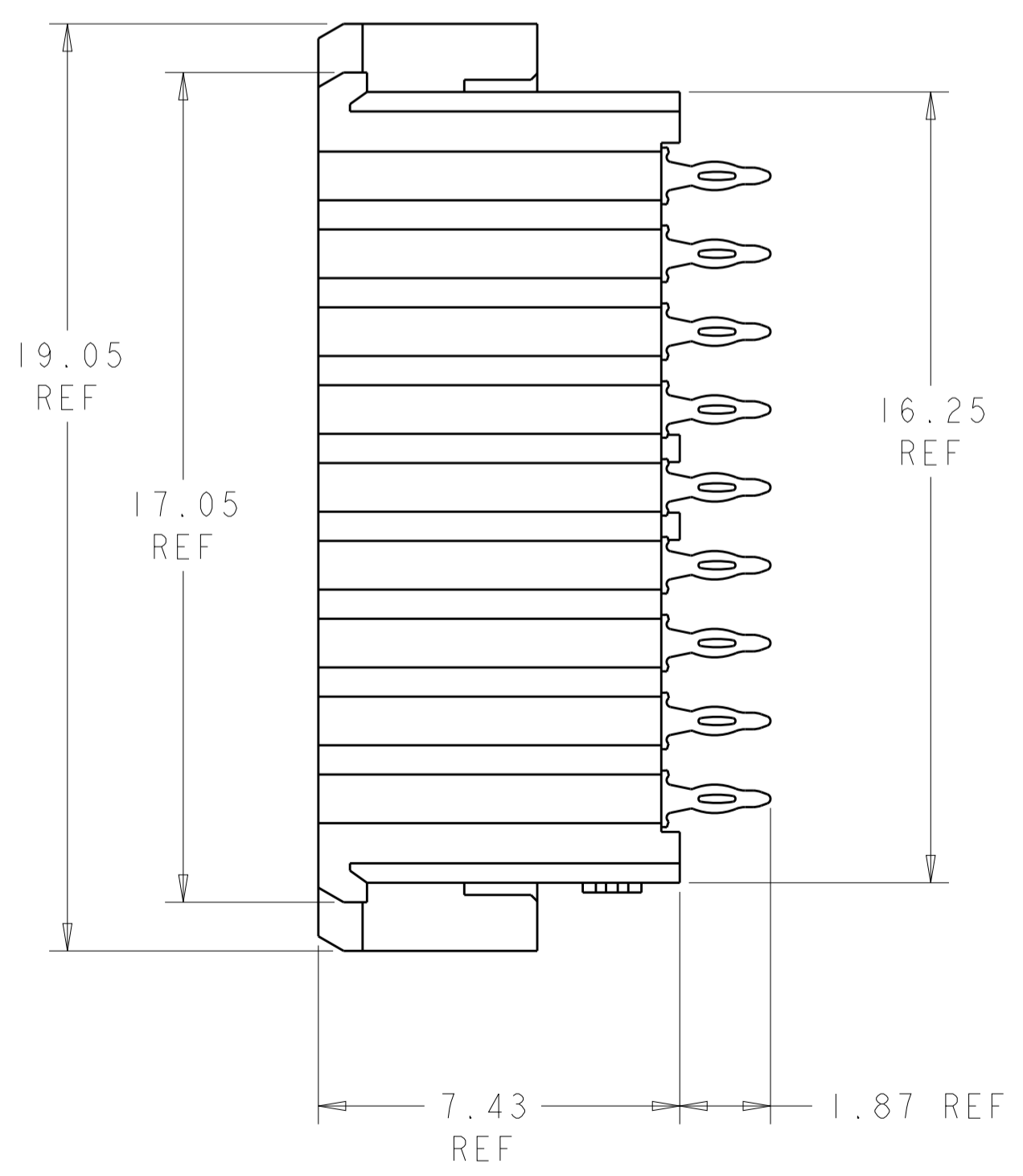
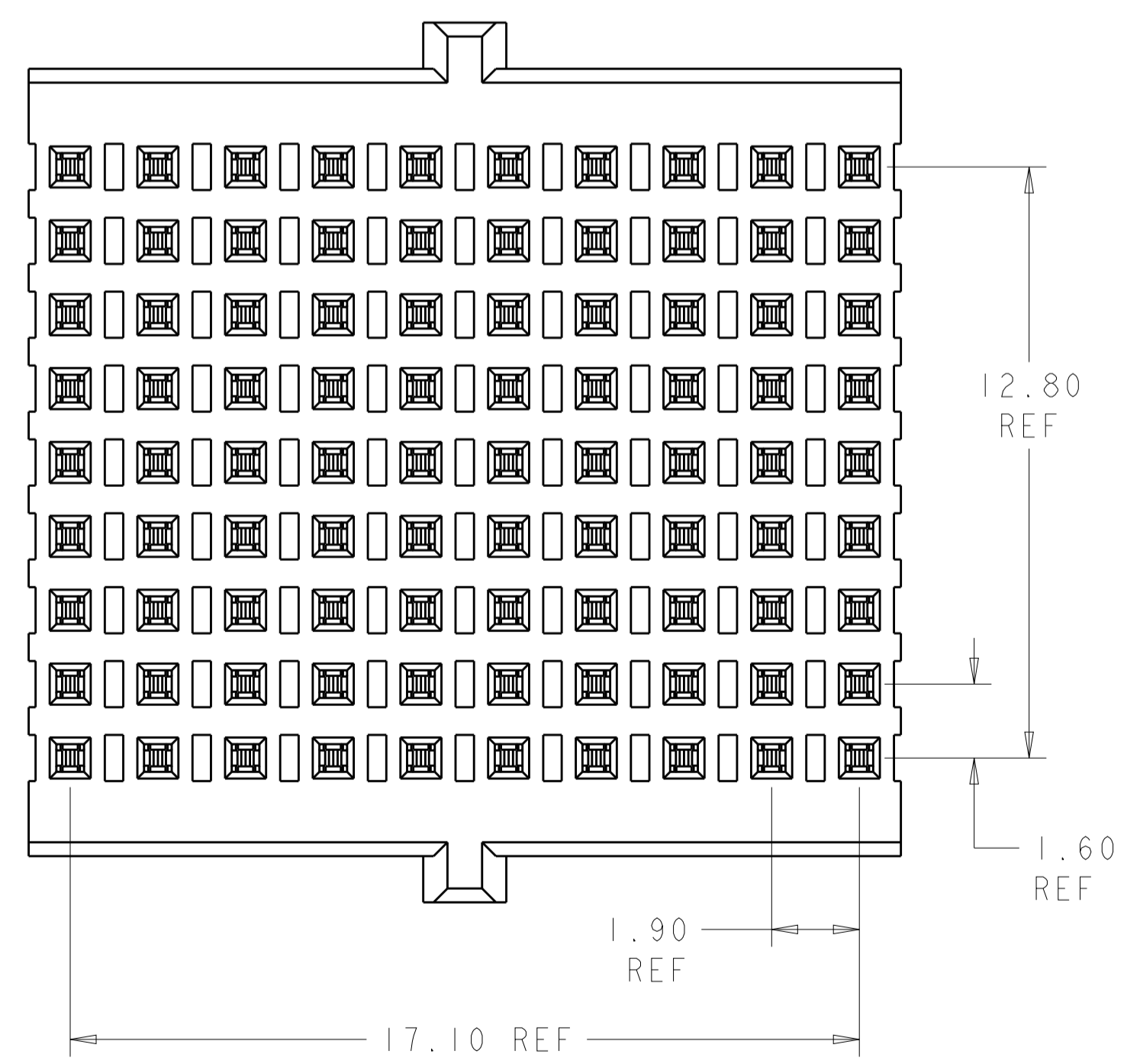
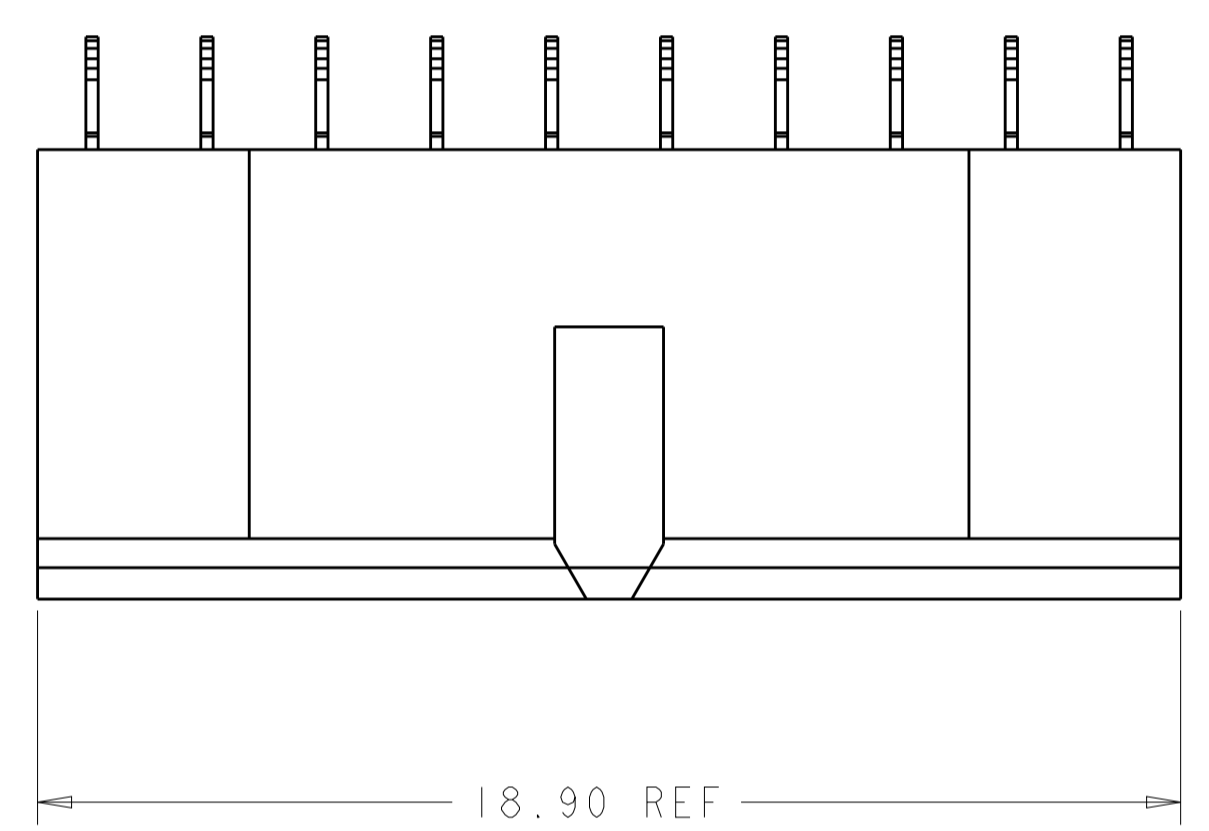

1	2000896-3
2	2000896-2
3	2000896-1
FINISH	PART NUMBER

THIS DRAWING IS A CONTROLLED DOCUMENT. DIMENSIONING AND TOLERANCING PER GPS (ISO STANDARDS). TOLERANCES UNLESS OTHERWISE SPECIFIED:

mm	0 PLC ±0.13
	2 PLC ±0.05
	3 PLC ±
	4 PLC ±
ANGLES	° ±

MATERIAL: FINISH: -

OWN: D. BELACK 24JUN2009
 CHK: A. TSANG 2-24-2009
 APVD: M. McALONIS 2-24-2009

PRODUCT SPEC: 108-2409
 APPLICATION SPEC: 114-13267
 WEIGHT: 3.38 g -2x

CUSTOMER DRAWING

NAME: Fortis Zd. 10-COLUMN, 3-PAIR, VERTICAL CENTER MODULE ASSEMBLY
 SIZE: A1
 CAGE CODE: 2000896
 DRAWING NO: 100779
 SCALE: 8:1 SHEET 1 OF 1 REV F

TE Connectivity