



Chipsmall Limited consists of a professional team with an average of over 10 year of expertise in the distribution of electronic components. Based in Hongkong, we have already established firm and mutual-benefit business relationships with customers from,Europe,America and south Asia,supplying obsolete and hard-to-find components to meet their specific needs.

With the principle of "Quality Parts,Customers Priority,Honest Operation,and Considerate Service",our business mainly focus on the distribution of electronic components. Line cards we deal with include Microchip,ALPS,ROHM,Xilinx,Pulse,ON,Everlight and Freescale. Main products comprise IC,Modules,Potentiometer,IC Socket,Relay,Connector.Our parts cover such applications as commercial,industrial, and automotives areas.

We are looking forward to setting up business relationship with you and hope to provide you with the best service and solution. Let us make a better world for our industry!



## Contact us

Tel: +86-755-8981 8866 Fax: +86-755-8427 6832

Email & Skype: info@chipsmall.com Web: www.chipsmall.com

Address: A1208, Overseas Decoration Building, #122 Zhenhua RD., Futian, Shenzhen, China



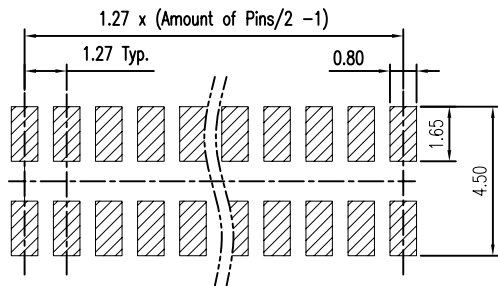
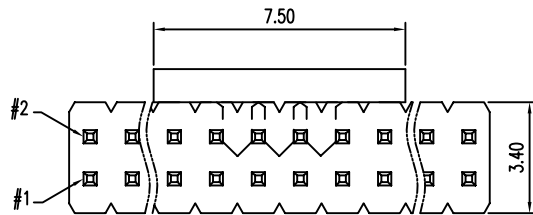
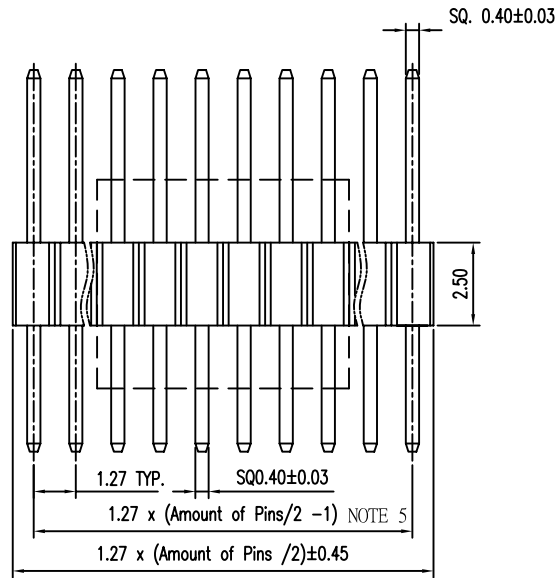

Recommended P.C.B. Layout  
Layout Tolerance = ± 0.05 mm

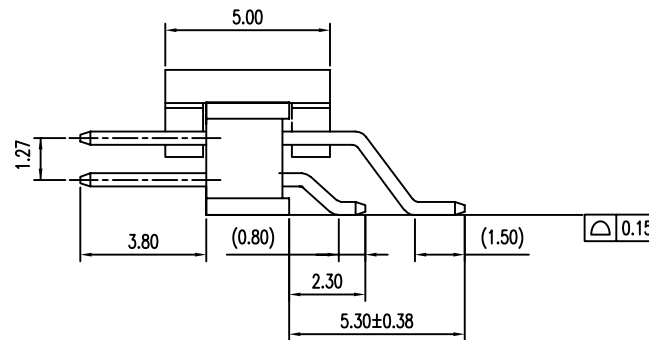

NOTE:

- MATERIAL,  
HOUSING: HIGH TEMP PLASTIC, UL94-V0, BLACK  
TERMINAL: COPPER ALLOY, SQ=0.40±0.03MM
- FINISH:  
TERMINAL: GOLD AT CONTACT,  
G/F OVER 1um(40u")MIN Ni OVER ALL
- SPEC.:  
PRODUCT SPEC: GS-12-629  
PACKING SPEC: GS-14-1420
- THE HSG. WILL WITHSTAND EXPOSURE TO 260°C  
PEAK TEMP. FOR 10 SEC. IN A CONVECTION INFRA-RED  
OR VAPOR PHASE REFLOW OVEN.
- THE TOLERANCE OF THIS DIMENSION

2-50 PINS	± 0.20
-----------	--------

6. PRODUCT NUMBERING:

20021122 - 0 0 0 XX X X LF

- LEAD FREE
- PLATING:  
1: GOLD FLASH ALL OVER  
4: 0.25um(10U") GOLD AT CONTACT  
8: 0.76um(30U") GOLD AT CONTACT  
9: 1u" GOLD OVER 30u" PdNi AT CONTACT
- PACKING  
T: TUBE  
D: TUBE + CAP  
C: REEL + CAP
- PIN COUNT  
08, 10, . . . . . 50  
( 8 - 50 EVERY EVEN PIN )

mat'l. code		surface		tolerance		projection		product family	
		ISO1302	ISO1101	ISO406	MM		MINITEK		
ltr	ecn no	dr	date	tolerances unless otherwise specified		MM		title	
H	ELX-N-19179	TIM	10/24/14	angles	0.X±0.38	MM		1.27X1.27MM BTB HEADER	
B	T09-1155	S.LIN	12/03/09	flatness	0.XX±0.25	MM		UNSHROUDED SMT	
C	T10-0014	S.LIN	01/28/10	0°±2'	0.XXX±0.10	scale 5:1		dwg no	
D	T11-0029	S.LIN	06/14/11	dr	STERLING LIN	09/15/09	sheet. 1 of 1		size
E	ELX-N-010358	ZK	01/16/12	engr	STERLING LIN	09/15/09	20021122		A4
F	ELX-N-010619	ZK	03/12/12	chr	GRAY HSIEH	09/15/09	type		Product Customer Drawing
G	ELX-N-16465	TIM	12/06/13	appd	JOSEPH	09/15/09			
sheet	revision	H							
index	sheet	1							