



Chipsmall Limited consists of a professional team with an average of over 10 year of expertise in the distribution of electronic components. Based in Hongkong, we have already established firm and mutual-benefit business relationships with customers from,Europe,America and south Asia,supplying obsolete and hard-to-find components to meet their specific needs.

With the principle of "Quality Parts,Customers Priority,Honest Operation,and Considerate Service",our business mainly focus on the distribution of electronic components. Line cards we deal with include Microchip,ALPS,ROHM,Xilinx,Pulse,ON,Everlight and Freescale. Main products comprise IC,Modules,Potentiometer,IC Socket,Relay,Connector.Our parts cover such applications as commercial,industrial, and automotives areas.

We are looking forward to setting up business relationship with you and hope to provide you with the best service and solution. Let us make a better world for our industry!



Contact us

Tel: +86-755-8981 8866 Fax: +86-755-8427 6832

Email & Skype: info@chipsmall.com Web: www.chipsmall.com

Address: A1208, Overseas Decoration Building, #122 Zhenhua RD., Futian, Shenzhen, China



| LOC | DIST | REVISIONS | | | |
|-----|------|-----------|-----------|----|------|
| GP | 00 | REV | DATE | BY | CHKD |
| | | C | 07DEC2011 | TX | AC |
| | | C1 | 09SEP2013 | PP | SH |
| | | C2 | 16JAN2014 | PP | SH |
| | | C3 | 24MAR2014 | JZ | SH |

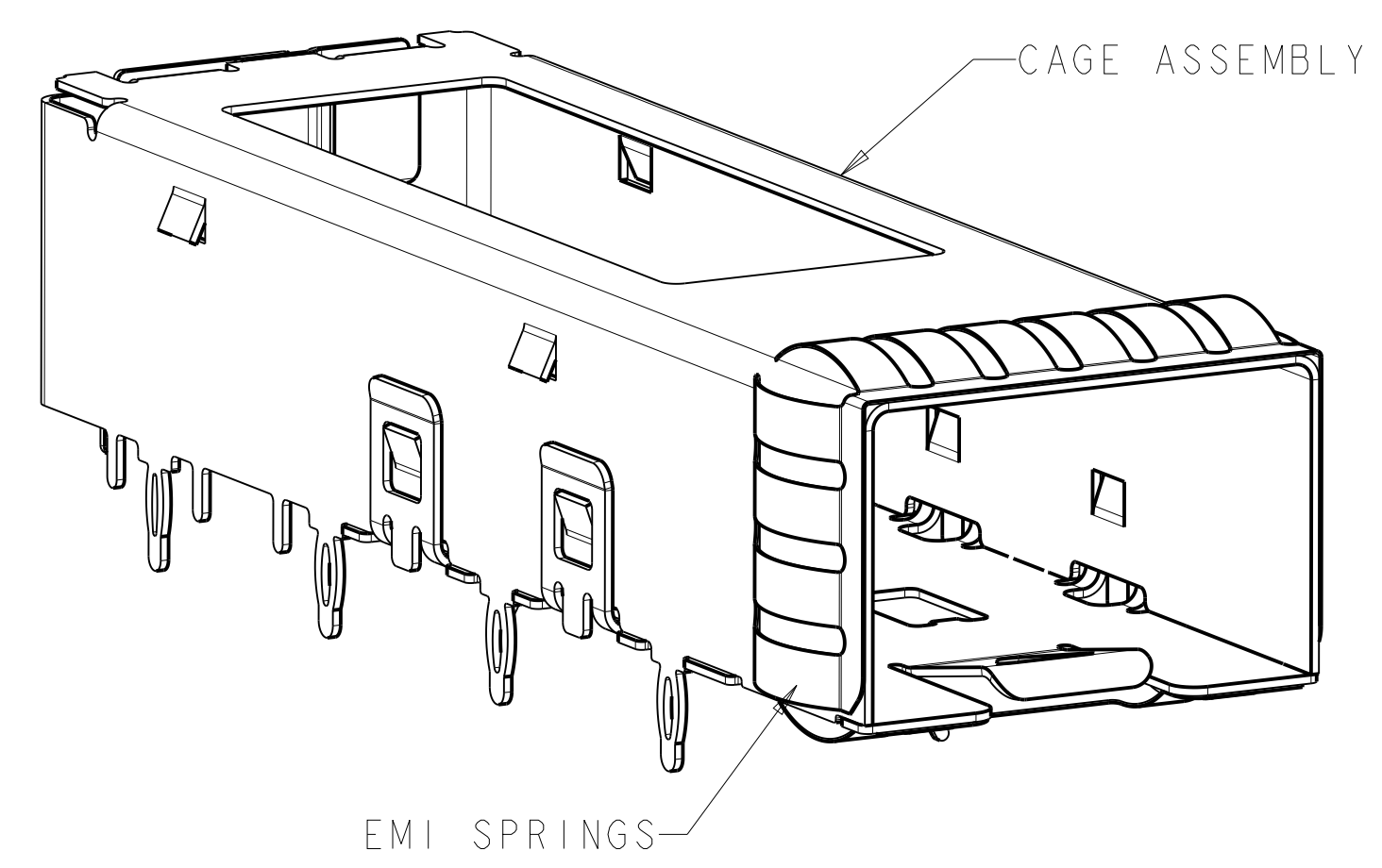

2007198-2
SCALE 5:1

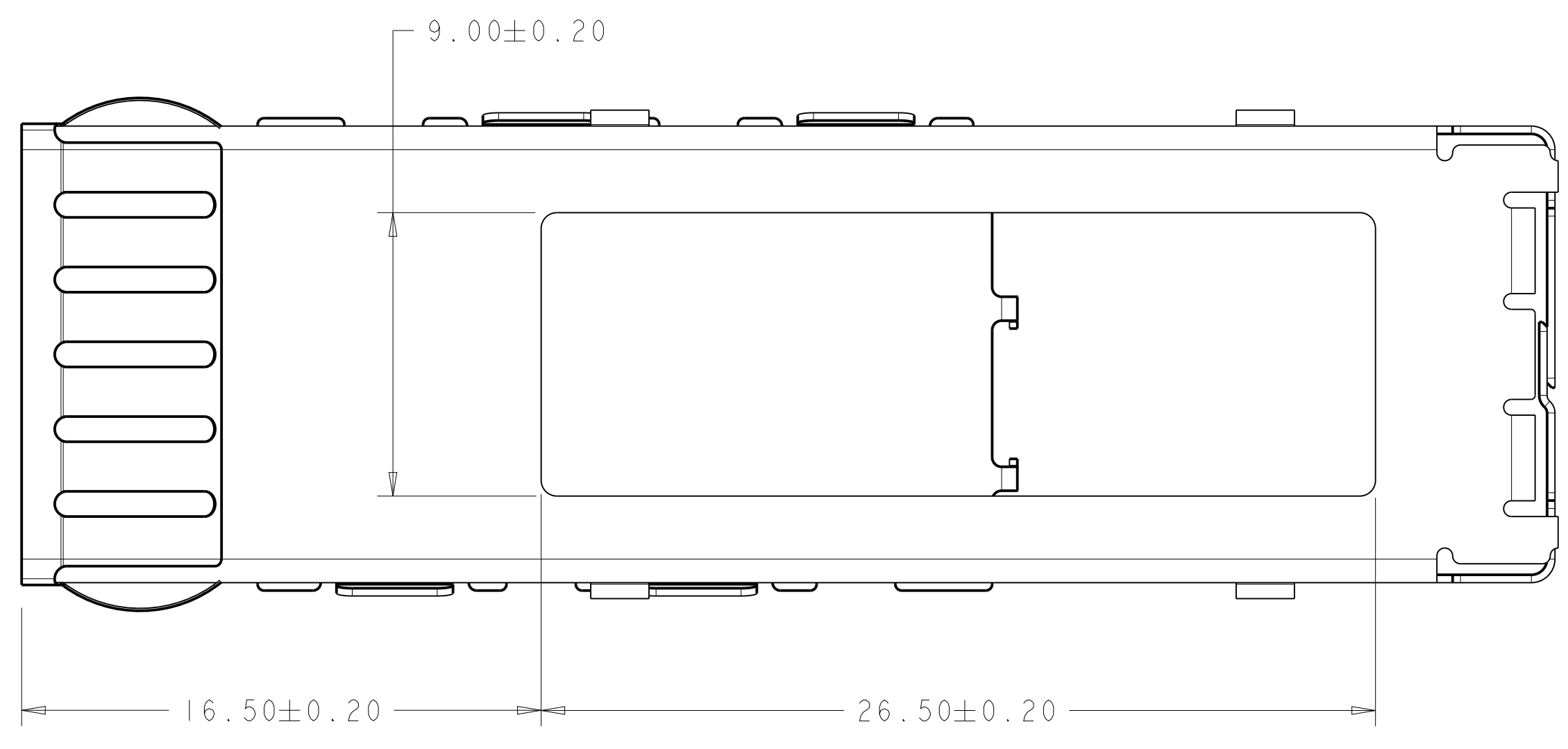

2007198-2
SAME AS 2007198-1 EXCEPT AS SHOWN
TOP VIEW

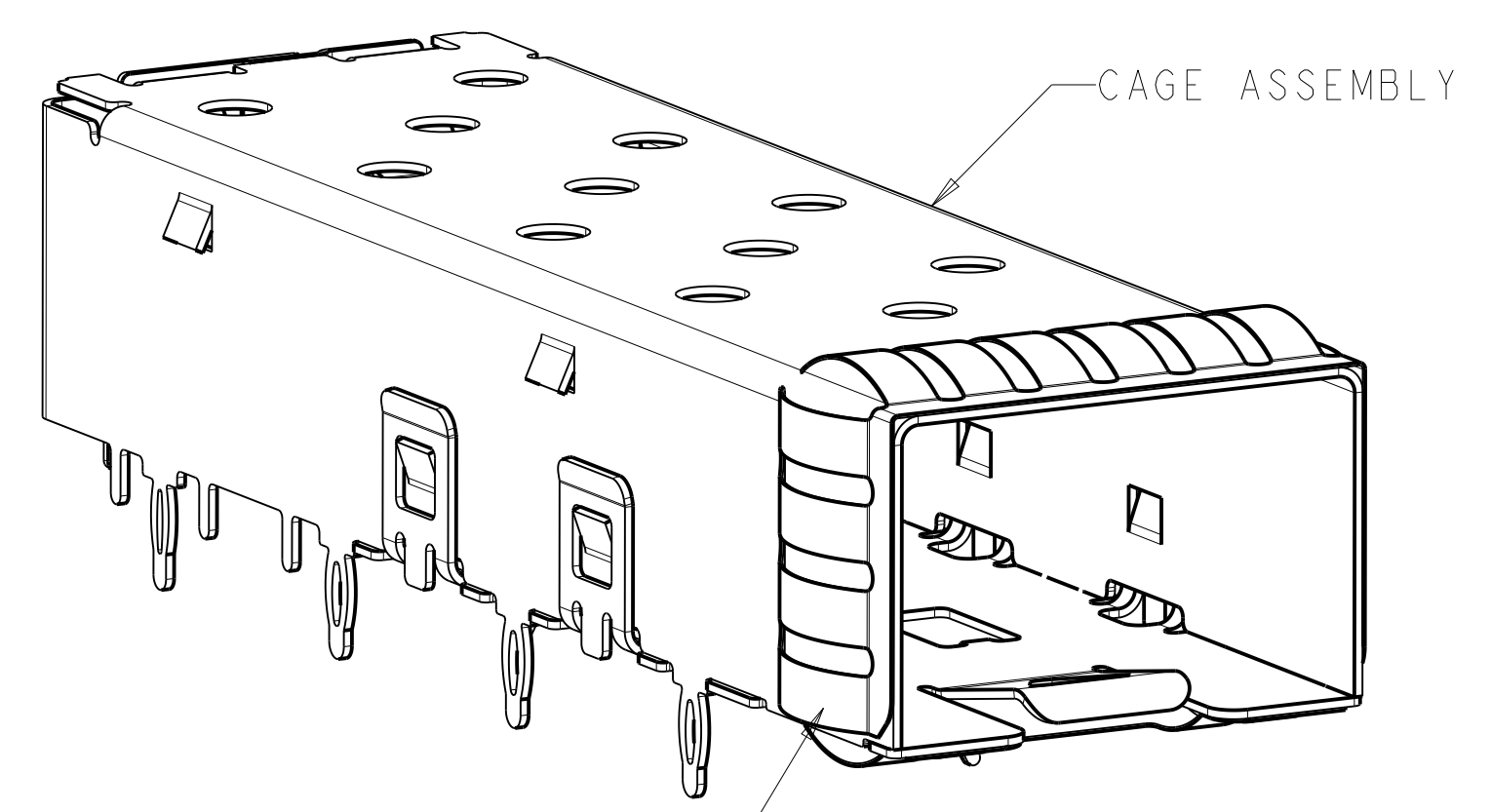

2007198-1/-9
2007198-9 SAME AS 2007198-1, ONLY PACKAGE DIFFER
SCALE 5:1

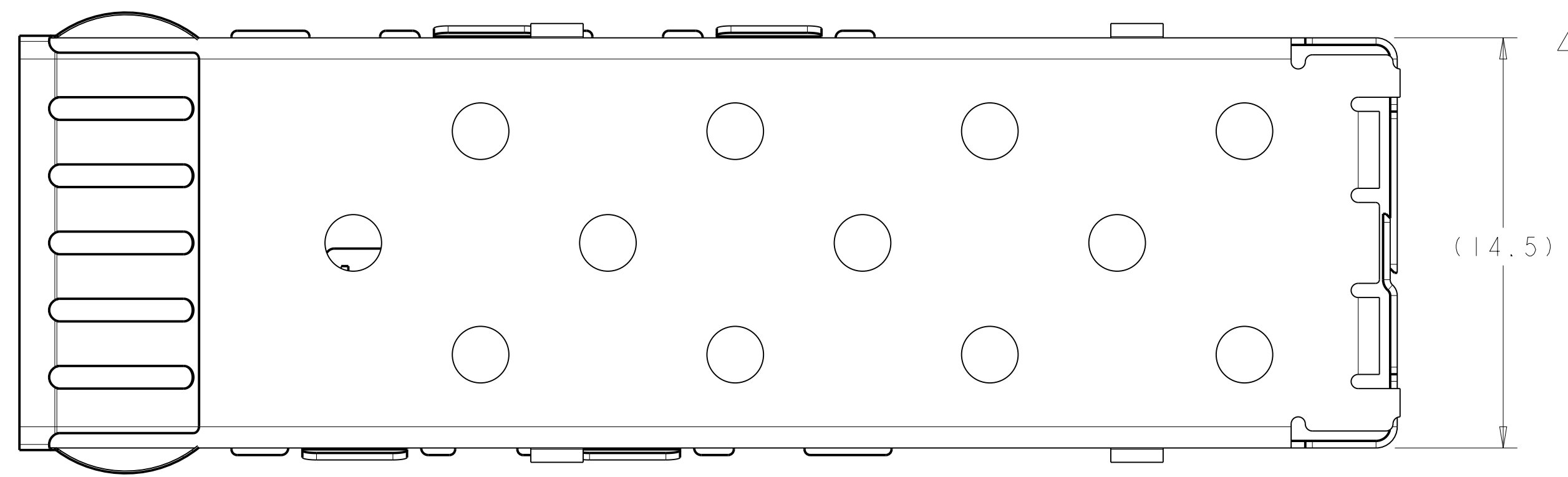

2007198-1/-9
TOP VIEW

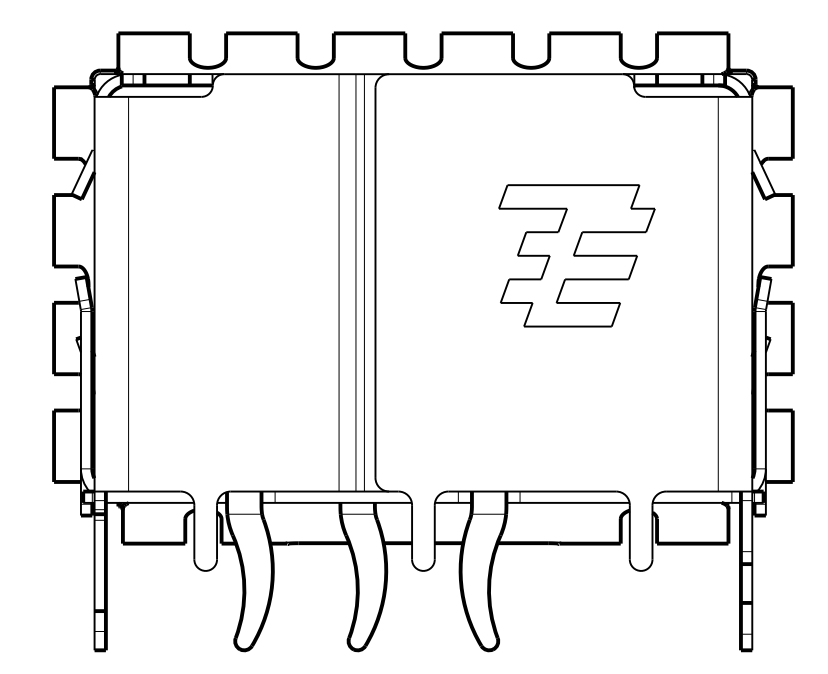
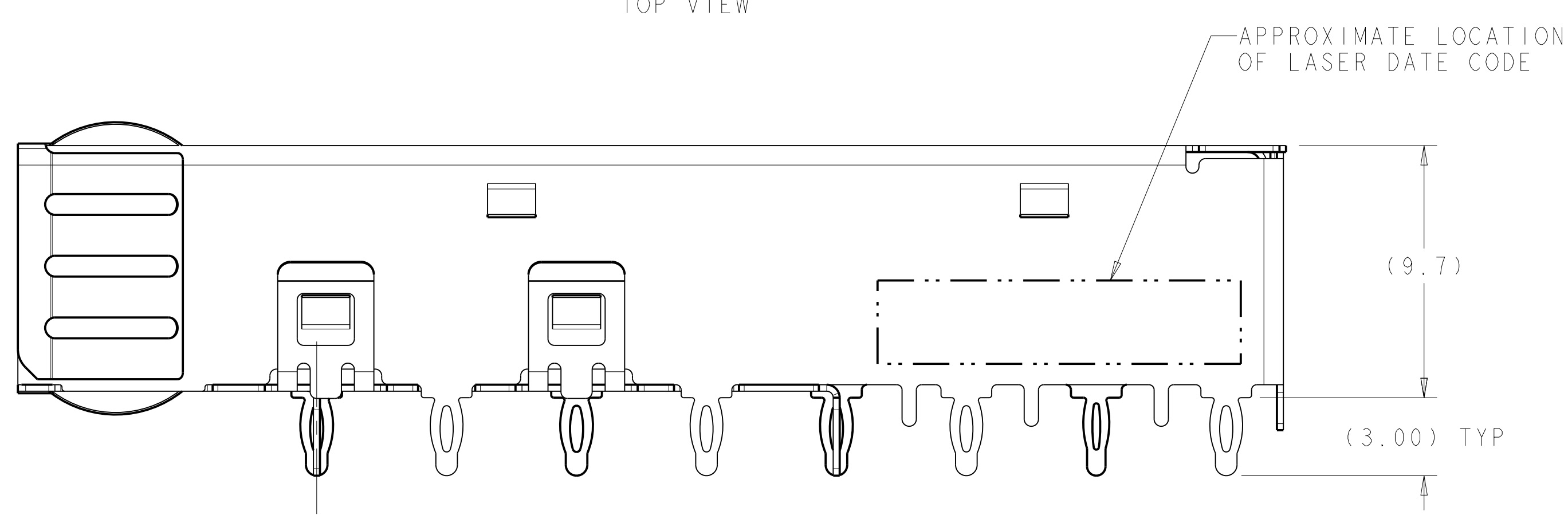
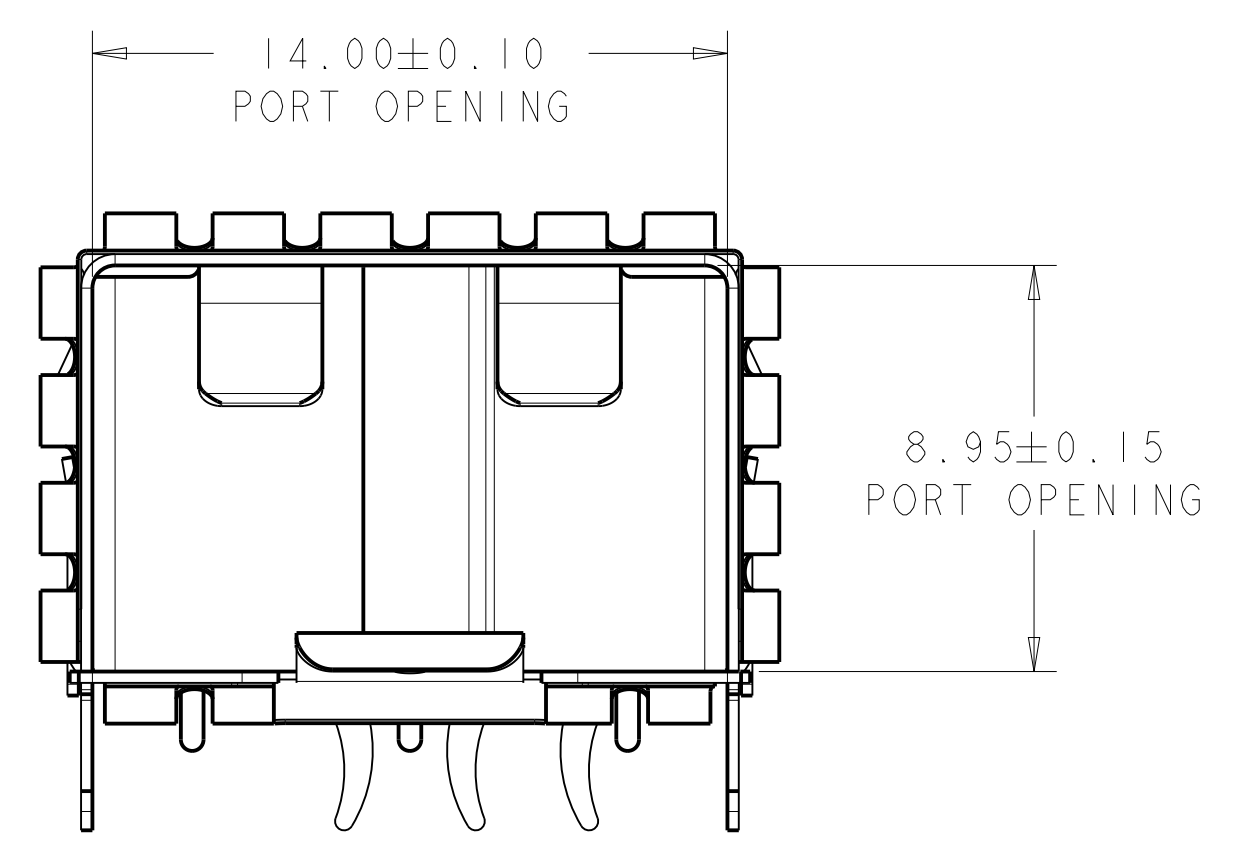

- 1. MATERIAL:
CAGE ASSEMBLY - 0.25mm THICK NICKEL SILVER ALLOY.
EMI SPRINGS - COPPER ALLOY.
- 2. FINISH
EMI SPRINGS - 0.8um MIN MATTE TIN OVER 0.8um MIN NICKEL,
NON-PLATED EDGES PERMISSIBLE.
- 3. MATES WITH SFP MSA COMPLIANT TRANSCEIVERS.
- 4. PADS AND VIAS CHASSIS GROUND.
- 5. DATUM AND BASIC DIMENSION ESTABLISHED BY CUSTOMER.
- 6. MINIMUM PC BOARD THICKNESS:
SINGLE SIDED = 1.50 mm
DOUBLE SIDED = 3.00 mm
- 7. REFERENCE APPLICATION SPEC. 114-13120, HOLE A, FOR
RECOMMENDED DRILL HOLE DIAMETER AND PLATING THICKNESS.
- 8. REFERENCE APPLICATION SPEC. 114-13120, HOLE C, FOR
RECOMMENDED DRILL HOLE DIAMETER AND PLATING THICKNESS.
- 9. NOTE DELETED
- 10. PACKAGE TYPE IS TAPE AND REEL.

| INSULATING TAPE | DESCRIPTION | PART NUMBER |
|---------------------|------------------|-------------|
| W/O INSULATING TAPE | EMI HOLES | 2007198-9 |
| W/O INSULATING TAPE | NEW LANCE | 2007198-7 |
| W/ INSULATING TAPE | EMI HOLES | 2007198-5 |
| W/O INSULATING TAPE | HEATSINK OPENING | 2007198-2 |
| W/O INSULATING TAPE | EMI HOLES | 2007198-1 |

THIS DRAWING IS A CONTROLLED DOCUMENT.

| | | | |
|-------------|--|-------------------------|---|
| DIMENSIONS: | TOLERANCES UNLESS OTHERWISE SPECIFIED: | DRW: M. SCHMITT 07JUN07 | TE Connectivity NAME: SFP+ 1X1 CAGE ASSEMBLY, PRESS-FIT PRESS-FIT, EMI SPRINGS PRODUCT SPEC: 108-2364 APPLICATION SPEC: 114-13120 SIZE: CAGE CODE DRAWING NO: A100779C=2007198 WEIGHT: - Customer Drawing |
| mm | 0 PLC ±0.1 | CHK: M. SCHMITT 07JUN07 | |
| | 1 PLC ±0.1 | APP'D: B. WERTZ 07JUN07 | |
| | 2 PLC ±0.1 | | |
| | 3 PLC ±0.05 | | RESTRICTED TO |
| | 4 PLC ±0.05 | | SCALE: 6:1 SHEET 1 OF 4 REV: C.3 |
| | ANGLES ±0.05 | | |

| LOC | | DIST | | REVISIONS | | | |
|-----|----|------|-----|-------------|------|-----|------|
| GP | 00 | P | LTN | DESCRIPTION | DATE | DMN | APVD |
| | | - | | SEE SHEET 1 | - | - | - |
| | | | | | | | |

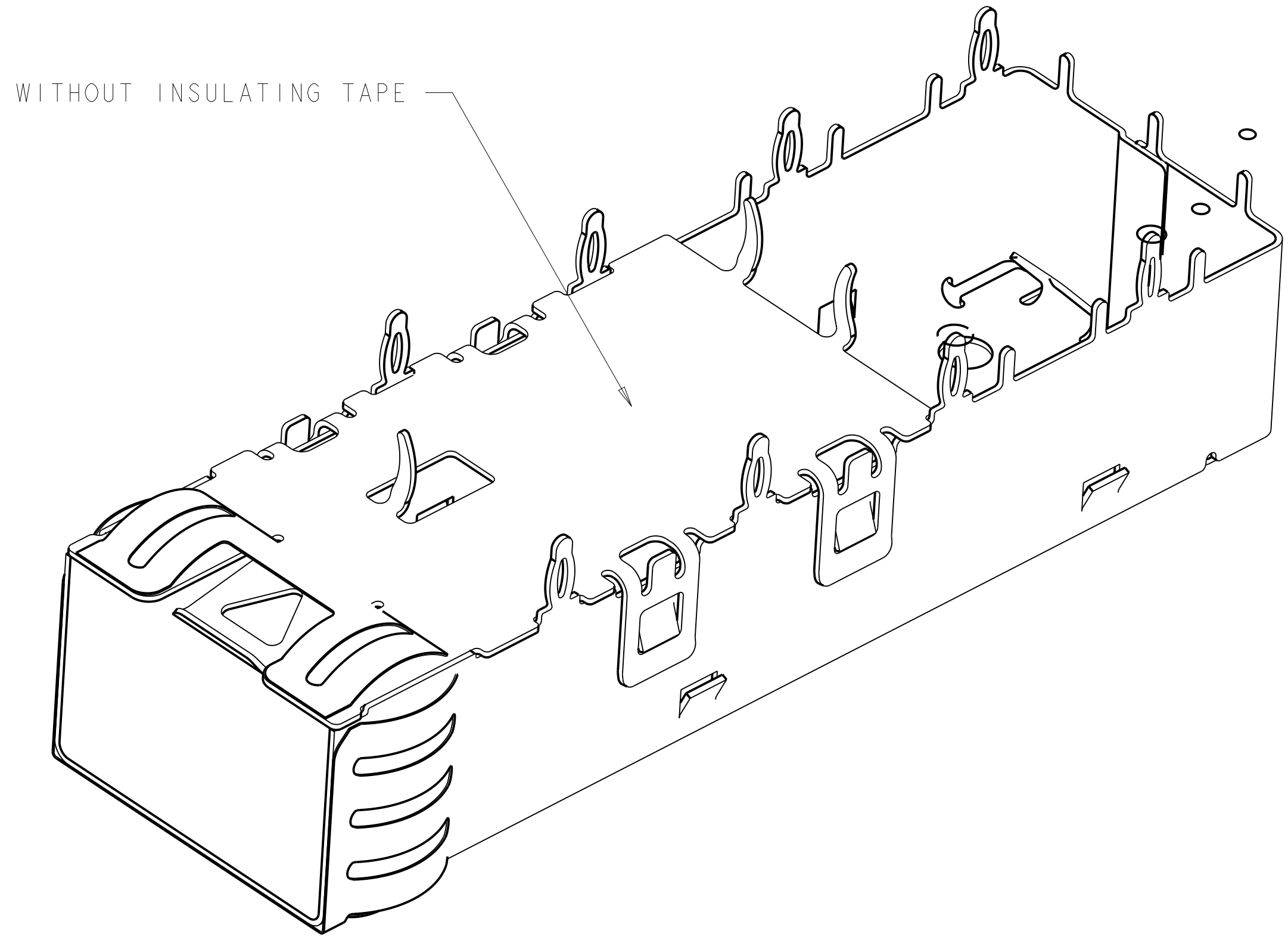

2007198-1,2,9 AS SHOWN WITHOUT INSULATING TAPE

WITH INSULATING TAPE

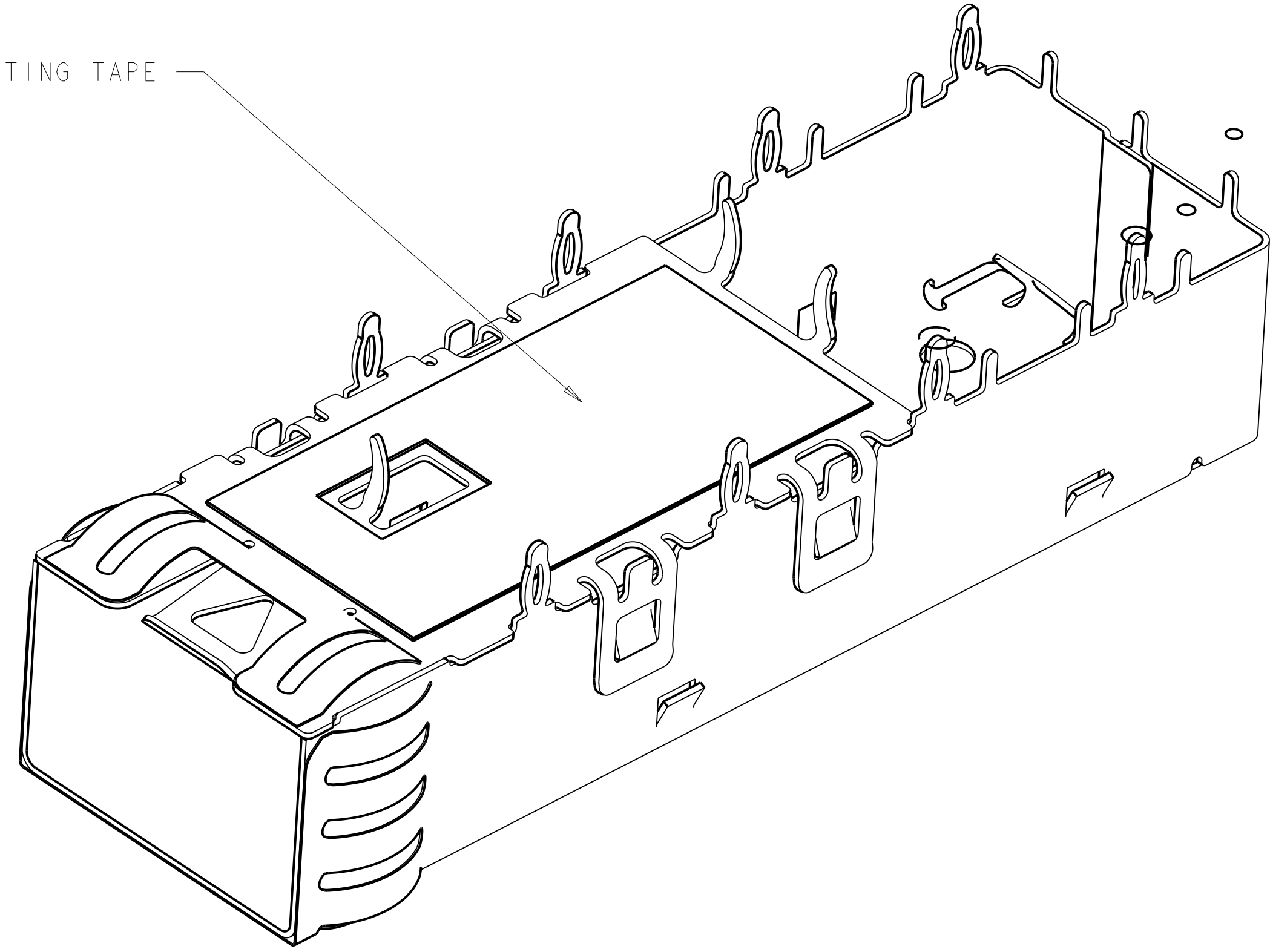

2007198-5 AS SHOWN WITH INSULATING TAPE

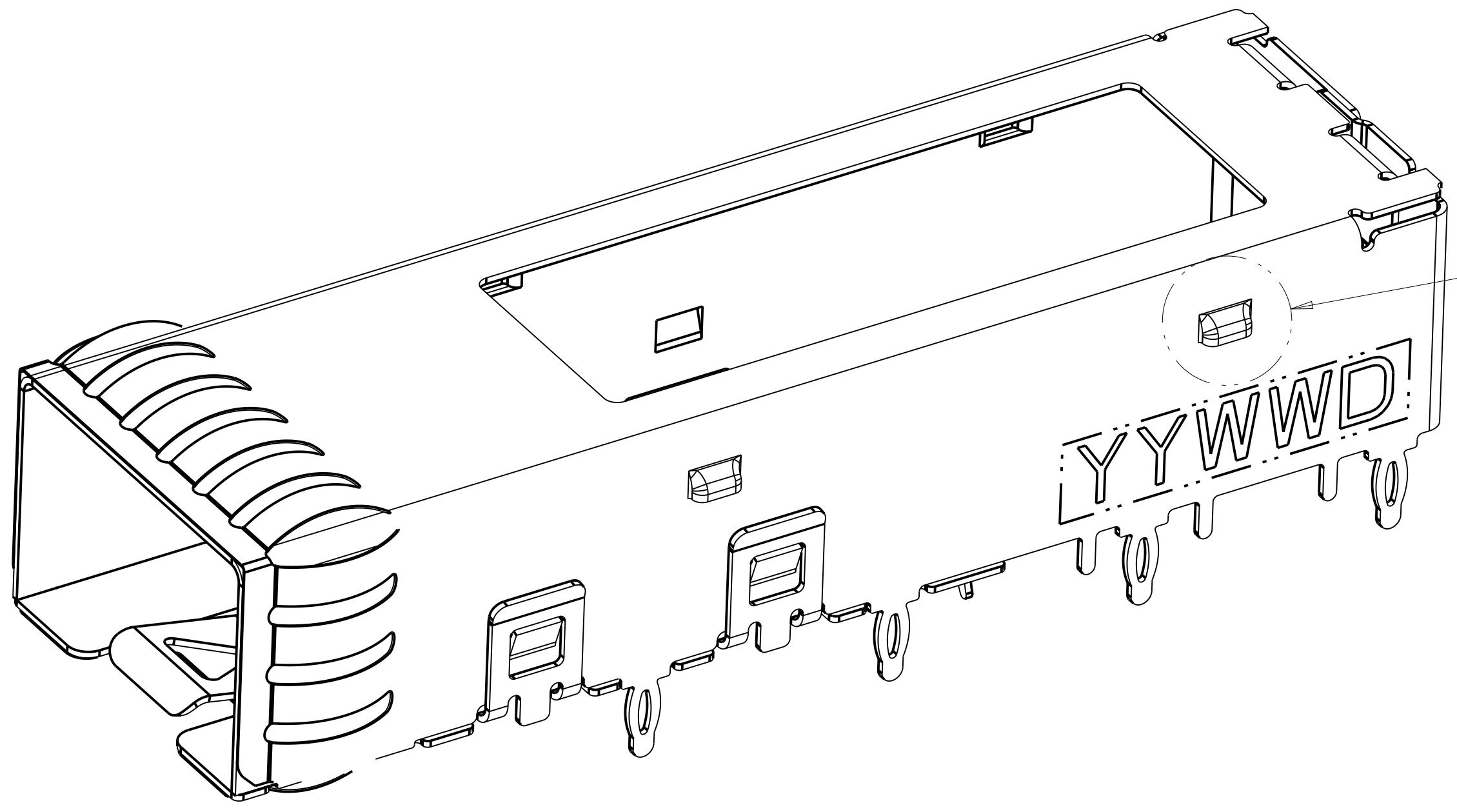

2007198-7
 SAME AS 2007198-2 EXCEPT AS SHOWN
 TOP VIEW

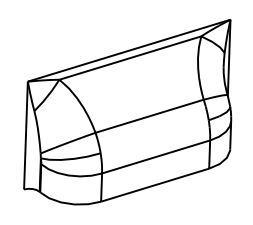

DETAIL C
 SCALE 15:1

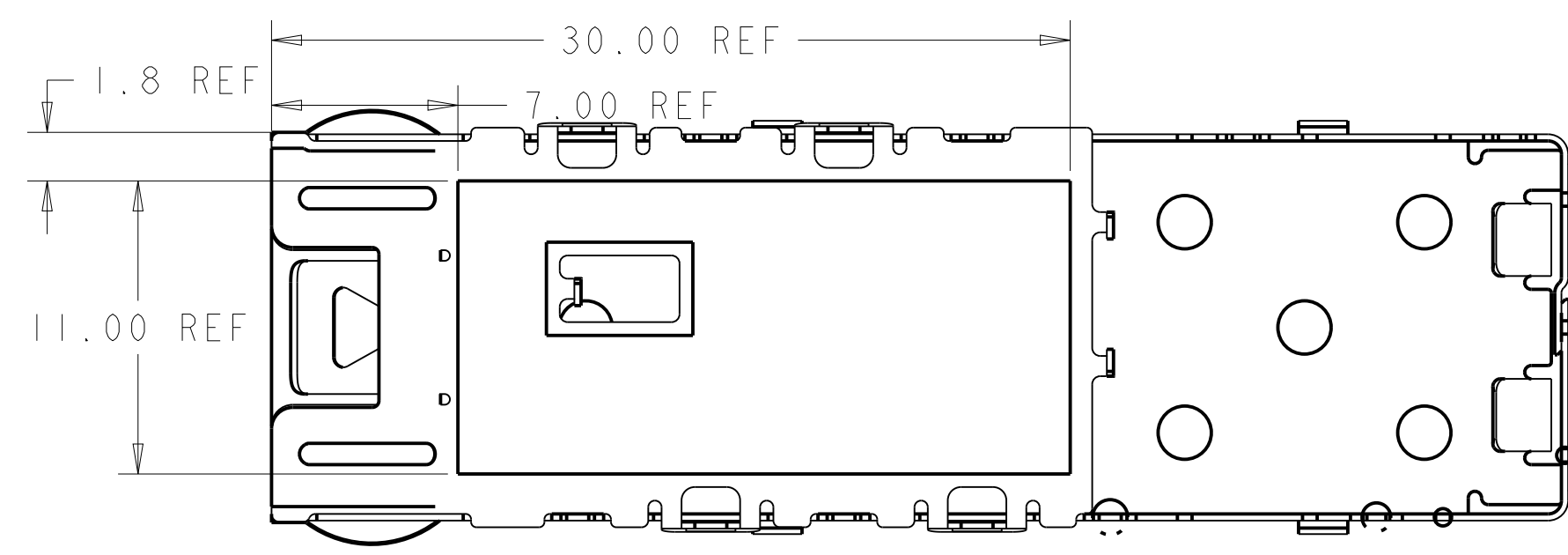

SCALE 4:1
 2007198-5 AS SHOWN THE LOCATION OF THE TAPE

| | | | |
|--|--|------------------------|---|
| THIS DRAWING IS A CONTROLLED DOCUMENT. | | DMN M. SCHMITT 07JUN07 | STE TE Connectivity |
| DIMENSIONS: mm | | CHK M. SCHMITT 07JUN07 | |
| TOLERANCES UNLESS OTHERWISE SPECIFIED: | | APVD B. WERTZ 07JUN07 | NAME SFP+ IXI CAGE ASSEMBLY, PRESS-FIT PRESS-FIT, EMI SPRINGS |
| 0 PLC ±0.1 | | PRODUCT SPEC | SIZE CAGE CODE DRAWING NO RESTRICTED TO |
| 1 PLC ±0.1 | | 108-2364 | A100779C=2007198 |
| 2 PLC ±0.1 | | APPLICATION SPEC | SCALE 6:1 SHEET 2 OF 4 REV C.3 |
| 3 PLC ±0.05 | | 114-13120 | |
| 4 PLC ±0.05 | | WEIGHT | |
| ANGLES ±0.05 | | Customer Drawing | |
| FINISH | | | |

| LOC | DIST | REV | DATE | BY | APPV |
|-----|------|-----|------|----|------|
| GP | 00 | | | | |

| REVISIONS | | | | | |
|-----------|------|----|------|-------------|--|
| REV | DATE | BY | APPV | DESCRIPTION | |
| - | - | - | - | SEE SHEET 1 | |

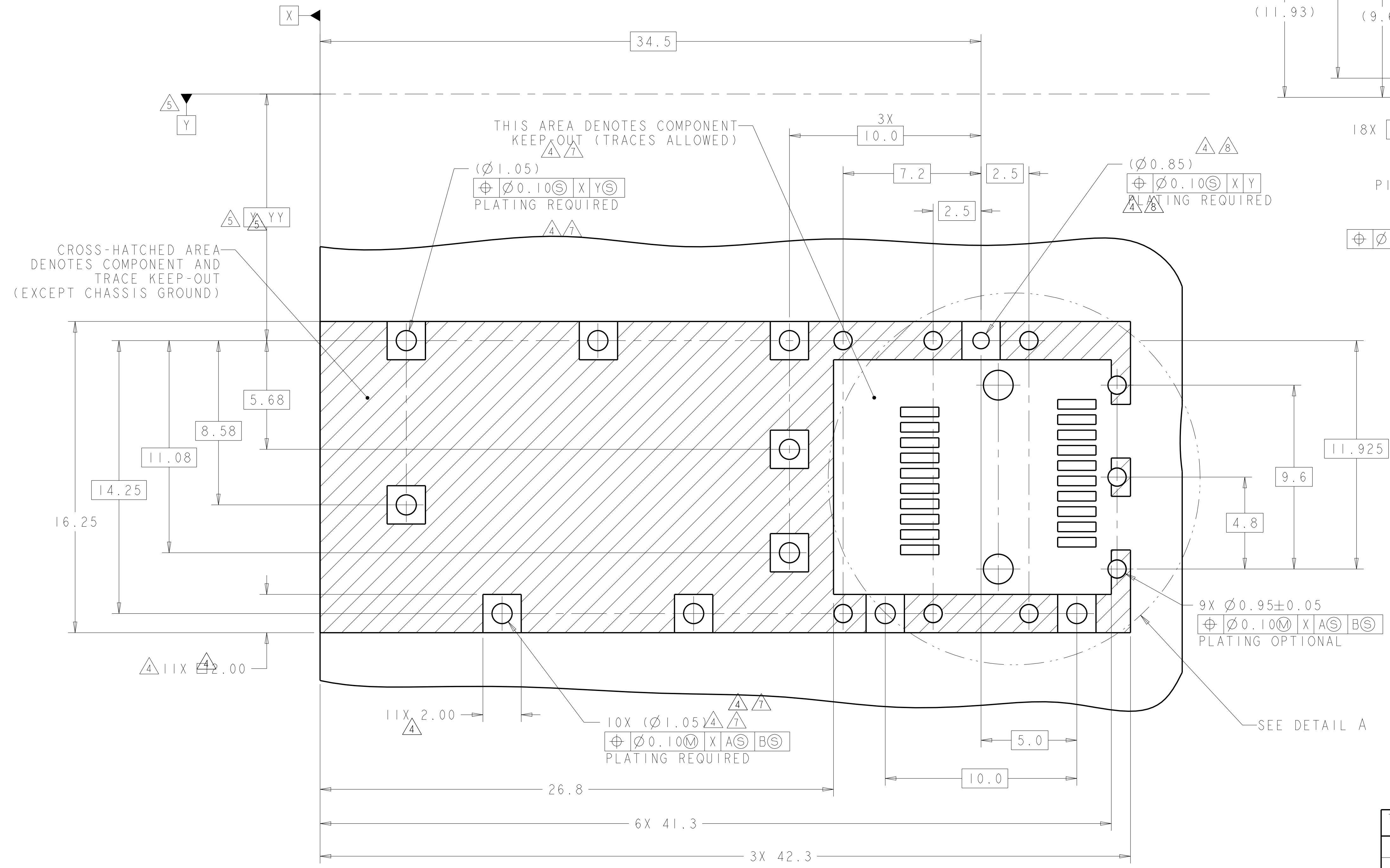
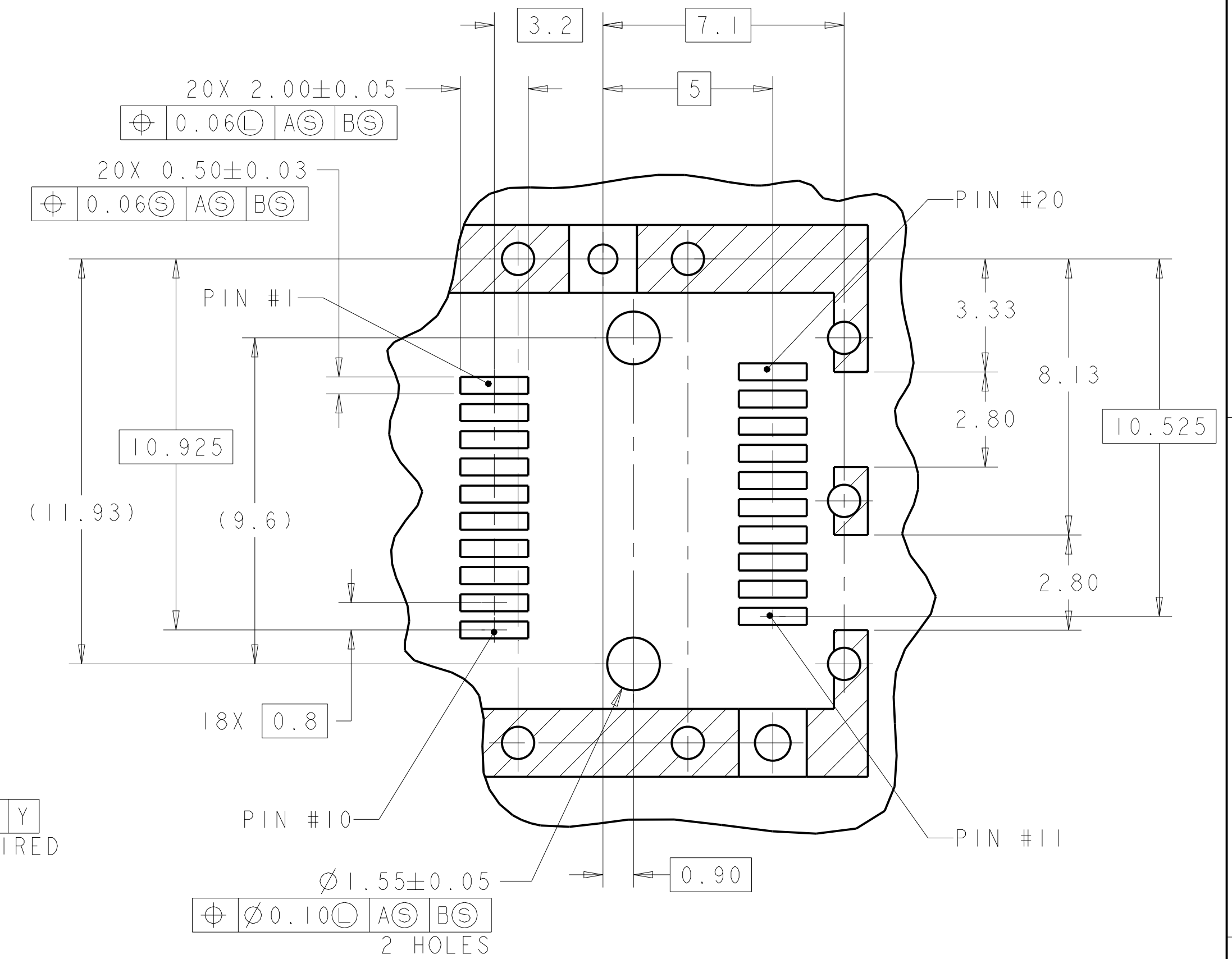
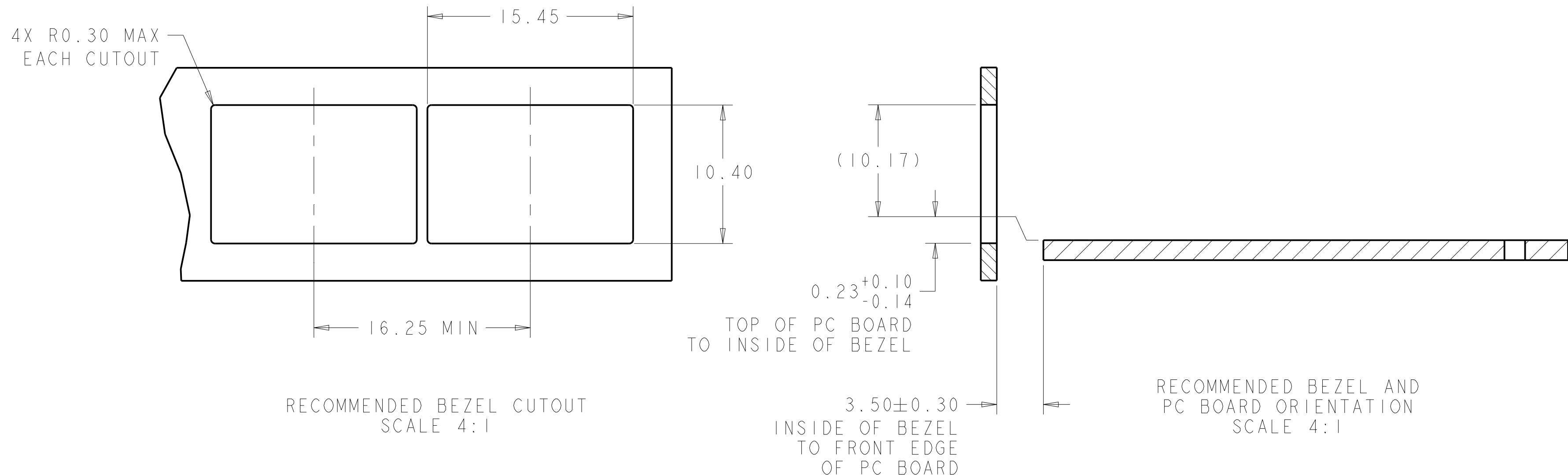

| | | | |
|--|--|---|---|
| THIS DRAWING IS A CONTROLLED DOCUMENT. | | OWN: M. SCHMITT 07JUN07 | TE Connectivity |
| DIMENSIONS: mm | | CHK: M. SCHMITT 07JUN07 | |
| TOLERANCES UNLESS OTHERWISE SPECIFIED: | | APV: B. WERTZ 07JUN07 | NAME: SFP+ IXI CAGE ASSEMBLY, PRESS-FIT PRESS-FIT, EMI SPRINGS PRODUCT SPEC: 108-2364 APPLICATION SPEC: 114-13120 |
| 0 PLC ±0.1 1 PLC ±0.1 2 PLC ±0.1 3 PLC ±0.05 4 PLC ±0.05 ANGLES ±0.05 | | SIZE: A1 CAGE CODE: 00779 DRAWING NO: C=2007198 | |
| MATERIAL: FINISH: | | WEIGHT: | RESTRICTED TO: |
| Customer Drawing | | SCALE: 6:1 | SHEET 3 OF 4 REV C3 |

| LOC | | DIST | | REVISIONS | | | |
|-----|----|------|-----|-------------|------|-----|------|
| GP | 00 | P | LTN | DESCRIPTION | DATE | DMN | APVD |
| | | | | SEE SHEET 1 | | | |

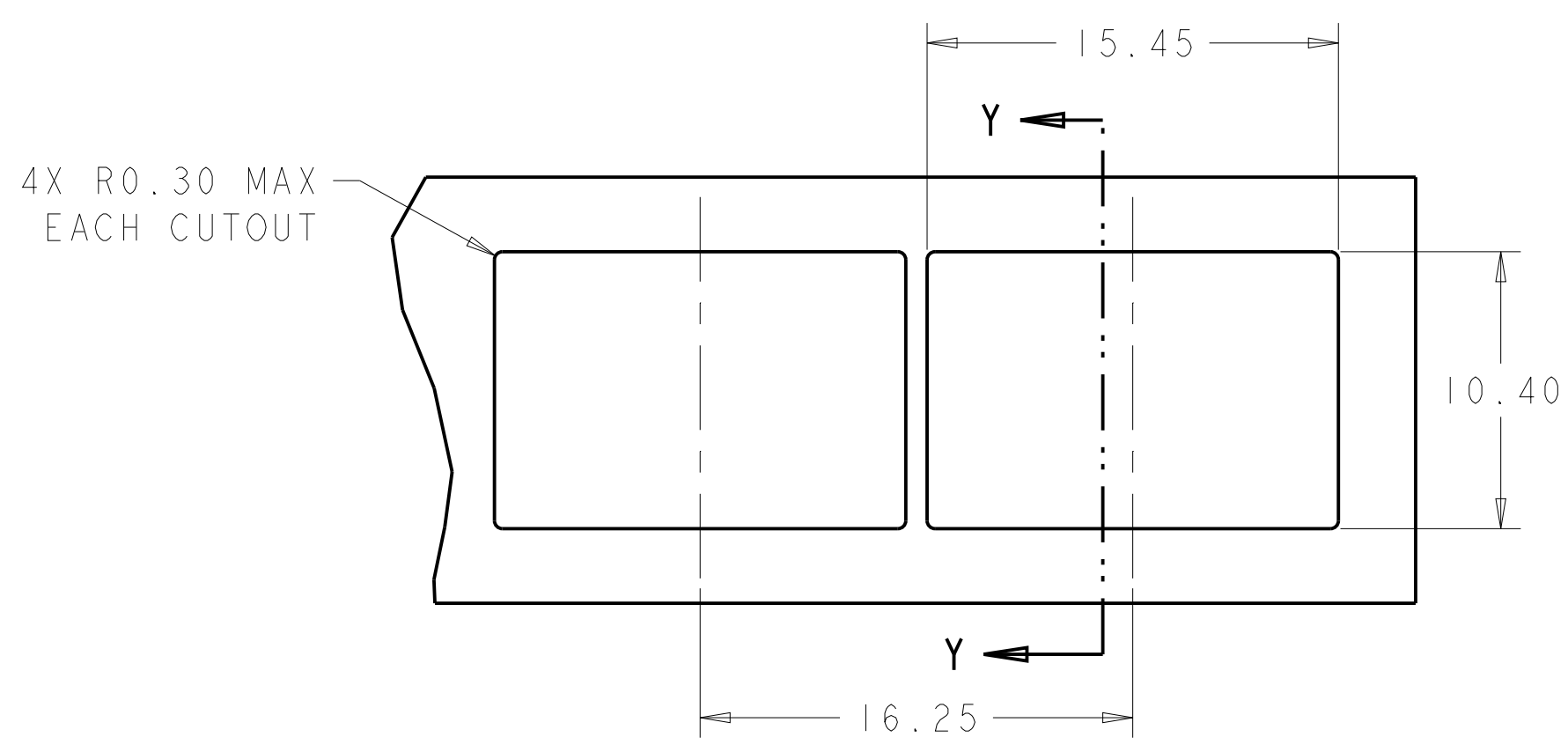

RECOMMENDED BEZEL CUTOUT
SCALE 4:1

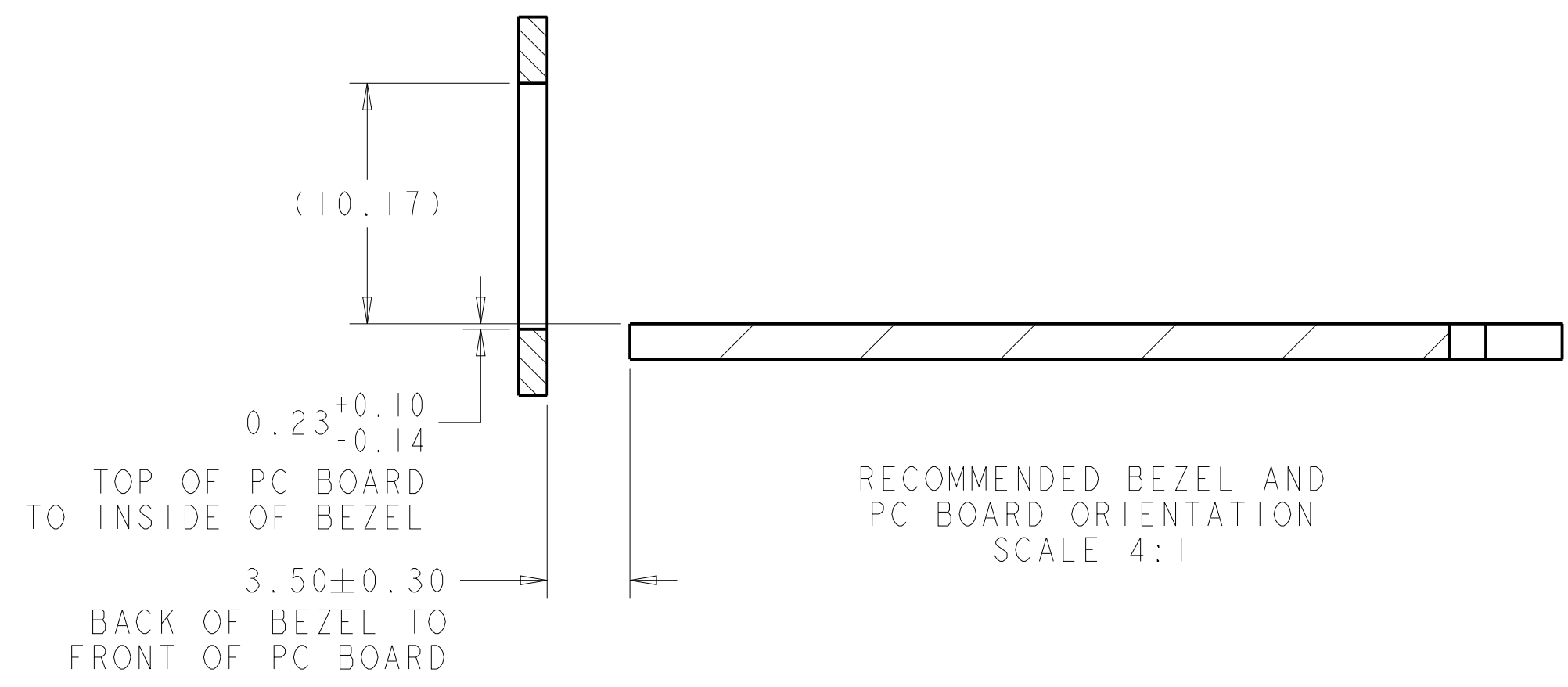

RECOMMENDED BEZEL AND
PC BOARD ORIENTATION
SCALE 4:1

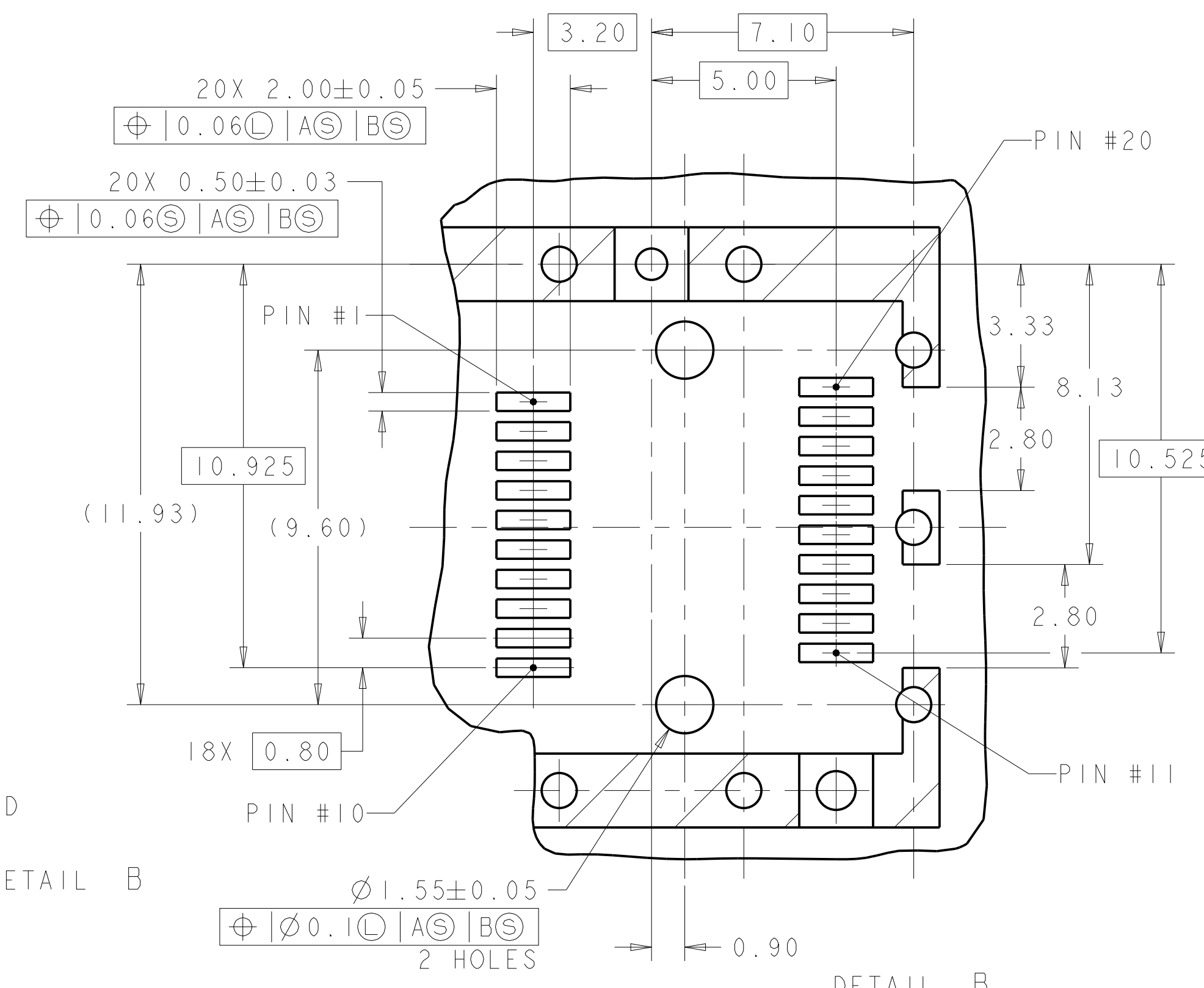

DETAIL B
SCALE 8:1

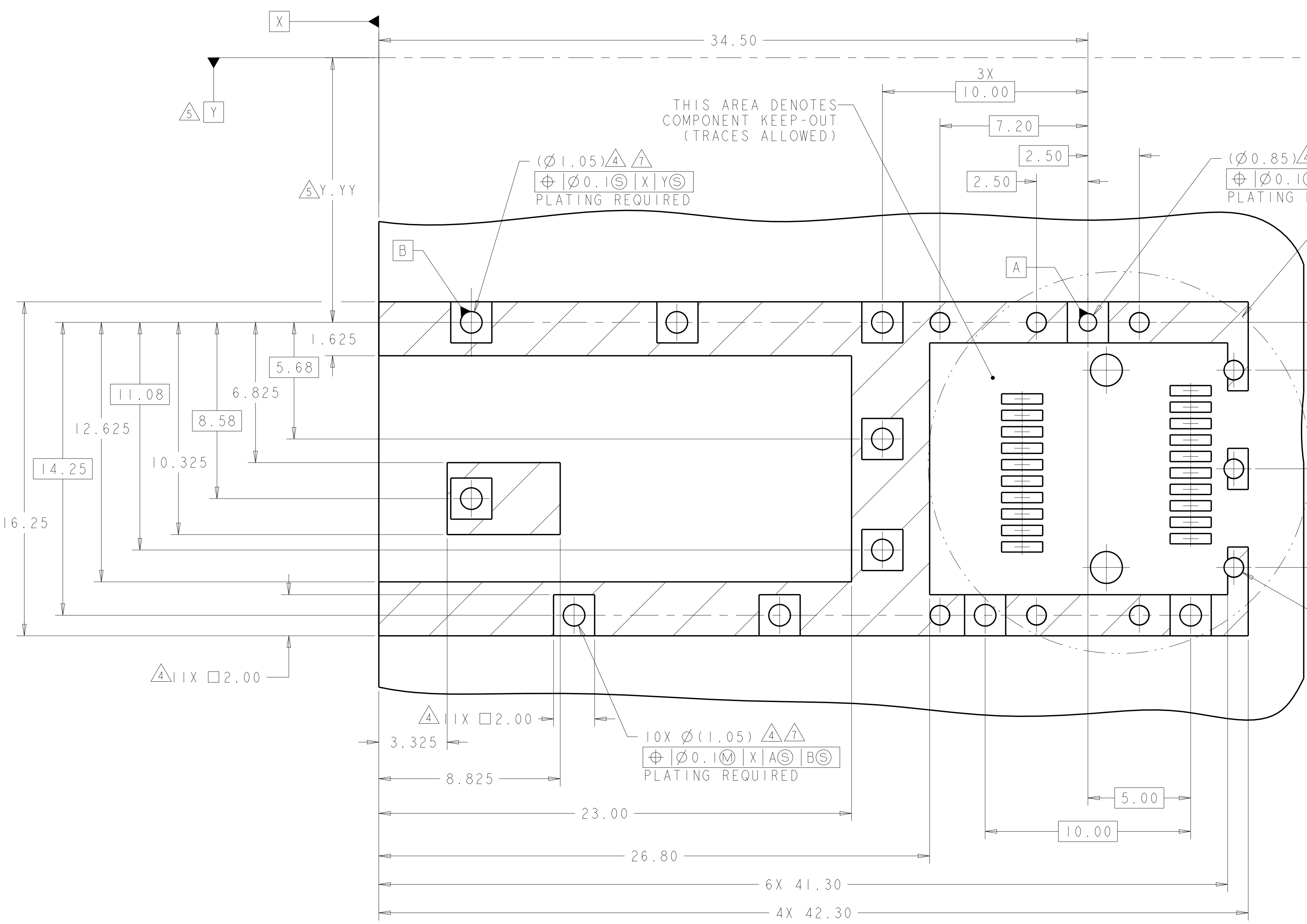

RECOMMENDED PCB LAYOUT FOR WITH
INSULATING TAPE PART
SCALE 8:1

| | | | |
|--|--|----------------------------|---|
| THIS DRAWING IS A CONTROLLED DOCUMENT. | | DMN M. SCHMITT 07JUN07 | TE Connectivity |
| DIMENSIONS: mm | | CHK M. SCHMITT 07JUN07 | |
| TOLERANCES UNLESS OTHERWISE SPECIFIED: | | APVD B. WERTZ 07JUN07 | NAME SFP+ IXI CAGE ASSEMBLY, PRESS-FIT PRESS-FIT, EMI SPRINGS WITH HEATSINK |
| 0 PLC ±0.1 1 PLC ±0.1 2 PLC ±0.1 3 PLC ±0.05 4 PLC ±0.05 ANGLES ±0.05 | | PRODUCT SPEC 108-2364 | SIZE CAGE CODE DRAWING NO. A100779C=2007198 |
| MATERIAL FINISH | | APPLICATION SPEC 114-13120 | RESTRICTED TO |
| | | WEIGHT | SCALE 6:1 SHEET 4 OF 4 REV C3 |
| | | Customer Drawing | |