



Chipsmall Limited consists of a professional team with an average of over 10 year of expertise in the distribution of electronic components. Based in Hongkong, we have already established firm and mutual-benefit business relationships with customers from,Europe,America and south Asia,supplying obsolete and hard-to-find components to meet their specific needs.

With the principle of “Quality Parts,Customers Priority,Honest Operation,and Considerate Service”,our business mainly focus on the distribution of electronic components. Line cards we deal with include Microchip,ALPS,ROHM,Xilinx,Pulse,ON,Everlight and Freescale. Main products comprise IC,Modules,Potentiometer,IC Socket,Relay,Connector.Our parts cover such applications as commercial,industrial, and automotives areas.

We are looking forward to setting up business relationship with you and hope to provide you with the best service and solution. Let us make a better world for our industry!



Contact us

Tel: +86-755-8981 8866 Fax: +86-755-8427 6832

Email & Skype: info@chipsmall.com Web: www.chipsmall.com

Address: A1208, Overseas Decoration Building, #122 Zhenhua RD., Futian, Shenzhen, China



THIS DRAWING IS UNPUBLISHED. RELEASED FOR PUBLICATION
 BY AMP INCORPORATED, ALL RIGHTS RESERVED.

LOC	DIST	REVISIONS			
P	LTR	DESCRIPTION	DATE	DWN	APVD
AJ	16	AK	REVISED PER EC 0514-0288-02	18DEC02	DD KW

- ① BRASS PER QQ-B-626
- ② BERYLLIUM COPPER PER ASTM-B-196
- ③ NYLON PER ASTM-D-4066, BLACK
- ④ POLYMETHYLPENTENE GENERAL PURPOSE, NATURAL
- ⑤ .00076 [.000030] MINIMUM GOLD PER MIL-G-45204
- ⑥ WEIGHT 201097-1 = .001935 LB AND 201097-7 = .001831 LB
- 7. SEE INSTRUCTION SHEET 1770
- ⑧ POLYESTER PER ASTM-D-3221, NATURAL

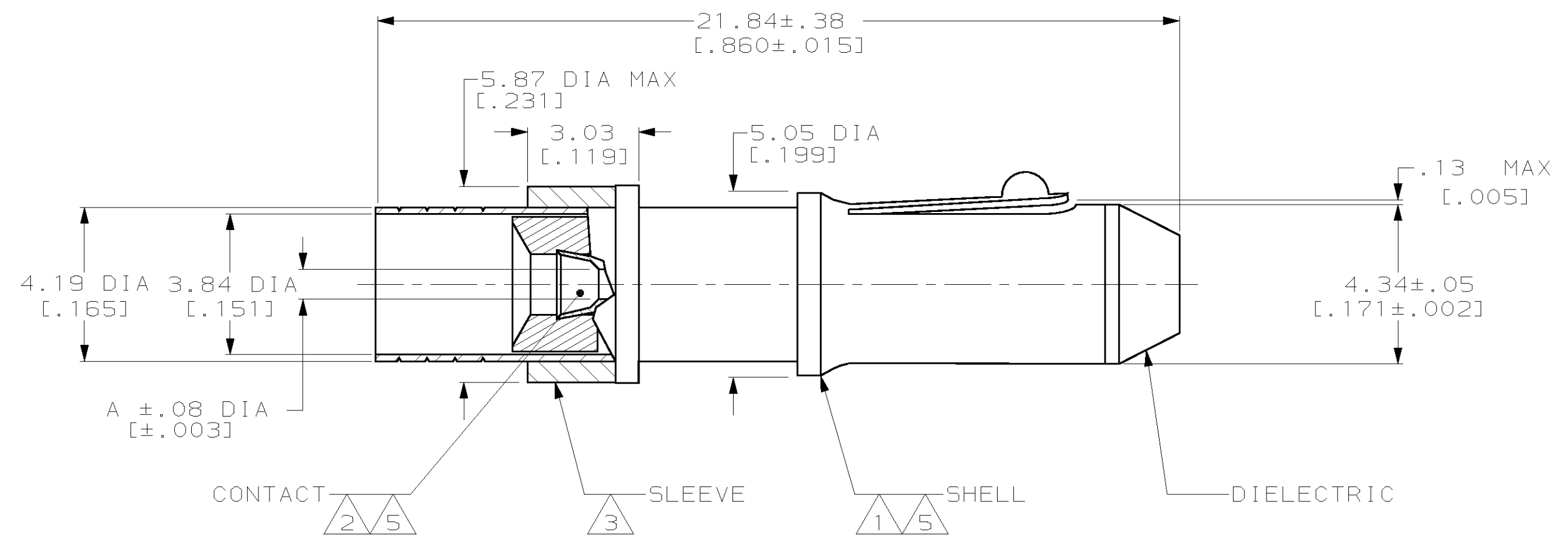

0.81 [$.032$]	④	201097-1
A	DIELECTRIC MATERIAL	PART NUMBER

THIS DRAWING IS A CONTROLLED DOCUMENT.		DWN J. KURTZ 14 DEC 89	TYCO Electronics Harrisburg, PA 17105-3608	
DIMENSIONS: mm [INCHES]		CHK M. SNEED 22 FEB 90	AMP CONTACT ASSEMBLY, PIN, MINATURE	
TOLERANCES UNLESS OTHERWISE SPECIFIED:		APVD B. ADAMS 22 FEB 90		
0 PLC ± 1 PLC ± 2 PLC ± 0.20 [$.008$] 3 PLC ± 4 PLC ± ANGLES ±		PRODUCT SPEC -	NAME	
MATERIAL		FINISH	WEIGHT	RESTRICTED TO
SEE NOTES		SEE NOTES	⑥ -	-
		CUSTOMER DRAWING	SCALE 8:1	SHEET 1 OF 1
			DRAWING NO. A2 00779 C-201097	REV AK

201097