



Chipsmall Limited consists of a professional team with an average of over 10 year of expertise in the distribution of electronic components. Based in Hongkong, we have already established firm and mutual-benefit business relationships with customers from,Europe,America and south Asia,supplying obsolete and hard-to-find components to meet their specific needs.

With the principle of “Quality Parts,Customers Priority,Honest Operation,and Considerate Service”,our business mainly focus on the distribution of electronic components. Line cards we deal with include Microchip,ALPS,ROHM,Xilinx,Pulse,ON,Everlight and Freescale. Main products comprise IC,Modules,Potentiometer,IC Socket,Relay,Connector.Our parts cover such applications as commercial,industrial, and automotives areas.

We are looking forward to setting up business relationship with you and hope to provide you with the best service and solution. Let us make a better world for our industry!



Contact us

Tel: +86-755-8981 8866 Fax: +86-755-8427 6832

Email & Skype: info@chipsmall.com Web: www.chipsmall.com

Address: A1208, Overseas Decoration Building, #122 Zhenhua RD., Futian, Shenzhen, China



THIS DRAWING IS UNPUBLISHED.

RELEASED FOR PUBLICATION

-. - .

© COPYRIGHT - By -

ALL RIGHTS RESERVED.

REVISIONS
変更

P	LTR	DESCRIPTION	DATE	DWN	APVD
	D	OBSOLETE ECR-16-004581	15APR2016	C.H	A.K

OBSOLETE

THIS DRAWING IS A CONTROLLED DOCUMENT.

DWN Y.SHINO 18SEP2009

CHK S.KAJINUMA 18SEP2009

APVD S.KAJINUMA 18SEP2009

PRODUCT SPEC
製品規格

APPLICATION SPEC
取付適用規格

WEIGHT 0.000000

CUSTOMER DRAWING



NAME
名称 LCD COAXIAL EMBEDDED DISPLAY INTERFACE
(LCEDI) 0.5mm PITCH CONN
PLUG HSG ASSY

SIZE	CAGE CODE	DRAWING NO 番号	RESTRICTED TO
A3	00779	C-2023344	-

DIMENSIONS:
単位: 耗
mm

TOLERANCES UNLESS
OTHERWISE SPECIFIED:
一般公差

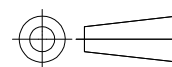

0 RLC	± -
1 PLC	± -
2 PLC	± -
3 PLC	± -
4 PLC	± -
ANGLES	± -

MATERIAL
材料

FINISH
仕上

SCALE 尺度 4:1	SHEET 1 OF 1	REV D
-----------------	-----------------	----------