



Chipsmall Limited consists of a professional team with an average of over 10 year of expertise in the distribution of electronic components. Based in Hongkong, we have already established firm and mutual-benefit business relationships with customers from,Europe,America and south Asia,supplying obsolete and hard-to-find components to meet their specific needs.

With the principle of “Quality Parts,Customers Priority,Honest Operation,and Considerate Service”,our business mainly focus on the distribution of electronic components. Line cards we deal with include Microchip,ALPS,ROHM,Xilinx,Pulse,ON,Everlight and Freescale. Main products comprise IC,Modules,Potentiometer,IC Socket,Relay,Connector.Our parts cover such applications as commercial,industrial, and automotives areas.

We are looking forward to setting up business relationship with you and hope to provide you with the best service and solution. Let us make a better world for our industry!



Contact us

Tel: +86-755-8981 8866 Fax: +86-755-8427 6832

Email & Skype: info@chipsmall.com Web: www.chipsmall.com

Address: A1208, Overseas Decoration Building, #122 Zhenhua RD., Futian, Shenzhen, China



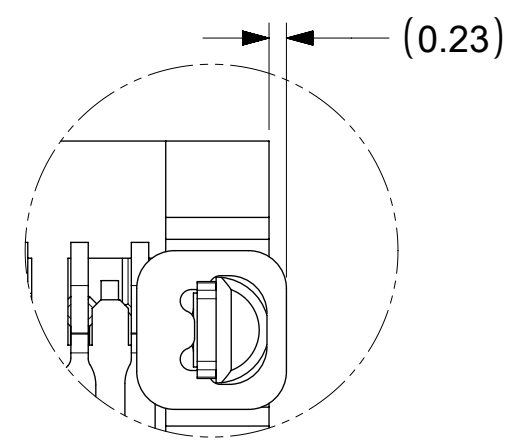
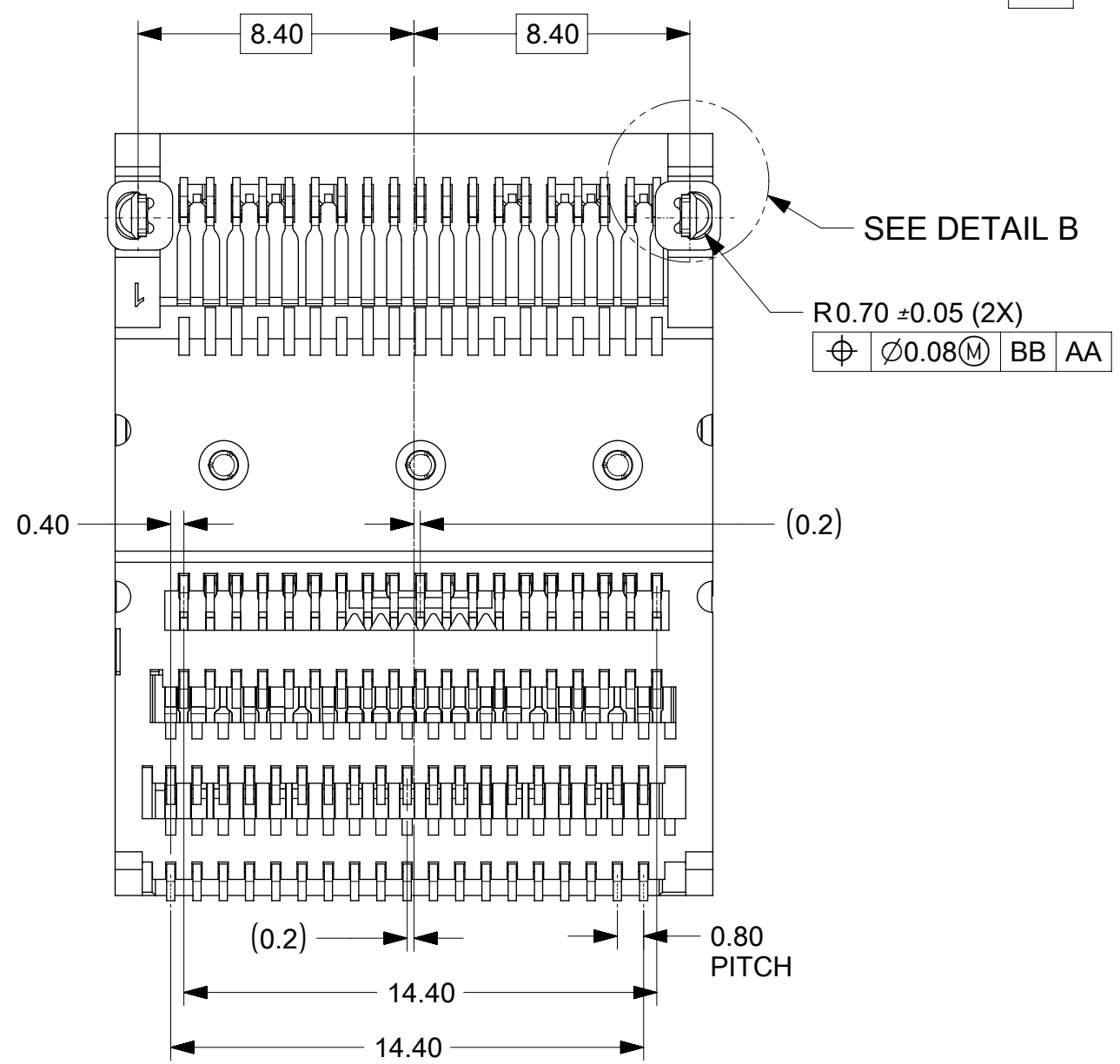
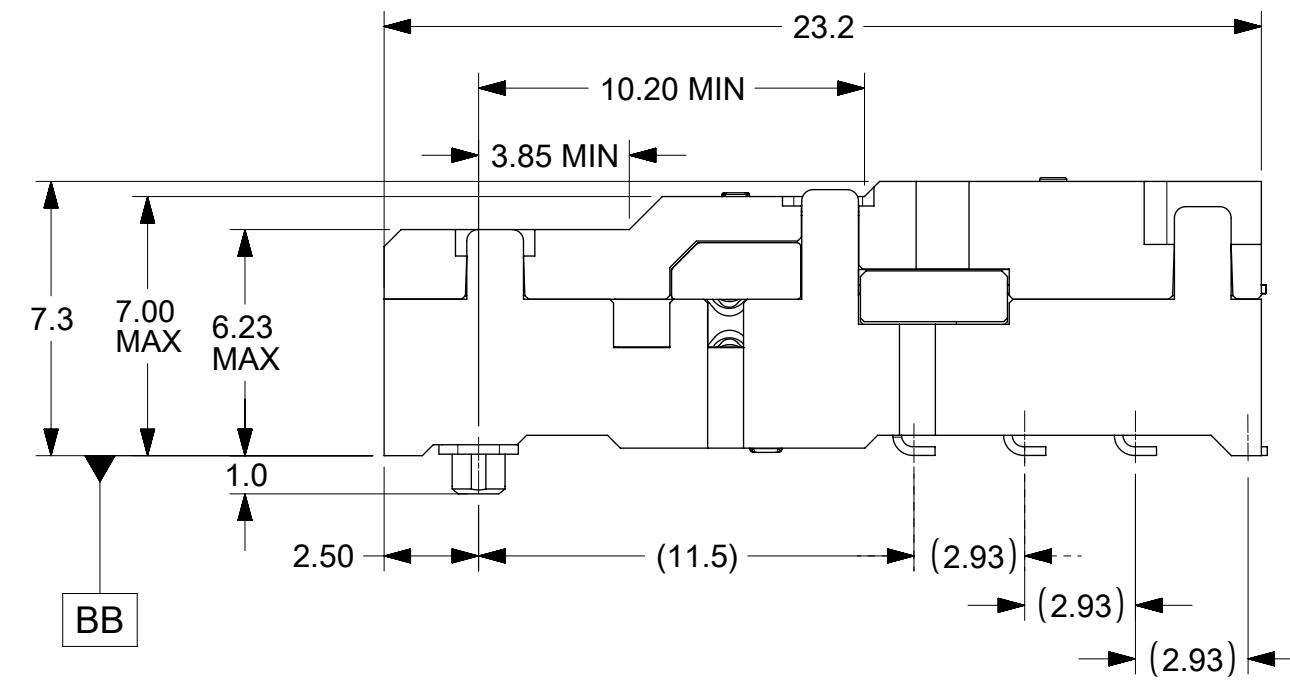
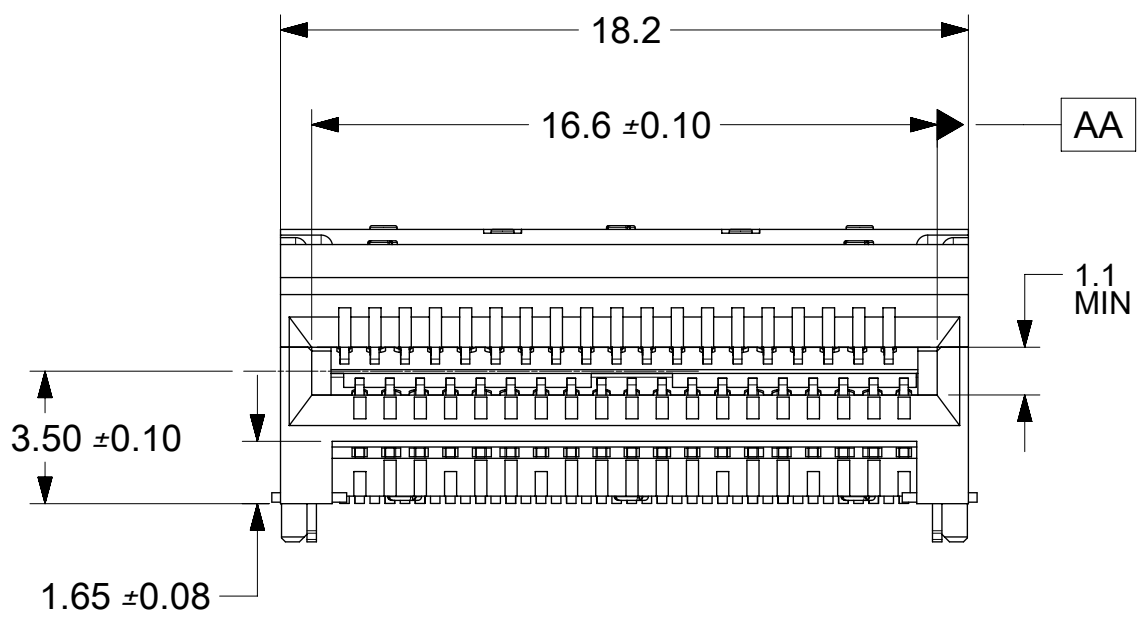
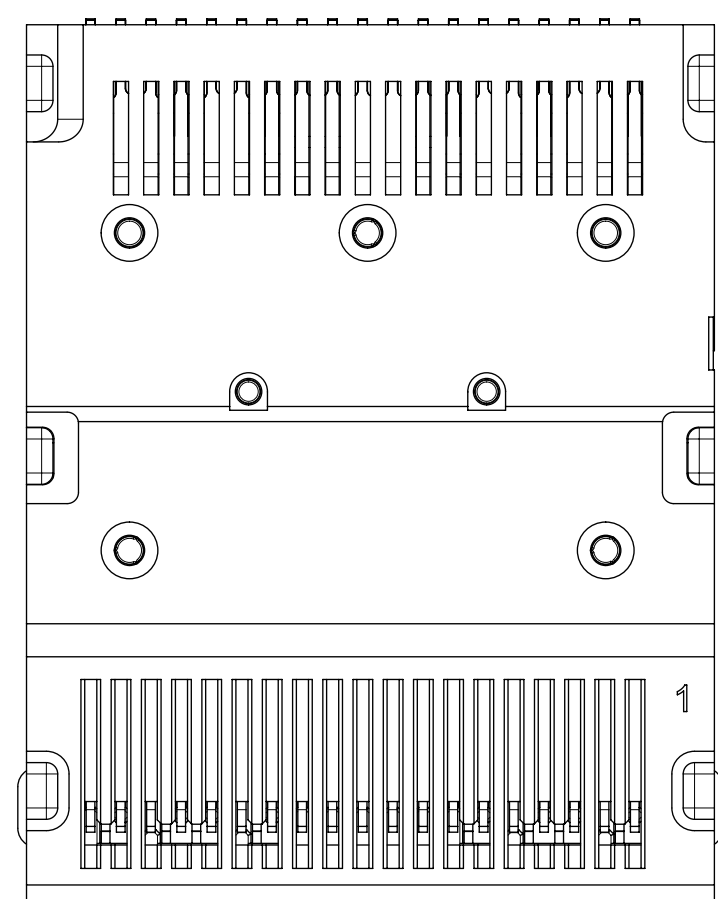

DETAIL B
SCALE 10:1

NOTES

1. MATERIAL:
HOUSING - HIGH TEMPERATURE THERMOPLASTIC GLASS FILLED. UL 94V-0. BLACK.
TERMINALS - COPPER ALLOY
SOLDER RING / NAIL: NICKEL SILVER
2. PLATING:
CONTACT AREA - 0.76um MIN GOLD OVER 2.54um MIN NICKEL
SOLDER AREA - 2.54um MIN TIN OVER 2.54um MAX NICKEL
3. TERMINAL SOLDER FEET TO BE COPLANAR WITHIN 0.10/.004 MEASURED FROM FRONT HOUSING STAND OFF (DATUM -BB-)
4. DATE CODE: 4 DIGIT (3 DIGIT DATE, 1 DIGIT YEAR)
5. CIRCUIT IDENTIFIER: SEE APPROPRIATE INDUSTRY SPECIFICATION FOR LOCATION OF PIN 1
6. PACKAGED PER PACKING SPECIFICATION: 2027188000
7. CONFORMS TO PRODUCT SPECIFICATION: 2027189010-PS
8. APPLICATION SPECIFICATION: 2027189030-AS
9. THIS PART CONFORMS TO CLASS C REQUIREMENTS OF COSMETIC SPECIFICATION PS-45499-002

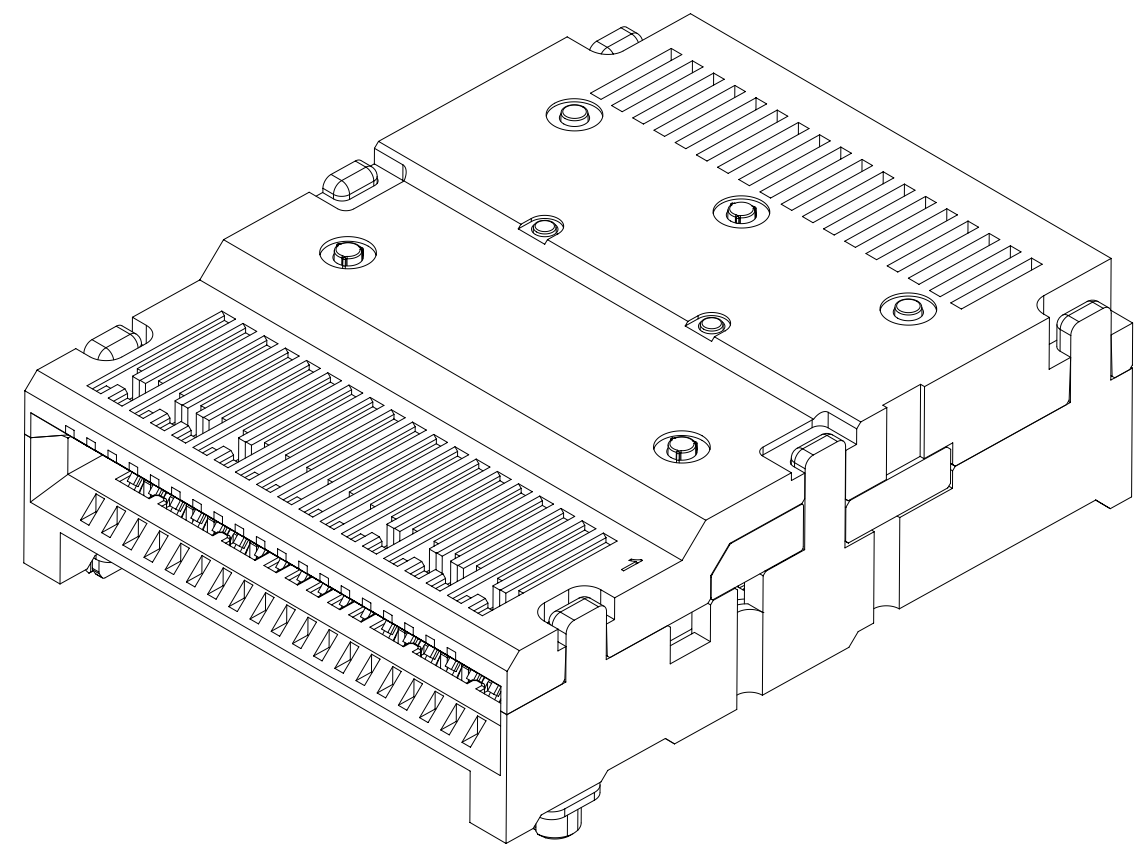

SYMBOLS										THIS DRAWING CONTAINS INFORMATION THAT IS PROPRIETARY TO MOLEX ELECTRONIC TECHNOLOGIES, LLC AND SHOULD NOT BE USED WITHOUT WRITTEN PERMISSION																			
DIMENSION UNITS					SCALE					CURRENT REV DESC: SEE REVISION TABLE																			
mm					5:1					EC NO: 175630 DRWN: MCAIN 2018/04/24 CHK'D: MWOLFE 2018/05/07 APPR: SMILLER 2018/05/10 INITIAL REVISION: DRWN: LZHUANG06 2017/04/07 APPR: SMILLER 2017/12/18 DRAFT WHERE APPLICABLE MUST REMAIN WITHIN DIMENSIONS THIRD ANGLE PROJECTION DRAWING SERIES C-SIZE 202718																			
GENERAL TOLERANCES (UNLESS SPECIFIED)																				ASSEMBLY DDQ SMT CONNECTOR 76CKT									
ANGULAR TOL ± 1.0°																				PRODUCT CUSTOMER DRAWING									
4 PLACES ±					2 PLACES ± 0.13															DOCUMENT NUMBER					DOC TYPE DOC PART REVISION				
3 PLACES ±					1 PLACE ± 0.25															2027180100					PSD 000 C				
2 PLACES ±					0 PLACES ±					MATERIAL NUMBER					CUSTOMER														
1 PLACE ±					0 PLACES ±					202718-0100					SHEET NUMBER														
DRAFT WHERE APPLICABLE MUST REMAIN WITHIN DIMENSIONS					THIRD ANGLE PROJECTION					DRAWING SERIES					SHEET NUMBER														
					C-SIZE 202718					202718-0100					1 OF 6														

DOCUMENT STATUS	P1	RELEASE DATE	2018/05/10	16:07:35
-----------------	----	--------------	------------	----------

MOTHERBOARD FOOTPRINT RECOMMENDATION

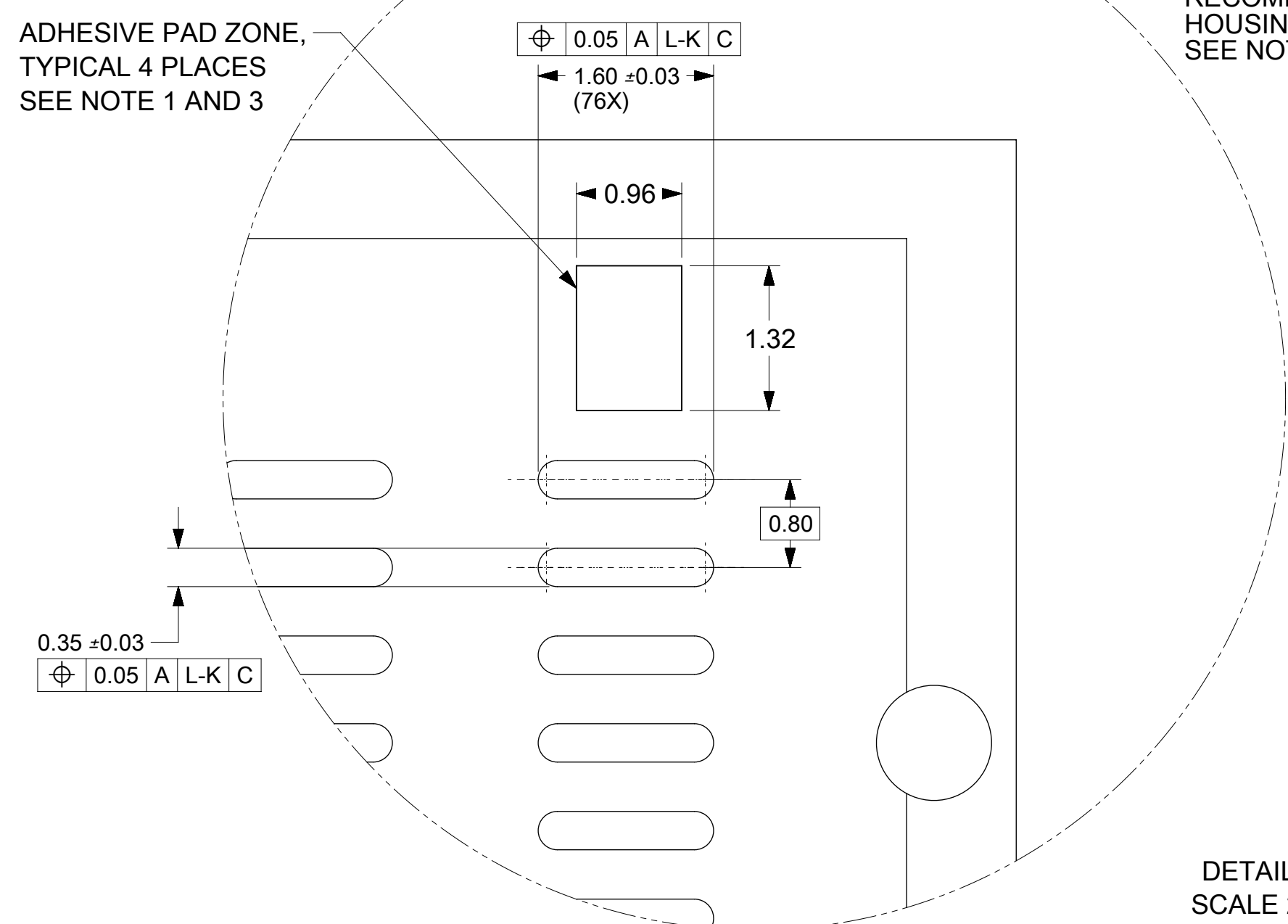
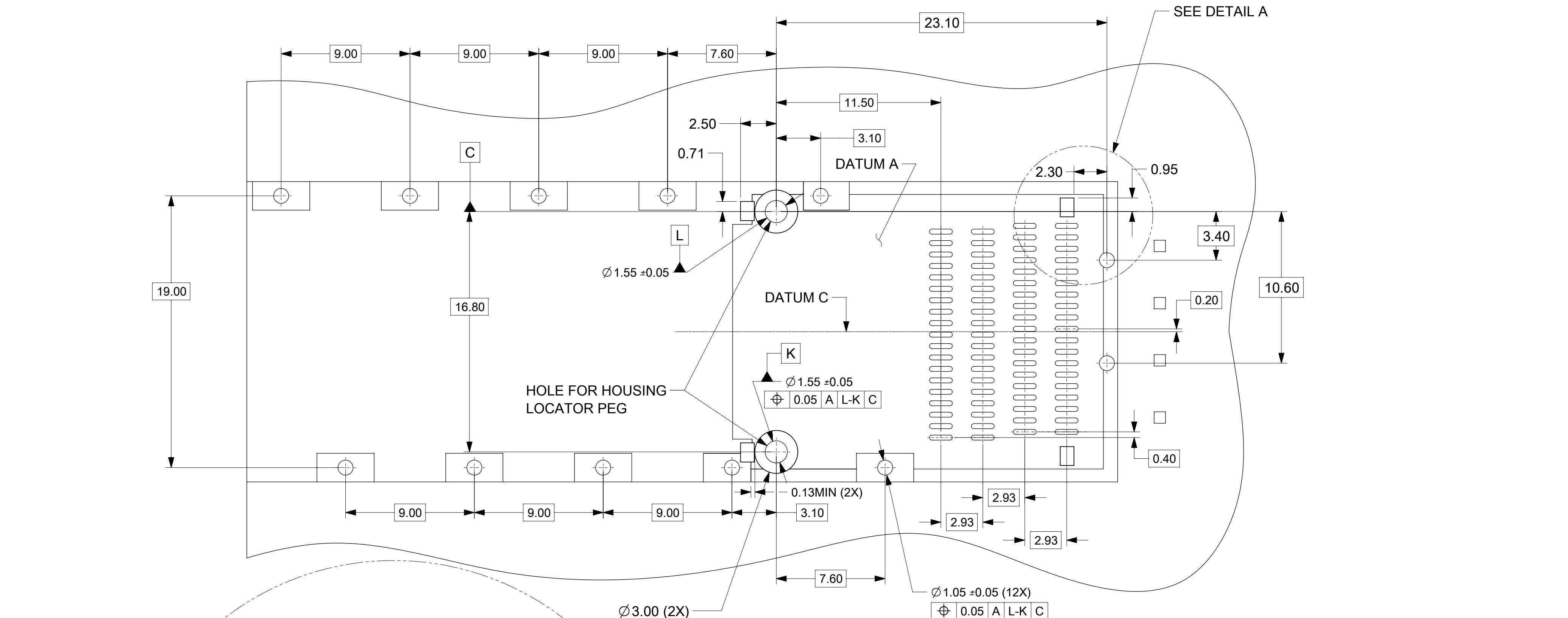

HOLE FOR HOUSING LOCATOR PEG

Ø 1.55 ± 0.05
 ⊕ 0.05 A L-K C

Ø 3.00 (2X)
 RECOMMENDED SOLDER PAD FOR HOUSING RETENTION
 SEE NOTE 2 AND 3

- NOTE:
- SMT ADHESIVE IS RECOMMENDED FOR USE WITH TWO PASS REFLOW PROCESS.
 - CONNECTOR SOLDER RING IS RECOMMENDED FOR USE WITH TWO PASS REFLOW PROCESS. REDUCE SIZE OF 2.00X4.00 CAGE COPPER PAD TO MAINTAIN GAP OF AT LEAST 0.13MM BETWEEN SOLDER RING PAD AND CAGE COPPER PAD.
 - SEE APPLICATION SPECIFICATION 2027189030-AS FOR MORE DETAILS ON TWO PASS REFLOW PROCESS WHERE CONNECTOR IS ON UNDERSIDE OF PCB DURING SECOND PASS.
 - SEE APPLICATION SPECIFICATION 2027189030-AS FOR STENCIL RECOMMENDATION. STENCIL RECOMMENDATION IS A GUIDELINE ONLY. MANUFACTURING PROCESS PARAMETERS WILL DEFINE THE ACTUAL STENCIL.
 RECOMMENDED STENCIL THICKNESS: 0.13MM (.005")
 SOLDER FOOT: ~100% OF PAD
 SOLDER RING: ~45% OF PAD

SYMBOLS										THIS DRAWING CONTAINS INFORMATION THAT IS PROPRIETARY TO MOLEX ELECTRONIC TECHNOLOGIES, LLC AND SHOULD NOT BE USED WITHOUT WRITTEN PERMISSION																			
DIMENSION UNITS					SCALE					CURRENT REV DESC: SEE REVISION TABLE																			
mm					5:1					EC NO: 175630																			
GENERAL TOLERANCES (UNLESS SPECIFIED)										DRWN: MCAIN 2018/04/24																			
ANGULAR TOL ± 1.0°										CHK'D: MWOLFE 2018/05/07																			
4 PLACES ±										APPR: SMILLER 2018/05/10																			
3 PLACES ±										INITIAL REVISION:																			
2 PLACES ± 0.13										DRWN: LZHUANG06 2017/04/07																			
1 PLACE ± 0.25										APPR: SMILLER 2017/12/18																			
0 PLACES ±										DRAFT WHERE APPLICABLE MUST REMAIN WITHIN DIMENSIONS																			
THIRD ANGLE PROJECTION					DRAWING					SERIES					MATERIAL NUMBER					CUSTOMER					SHEET NUMBER				
C-SIZE					202718					202718-0100										2 OF 6									



ASSEMBLY DDQ SMT CONNECTOR 76CKT

PRODUCT CUSTOMER DRAWING

DOCUMENT NUMBER: 2027180100
 DOC TYPE: PSD
 DOC PART: 000
 REVISION: C

PIN OUT TABLE

PIN #	Symbol	Description	Notes
1	GND	Ground	
2	TX2n	Transmitter Inverted Data Input	
3	TX2p	Transmitter Non-Inverted Data Input	
4	GND	Ground	
5	TX4n	Transmitter Inverted Data Input	
6	TX4p	Transmitter Non-Inverted Data Input	
7	GND	Ground	
8	ModSelL	Module Select	
9	ResetL	Module Reset	
10	VCC RX	+3.3V Power Supply Receiver	
11	SCL	2-wire serial interface clock	
12	SDA	2-wire serial interface data	
13	GND	Ground	
14	RX3p	Receiver Non-Inverted Data Output	
15	RX3n	Receiver Inverted Data Output	
16	GND	Ground	
17	RX1p	Receiver Non-Inverted Data Output	
18	RX1n	Receiver Inverted Data Output	
19	GND	Ground	
20	GND	Ground	
21	RX2n	Receiver Inverted Data Output	
22	RX2p	Receiver Non-Inverted Data Output	
23	GND	Ground	
24	RX4n	Receiver Inverted Data Output	
25	RX4p	Receiver Non-Inverted Data Output	
26	GND	Ground	
27	ModPrsL	Module Present	
28	IntL	Interrupt	
29	VCC TX	+3.3V Power supply transmitter	
30	VCC1	+3.3V Power supply	
31	LPMODE	Low Power Mode	
32	GND	Ground	
33	TX3p	Transmitter Non-Inverted Data Input	
34	TX3n	Transmitter Inverted Data Input	
35	GND	Ground	
36	TX1p	Transmitter Non-Inverted Data Input	
37	TX1n	Transmitter Inverted Data Input	
38	GND	Ground	
39	GND	Ground	
40	TX6n	Transmitter Inverted Data Input	
41	TX6p	Transmitter Non-Inverted Data Input	
42	GND	Ground	
43	TX8n	Transmitter Inverted Data Input	
44	TX8p	Transmitter Non-Inverted Data Input	
45	GND	Ground	
46	TBD	For future use	
47	TBD	For future use	
48	VCC	+3.3V Power supply	
49	TBD	For future use	
50	TBD	For future use	
51	GND	Ground	
52	RX7p	Receiver Non-Inverted Data Output	
53	RX7n	Receiver Inverted Data Output	
54	GND	Ground	
55	RX5p	Receiver Non-Inverted Data Output	
56	RX5n	Receiver Inverted Data Output	
57	GND	Ground	
58	GND	Ground	
59	RX6n	Receiver Inverted Data Output	
60	RX6p	Receiver Non-Inverted Data Output	
61	GND	Ground	
62	RX8n	Receiver Inverted Data Output	
63	RX8p	Receiver Non-Inverted Data Output	
64	GND	Ground	
65	NC	No Connect	
66	TBD	For future use	
67	VCC	+3.3V Power supply	
68	VCC	+3.3V Power supply	
69	TBD	For future use	
70	GND	Ground	
71	TX7p	Transmitter Non-Inverted Data Input	
72	TX7n	Transmitter Inverted Data Input	
73	GND	Ground	
74	TX5p	Transmitter Non-Inverted Data Input	
75	TX5n	Transmitter Inverted Data Input	
76	GND	Ground	

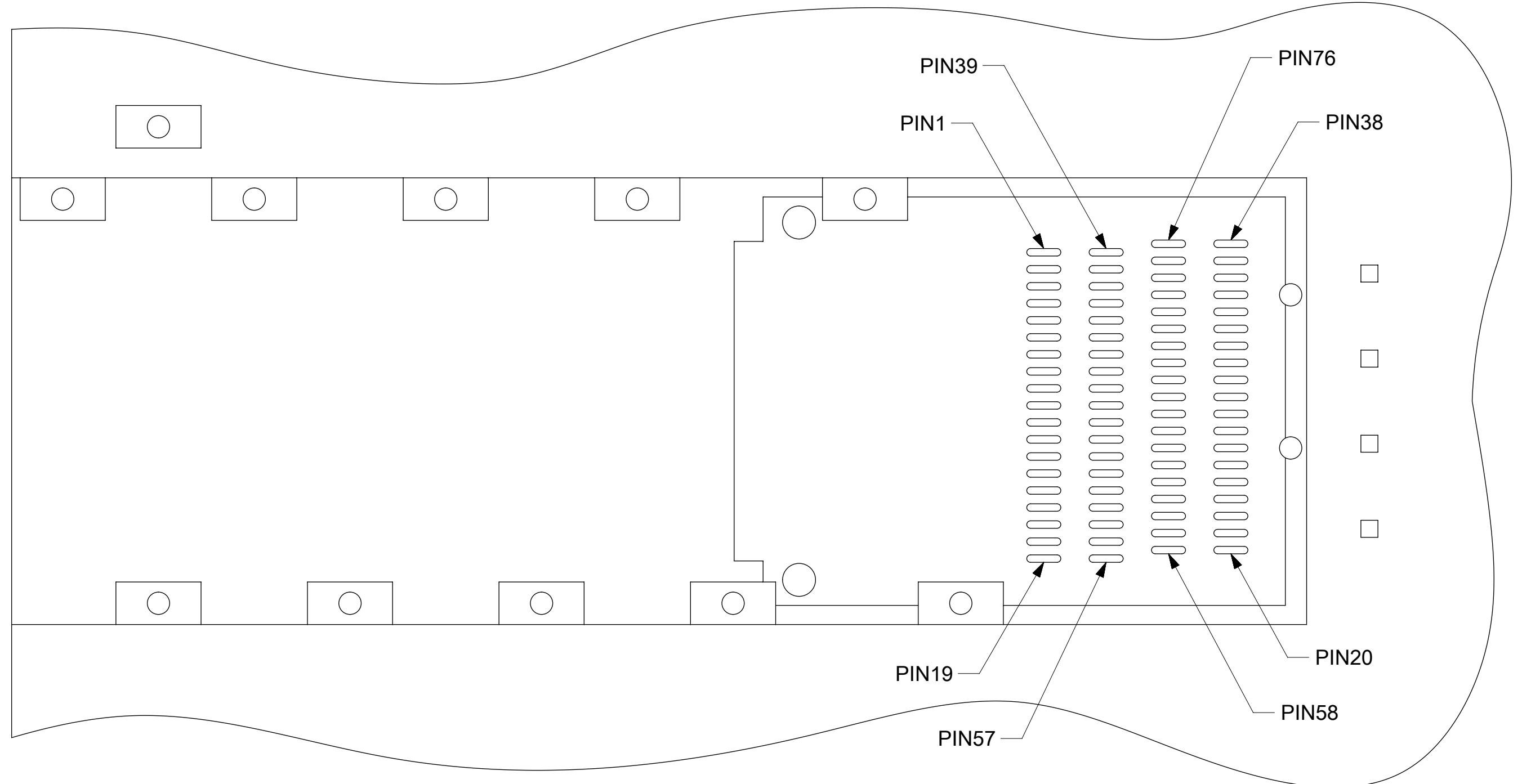

Notes:
 * Reference only.
 ** Please align QSFP-DD MSA for pin mapping

THIS DRAWING CONTAINS INFORMATION THAT IS PROPRIETARY TO MOLEX ELECTRONIC TECHNOLOGIES, LLC AND SHOULD NOT BE USED WITHOUT WRITTEN PERMISSION									
SYMBOLS		DIMENSION UNITS		SCALE		CURRENT REV DESC: SEE REVISION TABLE			
▽ = 0		mm		5:1		molex ASSEMBLY DDQ SMT CONNECTOR 76CKT PRODUCT CUSTOMER DRAWING EC NO: 175630 DRWN: MCAIN 2018/04/24 CHK'D: MWOLFE 2018/05/07 APPR: SMILLER 2018/05/10 INITIAL REVISION: DRWN: LZHUANG06 2017/04/07 APPR: SMILLER 2017/12/18			
▽ = 0		GENERAL TOLERANCES (UNLESS SPECIFIED)							
▽ = 0		ANGULAR TOL ± 1.0°							
▽ = 0		4 PLACES ±							
▽ = 0		3 PLACES ±				DOCUMENT NUMBER			
▽ = 0		2 PLACES ± 0.13				2027180100			
▽ = 0		1 PLACE ± 0.25				DOC TYPE DOC PART REVISION			
▽ = 0		0 PLACES ±				PSD 000 C			
▽ = 0		DRAFT WHERE APPLICABLE MUST REMAIN WITHIN DIMENSIONS		THIRD ANGLE PROJECTION		DRAWING		SERIES	
▽ = 0				C-SIZE		202718		MATERIAL NUMBER	
▽ = 0								CUSTOMER	
▽ = 0								SHEET NUMBER	
▽ = 0								3 OF 6	

PCB LAYOUT FOR BELLY TO BELLY MOUNTING

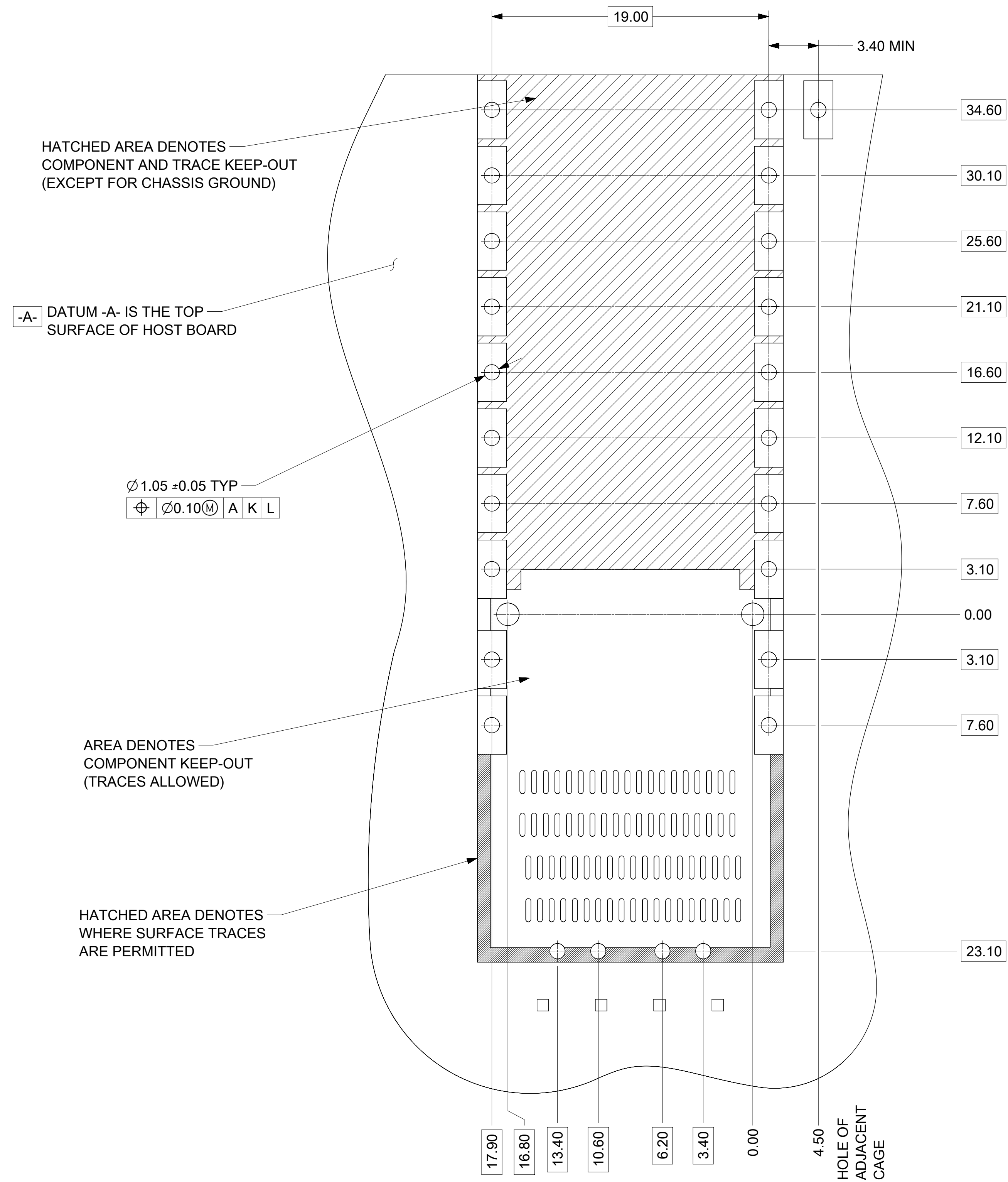

- NOTES:
1. PADS AND VIAS GO TO CHASSIS GROUND. (RECOMMENDED PADS TO BE 2.00X4.00MM).
 2. RECOMMENDED THRU HOLE PLATING INCLUDES HASL, OSP, OR IMMERSION (GOLD, SILVER, OR TIN).
 3. CONNECTOR PAD LAYOUT PER DDQ-MSA WILL ACCOMODATE MOLEX CONNECTOR 2027180100.

SYMBOLS	THIS DRAWING CONTAINS INFORMATION THAT IS PROPRIETARY TO MOLEX ELECTRONIC TECHNOLOGIES, LLC AND SHOULD NOT BE USED WITHOUT WRITTEN PERMISSION		
	DIMENSION UNITS	SCALE	CURRENT REV DESC: SEE REVISION TABLE
▽ = 0	mm	5:1	<p>molex</p> <p>ASSEMBLY DDQ SMT CONNECTOR 76CKT</p> <p>PRODUCT CUSTOMER DRAWING</p> <p>DOCUMENT NUMBER: 2027180100 DOC TYPE: PSD DOC PART: 000 REVISION: C</p> <p>MATERIAL NUMBER: 202718-0100 CUSTOMER: SHEET NUMBER: 4 OF 6</p>
▽ = 0	GENERAL TOLERANCES (UNLESS SPECIFIED)		
▽ = 0	ANGULAR TOL ± 1.0°		
▽ = 0	4 PLACES	±	
▽ = 0	3 PLACES	±	
▽ = 0	2 PLACES	± 0.13	
▽ = 0	1 PLACE	± 0.25	
▽ = 0	0 PLACES	±	
▽ = 0	DRAFT WHERE APPLICABLE MUST REMAIN WITHIN DIMENSIONS	THIRD ANGLE PROJECTION	DRAWING: D-SIZE SERIES: 202718
▽ = 0			EC NO: 175630
			DRWN: MCAIN 2018/04/24
			CHK'D: MWOLFE 2018/05/07
			APPR: SMILLER 2018/05/10
			INITIAL REVISION:
			DRWN: LZHUANG06 2017/04/07
			APPR: SMILLER 2017/12/18

BEZEL AND BOARD POSITION DIMENSIONS FOR SINGLE SIDE MOUNTING

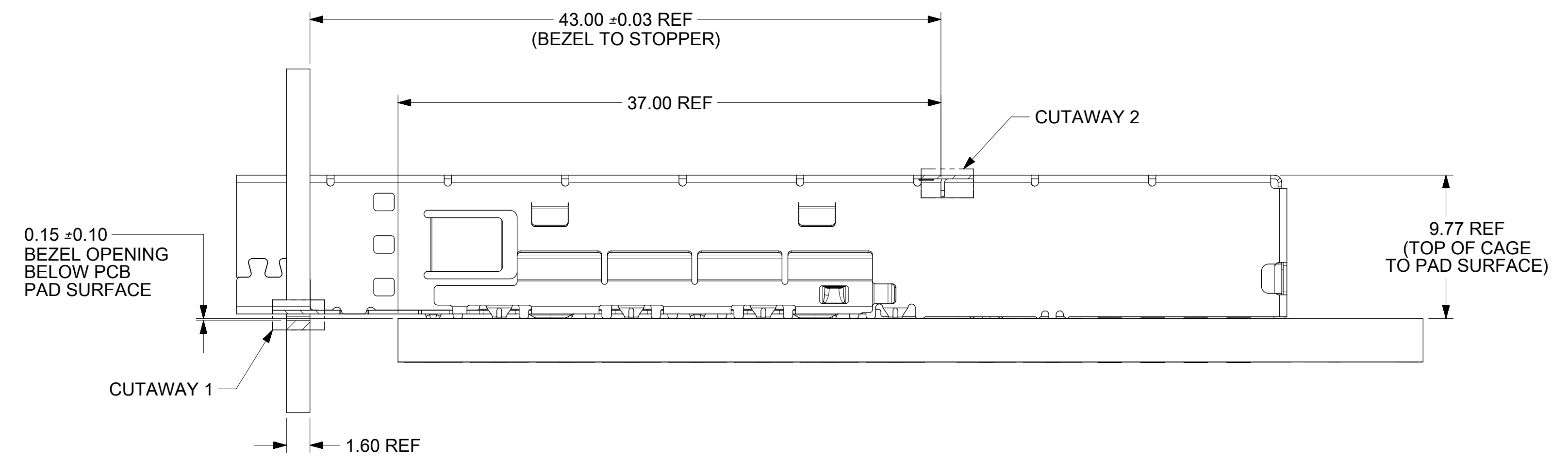
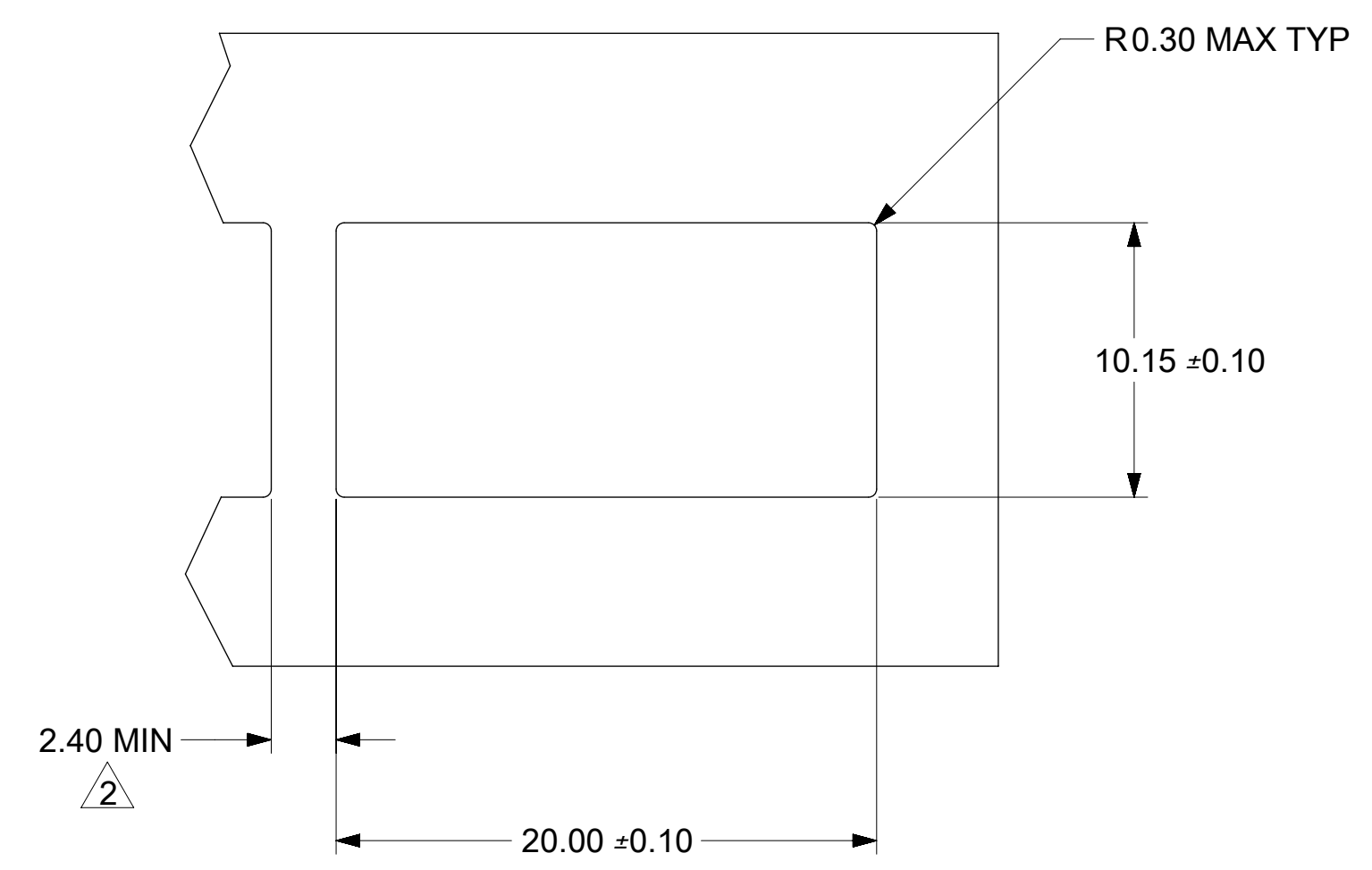

BEZEL AND BOARD POSITION DIMENSIONS FOR BELLY TO BELLY MOUNTING

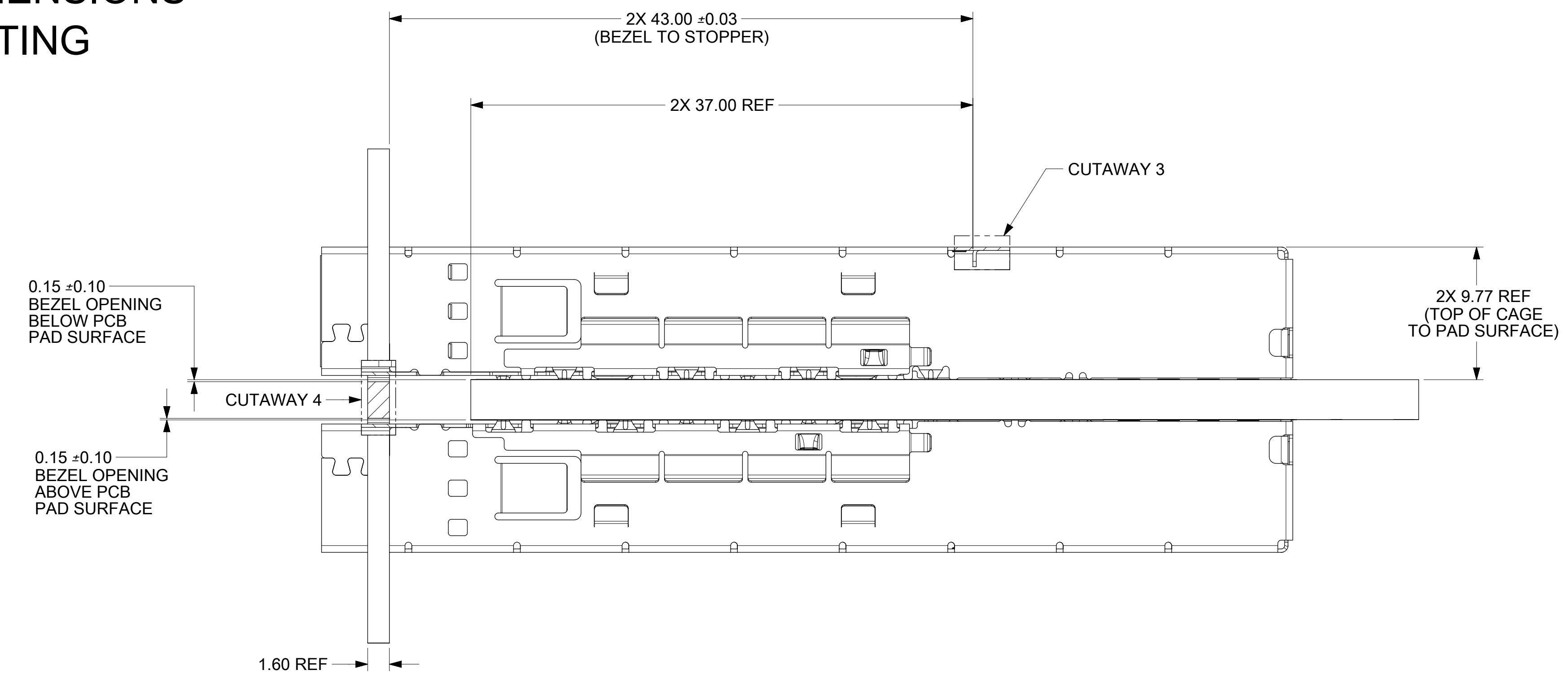
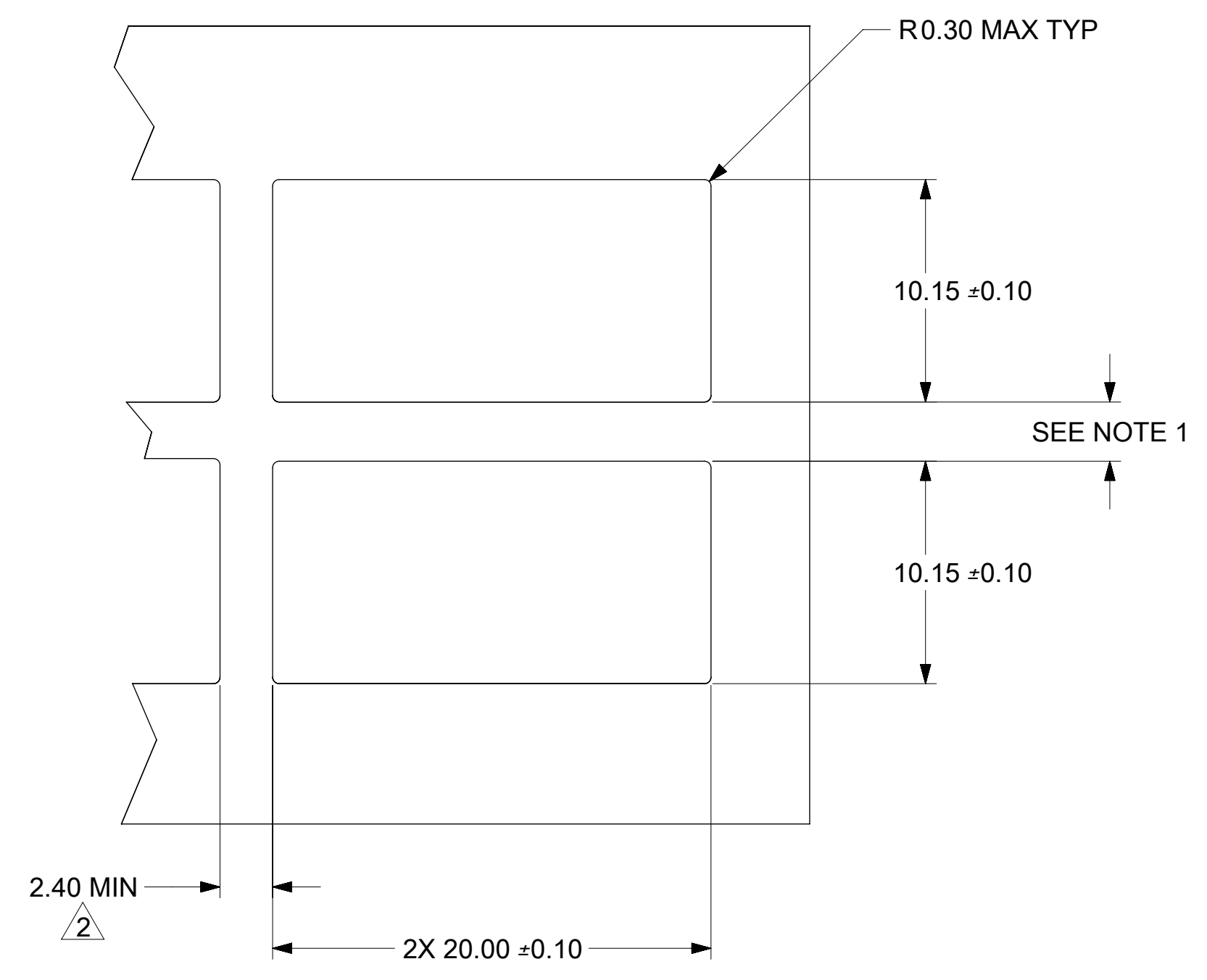

NOTES:
 1. PCB THICKNESS VARIATION MUST BE CONSIDERED WHEN DETERMINING BEZEL OPENING, SIZE, AND LOCATION.
 2. THIS DIMENSION IS FOR REFERENCE ONLY, USER CAN MODIFY DEPENDING ON APPLICATION, OPENING FOR ADJACENT CAGE ON PCB LAYOUT VARIES BASED ON MODIFICATION.

SYMBOLS		THIS DRAWING CONTAINS INFORMATION THAT IS PROPRIETARY TO MOLEX ELECTRONIC TECHNOLOGIES, LLC AND SHOULD NOT BE USED WITHOUT WRITTEN PERMISSION	
▽ = 0	DIMENSION UNITS	SCALE	CURRENT REV DESC: SEE REVISION TABLE
	mm	4:1	
▽ = 0	GENERAL TOLERANCES (UNLESS SPECIFIED)		
▽ = 0	ANGULAR TOL ± 1.0°		
▽ = 0	4 PLACES ±		
▽ = 0	3 PLACES ±		
▽ = 0	2 PLACES ± 0.13		
▽ = 0	1 PLACE ± 0.25		
▽ = 0	0 PLACES ±		
■ = 0	DRAFT WHERE APPLICABLE MUST REMAIN WITHIN DIMENSIONS		
▽ = 0	THIRD ANGLE PROJECTION		
		DRAWING	SERIES
		D-SIZE	202718
DOCUMENT NUMBER		MATERIAL NUMBER	CUSTOMER
2027180100		202718-0100	202718-0100
DOC TYPE		DOC PART	REVISION
PSD		000	C
DOCUMENT NUMBER		SHEET NUMBER	
2027180100		5 OF 6	

REVISION	DATE	DISCRIPTION
1	04/07/2017	INITIAL CONCEPT
2	09/27/2017	ADDED SHEET SHOWING VIEWS OF BOTH SINGLE SIDE AND BELLY TO BELLY MOUNTING, ADDED SOLDER PAD FOR HOUSING RETENTION, AND ADHESIVE PADS ADDED EXPLODED VIEWS
A	12/06/2017	INITIAL PROPOSAL - (ER)
A1	12/18/2017	INITIAL RELEASE (NEW PRODUCT)
B	12/21/2017	UPDATE VIEWS
B1	02/02/2018	UPDATE VIEWS, ADD PK AS PS SPEC, ADD ADHESIVE PADS NOTE, CORRECT BELLY TO BELLY PCB LAYOUT
B2	4/11/2018	ALIGN DIMENSIONAL CALLOUTS TO MATCH MSA
C	4/25/2018	ADD TWO PASS REFLOW PROCESS NOTE

SYMBOLS										THIS DRAWING CONTAINS INFORMATION THAT IS PROPRIETARY TO MOLEX ELECTRONIC TECHNOLOGIES, LLC AND SHOULD NOT BE USED WITHOUT WRITTEN PERMISSION									
DIMENSION UNITS		SCALE		CURRENT REV DESC: SEE REVISION TABLE															
	= 0	mm	1:1	EC NO: 175630 DRWN: MCAIN 2018/04/24 CHK'D: MWOLFE 2018/05/07 APPR: SMILLER 2018/05/10 PRODUCT CUSTOMER DRAWING															
	= 0	GENERAL TOLERANCES (UNLESS SPECIFIED)																	
	= 0	ANGULAR TOL ± 1.0°																	
	= 0	4 PLACES	±	INITIAL REVISION: DRWN: LZHUANG06 2017/04/07 APPR: SMILLER 2017/12/18															
	= 0	3 PLACES	±																
	= 0	2 PLACES	± 0.13																
	= 0	1 PLACE	± 0.25	DOCUMENT NUMBER		DOC TYPE		DOC PART		REVISION									
	= 0	0 PLACES	±	2027180100		PSD		000		C									
	= 0	DRAFT WHERE APPLICABLE MUST REMAIN WITHIN DIMENSIONS		THIRD ANGLE PROJECTION		DRAWING		SERIES		MATERIAL NUMBER		CUSTOMER		SHEET NUMBER					
	= 0					C-SIZE		202718		202718-0100				6 OF 6					

molex

ASSEMBLY DDQ SMT CONNECTOR 76CKT

PRODUCT CUSTOMER DRAWING

2027180100

PSD 000 C

202718-0100

6 OF 6

DOCUMENT STATUS	P1	RELEASE DATE	2018/05/10	16:07:35
-----------------	----	--------------	------------	----------