



Chipsmall Limited consists of a professional team with an average of over 10 year of expertise in the distribution of electronic components. Based in Hongkong, we have already established firm and mutual-benefit business relationships with customers from,Europe,America and south Asia,supplying obsolete and hard-to-find components to meet their specific needs.

With the principle of “Quality Parts,Customers Priority,Honest Operation,and Considerate Service”,our business mainly focus on the distribution of electronic components. Line cards we deal with include Microchip,ALPS,ROHM,Xilinx,Pulse,ON,Everlight and Freescale. Main products comprise IC,Modules,Potentiometer,IC Socket,Relay,Connector.Our parts cover such applications as commercial,industrial, and automotives areas.

We are looking forward to setting up business relationship with you and hope to provide you with the best service and solution. Let us make a better world for our industry!



Contact us

Tel: +86-755-8981 8866 Fax: +86-755-8427 6832

Email & Skype: info@chipsmall.com Web: www.chipsmall.com

Address: A1208, Overseas Decoration Building, #122 Zhenhua RD., Futian, Shenzhen, China



a) Part as supplied.

202K1**–100

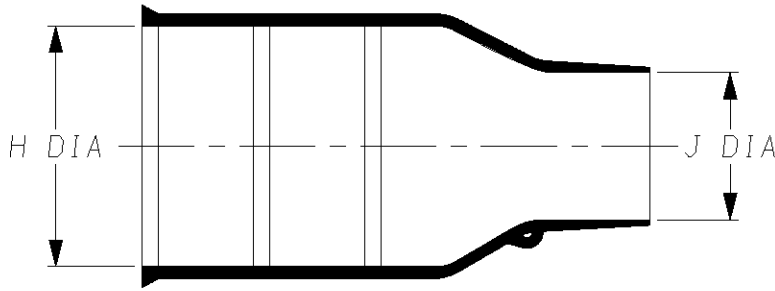

b) Part after unrestricted recovery.

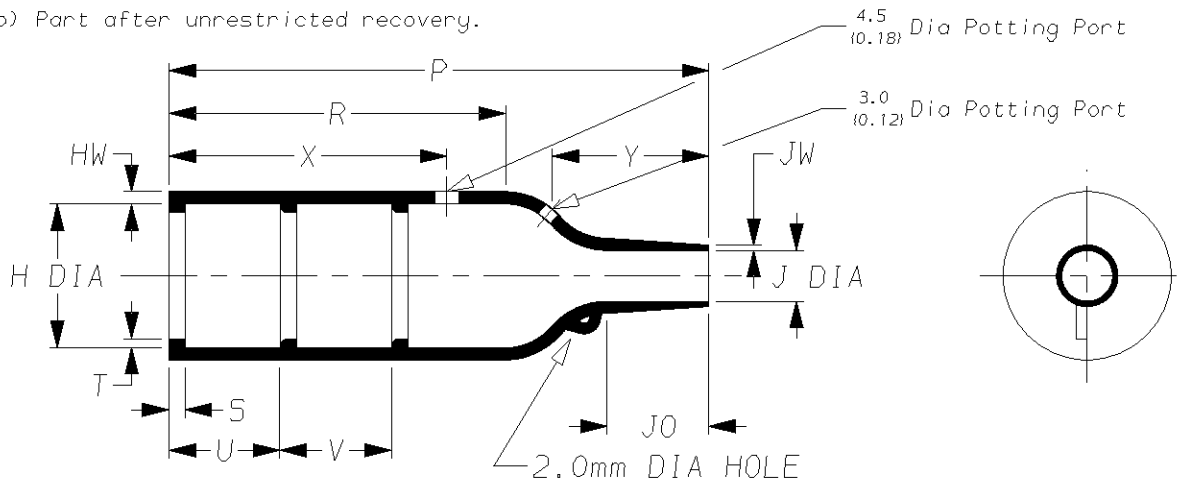
 DIMENSIONS in millimetres
(in inches, for reference)

| Part No. | H | | J | | P | R | S | T | U&V | JO | HW | JW | X | Y |
|-----------|--------------|----------------|--------------|----------------|---------------|--------------|---------------|---------------|--------------|----------------|---------------|---------------|--------------|--------------|
| | Min a | Max b | Min a | Max b | ±10% b | ±10% b | ±10% b | ±10% b | ±10% b | ±10% b | ±20% b | ±20% b | ±20% b | ±20% b |
| ① 202K121 | 24 (0.94) | 10.4 (0.41) | 14 (0.55) | 5.6 (0.22) | 38 (1.50) | 21 (0.83) | 3.0 (0.12) | 1.0 (0.04) | 12 (0.47) | 8.5 (0.33) | 1.6 (0.06) | 0.9 (0.04) | 24 (0.94) | 13 (0.51) |
| ① 202K132 | 30 (1.18) | 14.2 (0.56) | 15 (0.59) | 5.9 (0.23) | 55 (2.17) | 32 (1.26) | 3.0 (0.12) | 1.0 (0.04) | 12 (0.47) | 11.5 (0.45) | 1.8 (0.07) | 1.0 (0.04) | 24 (0.94) | 18 (0.71) |
| ① 202K142 | 31 (1.22) | 18.0 (0.71) | 18 (0.71) | 7.1 (0.28) | 67 (2.64) | 35 (1.38) | 3.0 (0.12) | 1.0 (0.04) | 20 (0.79) | 17.0 (0.67) | 1.8 (0.07) | 1.0 (0.04) | 32 (1.26) | 25 (0.98) |
| ① 202K153 | 36 (1.42) | 22.4 (0.88) | 21 (0.83) | 8.4 (0.33) | 80 (3.15) | 42 (1.65) | 3.0 (0.12) | 1.0 (0.04) | 20 (0.79) | 19.5 (0.77) | 2.0 (0.08) | 1.0 (0.04) | 32 (1.26) | 30 (1.18) |
| 202K163 | 43 (1.69) | 28.2 (1.11) | 25 (0.98) | 9.9 (0.39) | 99 (3.90) | 61 (2.40) | 3.0 (0.12) | 1.7 (0.07) | 20 (0.79) | 21.0 (0.83) | 2.2 (0.09) | 1.0 (0.04) | 52 (2.05) | 30 (1.18) |
| 202K174 | 52 (2.05) | 35.1 (1.38) | 39 (1.54) | 15.7 (0.62) | 130 (5.12) | 72 (2.83) | 3.0 (0.12) | 1.7 (0.07) | 20 (0.79) | 39.0 (1.54) | 3.2 (0.13) | 1.5 (0.06) | 52 (2.05) | 50 (1.97) |
| 202K185 | 66 (2.60) | 44.5 (1.75) | 42 (1.65) | 16.8 (0.66) | 170 (6.69) | 90 (3.54) | 3.0 (0.12) | 2.0 (0.08) | 20 (0.79) | 51.5 (2.03) | 3.8 (0.15) | 2.0 (0.08) | 52 (2.05) | 70 (2.76) |

② See over for explanation of Notes

Drawn A.LILLEY. Checked

Issue 5

Date February 2007

Conforms to ISO Recommendations

 Approval
Design

MKTG.

Q.A.

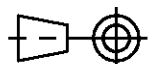
 3rd Angle Projection
Not to Scale



**Specification
Control Drawing**

Part Number

202K1**-100

Issue 5

| Iss. | Date | E.C.R. No. | Details of Change |
|------|---------------|-------------|-------------------------------------|
| 2 | December 1985 | 4502 | Redrawn |
| 3 | May 1990 | **** | Redrawn, was on 2 seperate drawings |
| 4 | February 2007 | CR06-HM-012 | Imperial dimensions added |

(Ordering Information)

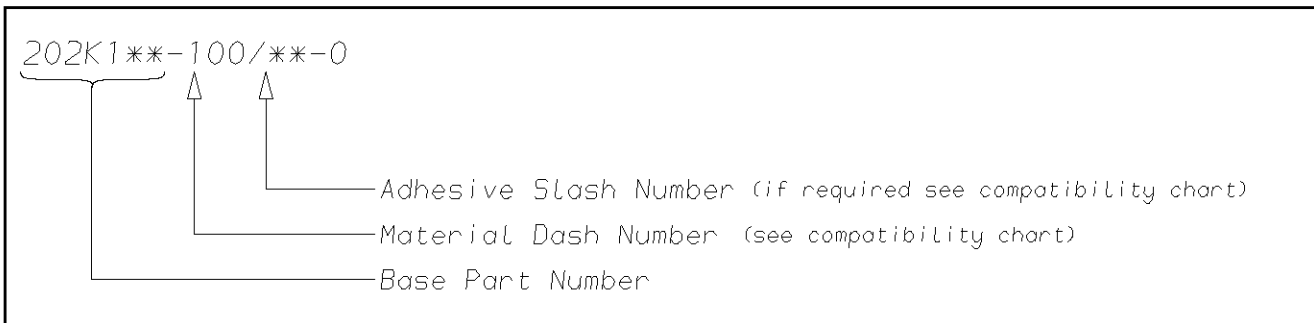

(COMPATIBILITY CHART)

| Material Dash Number | Material Description | SPEC Number | Coating Slash Number |
|----------------------|----------------------|------------------|----------------------|
| -100 | Zero Halogen | RT-1323, RK-6717 | /86, /180 |
| | | | |
| | | | |
| | | | |
| | | | |
| | | | |
| | | | |

NOTES

- ① Supplied with 2 lips only, Dimension V does not apply.
- ② Potting Port X @ 90° to Potting Port Y on 202K121.
- ③ Potting Ports are optional, when specified by suffix -00 they will be located as shown.
- ④ As supplied dimensions are for uncoated parts, when coating is added entry diameters will reduce by 1.5mm Max.
- ⑤ If eyelet clip (000W212) is required with part then add CS-1858 to description (i.e. 202K132-100-0-CS-1858).

| | |
|---|--|
| TE Connectivity Faraday Road, Swindon, Wiltshire, SN3 5HH England Telephone: (01793) 528171 Fax: 572516 | TE Connectivity 300, Constitution Drive, Menlo Park, CA 94025 USA Telephone (650) 361-3860 Fax: (650) 361-5579 |
| Cage Code K1010 | Cage Code 06090 |