



Chipsmall Limited consists of a professional team with an average of over 10 year of expertise in the distribution of electronic components. Based in Hongkong, we have already established firm and mutual-benefit business relationships with customers from,Europe,America and south Asia,supplying obsolete and hard-to-find components to meet their specific needs.

With the principle of “Quality Parts,Customers Priority,Honest Operation,and Considerate Service”,our business mainly focus on the distribution of electronic components. Line cards we deal with include Microchip,ALPS,ROHM,Xilinx,Pulse,ON,Everlight and Freescale. Main products comprise IC,Modules,Potentiometer,IC Socket,Relay,Connector.Our parts cover such applications as commercial,industrial, and automotives areas.

We are looking forward to setting up business relationship with you and hope to provide you with the best service and solution. Let us make a better world for our industry!



## Contact us

Tel: +86-755-8981 8866 Fax: +86-755-8427 6832

Email & Skype: info@chipsmall.com Web: www.chipsmall.com

Address: A1208, Overseas Decoration Building, #122 Zhenhua RD., Futian, Shenzhen, China



THIS DRAWING IS UNPUBLISHED. RELEASED FOR PUBLICATION  
 © COPYRIGHT 2011 BY TE CONNECTIVITY. ALL RIGHTS RESERVED.

LOC	DIST	REVISIONS					
DW		P	LTR	DESCRIPTION	DATE	DWN	APVD
		D1		REVISED PER ECR-15-005460	08MAY15	S.C.	H.L.

NOTE:

- MATERIAL:
  - HOUSING/SPACER: LCP WITH 30% GF, UL94 V-0, BLACK COLOR.
  - SHELL: PHOSPHOR BRONZE
  - CONTACT: BRASS
- FINISH:
  - CONTACT:
    - (SEE TABLE) GLOD PLATED ON CONTACT AREA
    - 2.54µm [100µ"] MIN. MATTE-TIN ON SOLDER TAIL
    - 1.27µm [50µ"] MIN. NICKEL UNDERPLATE OVERALL
  - SHELL:
    - 1.27µm [50µ"] MIN. NICKEL UNDERPLATING OVERALL.
- REFLOW SOLDER CAPABLE TO 260°C PER TEC-109-201.
- LOW HALOGEN SPECIFICATION:
  - CHLORINE(CL): 900 ppm MAX.
  - BROMINE(BR): 900 ppm MAX.
  - CL + BR : 1500 ppm MAX.

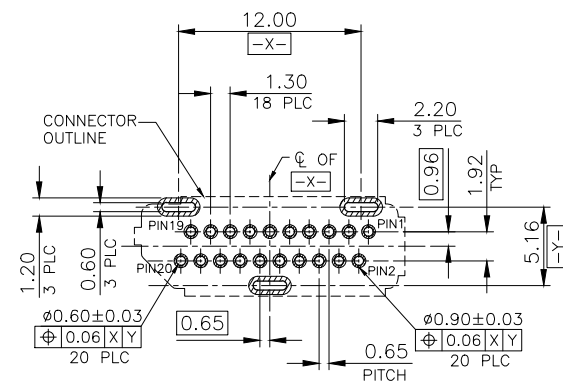
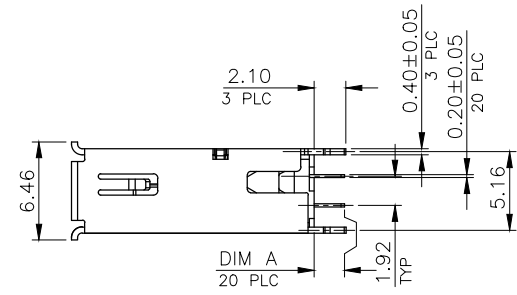
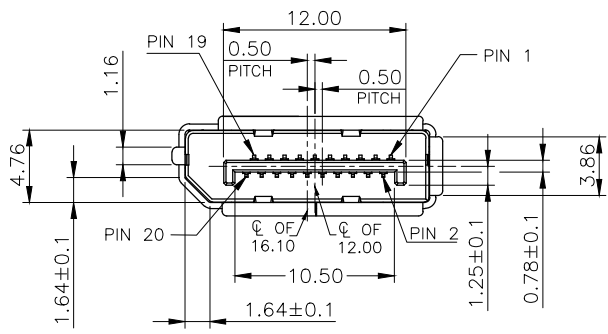
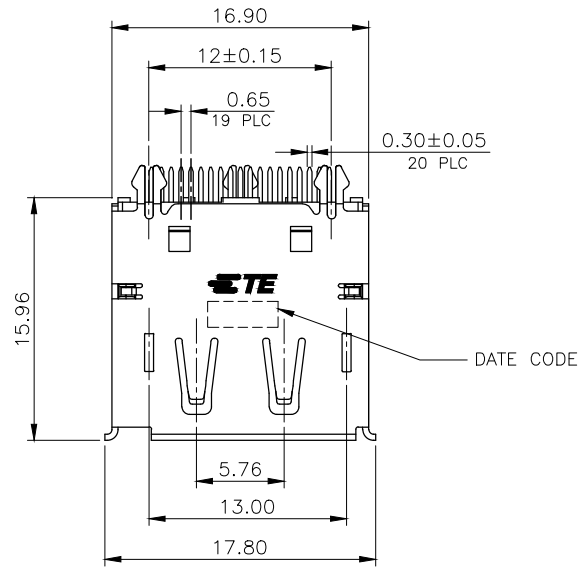

RECOMMENDED P.C.B LAYOUT <TOP VIEW>  
 THICKNESS: 1.60mm, TOLERANCE: ±0.05mm

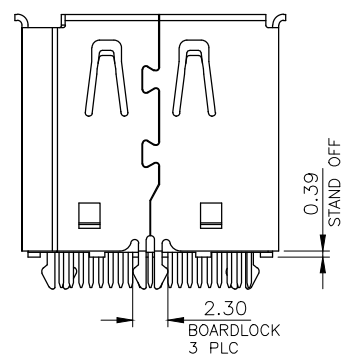

0.381µm [15µ"]	2.10	2041441-3
0.381µm [15µ"]	2.50	2041441-2
0.762µm [30µ"]	2.10	2041441-1
MIN. GOLD THICKNESS	DIM A	PART NUMBER

THIS DRAWING IS A CONTROLLED DOCUMENT.		DWN J. LAI	12DEC2011	<b>STE</b> TE Connectivity	
DIMENSIONS: mm		CHK S. CHIEN	12DEC2011		
TOLERANCES UNLESS OTHERWISE SPECIFIED:		APVD W. KODAMA	12DEC2011	NAME	
0 PLC ± -		PRODUCT SPEC		108-57889	
1 PLC ± 0.3		APPLICATION SPEC		SIZE	
2 PLC ± 0.2		WEIGHT		2.86 GRAMS	
3 PLC ± 0.15		MATERIAL		SEE NOTE	
4 PLC ± -		FINISH		SEE NOTE	
ANGLES ± 3'		CUSTOMER DRAWING		A3 00779 C=2041441	
		SCALE		SHEET 1 of 4	
		REV		D1	

THIS DRAWING IS UNPUBLISHED. RELEASED FOR PUBLICATION  
 © COPYRIGHT 2011 BY TE CONNECTIVITY. ALL RIGHTS RESERVED.

LOC		DIST		REVISIONS					
DW				P	LTR	DESCRIPTION	DATE	DWN	APVD
				-	-	SEE SHEET 1	-	-	-

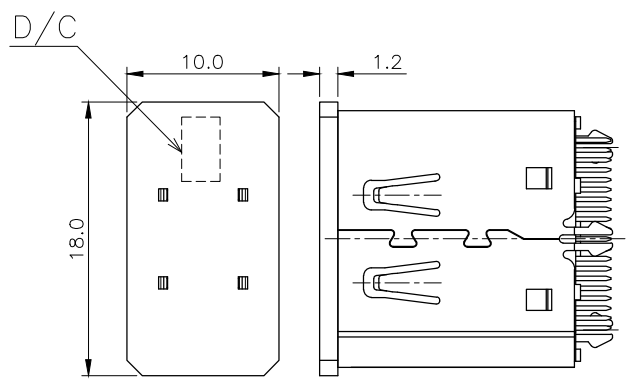
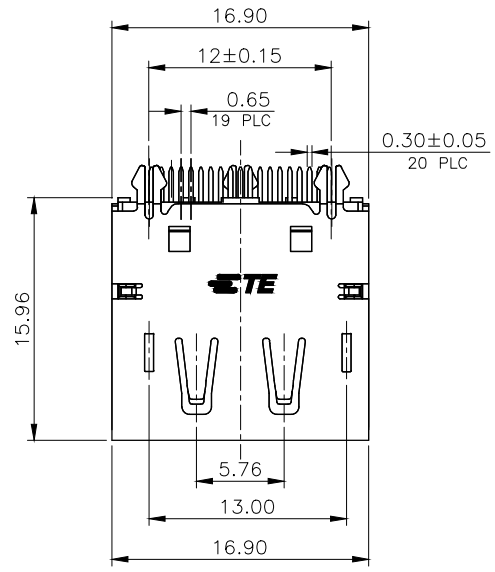

WITH CAP VIEW

- NOTE:
- MATERIAL:
    - HOUSING/SPACER: LCP WITH 30% GF, UL94 V-0, BLACK COLOR.
    - SHELL: PHOSPHOR BRONZE
    - CONTACT: BRASS
  - FINISH:
    - CONTACT:
      - (SEE TABLE) GLOD PLATED ON CONTACT AREA
      - 2.54µm [100µ"] MIN. MATTE-TIN ON SOLDER TAIL
      - 1.27µm [50µ"] MIN. NICKEL UNDERPLATE OVERALL
    - SHELL:
      - 1.27µm [50µ"] MIN. NICKEL UNDERPLATING OVERALL.
  - REFLOW SOLDER CAPABLE TO 260°C PER TEC-109-201.
  - LOW HALOGEN SPECIFICATION:
    - CHLORINE(CL): 900 ppm MAX.
    - BROMINE(BR): 900 ppm MAX.
    - CL + BR : 1500 ppm MAX.

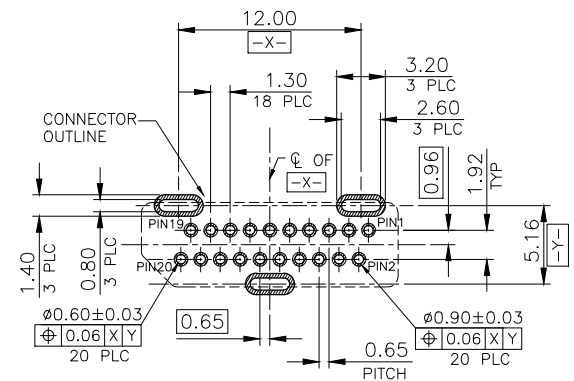
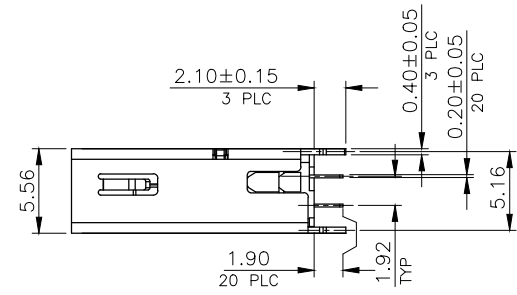
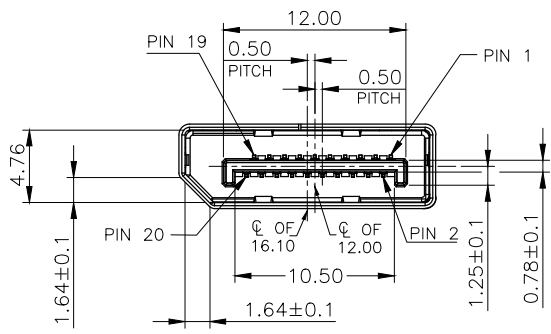

RECOMMENDED P.C.B LAYOUT <TOP VIEW>  
 THICKNESS: 1.60mm, TOLERANCE: ±0.05mm

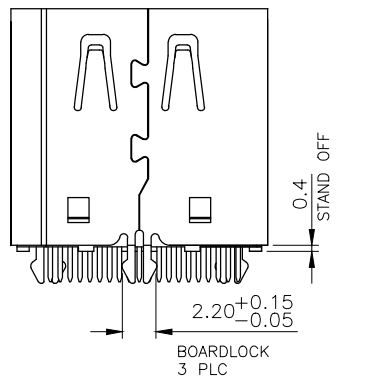

0.381µm [15µ"]	1-2041441-2
MIN. GOLD THICKNESS	PART NUMBER

THIS DRAWING IS A CONTROLLED DOCUMENT.		DWN J. LAI	12DEC2011	TE Connectivity	
DIMENSIONS: mm		CHK S. CHIEN	12DEC2011		
TOLERANCES UNLESS OTHERWISE SPECIFIED:		APVD W. KODAMA	12DEC2011	NAME	
0 PLC ± - 1 PLC ± 0.3 2 PLC ± 0.2 3 PLC ± 0.15 4 PLC ± - ANGLES ± 3°		PRODUCT SPEC 108-57889		DISPLAYPORT CONNECTOR, 20 POSITION, VERTICAL, DIP TYPE	
MATERIAL SEE NOTE		APPLICATION SPEC		SIZE	RESTRICTED TO
FINISH SEE NOTE		WEIGHT 2.8 GRAMS		CAGE CODE A300779	DRAWING NO C=2041441
CUSTOMER DRAWING		SCALE		SHEET 2 of 4	REV D1

THIS DRAWING IS UNPUBLISHED. RELEASED FOR PUBLICATION  
 © COPYRIGHT 2011 BY TE CONNECTIVITY. ALL RIGHTS RESERVED.

LOC	DIST	REVISIONS					
DW		P	LTR	DESCRIPTION	DATE	DWN	APVD
				SEE SHEET 1.			

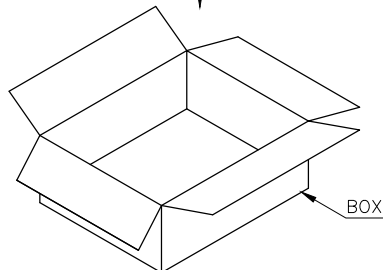
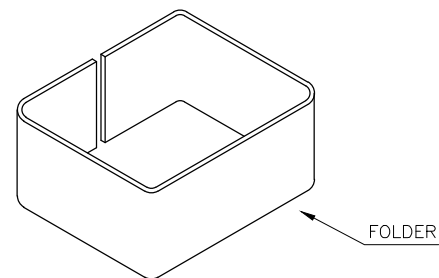
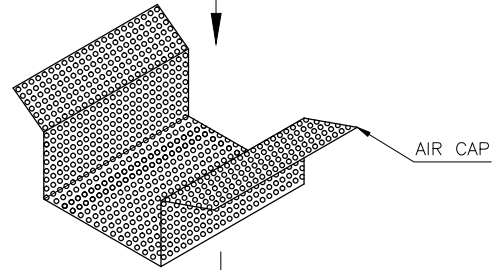
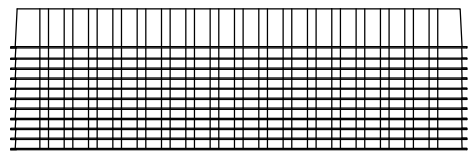
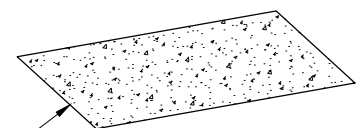
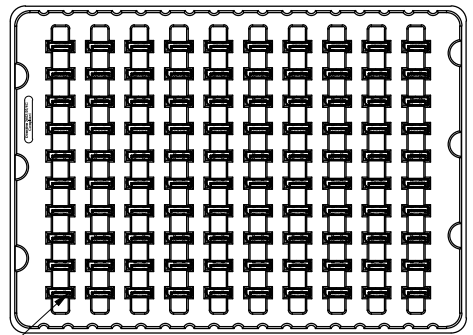
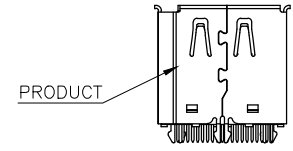

NOTES:

- MATERIAL:  
 TRAY: PET  
 SPONGE: EPS  
 AIR CAP: PE  
 FOLDER: SINGLE WALL CORRUGATED.  
 BOX: FIBREBOARD, CORRUGATED, DOUBLE WALL.
- DIMENSION:  
 TRAY: L=300mm, W=215mm, H=20.8mm  
 SPONGE: L=330mm, W=220mm, H=0.5mm  
 AIR CAP: L=850mm, W=315mm, H=8mm  
 FOLDER: L=1100mm, W=130mm, H=3mm  
 BOX: L=325mm, W=250mm, H=232mm

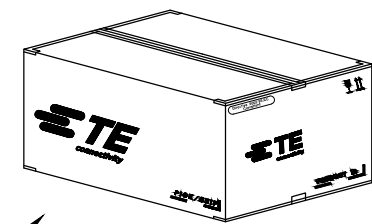

FOR PN 2041441-1,2041441-2,2041441-3

1000	10	100	2.84 Kg	5.62 Kg
PCS /BOX	TRAYS /BOX	PCS /TRAY	NET WEIGHT	GROSS WEIGHT

THIS DRAWING IS A CONTROLLED DOCUMENT.		DWN	TE Connectivity		
DIMENSIONS: mm		CHK	NAME		
TOLERANCES UNLESS OTHERWISE SPECIFIED:		APVD	DISPLAYPORT CONNECTOR, 20 POSITION, VERTICAL, DIP TYPE		
0 PLC ± -		PRODUCT SPEC	SIZE	CAGE CODE	DRAWING NO
1 PLC ± 0.3		APPLICATION SPEC	A3	00779	C=2041441
2 PLC ± 0.2		WEIGHT	RESTRICTED TO		
3 PLC ± 0.15		CUSTOMER DRAWING	SCALE	SHEET	REV
4 PLC ± -				3 of 4	D1
ANGLES ± 3'					
MATERIAL	FINISH				

THIS DRAWING IS UNPUBLISHED. RELEASED FOR PUBLICATION  
 © COPYRIGHT 2011 BY TE CONNECTIVITY. ALL RIGHTS RESERVED.

LOC	DIST	REVISIONS					
DW		P	LTR	DESCRIPTION	DATE	DWN	APVD
		-		SEE SHEET 1	-	-	-

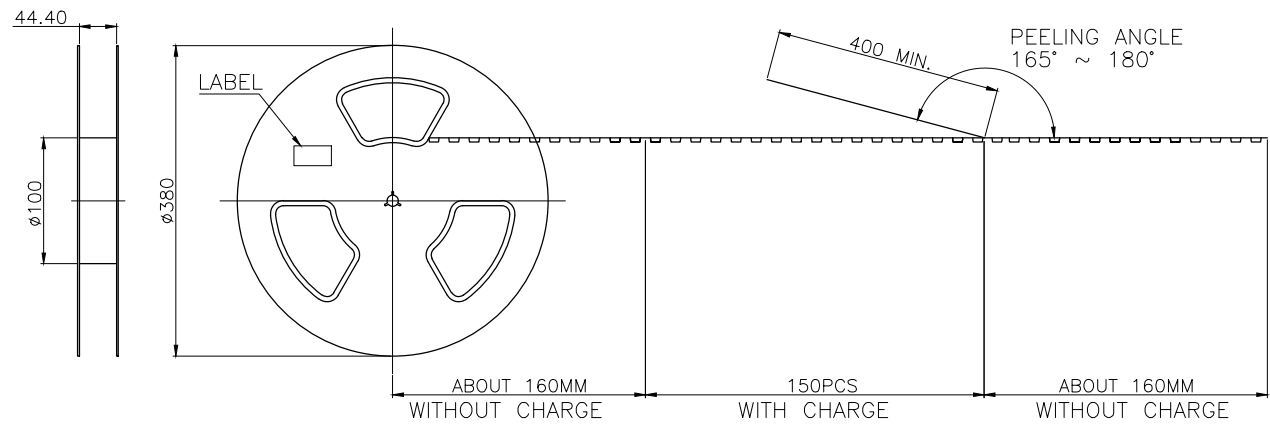

- NOTES:
- MATERIAL:  
 BOX: FIBREBOARD, CORRUGATED, DOUBLE WALL.  
 COVER TAPE: PET, TRANSPARENT COLOR.  
 CARRIER TAPE: POLYSTYRENES, BLACK COLOR.  
 REEL: POLYSTYRENES, BLUE COLOR.
  - PEELING STRENGTH: 0.1 ~ 1.3 N (10 ~ 130 GRAMS)
  - PEELING SPEED: 300 mm/min.

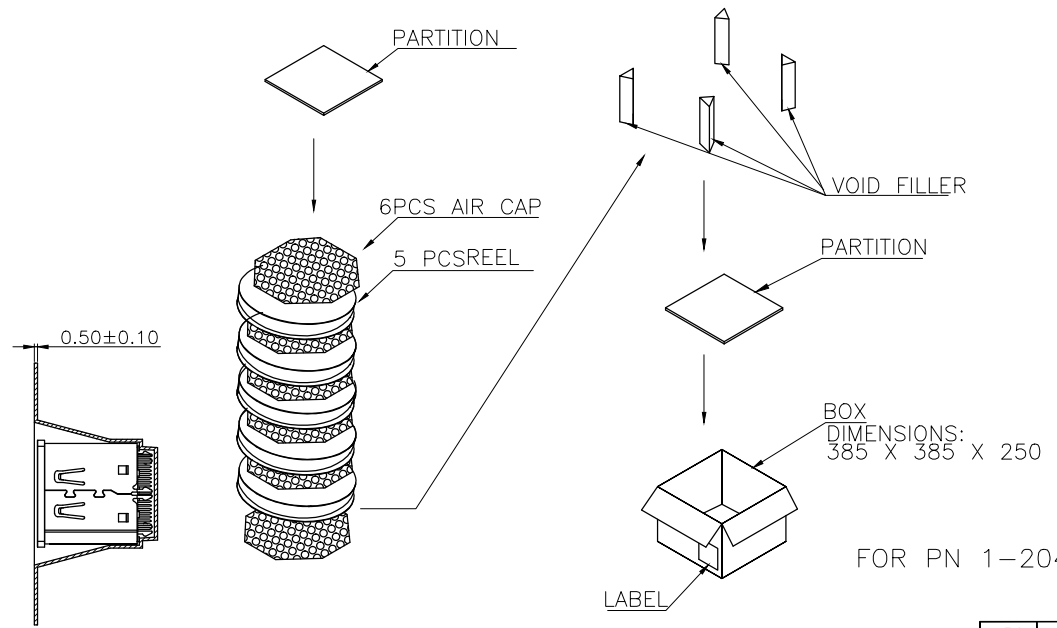
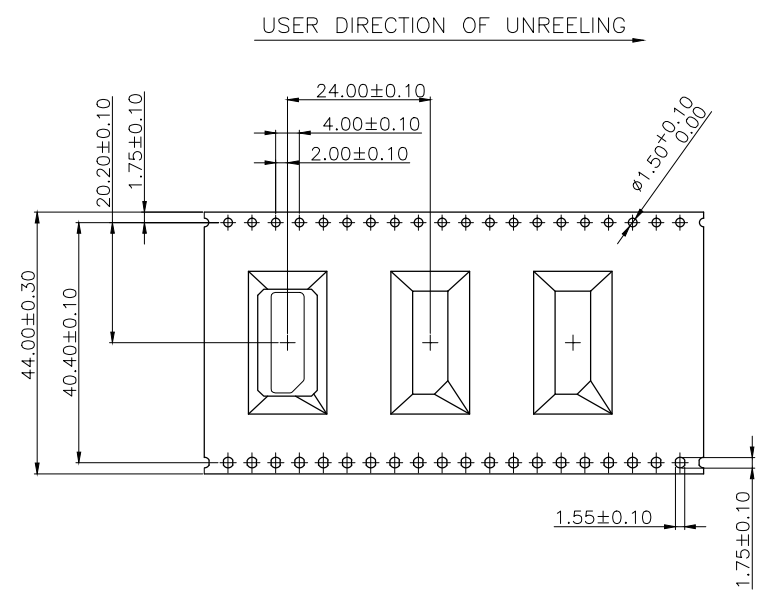

FOR PN 1-2041441-2

150	5	750
PCS/REEL	REELS/BOX	PCS/BOX

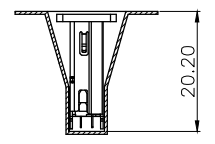

THIS DRAWING IS A CONTROLLED DOCUMENT.		DWN	-	<b>STE</b> TE Connectivity	
DIMENSIONS: MM		CHK	-		
TOLERANCES UNLESS OTHERWISE SPECIFIED:		APVD	-	NAME	
0 PLC ±		PRODUCT SPEC		DISPLAYPORT CONNECTOR, 20 POSITION, VERTICAL, DIP TYPE	
1 PLC ±		APPLICATION SPEC		SIZE	A3
2 PLC ±		WEIGHT		CAGE CODE	00779
3 PLC ±		CUSTOMER DRAWING		DRAWING NO	C=2041441
4 PLC ±		SCALE		RESTRICTED TO	-
ANGLES ±		SHEET		4 of 4	
MATERIAL SEE NOTE		FINISH		REV D1	